

OWWO

For KCC Use: 5-18-2009  
Effective Date: 5-18-2009  
District # 1  
SGA?  Yes  No

KANSAS CORPORATION COMMISSION  
OIL & GAS CONSERVATION DIVISION

Form C-1  
October 2007

Form must be Typed  
Form must be Signed  
All blanks must be Filled

NOTICE OF INTENT TO DRILL  
Must be approved by KCC five (5) days prior to commencing well

Expected Spud Date: May 15, 2009  
month day year

OPERATOR: License# 31885  
Name: M & M Exploration, Inc.  
Address 1: 60 Garden Center, Suite 102  
Address 2:  
City: Broomfield State: CO Zip: 80020 + 1022  
Contact Person: Mike Austin  
Phone: 303-438-1991

CONTRACTOR: License# Must be licensed by KCC  
Name: Advise on ACO-1

Well Drilled For:  Oil  Gas  Seismic  Other  
 Enh Rec  Disposal  
 Infield  Pool Ext.  Other  
Type Equipment:  Mud Rotary  Air Rotary  Cable

If OWWO: old well information as follows:  
Operator: Associated Petroleum Consultants  
Well Name: Z Bar Cattle Co. #1  
Original Completion Date: 3/26/77 Original Total Depth: 4830'

Directional, Deviated or Horizontal wellbore?  Yes  No  
If Yes, true vertical depth:  
Bottom Hole Location:  
KCC DKT #:

Spot Description:  
C NE NE Sec. 31 Twp. 33 S. R. 14 E W  
660 feet from N / S Line of Section  
660 feet from E / W Line of Section

Is SECTION:  Regular  Irregular?  
(Note: Locate well on the Section Plat on reverse side)

County: Barber  
Lease Name: Z Bar Cattle Co. Well #: #1  
Field Name: Aetna

Is this a Prorated / Spaced Field?  Yes  No  
Target Formation(s): Arbuckle

Nearest Lease or unit boundary line (in footage): 660'  
Ground Surface Elevation: 1699 feet MSL

Water well within one-quarter mile:  Yes  No  
Public water supply well within one mile:  Yes  No

Depth to bottom of fresh water: 100  
Depth to bottom of usable water: 180

Surface Pipe by Alternate:  I  II  
Length of Surface Pipe Planned to be set: 405

Length of Conductor Pipe (if any):  
Projected Total Depth: 5400'

Formation at Total Depth: Arbuckle  
Water Source for Drilling Operations:  
 Well  Farm Pond  Other:

DWR Permit #: (Note: Apply for Permit with DWR )

Will Cores be taken?  Yes  No  
If Yes, proposed zone:

AFFIDAVIT

KANSAS CORPORATION COMMISSION

The undersigned hereby affirms that the drilling, completion and eventual plugging of this well will comply with K.S.A. 55 et. seq.  
It is agreed that the following minimum requirements will be met:

MAY 11 2009  
RECEIVED

- 1. Notify the appropriate district office prior to spudding of well;
- 2. A copy of the approved notice of intent to drill shall be posted on each drilling rig;
- 3. The minimum amount of surface pipe as specified below shall be set by circulating cement to the top; in all cases surface pipe shall be set through all unconsolidated materials plus a minimum of 20 feet into the underlying formation.
- 4. If the well is dry hole, an agreement between the operator and the district office on plug length and placement is necessary prior to plugging;
- 5. The appropriate district office will be notified before well is either plugged or production casing is cemented in;
- 6. If an ALTERNATE II COMPLETION, production pipe shall be cemented from below any usable water to surface within 120 DAYS of spud date. Or pursuant to Appendix "B" - Eastern Kansas surface casing order #133,891-C, which applies to the KCC District 3 area, alternate II cementing must be completed within 30 days of the spud date or the well shall be plugged. In all cases, NOTIFY district office prior to any cementing.

I hereby certify that the statements made herein are true and correct to the best of my knowledge and belief.

Date: May 7, 2009 Signature of Operator or Agent: [Signature] Title: President

For KCC Use ONLY  
API # 15 - 007-20484-00-01  
Conductor pipe required None feet  
Minimum surface pipe required 405 feet per ALT.  I  II  
Approved by: [Signature] 5-13-2009  
This authorization expires: 5-13-2010  
(This authorization void if drilling not started within 12 months of approval date.)  
Spud date: Agent:

- Remember to:
- File Drill Pit Application (form CDP-1) with Intent to Drill;
  - File Completion Form ACO-1 within 120 days of spud date;
  - File acreage attribution plat according to field proration orders;
  - Notify appropriate district office 48 hours prior to workover or re-entry;
  - Submit plugging report (CP-4) after plugging is completed (within 60 days);
  - Obtain written approval before disposing or injecting salt water.
- If this permit has expired (See: authorized expiration date) please check the box below and return to the address below.  
 Well Not Drilled - Permit Expired Date: Signature of Operator or Agent:

31  
33  
14  
 E  
 W

**IN ALL CASES PLOT THE INTENDED WELL ON THE PLAT BELOW**

*Plat of acreage attributable to a well in a prorated or spaced field*

**If the intended well is in a prorated or spaced field, please fully complete this side of the form.** If the intended well is in a prorated or spaced field complete the plat below showing that the well will be properly located in relationship to other wells producing from the common source of supply. Please show all the wells and within 1 mile of the boundaries of the proposed acreage attribution unit for gas wells and within 1/2 mile of the boundaries of the proposed acreage attribution unit for oil wells.

API No. 15 - 007-20484-00-01  
 Operator: M & M Exploration, Inc.  
 Lease: Z Bar Cattle Co.  
 Well Number: #1  
 Field: Aetna

Location of Well: County: Barber  
660 feet from  N /  S Line of Section  
660 feet from  E /  W Line of Section  
 Sec. 31 Twp. 33 S. R. 14  E  W

Number of Acres attributable to well: \_\_\_\_\_  
 QTR/QTR/QTR/QTR of acreage: \_\_\_\_\_ - C - NE - NE

Is Section:  Regular or  Irregular

**If Section is Irregular, locate well from nearest corner boundary.**

Section corner used:  NE  NW  SE  SW

**PLAT**

*(Show location of the well and shade attributable acreage for prorated or spaced wells.)  
 (Show footage to the nearest lease or unit boundary line.)*

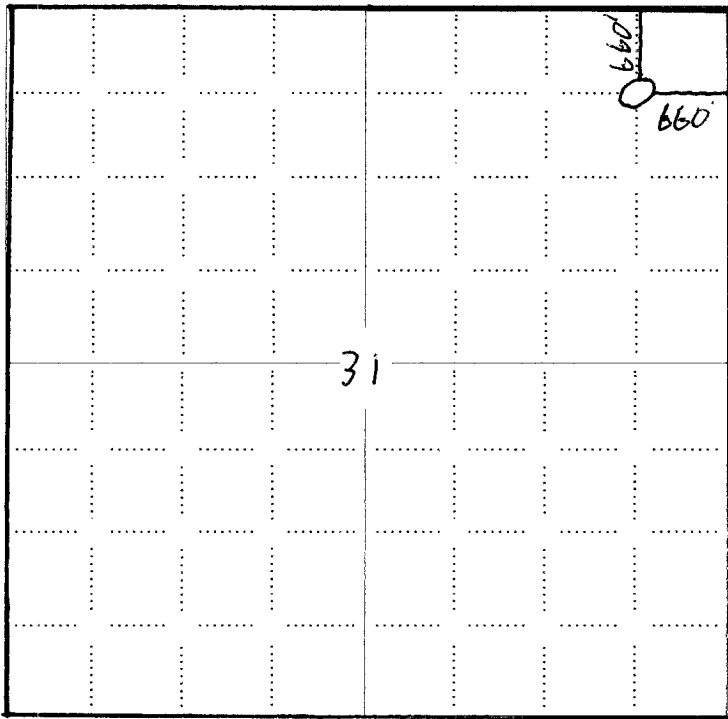

KANSAS CORPORATION COMMISSION  
 MAY 11 2009  
 RECEIVED

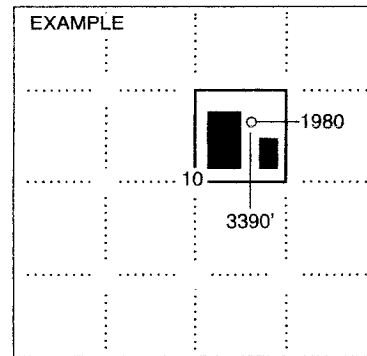

**NOTE: In all cases locate the spot of the proposed drilling location.**

**In plotting the proposed location of the well, you must show:**

1. The manner in which you are using the depicted plat by identifying section lines, i.e. 1 section, 1 section with 8 surrounding sections, 4 sections, etc.
2. The distance of the proposed drilling location from the south / north and east / west outside section lines.
3. The distance to the nearest lease or unit boundary line (in footage).
4. If proposed location is located within a prorated or spaced field a certificate of acreage attribution plat must be attached: (CO-7 for oil wells; CG-8 for gas wells).

**KANSAS CORPORATION COMMISSION  
OIL & GAS CONSERVATION DIVISION  
APPLICATION FOR SURFACE PIT**

Form CDP-1  
April 2004  
Form must be Typed

*Submit in Duplicate*

Operator Name: <b>M &amp; M Exploration, Inc.</b>		License Number: <b>31885</b>	
Operator Address: <b>60 Garden Center, Suite 102</b>		<b>Broomfield CO 80020</b>	
Contact Person: <b>Mike Austin</b>		Phone Number: <b>303-438-1991</b>	
Lease Name & Well No.: <b>Z Bar Cattle Co. #1</b>		Pit Location (QQQQ): <b>C NE NE</b>	
Type of Pit: <input type="checkbox"/> Emergency Pit <input type="checkbox"/> Burn Pit <input type="checkbox"/> Setting Pit <input checked="" type="checkbox"/> Drilling Pit <input type="checkbox"/> Workover Pit <input type="checkbox"/> Haul-Off Pit <i>(If WP Supply API No. or Year Drilled)</i>		Pit is: <input checked="" type="checkbox"/> Proposed <input type="checkbox"/> Existing If Existing, date constructed: _____ Pit capacity: _____ (bbls)	
Is the pit located in a Sensitive Ground Water Area? <input type="checkbox"/> Yes <input checked="" type="checkbox"/> No		Chloride concentration: _____ mg/l <i>(For Emergency Pits and Settling Pits only)</i>	
Is the bottom below ground level? <input checked="" type="checkbox"/> Yes <input type="checkbox"/> No		Artificial Liner? <input type="checkbox"/> Yes <input checked="" type="checkbox"/> No	
How is the pit lined if a plastic liner is not used? <b>Native Clay</b>			
Pit dimensions (all but working pits): <u>100</u> Length (feet) <u>100</u> Width (feet) <input type="checkbox"/> N/A: Steel Pits Depth from ground level to deepest point: <u>4</u> (feet) <input type="checkbox"/> No Pit			
If the pit is lined give a brief description of the liner material, thickness and installation procedure.		Describe procedures for periodic maintenance and determining liner integrity, including any special monitoring.	
Distance to nearest water well within one-mile of pit <u>4397</u> feet    Depth of water well <u>67</u> feet		Depth to shallowest fresh water <u>47</u> feet. <b>7</b> Source of information: <u>JR-KGS</u> <input type="checkbox"/> measured <input type="checkbox"/> well owner <input type="checkbox"/> electric log <input type="checkbox"/> KDWR	
<b>Emergency, Settling and Burn Pits ONLY:</b> Producing Formation: _____ Number of producing wells on lease: _____ Barrels of fluid produced daily: _____ Does the slope from the tank battery allow all spilled fluids to flow into the pit? <input type="checkbox"/> Yes <input type="checkbox"/> No		<b>Drilling, Workover and Haul-Off Pits ONLY:</b> Type of material utilized in drilling/workover: <u>Fresh water mud</u> Number of working pits to be utilized: <u>3</u> Abandonment procedure: <u>Evaporation and backfill</u> Drill pits must be closed within 365 days of spud date.	
I hereby certify that the above statements are true and correct to the best of my knowledge and belief.			
Date: <u>May 7, 2009</u>		Signature of Applicant or Agent: <u><i>Mike Austin</i></u>	
MAY 11 2009 <b>RECEIVED</b>			
<b>KCC OFFICE USE ONLY</b>			
Date Received: <u>5/11/09</u>		Permit Number: _____    Permit Date: <u>5/13/09</u> Lease Inspection: <input checked="" type="checkbox"/> Yes <input type="checkbox"/> No	
Steel Pit <input checked="" type="checkbox"/> RFAC <input checked="" type="checkbox"/> RFAS <input type="checkbox"/>			

15-007-20484-00-01



Mark Parkinson, Governor  
Thomas E. Wright, Chairman  
Michael C. Moffet, Commissioner  
Joseph F. Harkins, Commissioner

May 13, 2009

M & M Exploration, Inc.  
60 Garden Center Ste 102  
Broomfield CO 80020-1022

RE: Drilling Pit Application  
Z Bar Cattle Co. Lease Well No. 1  
NE/4 Sec. 31-33S-14W  
Barber County, Kansas

Dear Sir or Madam:

District staff has inspected the location and has determined that an unsealed condition will present a pollution threat to water resources.

District staff has instructed that no earthen pits are to be used at the location. Steel pits are to be used. Please inform the Commission in writing as to which disposal well you will utilize to dispose of the contents in the steel pits and the amount of fluid that will be disposed. **If a haul-off pit is necessary please file, form CDP-1, Application for Surface Pit.** This location will have to be inspected prior to approval of the haul-off pit application.

If fluids are taken to an authorized disposal well, please call the District Office at (620) 225-8888. Please file form CDP-5, Exploration and Production Waste Transfer, within 30 days of fluid removal.

Conservation division forms are available through our office and on the KCC web site: [www.kcc.state.ks.us/conservation/forms](http://www.kcc.state.ks.us/conservation/forms).

Sincerely,

A handwritten signature in black ink that reads "Kathy Haynes". The signature is written in a cursive style.

Kathy Haynes  
Environmental Protection and Remediation Department

Cc: File

**HAUL-OFF PIT APPLICATION  
FILING REQUIREMENTS**

**82-3-607. DISPOSAL OF DIKE AND PIT CONTENTS.**

- (a) Each operator shall perform one of the following when disposing of dike or pit contents:
- (1) Remove the liquid contents to a disposal well or other oil and gas operation approved by the commission or to road maintenance or construction locations approved by the department;
  - (2) dispose of reserve pit waste down the annular space of a well completed according to the alternate I requirements of K.A.R. 82-3-106, if the waste to be disposed of was generated during the drilling and completion of the well; or
  - (3) dispose of the remaining solid contents in any manner required by the commission. The requirements may include any of the following:
    - (A) Burial in place, in accordance with the grading and restoration requirements in K.A.R. 82-3-602 (f);
    - (B) removal and placement of the contents in an on-site disposal area approved by the commission;
    - (C) removal and placement of the contents in an off-site disposal area on acreage owned by the same landowner or to another producing lease or unit operated by the same operator, if prior written permission from the landowner has been obtained; or
    - (D) removal of the contents to a permitted off-site disposal area approved by the department.
- (b) Each violation of this regulation shall be punishable by the following:
- (1) A \$1,000 penalty for the first violation;
  - (2) a \$2,500 penalty for the second violation; and
  - (3) a \$5,000 penalty and an operator license review for the third violation.

**Complete and return with Haul-Off Pit Application, Form CDP1(2004)**

Haul-off pit will be located in an on-site disposal area: Yes  No

Haul-off pit is located in an off-site disposal area on acreage owned by the same landowner: Yes   
No  If yes, written permission from the landowner must be obtained. Attach written permission to haul-off pit application.

Haul-off pit is located in an off-site disposal area on another **producing** lease or unit operated by the same operator: Yes  No  If yes, written permission from the landowner must be obtained. Attach permission and a copy of the lease assignment that covers the acreage where the haul-off pit is to be located, to the haul-off pit application.

**NOTICE TO OPERATORS FILING INTENT TO DRILL  
FOR DISPOSAL OR ENHANCED RECOVERY  
INJECTION WELLS, (CLASS II INJECTION WELL)**

The attached approved Notice of Intent to Drill indicates the proposed well is to be used for injection. An approved "Intent to Drill" does not approve injection authority as a Class II Injection Well in Kansas.

Before any well is used for injection purposes, the operator must file an application for injection authority in accordance with K.A.R. 82-3-401 and provide notice in accordance with K.A.R. 82-3-402. The Conservation Division must issue a written permit granting the application before commencement of injection.

The Conservation Division requirements and restrictions associated with Class II Injection are identified in **K.A.R. 82-3-400 et seq** of our regulations. Associated regulations governing drilling, completion and injection applications may be found in K.A.R. 82-3-135, Table I, Table II, in the Cedar Hills Sandstone Moratorium, (Docket #156,397-C), and the Eastern Kansas Surface Casing Order, (Docket #133,891-C).

If you have questions regarding the approval of injection authority, an injection application may be filed as a "Design Approval" before actual drilling and completion of the well occurs. If you have any questions or concerns regarding Class II injection wells or regulations, call the Underground Injection Control Department at 316-337-6200.

Failure to obtain commission approval before beginning injection is punishable by a penalty, shut-in of the well or both.

CONSERVATION DIVISION

Finney State Office Building, 130 S. Market, Room 2078, Wichita, KS 67202-3802  
(316) 337-6200 • Fax: (316) 337-6211 • <http://kcc.ks.gov/>