

For KCC Use:  
 Effective Date: 5-20-09  
 District # 1  
 SGA?  Yes  No

KANSAS CORPORATION COMMISSION  
 OIL & GAS CONSERVATION DIVISION

Form C-1  
 October 2007  
 Form must be Typed  
 Form must be Signed  
 All blanks must be Filled

**NOTICE OF INTENT TO DRILL**

Must be approved by KCC five (5) days prior to commencing well

Expected Spud Date: 6-1-2009  
 month day year

OPERATOR: License# 34242  
 Name: Oolite Energy Corp  
 Address 1: P.O. Box 9398  
 Address 2: \_\_\_\_\_  
 City: Amarillo State: TX Zip: 79105  
 Contact Person: David E. Rice  
 Phone: 620-624-0156

CONTRACTOR: License# 5929  
 Name: Duke Drilling Co

Well Drilled For:  Oil  Gas  
 Enh Rec  Storage  Disposal  
 Seismic; # of Holes \_\_\_\_\_  
 Other: \_\_\_\_\_  
 If OWWO: old well information as follows: \_\_\_\_\_

Well Class:

Infield  
 Pool Ext.  
 Wildcat  
 Other

Type Equipment:

Mud Rotary  
 Air Rotary  
 Cable

Operator: \_\_\_\_\_  
 Well Name: \_\_\_\_\_  
 Original Completion Date: \_\_\_\_\_ Original Total Depth: \_\_\_\_\_

Directional, Deviated or Horizontal wellbore?  Yes  No  
 If Yes, true vertical depth: \_\_\_\_\_  
 Bottom Hole Location: \_\_\_\_\_  
 KCC DKT #: \_\_\_\_\_

Spot Description: \_\_\_\_\_  
 S2 - NW - NE - NW Sec. 25 Twp. 33 S. R. 30  E  W  
 (Q/Q/Q/Q) 427 feet from  N /  S Line of Section  
1,650 feet from  E /  W Line of Section

Is SECTION:  Regular  Irregular?

(Note: Locate well on the Section Plat on reverse side)

County: Meade  
 Lease Name: Borth Well #: 1  
 Field Name: Wildcat

Is this a Prorated / Spaced Field?  Yes  No  
 Target Formation(s): Marmaton, Novinger, Morrow, Chester, Basal Chester Sand

Nearest Lease or unit boundary line (in footage): 427  
 Ground Surface Elevation: 2695 feet MSL

Water well within one-quarter mile:  Yes  No  
 Public water supply well within one mile:  Yes  No

Depth to bottom of fresh water: 550'  
 Depth to bottom of usable water: 550'

Surface Pipe by Alternate:  I  II  
 Length of Surface Pipe Planned to be set: 1550'

Length of Conductor Pipe (if any): 40'  
 Projected Total Depth: 6500'

Formation at Total Depth: St. Louis

Water Source for Drilling Operations:  
 Well  Farm Pond  Other: \_\_\_\_\_

DWR Permit #: \_\_\_\_\_  
 (Note: Apply for Permit with DWR )

Will Cores be taken?  Yes  No  
 If Yes, proposed zone: \_\_\_\_\_

**AFFIDAVIT**

The undersigned hereby affirms that the drilling, completion and eventual plugging of this well will comply with K.S.A. 55 et. seq.

It is agreed that the following minimum requirements will be met:

1. Notify the appropriate district office **prior** to spudding of well;
2. A copy of the approved notice of intent to drill **shall be** posted on each drilling rig;
3. The minimum amount of surface pipe as specified below **shall be set** by circulating cement to the top; in all cases surface pipe **shall be set** through all unconsolidated materials plus a minimum of 20 feet into the underlying formation.
4. If the well is dry hole, an agreement between the operator and the district office on plug length and placement is necessary **prior to plugging**;
5. The appropriate district office will be notified before well is either plugged or production casing is cemented in;
6. If an ALTERNATE II COMPLETION, production pipe shall be cemented from below any usable water to surface within **120 DAYS** of spud date.  
 Or pursuant to Appendix "B" - Eastern Kansas surface casing order #133,891-C, which applies to the KCC District 3 area, alternate II cementing must be completed within 30 days of the spud date or the well shall be plugged. **In all cases, NOTIFY district office** prior to any cementing.

I hereby certify that the statements made herein are true and correct to the best of my knowledge and belief.

Date: 5/13/2009 Signature of Operator or Agent: David E Rice Title: Agent

**For KCC Use ONLY**  
 API # 15 - 119-21239-00-00  
 Conductor pipe required None feet  
 Minimum surface pipe required 570 feet per ALT.  I  II  
 Approved by: SB 5-15-09  
 This authorization expires: 5-15-10  
 (This authorization void if drilling not started within 12 months of approval date.)  
 Spud date: \_\_\_\_\_ Agent: \_\_\_\_\_

**Remember to:**

- File Drill Pit Application (form CDP-1) with Intent to Drill;
- File Completion Form ACO-1 within 120 days of spud date;
- File acreage attribution plat according to field proration orders;
- Notify appropriate district office 48 hours prior to workover or re-entry;
- Submit plugging report (CP-4) after plugging is completed (within 60 days);
- Obtain written approval before disposing or injecting salt water.
- If this permit has expired (See: authorized expiration date) please check the box below and return to the address below.

Well Not Drilled - Permit Expired Date: \_\_\_\_\_  
 Signature of Operator or Agent: \_\_\_\_\_

KANSAS CORPORATION COMMISSION

MAY 15 2009

RECEIVED

25  
33  
30  
 E  
 W

**IN ALL CASES PLOT THE INTENDED WELL ON THE PLAT BELOW**

*Plat of acreage attributable to a well in a prorated or spaced field*

**If the intended well is in a prorated or spaced field, please fully complete this side of the form.** If the intended well is in a prorated or spaced field complete the plat below showing that the well will be properly located in relationship to other wells producing from the common source of supply. Please show all the wells and within 1 mile of the boundaries of the proposed acreage attribution unit for gas wells and within 1/2 mile of the boundaries of the proposed acreage attribution unit for oil wells.

API No. 15 - 119-21239-00-00

Operator: Oolite Energy Corp

Lease: Borth

Well Number: 1

Field: Wildcat

Number of Acres attributable to well: \_\_\_\_\_

QTR/QTR/QTR/QTR of acreage: S2 - NW - NE - NW

Location of Well: County: Meade

427 feet from  N /  S Line of Section

1,650 feet from  E /  W Line of Section

Sec. 25 Twp. 33 S. R. 30  E  W

Is Section:  Regular or  Irregular

**If Section is Irregular, locate well from nearest corner boundary.**

Section corner used:  NE  NW  SE  SW

**PLAT**

*(Show location of the well and shade attributable acreage for prorated or spaced wells.)*

*(Show footage to the nearest lease or unit boundary line.)*

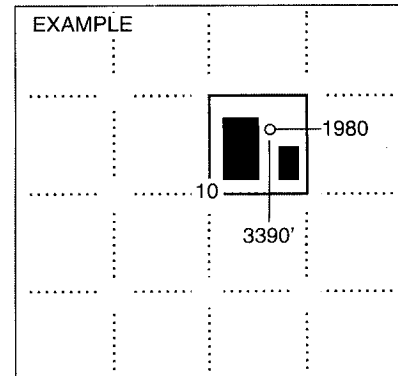
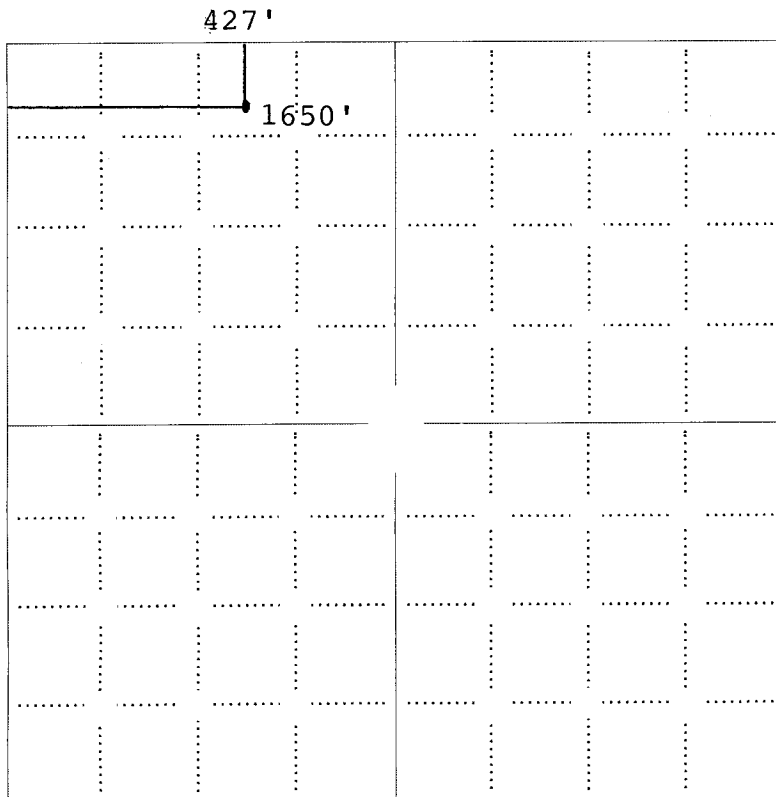

**NOTE: In all cases locate the spot of the proposed drilling location.**

**In plotting the proposed location of the well, you must show:**

1. The manner in which you are using the depicted plat by identifying section lines, i.e. 1 section, 1 section with 8 surrounding sections, 4 sections, etc.
2. The distance of the proposed drilling location from the south / north and east / west outside section lines.
3. The distance to the nearest lease or unit boundary line (in footage).
4. If proposed location is located within a prorated or spaced field a certificate of acreage attribution plat must be attached: (C0-7 for oil wells; CG-8 for gas wells).

**KANSAS CORPORATION COMMISSION  
OIL & GAS CONSERVATION DIVISION  
APPLICATION FOR SURFACE PIT**

Form CDP-1  
April 2004  
Form must be Typed

*Submit in Duplicate*

Operator Name: <b>Oolite Energy Corp</b>		License Number: <b>34242</b>
Operator Address: <b>P.O. Box 9398</b>		<b>Amarillo, TX 79105</b>
Contact Person: <b>David E. Rice</b>		Phone Number: <b>620-624-0156</b>
Lease Name & Well No.: <b>Borth #1</b>		Pit Location (QQQQ): <b>S2 - NW - NE - NW</b>
Type of Pit: <input type="checkbox"/> Emergency Pit <input type="checkbox"/> Burn Pit <input type="checkbox"/> Settling Pit <input checked="" type="checkbox"/> Drilling Pit <input type="checkbox"/> Workover Pit <input type="checkbox"/> Haul-Off Pit <small>(If WP Supply API No. or Year Drilled)</small>	Pit is: <input checked="" type="checkbox"/> Proposed <input type="checkbox"/> Existing If Existing, date constructed: _____ Pit capacity: <b>14,000</b> (bbls)	Sec. <b>25</b> Twp. <b>33</b> R. <b>30</b> <input type="checkbox"/> East <input checked="" type="checkbox"/> West <b>427</b> Feet from <input checked="" type="checkbox"/> North / <input type="checkbox"/> South Line of Section <b>1,650</b> Feet from <input type="checkbox"/> East / <input checked="" type="checkbox"/> West Line of Section <b>Meade</b> County
Is the pit located in a Sensitive Ground Water Area? <input type="checkbox"/> Yes <input checked="" type="checkbox"/> No		Chloride concentration: _____ mg/l <small>(For Emergency Pits and Settling Pits only)</small>
Is the bottom below ground level? <input checked="" type="checkbox"/> Yes <input type="checkbox"/> No	Artificial Liner? <input type="checkbox"/> Yes <input checked="" type="checkbox"/> No	How is the pit lined if a plastic liner is not used? <b>Natural Permeability</b>
Pit dimensions (all but working pits): _____ Length (feet) _____ Width (feet) Depth from ground level to deepest point: _____ (feet)		<input checked="" type="checkbox"/> N/A: Steel Pits <input type="checkbox"/> No Pit
If the pit is lined give a brief description of the liner material, thickness and installation procedure.		Describe procedures for periodic maintenance and determining liner integrity, including any special monitoring.
Distance to nearest water well within one-mile of pit <b>1416</b> feet    Depth of water well <b>380</b> feet	Depth to shallowest fresh water <b>200</b> feet. Source of information: <input type="checkbox"/> measured <input type="checkbox"/> well owner <input type="checkbox"/> electric log <input checked="" type="checkbox"/> KDWR	
<b>Emergency, Settling and Burn Pits ONLY:</b> Producing Formation: _____ Number of producing wells on lease: _____ Barrels of fluid produced daily: _____ Does the slope from the tank battery allow all spilled fluids to flow into the pit? <input type="checkbox"/> Yes <input type="checkbox"/> No	<b>Drilling, Workover and Haul-Off Pits ONLY:</b> Type of material utilized in drilling/workover: <b>Drilling Mud</b> Number of working pits to be utilized: <b>1</b> Abandonment procedure: <b>Evaporation and backfill</b> Drill pits must be closed within 365 days of spud date.	
I hereby certify that the above statements are true and correct to the best of my knowledge and belief.		
_____ 5/15/2009 Date	_____ <i>David E. Rice</i> Signature of Applicant or Agent	

15-119-21239-00-00

<b>KCC OFFICE USE ONLY</b>		Steel Pit <input checked="" type="checkbox"/>	RFAC <input checked="" type="checkbox"/>	RFAS <input type="checkbox"/>
Date Received: <b>5/15/09</b>	Permit Number: _____	Permit Date: <b>5/15/09</b>	Lease Inspection: <input type="checkbox"/> Yes <input checked="" type="checkbox"/> No	



Mark Parkinson, Governor  
Thomas E. Wright, Chairman  
Michael C. Moffet, Commissioner  
Joseph F. Harkins, Commissioner

May 15, 2009

Oolite Energy Corp.  
PO Box 9398  
Amarillo TX 79105

RE: Haul-Off Pit Application  
Borth Lease Well No. 1  
NW/4 Sec. 25-33S-30W  
Meade County, Kansas

Dear Sir or Madam:

The Application for Surface Pit (CDP-1) for the above referenced location has been received indicating that steel pits are to be used at this location. **If a haul-off pit is necessary please file form CDP-1, Application for Surface Pit.** This location will have to be inspected prior to approval of the haul-off pit application.

If fluids are taken to an authorized disposal well, please call the District Office at (620) 225-8888. Please file form CDP-5, Exploration and Production Waste Transfer, within 30 days of fluid removal.

Conservation division forms are available through our office and on the KCC web site: [www.kcc.state.ks.us/conservation/forms](http://www.kcc.state.ks.us/conservation/forms).

Sincerely,

Kathy Haynes  
Environmental Protection and Remediation Department

Cc: district

15-119-21239-00-00