

STATE OF KANSAS
STATE CORPORATION COMMISSION

15-195-01105-00-00
WELL PLUGGING RECORD

Give All Information Completely
Make Required Affidavit
Mail or Deliver Report to:
Conservation Division
State Corporation Commission
212 North Market, Insurance Bldg.
Wichita, Kansas

NORTH

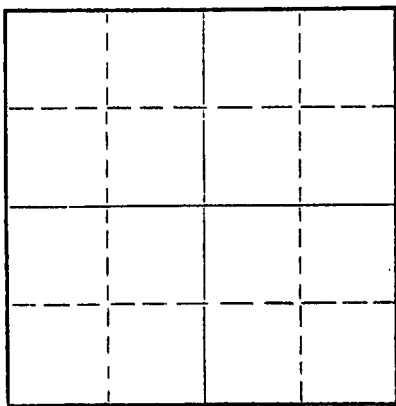

Locate well correctly on above
Section Plat

Trego County. Sec. 17 Twp. 11s Rge. 24w (E) (W)
Location as "NE/CNWxSWx" or footage from lines SW SW
Lease Owner John O. Farmer, Inc.
Lease Name Garrett Well No. # 1
Office Address P.O. Box 352, Russell, Kansas
Character of Well (completed as Oil, Gas or Dry Hole) Dry
Date well completed 6/28 1963
Application for plugging filed 6/28 1963
Application for plugging approved 6/28 1963
Plugging commenced 6/28 1963
Plugging completed 6:30 A.M. 6/28 1963
Reason for abandonment of well or producing formation Dry

If a producing well is abandoned, date of last production 19____
Was permission obtained from the Conservation Division or its agents before plugging was commenced? Yes

Name of Conservation Agent who supervised plugging of this well W. L. Nichols
Producing formation _____ Depth to top _____ Bottom _____ Total Depth of Well 3985 Feet
Show depth and thickness of all water, oil and gas formations.

OIL, GAS OR WATER RECORDS

CASING RECORD

FORMATION	CONTENT	FROM	TO	SIZE	PUT IN	PULLED OUT

Describe in detail the manner in which the well was plugged, indicating where the mud fluid was placed and the method or methods used in introducing it into the hole. If cement or other plugs were used, state the character of same and depth placed, from _____ feet to _____ feet for each plug set.

Plug # 1 540' 20 sx. cement
Plug # 2 140' 20 sx. cement
Plug # 3 40' 10 sx. cement

Completed: 6:30 A.M. 6/28/63

RECEIVED
STATE CORPORATION COMMISSION
7-8-1963
JUL 8 1963

CONSERVATION DIVISION
Wichita, Kansas

Name of Plugging Contractor John O. Farmer, Inc. (If additional description is necessary, use BACK of this sheet)
Address P.O. Box 352, Russell, Kansas

STATE OF KANSAS, COUNTY OF RUSSELL, ss.

John O. Farmer (employee of owner) or (owner or operator) of the above-described well, being first duly sworn on oath, says: That I have knowledge of the facts, statements, and matters herein contained and the log of the above-described well as filed and that the same are true and correct. So help me God.

(Signature)

P.O. Box 352, Russell, Kansas
(Address)

SUBSCRIBED AND SWORN TO before me this 6th day of July, 1963

My commission expires 2/15/67

Helen Carlson

Notary Public.

OPERATOR JOHN O. FARMER, INC.

ADDRESS P.O. Box 352, Russell, Kansas

Give detailed description and thickness of all formation drilled through, contents of sand, whether dry, water, oil or gas.

WELL NO. COUNTY TWP RGE.

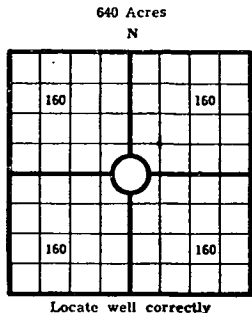

COUNTY Trego SEC 17 TWP 11s RGE 24w
 COMPANY OPERATING John O. Farmer, Inc.
 OFFICE ADDRESS P.O. Box 352, Russell, Kansas
 DRILLING STARTED 6/20, 1963, DRILLING FINISHED 6/28, 1963
 DATE OF FIRST PRODUCTION _____ COMPLETED _____
 WELL LOCATED SW $\frac{1}{4}$ SW $\frac{1}{4}$ _____, North of South
 Line and _____ ft. East of West Line of Quarter Section
 Elevation (Relative to sea level) DERRICK FLOOR 2402' GROUND 2439'
 CHARACTER OF WELL (Oil, gas or dryhole) Dry

OIL OR GAS SANDS OR ZONES

Name	From	To	Name	From	To
1			4		
2			5		
3			6		

Perforating Record If Any

Shot Record

Formation	From	To	No. of Shots	Formation	From	To	Size of Shot

CASING RECORD

Amount Set								Amount Pulled		Packer Record	
Size	Wt.	Thds.	Make	Ft.	In.	Ft.	In.	Size	Length	Depth Set	Make

Liner Record: Amount _____ Kind _____ Top _____ Bottom _____

CEMENTING AND MUDDING

Size	Amount Set		Sacks Cement	Chemical		Method of Cementing	Amount	Mudding Method	Results (See Note)
	Ft.	In.		Gal.	Make				
8 5/8"	147'		125sx.						

Note: What method was used to protect sands if outer strings were pulled? _____

NOTE: Were bottom hole plugs used? _____ If so, state kind, depth set and results obtained _____

TOOLS USED

Rotary Tools were used from 0 feet to R.T.D. Cable tools were used from _____ feet to _____ feet, and from _____ feet to _____ feet, and from _____ feet to _____ feet
 Type Rig Rotary

INITIAL PRODUCTION TEST

Describe initial test: whether by flow through tubing or casing or by pumping _____

Amount of Oil Production _____ bbls. Size of choke, if any _____ Length of test _____ Water Production _____ bbls. Gravity of oil _____ Type of Pump if pump is used, describe _____

Formation	Top	Bottom	Formation	Top	Bottom
Shale	400				
Shale & Sand	400	1060			
Shale	1060	2051			
Shale & Shells	2051	2509			
Shale & Lime	2509	2640			
Lime & Shale	2640	3985'			
Sample tops- No Log Run					
			Heebner	3711	(-1307)
			Toronto	3734	(-1330)
			Lansing	3750	(-1346)
			Base Kansas City	3980	(-1576)
			Total Depth	3985	(-1581)

RECEIVED
 STATE CORPORATION COMMISSION
 7-8-1963
 JUL 8 1963

CONSERVATION DIVISION
 Wichita, Kansas

I, the undersigned, being first duly sworn upon oath, state that this well record is true, correct and complete according to the records of this office and to the best of my knowledge and belief.

John O. Farmer
 Name and title of representative of company
 President

Subscribed and sworn to before me this 6th day of July, 1963

My Commission expires 2/15/67

Helen Carlson

Notary Public.