

STATE OF KANSAS
STATE CORPORATION COMMISSION

WELL PLUGGING RECORD

Give All Information Completely
Make Required Affidavit
Mail or Deliver Report to
Conservation Division
State Corporation Comm.
245 North Water
Wichita, KS 67202

Trego County, Sec. 20 Twp. 11S Rge. 24W E/W
Location as "NE/CNW $\frac{1}{2}$ /SW $\frac{1}{4}$ " or footage from lines
SE NE NE
Lease Owner Mack Oil Company
Lease Name SCHWANBECK Well No. 1
Office Address 908 Union Center, Wichita, KS 67202
Character of Well (Completed as Oil, Gas or Dry Hole)
Dry Hole
Date Well completed 3-15-77 19
Application for plugging filed Yes 19
Application for plugging approved 19
Plugging commenced 19
Plugging completed 2:30 P.M. 3-15-77 19
Reason for abandonment of well or producing formation

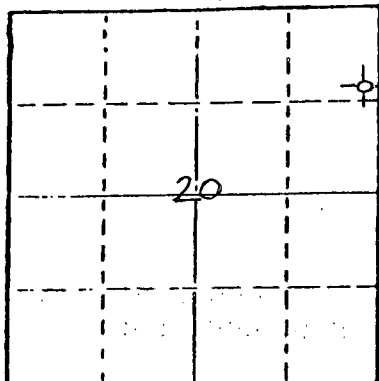

Locate well correctly on above
Section Plat

If a producing well is abandoned, date of last production 19

Was permission obtained from the Conservation Division or
its agents before plugging was commenced? Yes

Name of Conservation Agent who supervised plugging of this well Gilbert Balthazor
Producing formation Depth to top Bottom Total Depth of Well
Show depth and thickness of all water, oil and gas formations.

OIL, GAS OR WATER RECORDS

CASING RECORD

FORMATION	CONTENT	FROM	TO	SIZE	PUT IN	PULLED OUT

Describe in detail the manner in which the well was plugged, indicating where the mud fluid was placed and the method or methods used in introducing it into the hold. If cement or other plugs were used, state the character of same and depth placed, from feet to feet for each plug set.

Plug #1	950'	70 sx. cement
Plug #2	200'	20 sx. cement
Plug #3	40'	10 sx. cement

3-23-1977

(If additional description is necessary, use BACK of this sheet)

Name of Plugging Contractor John O. Farmer, Inc.
P.O. Box 352, Russell, Kansas 67665

STATE OF KANSAS COUNTY OF SEDGWICK ss.

(employee of owner) or (owner or operator) of the above-described well, being first duly sworn on oath, says: That I have knowledge of the facts, statements, and matters herein contained and the log of the above-described well as filed and that the same are true and correct. So help me God.

(Signature) [Signature]
908 Union Center, Wichita, KS 67202

SUBSCRIBED AND SWORN TO before me this 22nd day of March 19 77

My commission expires Jan. 8, 1978

[Signature]
Nancy Laggart Notary Public.

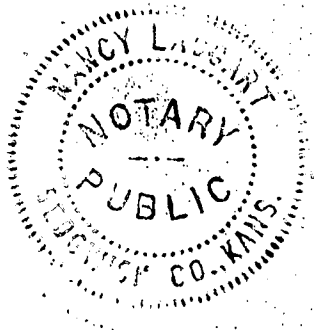

15-195-20400-00-00

KANSAS DRILLERS LOG

API No. 15 — 195 — 20,400 - 00 - 00
County Number

Operator
Mack Oil Company

Address
908 Union Center, Wichita, Kansas 67202

Well No. 1 Lease Name SCHWANBECK

Footage Location
330 feet from (N) line 330 feet from ~~E~~ line

Principal Contractor John O. Farmer, Inc. Geologist

Spud Date 3-7-77 Total Depth 4085 P.B.T.D.

Date Completed 3-15-77 Oil Purchaser None -- D & A

S. 20 T. 11S R. 24 E W

Loc. SE NE NE

County Trego

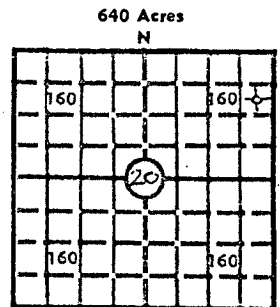

Locate well correctly

Elev.: Gr. 2475

DF 2478 KB 2480

CASING RECORD

Report of all strings set — surface, intermediate, production, etc.

Purpose of string	Size hole drilled	Size casing set (in O.D.)	Weight lbs/ft.	Setting depth	Type cement	Sacks	Type and percent additives
Surface	12 1/4	8-5/8	26	214	Common	170	

LINER RECORD

PERFORATION RECORD

Top, ft.	Bottom, ft.	Sacks cement	Shots per ft.	Size & type	Depth interval

TUBING RECORD

Size	Setting depth	Packer set at

ACID, FRACTURE, SHOT, CEMENT SQUEEZE RECORD

Amount and kind of material used	Depth interval treated
<u>3-23-1977</u>	

INITIAL PRODUCTION

Date of first production		Producing method (flowing, pumping, gas lift, etc.)			
RATE OF PRODUCTION — PER 24 HOURS	Oil	Gas	Water	Gas-oil ratio	
	bbls.	MCF	bbls.	CFPB	
Disposition of gas (vented, used on lease or sold)			Producing interval(s)		

INSTRUCTIONS: As provided in KCC Rule 82-2-125, within 90 days after completion of a well, one completed copy of this Drillers Log shall be transmitted to the State Geological Survey of Kansas, 4150 Monroe Street, Wichita, Kansas 67209. Copies of this form are available from the Conservation Division, State Corporation Commission, 3830 So. Meridian (P.O. Box 17027), Wichita, Kansas 66217. Phone AC 316-522-2206. If confidential custody is desired, please note Rule 82-2-125. Drillers Logs will be on open file in the Oil and Gas Division, State Geological Survey of Kansas, Lawrence, Kansas 66044.

15-195-20400-00-00

Operator Mack Oil Company		DESIGNATE TYPE OF COMP.: OIL, GAS, DRY HOLE, SWDW, ETC.:
Well No. 1	Lease Name SCHWANBECK	Dry Hole
S 20 T 11 S R 25 ^{EX} W 24 W		

WELL LOG

Show all important zones of porosity and contents thereof; cored intervals, and all drill-stem tests, including depth interval tested, cushion used, time tool open, flowing and shut-in pressures, and recoveries.

SHOW GEOLOGICAL MARKERS, LOGS RUN, OR OTHER DESCRIPTIVE INFORMATION.

FORMATION DESCRIPTION, CONTENTS, ETC.	TOP	BOTTOM	NAME	DEPTH
Shale	214	800		
Shale & Sand	800	1610		
Sand	1610	1830		
Red Bed	1830	2075		
Anhydrite	2075	2116		
Shale	2116	2140		
Shale & Shells	2140	2390		
Shale & Lime	2390	3145		
Lime & Shale	3145	3895		
Lime	3895	4085		

3-23-1977

USE ADDITIONAL SHEETS, IF NECESSARY, TO COMPLETE WELL RECORD.

Date Received	<p><i>Nancy Laggart</i> Signature</p> <p><i>Secretary</i> Title</p> <p><i>3-22-77</i> Date</p>
---------------	--