

FOR KCC USE:

15-195-22173-00-00

FORM C-1 7/91

FORM MUST BE TYPED

FORM MUST BE SIGNED

ALL BLANKS MUST BE FILLED

EFFECTIVE DATE: 1-31-96

State of Kansas

DISTRICT # 4

NOTICE OF INTENTION TO DRILL

SGA? Yes No

Must be approved by the K.C.C. five (5) days prior to commencing well

Expected Spud Date 2 - 2 1996
month day year

Spot N/2- N/2- SE.. Sec 2... Twp 11S, Rg .24. X East West

OPERATOR: License # 5123
Name: Pickrell Drilling Company, Inc.
Address: 110 N. Market, Suite 205
City/State/Zip: Wichita, Kansas 67202
Contact Person: Kent Crisler
Phone: 316-262-8427

2310 feet from South line of Section
1320 feet from East line of Section
IS SECTION REGULAR IRREGULAR?

(NOTE: Locate well on the Section Plat on Reverse Side)
County: Trego
Lease Name: Hollandworth "A" Well #: 1
Field Name: Wildcat

CONTRACTOR: License #: 5123
Name: Company Tools

Is this a Prorated/Spaced Field? yes X no
Target Formation(s): Lansing-Kansas City

Well Drilled For: Well Class: Type Equipment:
X Oil ... Enh Rec ... Infield X Mud Rotary
... Gas ... Storage ... Pool Ext. ... Air Rotary
... OWWO ... Disposal X Wildcat ... Cable
... Seismic; ... # of Holes ... Other

Nearest lease or unit boundary: 330'
Ground Surface Elevation: 2330' est. feet MSL
Water well within one-quarter mile: yes X no

If OWWO: old well information as follows:
Operator:
Well Name:
Comp. Date: Old Total Depth

Public water supply well within one mile: yes X no
Depth to bottom of fresh water: 150'
Depth to bottom of usable water: 1040'

Directional, Deviated or Horizontal wellbore? yes X no
If yes, true vertical depth:
Bottom Hole Location:

Surface Pipe by Alternate: 1 X 2
Length of Surface Pipe Planned to be set: 210'
Length of Conductor pipe required: N/A
Projected Total Depth: 390'

Formation at Total Depth: Base Kansas City
Water Source for Drilling Operations:
... well ... farm pond X other

AFFIDAVIT

The undersigned hereby affirms that the drilling, completion and eventual plugging of this well will comply with K.S.A. 35-101, et. seq.

It is agreed that the following minimum requirements will be met:

- 1. Notify the appropriate district office prior to spudding of well;
2. A copy of the approved notice of intent to drill shall be posted on each drilling rig;
3. The minimum amount of surface pipe as specified below shall be set by circulating cement to the top, in all cases surface pipe shall be set through all unconsolidated materials plus a minimum of 20 feet into the underlying formation;
4. If the well is dry hole, an agreement between the operator and the district office on plug length and placement is necessary prior to plugging;
5. The appropriate district office will be notified before well is either plugged or production casing is cemented in;
6. IF AN ALTERNATE II COMPLETION, PRODUCTION PIPE SHALL BE CEMENTED FROM BELOW ANY USABLE WATER TO SURFACE WITHIN 120 DAYS OF SPUD DATE. IN ALL CASES, NOTIFY DISTRICT OFFICE PRIOR TO ANY CEMENTING.

I hereby certify that the statements made herein are true and to the best of my knowledge and belief.

Date: 1-25-96 Signature of Operator or Agent: Kent G. Crisler Title: Geologist

FOR KCC USE:
API # 15- 195-221730000
Conductor pipe required NONE feet
Minimum surface pipe required 200 feet per Alt. 1 (2)
Approved by: JK 1-26-96
This authorization expires: 7-26-96
(This authorization void if drilling not started within 6 months of effective date.)
Spud date: Agent:

REMEMBER TO:

- File Drill Pit Application (form CDP-1) with Intent to Drill;
- File Completion Form ACO-1 within 120 days of spud date;
- File acreage attribution plat according to field proration orders;
- Notify appropriate district office 48 hours prior to workover or re-entry;
- Submit plugging report (CP-4) after plugging is completed;
- Obtain written approval before disposing or injecting salt water.

Mail to: Conservation Division, 200 Colorado Derby Building, 202 W. First St., Wichita, Kansas 67202-1286.

RECEIVED
KANSAS CORPORATION COMMISSION
1-25-1996
JAN 25 1996

CONSERVATION DIVISION

Handwritten initials and marks on the right margin.

IN ALL CASES PLOT THE INTENDED WELL ON THE PLAT BELOW

PLAT OF ACREAGE ATTRIBUTABLE TO A WELL IN A PRORATED OR SPACED FIELD

If the intended well is in a prorated or spaced field, please fully complete this side of the form. If the intended well is in a prorated or spaced field complete the plat below showing that the well will be properly located in relationship to other wells producing from the common source of supply. Please show all the wells within 1 mile of the boundaries of the proposed acreage attribution unit for gas wells and within 1/2 mile of the boundaries of the proposed acreage attribution unit for oil wells.

API NO. 15- _____
 OPERATOR Pickrell Drilling Co. Inc. LOCATION OF WELL: COUNTY Trego
 LEASE Hollandworth "A" 2310 feet from south/north line of section
 WELL NUMBER 1 1320 feet from east/west line of section
 FIELD _____ SECTION 2 TWP 11S RG 24W

NUMBER OF ACRES ATTRIBUTABLE TO WELL 40 IS SECTION X REGULAR or _____ IRREGULAR
 QTR/QTR/QTR OF ACREAGE _____ **IF SECTION IS IRREGULAR, LOCATE WELL FROM NEAREST CORNER BOUNDARY.**

Section corner used: _____ NE _____ NW X SE _____ SW

PLAT

(Show location of the well and shade attributable acreage for prorated or spaced wells.)
 (Show footage to the nearest lease or unit boundary line.)

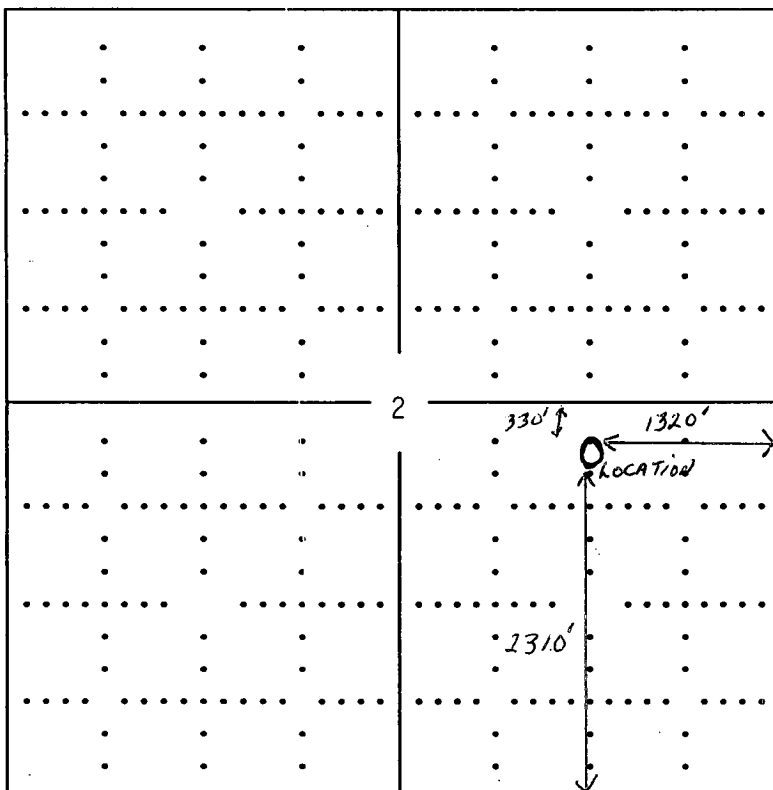

ONE SECTION

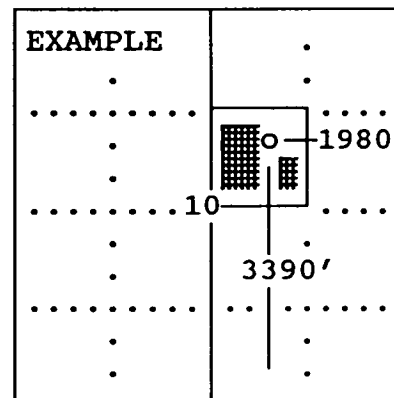

SEWARD CO.

In plotting the proposed location of the well, you must show:

- 1) The manner in which you are using the depicted plat by identifying section lines, i.e. 1 section, 1 section with 8 surrounding sections, 4 sections, etc.;
- 2) the distance of the proposed drilling location from the section's south/north and east/west; and
- 3) the distance to the nearest lease or unit boundary line.