

FOR KCC USE:

15-195-01332-00-01

FORM C-1 7/91

FORM MUST BE TYPED

EFFECTIVE DATE: 7-13-98

State of Kansas

FORM MUST BE SIGNED

DISTRICT # 4

NOTICE OF INTENTION TO DRILL

ALL BLANKS MUST BE FILLED

SGA? Yes X No

Must be approved by the K.C.C. five (5) days prior to commencing

Expected Spud Date July 13, 1998

Spot SW SW NE Sec 26 Twp 11 S Rg 23 East

OPERATOR: License # 5663 Hess Oil Company

2310 feet from North line of Section 2310 feet from East line of Section

CONTRACTOR: License # 4958 Mallard JV, Inc

IS SECTION REGULAR X IRREGULAR? County: Trego

Well Drilled For: Oil, Gas, O.W.O., Seismic, etc.

Lease Name: Mona Well #: 1 O.W.O. Field Name: WaKeeney

If O.W.O.: old well information as follows: Operator: Petroleum, Inc.

Is this a Prorated/Spaced Field? yes X no Target Formation(s): Arbuckle

Directional, Deviated or Horizontal wellbore? yes X no

Nearest lease or unit boundary: 330' Ground Surface Elevation: 2368' est

Bottom Hole Location

Water well within one-quarter mile: yes X no Public water supply well within one mile: yes X no

AFFIDAVIT

The undersigned hereby affirms that the drilling, completion and eventual plugging of this well will comply with K.S.A. 55-101, et. seq.

- 1. Notify the appropriate district office prior to spudding of well; 2. A copy of the approved notice of intent to drill shall be posted on each drilling rig; 3. The minimum amount of surface pipe as specified below shall be set by circulating cement to the top; in all cases surface pipe shall be set through all unconsolidated materials plus a minimum of 20 feet into the underlying formation; 4. If the well is dry hole, an agreement between the operator and the district office on plug length and placement is necessary prior to plugging; 5. The appropriate district office will be notified before well is either plugged or production casing is cemented in; 6. IF AN ALTERNATE II COMPLETION, PRODUCTION PIPE SHALL BE CEMENTED FROM BELOW ANY USABLE WATER TO SURFACE WITHIN 120 DAYS OF SPUD DATE. IN ALL CASES, NOTIFY DISTRICT OFFICE PRIOR TO ANY CEMENTING.

I hereby certify that the statements made herein are true and to the best of my knowledge and belief. Date: 7/1/98 Signature of Operator or Agent: Bryan Hess, Mgr.

FOR KCC USE: API # 15- 195-013320001 Conductor pipe required NONE feet Minimum surface pipe required 205 feet per Alt. X(2) Approved by: JK 7-8-98 This authorization expires: 1-8-99 (This authorization void if drilling not started within 6 months of effective date.) Spud date: Agent:

REMEMBER TO:

- File Drill Pit Application (form CDP-1) with Intent to Drill; - File Completion Form ACO-1 within 120 days of spud date; - File acreage attribution plat according to field proration orders; - Notify appropriate district office 48 hours prior to workover or re-entry; - Submit plugging report (CP-4) after plugging is completed; - Obtain written approval before disposing or injecting salt water.

Mail to: KCC - Conservation Division, 130 S. Market - Room 2078, Wichita, Kansas 67202.

26 11 23W

**IN ALL CASES PLOT THE INTENDED WELL ON THE PLAT BELOW**

**PLAT OF ACREAGE ATTRIBUTABLE TO A WELL IN A PRORATED OR SPACED FIELD**

**If the intended well is in a prorated or spaced field, please fully complete this side of the form.** If the intended well is in a prorated or spaced field complete the plat below showing that the well will be properly located in relationship to other wells producing from the common source of supply. Please show all the wells within 1 mile of the boundaries of the proposed acreage attribution unit for gas wells and within 1/2 mile of the boundaries of the proposed acreage attribution unit for oil wells.

API NO. 15- \_\_\_\_\_  
 OPERATOR Hess Oil Company LOCATION OF WELL: COUNTY Trego  
 LEASE Mona 2310 feet from /North line of section  
 WELL NUMBER 1 OWWO 2310 feet from East/ line of section  
 FIELD \_\_\_\_\_ SECTION 26 TWP 11 RG 23 W

NUMBER OF ACRES ATTRIBUTABLE TO WELL \_\_\_\_\_ IS SECTION X REGULAR or \_\_\_\_\_ IRREGULAR  
 QTR/QTR/QTR OF ACREAGE \_\_\_\_\_ IF SECTION IS IRREGULAR, LOCATE WELL FROM NEAREST CORNER BOUNDARY.  
 Section corner used: \_\_\_\_\_ NE \_\_\_\_\_ NW \_\_\_\_\_ SE \_\_\_\_\_ SW

**PLAT**

(Show location of the well and shade attributable acreage for prorated or spaced wells.)  
 (Show footage to the nearest lease or unit boundary line.)

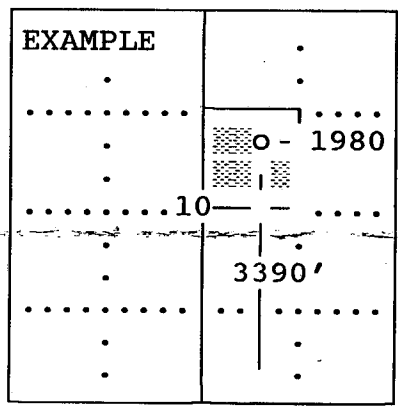
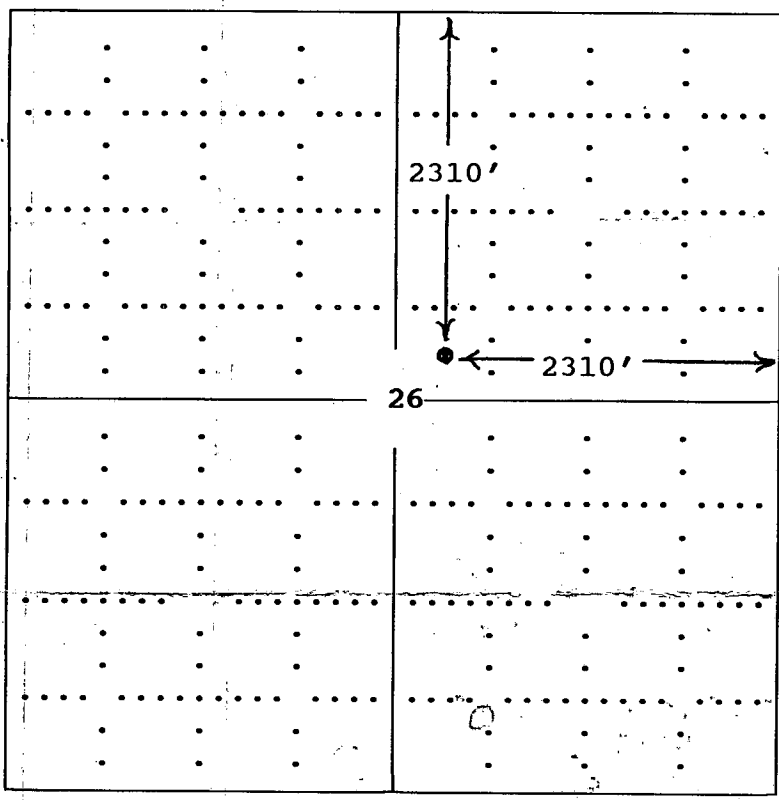

SEWARD CO.

**In plotting the proposed location of the well, you must show:**

- 1) The manner in which you are using the depicted plat by identifying section lines, i.e. 1 section, 1 section with 8 surrounding sections, 4 sections, etc.;
- 2) the distance of the proposed drilling location from the section's south/north and east/west; and
- 3) the distance to the nearest lease or unit boundary line.