

15-193-20060-0000

**KANSAS DRILLERS LOG**

API No. 15 — 193 — 20,060  
County Number

S. 33 T. 10S R. 31 <sup>W</sup>

Loc. C SW NE

County Thomas

Operator

Abercrombie Drilling, Inc.

Address

801 Union Center, Wichita, Kansas 67202

Well No.

#1

Lease Name

MILLER ESTATE

Footage Location

1980

feet from (N) <sup>X</sup> line

1980

feet from (E) (W) line

Principal Contractor

Abercrombie Drilling, Inc.

Geologist

Jack K. Wharton

Spud Date

September 13, 1975

Total Depth

4640'

P.B.T.D.

Date Completed

September 22, 1975

Oil Purchaser

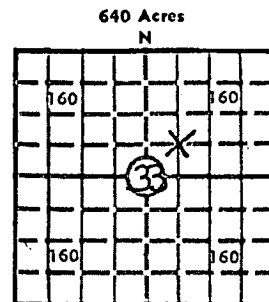

Locate well correctly

Elev.: Gr. 2939'

DF 2941'

KB 2944'

**CASING RECORD**

Report of all strings set — surface, intermediate, production, etc.

Purpose of string	Size hole drilled	Size casing set (in O.D.)	Weight lbs/ft.	Setting depth	Type cement	Sacks	Type and percent additives
Surface	12 1/2"	8 5/8"		200.82	Sunset	165	None

**LINER RECORD**

**PERFORATION RECORD**

Top, ft.	Bottom, ft.	Sacks cement	Shots per ft.	Size & type	Depth interval

**TUBING RECORD**

Size	Setting depth	Packer set at

**ACID, FRACTURE, SHOT, CEMENT SQUEEZE RECORD**

Amount and kind of material used	Depth interval treated
	9-25-75

**INITIAL PRODUCTION**

Date of first production		Producing method (flowing, pumping, gas lift, etc.)			
RATE OF PRODUCTION PER 24 HOURS	Oil	Gas	Water	Gas-oil ratio	
	bbbls.	MCF	bbbls.	CFPB	
Disposition of gas (vented, used on lease or sold)			Producing interval(s)		

INSTRUCTIONS: As provided in KCC Rule 82-2-125, within 90 days after completion of a well, one completed copy of this Drillers Log shall be transmitted to the State Geological Survey of Kansas, 4150 Monroe Street, Wichita, Kansas 67209. Copies of this form are available from the Conservation Division, State Corporation Commission, 3830 So. Meridian (P.O. Box 17027), Wichita, Kansas 66217. Phone AC 316-522-2206. If confidential custody is desired, please note Rule 82-2-125. Drillers Logs will be on open file in the Oil and Gas Division, State Geological Survey of Kansas, Lawrence, Kansas 66044.

Operator Abercrombie Drilling, Inc.		DESIGNATE TYPE OF COMP.: OIL, GAS, DRY HOLE, SWDW, ETC.:
Well No. #1	Lease Name MILLER ESTATE	DRY HOLE
S 33 T 10S R 31 E W		

**WELL LOG**

Show all important zones of porosity and contents thereof; cored intervals, and all drill-stem tests, including depth interval tested, cushion used, time tool open, flowing and shut-in pressures, and recoveries.

SHOW GEOLOGICAL MARKERS, LOGS RUN, OR OTHER DESCRIPTIVE INFORMATION.

FORMATION DESCRIPTION, CONTENTS, ETC.	TOP	BOTTOM	NAME	DEPTH
Clay and Sand	0	150	<u>ELECTRIC LOG</u>	<u>TOPS:</u>
Shale	150	175		
Cement, Sand & Shale	175	278	Anhydrite	2478
Shale	278	1440	B/Anhydrite	2504
Shale & Sand	1440	2645	Heebner	3946
Shale & Lime	2645	3485	Toronto	3968
Lime & Shale	3485	4020	Lansing	3990
Lime	4020	4640	B/Kansas City	4264
Rotary Total Depth		4640	Pawnee Lime	4390
			Fort Scott	4456
			Cherokee Lime	4487
			Cherokee Sand	4541
			Mississippi	4580
			RTD	4640
			ELTD	4639
<p>DST #1 (4110'-4165') 30", 30", 30", 30"            Rec. 5' drilling mud. IFP 35-35#; IBHP 916#; FFP 59-59#; FBHP 834#.</p> <p>DST #2 (4166'-4195') 30", 45", 30", 45"            Weak blow for 30 min. Rec. 65' drlg. mud. IFP 0-0#; IBHP 962#; FFP 11-11#; FBHP 916#.</p> <p>DST #3 (4430'-4450') 30", 30", 30", 30"            Rec. 5' OCM. Weak blow for 20 min. IFP 11-11#; IBHP 857#; FFP 11-11#; FBHP 822#.</p>				

USE ADDITIONAL SHEETS, IF NECESSARY, TO COMPLETE WELL RECORD.

Date Received	 Jerry A. Langrehr Exec. Vice President
	Signature
	Title
	September 24, 1975 Date