

CORRECTED AS TO FOOTAGE FEL

\*6-1-2009  
**CORRECTED**

For KCC Use:  
Effective Date: 5-19-2009  
District # 1  
SGA?  Yes  No

**KANSAS CORPORATION COMMISSION  
OIL & GAS CONSERVATION DIVISION**

Form C-1  
October 2007  
Form must be Typed  
Form must be Signed  
All blanks must be Filled

**NOTICE OF INTENT TO DRILL**

Must be approved by KCC five (5) days prior to commencing well

Expected Spud Date: May 22 2009  
month day year

Spot Description:  
NE - NE - SE Sec. 26 Twp. 25 S. R. 24  E  W  
(or) 2290 feet from  N /  S Line of Section  
\* 355 feet from  E /  W Line of Section  
Is SECTION:  Regular  Irregular?

OPERATOR: License# 31093  
Name: Becker Oil Corporation  
Address 1: P. O. Box 1150  
Address 2:  
City: Ponca City State: OK Zip: 74602  
Contact Person: Clyde M. Becker, Jr.  
Phone: 303-816-2013

(Note: Locate well on the Section Plat on reverse side)  
County: Ford  
Lease Name: Lix Well #: 1  
Field Name:

CONTRACTOR: License# 5142  
Name: Sterling Drilling Company

Is this a Prorated / Spaced Field?  Yes  No  
Target Formation(s): Cherokee-Morrow

Well Drilled For:  Oil  Gas  Seismic; # of Holes  Other:  
Well Class:  Enh Rec  Storage  Disposal  Wildcat  Other:  
Type Equipment:  Mud Rotary  Air Rotary  Cable

\* Nearest Lease or unit boundary line (in footage): 355'  
Ground Surface Elevation: 2447 feet MSL  
Water well within one-quarter mile:  Yes  No  
Public water supply well within one mile:  Yes  No  
Depth to bottom of fresh water: 180'  
Depth to bottom of usable water: 250'  
Surface Pipe by Alternate:  I  II  
Length of Surface Pipe Planned to be set: 325'

If OWWO: old well information as follows:  
Operator:  
Well Name:  
Original Completion Date: Original Total Depth:

Length of Conductor Pipe (if any):  
Projected Total Depth: 4975'  
Formation at Total Depth: Mississippian

Directional, Deviated or Horizontal wellbore?  Yes  No  
If Yes, true vertical depth:

Water Source for Drilling Operations:  
 Well  Farm Pond  Other:  
DWR Permit #:

Bottom Hole Location:  
KCC DKT #:

(Note: Apply for Permit with DWR)   
Will Cores be taken?  Yes  No  
If Yes, proposed zone:

\* WAS: 335' FEL ; NLUB : 335'  
IS: 355' FEL ; NLUB : 355'

**AFFIDAVIT**

The undersigned hereby affirms that the drilling, completion and eventual plugging of this well will comply with K.S.A. 55 et. seq.  
It is agreed that the following minimum requirements will be met:

RECEIVED  
MAY 20 2009  
KCC WICHITA

- 1. Notify the appropriate district office **prior** to spudding of well;
- 2. A copy of the approved notice of intent to drill **shall be** posted on each drilling rig;
- 3. The minimum amount of surface pipe as specified below **shall be set** by circulating cement to the top; in all cases surface pipe **shall be set** through all unconsolidated materials plus a minimum of 20 feet into the underlying formation.
- 4. If the well is dry hole, an agreement between the operator and the district office on plug length and placement is necessary **prior to plugging**;
- 5. The appropriate district office will be notified before well is either plugged or production casing is cemented in;
- 6. If an ALTERNATE II COMPLETION, production pipe shall be cemented from below any usable water to surface within **120 DAYS** of spud date.  
Or pursuant to Appendix "B" - Eastern Kansas surface casing order #133,891-C, which applies to the KCC District 3 area, alternate II cementing must be completed within 30 days of the spud date or the well shall be plugged. **In all cases, NOTIFY district office** prior to any cementing.

I hereby certify that the statements made herein are true and correct to the best of my knowledge and belief.

Date: 5/22/09 Signature of Operator or Agent: Clyde M. Becker, Jr. Title: President

**For KCC Use ONLY**  
API # 15 - D57-20633-0000  
Conductor pipe required None feet  
Minimum surface pipe required 200 feet per ALT.  I  II  
Approved by: 5-14-2009 / Perm 6-1-2009  
This authorization expires: 5-14-2010  
(This authorization void if drilling not started within 12 months of approval date.)  
Spud date: Agent:

**Remember to:**  
- File Drill Pit Application (form CDP-1) with Intent to Drill;  
- File Completion Form ACO-1 within 120 days of spud date;  
- File acreage attribution plat according to field proration orders;  
- Notify appropriate district office 48 hours prior to workover or re-entry;  
- Submit plugging report (CP-4) after plugging is completed (within 60 days);  
- Obtain written approval before disposing or injecting salt water.  
- If this permit has expired (See: authorized expiration date) please check the box below and return to the address below.  
 Well Not Drilled - Permit Expired Date: Signature of Operator or Agent:

Mail to: KCC - Conservation Division, 130 S. Market - Room 2078, Wichita, Kansas 67202

**CORRECTED**

**IN ALL CASES PLOT THE INTENDED WELL ON THE PLAT BELOW**

*Plat of acreage attributable to a well in a prorated or spaced field*

*If the intended well is in a prorated or spaced field, please fully complete this side of the form.* If the intended well is in a prorated or spaced field complete the plat below showing that the well will be properly located in relationship to other wells producing from the common source of supply. Please show all the wells and within 1 mile of the boundaries of the proposed acreage attribution unit for gas wells and within 1/2 mile of the boundaries of the proposed acreage attribution unit for oil wells.

API No. 15 - 057-20633-0000  
Operator: Becker Oil Corporation  
Lease: Lix  
Well Number: 1  
Field: \_\_\_\_\_

Location of Well: County: Ford  
2290 feet from  N /  S Line of Section  
355 feet from  E /  W Line of Section  
Sec. 26 Twp. 25 S. R. 24  E  W

Number of Acres attributable to well: \_\_\_\_\_  
QTR/QTR/QTR/QTR of acreage: \_\_\_\_\_ - NE - NE - SE

Is Section:  Regular or  Irregular

**If Section is Irregular, locate well from nearest corner boundary.**

Section corner used:  NE  NW  SE  SW

**PLAT**

*(Show location of the well and shade attributable acreage for prorated or spaced wells.)  
(Show footage to the nearest lease or unit boundary line.)*

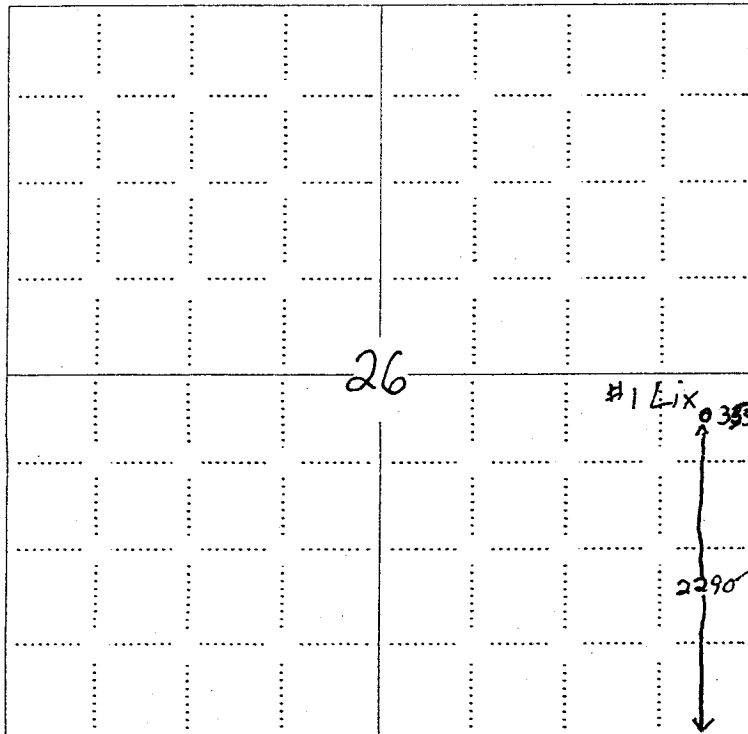

**NOTE: In all cases locate the spot of the proposed drilling location.**

RECEIVED  
MAY 28 2009  
KCC WICHITA

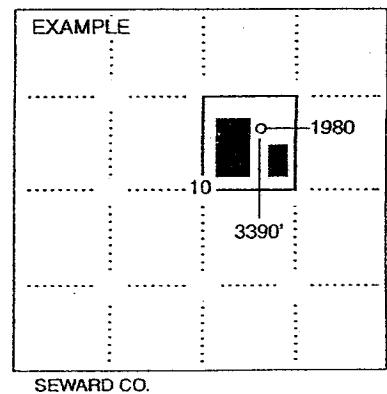

**In plotting the proposed location of the well, you must show:**

1. The manner in which you are using the depicted plat by identifying section lines, i.e. 1 section, 1 section with 8 surrounding sections, 4 sections, etc.
2. The distance of the proposed drilling location from the south / north and east / west outside section lines.
3. The distance to the nearest lease or unit boundary line (in footage).
4. If proposed location is located within a prorated or spaced field a certificate of acreage attribution plat must be attached: (CO-7 for oil wells; CG-8 for gas wells).

CORRECTED  
 OIL & GAS CONSERVATION DIVISION  
**APPLICATION FOR SURFACE PIT**

Form OGP-1  
 April 2004  
 Form must be typed

*Submit in Duplicate*

CORRECTED

Operator Name: <b>Becker Oil Corporation</b>		License Number: <b>310901</b>	
Operator Address: <b>P. O. Box 1150, Ponca City, OK 74602</b>			
Contact Person: <b>Clyde M. Becker, Jr.</b>		Phone Number: <b>303-816-2013</b>	
Lease Name & Well No.: <b>Lix #1</b>		Pit Location (QQQQ) _____ NE _____ NE _____ SE Sec. <u>26</u> Twp. <u>26</u> R. <u>24</u> <input type="checkbox"/> East <input checked="" type="checkbox"/> West <u>2,290</u> Feet from <input type="checkbox"/> North / <input checked="" type="checkbox"/> South Line of Section <u>355</u> Feet from <input checked="" type="checkbox"/> East / <input type="checkbox"/> West Line of Section <b>Ford</b> County	
Type of Pit: <input type="checkbox"/> Emergency Pit <input type="checkbox"/> Burn Pit <input type="checkbox"/> Settling Pit <input checked="" type="checkbox"/> Drilling Pit <input type="checkbox"/> Workover Pit <input type="checkbox"/> Haul-Off Pit <small>(If WP Supply API No. or Year Drilled)</small>		Pit is: <input checked="" type="checkbox"/> Proposed <input type="checkbox"/> Existing If Existing, date constructed: _____ Pit capacity: <b>1,800</b> (bbls)	
Is the pit located in a Sensitive Ground Water Area? <input type="checkbox"/> Yes <input checked="" type="checkbox"/> No		Chloride concentration: _____ mg/l <small>(For Emergency Pits and Settling Pits only)</small>	
Is the bottom below ground level? <input checked="" type="checkbox"/> Yes <input type="checkbox"/> No		Artificial Liner? <input type="checkbox"/> Yes <input checked="" type="checkbox"/> No	
Pit dimensions (all but working pits): <u>60</u> Length (feet) <u>60</u> Width (feet)		N/A: Steel Pits <input type="checkbox"/>	
Depth from ground level to deepest point: <u>3</u> (feet)		No Pit <input type="checkbox"/>	
If the pit is lined give a brief description of the liner material, thickness and installation procedure.		Describe procedures for periodic maintenance and determining liner integrity, including any special monitoring.	
Distance to nearest water well within one-mile of pit: <u>3284</u> feet    Depth of water well <u>60</u> feet		Depth to shallowest fresh water <u>25</u> feet. Source of information: <input type="checkbox"/> measured <input type="checkbox"/> well owner <input type="checkbox"/> electric log <input type="checkbox"/> KDWR	
<b>Emergency, Settling and Burn Pits ONLY:</b> Producing Formation: _____ Number of producing wells on lease: _____ Barrels of fluid produced daily: _____ Does the slope from the tank battery allow all spilled fluids to flow into the pit? <input type="checkbox"/> Yes <input type="checkbox"/> No		<b>Drilling, Workover and Haul-Off Pits ONLY:</b> Type of material utilized in drilling/workover: <u>starch mud</u> Number of working pits to be utilized: <u>2</u> Abandonment procedure: <u>evaporate, back-fill and replace top soil</u> Drill pits must be closed within 365 days of spud date.	
I hereby certify that the above statements are true and correct to the best of my knowledge and belief.			
<u>5/28/09</u> Date		<i>Clyde M. Becker Jr</i> Signature of Applicant or Agent	
<b>KCC OFFICE USE ONLY</b>			
Date Received: <u>6/1/09</u>		Permit Number: _____ Permit Date: <u>6/1/09</u>	
Lease Inspection: <input type="checkbox"/> Yes <input checked="" type="checkbox"/> No		Steel Pit <input type="checkbox"/> RFAC <input type="checkbox"/> RFAS <input type="checkbox"/>	

15-057-20633-09-00