

For KCC Use: 3-11-03
Effective Date: 4
District #: _____
SGA? Yes No

KANSAS CORPORATION COMMISSION
OIL & GAS CONSERVATION DIVISION
NOTICE OF INTENT TO DRILL

Form C-1
September 1999
Form must be Typed
Form must be Signed
All blanks must be Filled

Must be approved by KCC five (5) days prior to commencing well

Expected Spud Date 3 16 2003
month day year

Spot East West
SE NE NE Sec. 17 Twp. 11 S. R. 30
900 feet from N (circle one) Line of Section
100 feet from E (circle one) Line of Section
Is SECTION Regular Irregular?

OPERATOR: License# 9860
Name: Castle Resources Inc.
Address: PO Box 87
City/State/Zip: Schoenchen, KS 67667
Contact Person: Jerry Green
Phone: 785-625-5155

(Note: Locate well on the Section Plat on reverse side)
County: GOVE
Lease Name: Lockwood-Richmeier Well #: 1
Field Name: wildcat
Is this a Prorated / Spaced Field? Yes No

CONTRACTOR: License# 6039
Name: L.D. Drilling, Inc.

Target Formation(s): Basal Pennsylvania
Nearest Lease or unit boundary: 900' (Unit)
Ground Surface Elevation: 2900 feet MSL
Water well within one-quarter mile: Yes No
Public water supply well within one mile: Yes No
Depth to bottom of fresh water: 200'
Depth to bottom of usable water: 1650'
Surface Pipe by Alternate: 1 X2
Length of Surface Pipe Planned to be set: 250'
Length of Conductor Pipe required: NONE
Projected Total Depth: 4600'
Formation at Total Depth: Cherokee
Water Source for Drilling Operations:
Well _____ Farm Pond Other
DWR Permit #: _____

Well Drilled For: Oil Gas OWWO Seismic; # of Holes _____ Other _____
Well Class: Enh Rec Storage Disposal Infield Pool Ext. Wildcat Other _____
Type Equipment: Mud Rotary Air Rotary Cable

If OWWO: old well information as follows:
Operator: _____
Well Name: _____
Original Completion Date: _____ Original Total Depth: _____

Directional, Deviated or Horizontal wellbore? Yes No
If Yes, true vertical depth: _____
Bottom Hole Location: _____

KCC DKT #: _____

(Note: Apply for Permit with DWR)
Will Cores be taken? Yes No
If Yes, proposed zone: _____

AFFIDAVIT

The undersigned hereby affirms that the drilling, completion and eventual plugging of this well will comply with K.S.A. 55-101, et seq. It is agreed that the following minimum requirements will be met:

1. Notify the appropriate district office prior to spudding of well;
2. A copy of the approved notice of intent to drill shall be posted on each drilling rig;
3. The minimum amount of surface pipe as specified below shall be set by circulating cement to the top; in all cases surface pipe shall be set through all unconsolidated materials plus a minimum of 20 feet into the underlying formation.
4. If the well is dry hole, an agreement between the operator and the district office on plug length and placement is necessary prior to plugging;
5. The appropriate district office will be notified before well is either plugged or production casing is cemented in;
6. If an ALTERNATE II COMPLETION, production pipe shall be cemented from below any usable water to surface within 120 days of spud date. In all cases, NOTIFY district office prior to any cementing.

I hereby certify that the statements made herein are true and to the best of my knowledge and belief.

Date: 3-3-03 Signature of Operator or Agent: _____ Title: President

For KCC Use ONLY
API # 15 - 063-21576-00-00
Conductor pipe required NONE feet
Minimum surface pipe required 250 feet per Alt. 2
Approved by: BSP 3-6-03
This authorization expires: 9-6-03
(This authorization void if drilling not started within 6 months of effective date.)
Spud date: _____ Agent: _____

- Remember to:
- File Drill Pit Application (form CDP-1) with Intent to Drill;
 - File Completion Form ACO-1 within 120 days of spud date;
 - File acreage attribution plat according to field proration orders;
 - Notify appropriate district office 48 hours prior to workover or re-entry;
 - Submit plugging report (CP-4) after plugging is completed;
 - Obtain written approval before disposing or injecting salt water.

MAR 05 2003
3-5-2003
KCC WICHITA

17 11 30

IN ALL CASES PLOT THE INTENDED WELL ON THE PLAT BELOW

Plat of acreage attributable to a well in a prorated or spaced field

If the intended well is in a prorated or spaced field, please fully complete this side of the form. If the intended well is in a prorated or spaced field complete the plat below showing that the well will be properly located in relationship to other wells producing from the common source of supply. Please show all the wells and within 1 mile of the boundaries of the proposed acreage attribution unit for gas wells and within 1/2 mile of the boundaries of the proposed acreage attribution unit for oil wells.

API No. 15 - _____

Operator: Castle Resources Inc.

Lease: Lockwood-Richmeier

Well Number: 1

Field: wildcat

Number of Acres attributable to well: _____

QTR / QTR / QTR of acreage: _____

Location of Well: County: Gove

900 feet from S / N (circle one) Line of Section

100 feet from E / W (circle one) Line of Section

Sec. 17 Twp. 11 S. R. 30 East West

Is Section X Regular or _____ Irregular

If Section is Irregular, locate well from nearest corner boundary.

Section corner used: _____ NE _____ NW _____ SE _____ SW

PLAT

(Show location of the well and shade attributable acreage for prorated or spaced wells.)

(Show footage to the nearest lease or unit boundary line.)

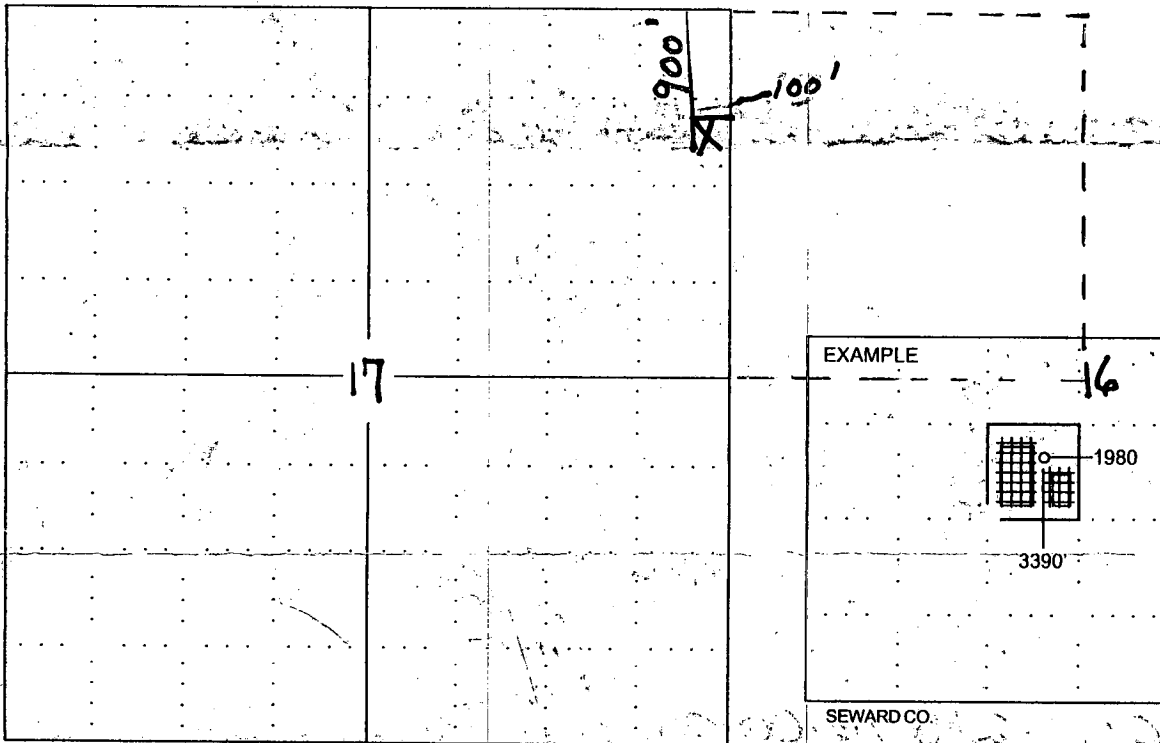

NOTE: In all cases locate the spot of the proposed drilling location.

In plotting the proposed location of the well, you must show:

1. The manner in which you are using the depicted plat by identifying section lines, i.e. 1 section, 4 sections, etc.
2. The distance of the proposed drilling location from the section's south / north and east / west.
3. The distance to the nearest lease or unit boundary line.
4. If proposed location is located within a prorated or spaced field a certificate of acreage attribution plat must be attached: (C0-7 for oil wells; CG-8 for gas wells).