

STATE CORPORATION COMMISSION OF KANSAS  
OIL & GAS CONSERVATION DIVISION  
WELL COMPLETION OR RECOMPLETION FORM  
ACO-1 WELL HISTORY  
DESCRIPTION OF WELL AND LEASE

S

API NO. 15-195-21,886-00-00  
County Trego  
SE NW NW Sec. 32 Twp. 11 Rge. 24 East  
..... West

Operator: License # 9067  
Name DaMar Resources, Inc.  
Address Box 70  
City/State/Zip Hays, KS 67601

4290 Ft North from Southeast Corner of Section  
4290 Ft West from Southeast Corner of Section  
(Note: Locate well in section plat below)

Purchaser.....

Lease Name Armbrister Well # 1

Field Name.....

Operator Contact Person Dan Schippers  
Phone 913 625-0020

Producing Formation.....

Elevation: Ground 2531' KB 2536'

Contractor: License # 8241  
Name Emphasis Oil Operations

Wellsite Geologist Curtis R. Longpine  
Phone (913) 625-0020

Designate Type of Completion  
 New Well  Re-Entry  Workover  
 Oil  SWD  Temp Abd  
 Gas  Inj  Delayed Comp.  
 Dry  Other (Core, Water Supply etc.)

If OWWO: old well info as follows:  
Operator.....  
Well Name.....  
Comp. Date.....Old Total Depth.....

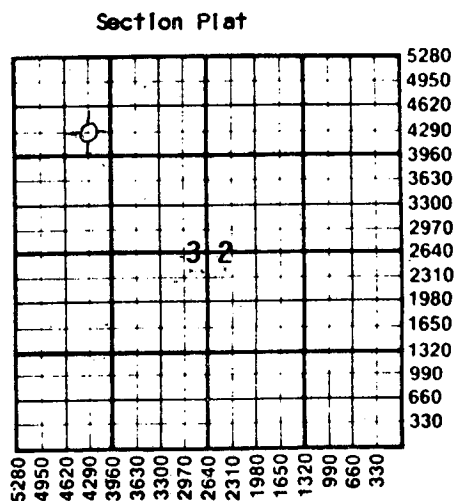

WATER SUPPLY INFORMATION  
Disposition of Produced Water:  Disposal  
Docket # .....  Repressuring

WELL HISTORY  
Drilling Method:  
 Mud Rotary  Air Rotary  Cable  
.....11/25/86 .....12/03/86 .....12/03/86  
Spud Date Date Reached TD Completion Date  
.....4128' .....  
Total Depth PBTB

Questions on this portion of the ACO-1 call:  
Water Resources Board (913) 296-3717  
Source of Water:  
Division of Water Resources Permit #.....  
 Groundwater.....Ft North from Southeast Corner  
(Well) .....Ft West from Southeast Corner of  
Sec Twp Rge East West  
 Surface Water 600 Ft North from Southeast Corner  
(Stream, pond etc) 1100 Ft West from Southeast Corner  
Sec 25 Twp 11S Rge 25 East  West  
 Other (explain).....  
(purchased from city, R.W.D. #)

Amount of Surface Pipe Set and Cemented at 217 feet  
Multiple Stage Cementing Collar Used?  Yes  No  
If yes, show depth set.....feet  
If alternate 2 completion, cement circulated  
from.....feet depth to.....w/.....SX cmt  
Cement Company Name.....  
Invoice #.....

INSTRUCTIONS: This form shall be completed in duplicate and filed with the Kansas Corporation Commission, 200 Colorado Derby Building, Wichita, Kansas 67202, within 90 days after completion or recompletion of any well. Rule 82-3-130 and 82-3-107 apply.  
Information on side two of this form will be held confidential for a period of 12 months if requested in writing and submitted with the form. See rule 82-3-107 for confidentiality in excess of 12 months.  
One copy of all wireline logs and drillers time log shall be attached with this form. Submit CP-4 form with all plugged wells. Submit CP-111 form with all temporarily abandoned wells.

All requirements of the statutes, rules and regulations promulgated to regulate the oil and gas industry have been fully complied with and the statements herein are complete and correct to the best of my knowledge.

Signature *Paul J. Johnson*  
Title President Date 12-18-86

Subscribed and sworn to before me this 18th day of December 1986.  
Notary Public *Darlene Pearson*

Date Commission Expires 7-10-89

K.C.C. OFFICE USE ONLY  
F  Letter of Confidentiality Attached  
C  Wireline Log Received  
C  Drillers Timelog Received  
Distribution  
 KCC  SWD/Rep  NGPA  
 KGS  Plug  Other  
(Specify)

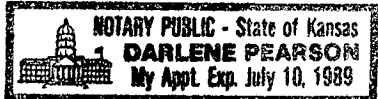

Sec 32 Twp. 11. Rge 24 E

**SIDE TWO**

Operator Name DaMar Resources, Inc. Lease Name Armbrister Well # 1

Sec. 32 Twp. 11S Rge. 24  East  West County Trego

**WELL LOG**

**INSTRUCTIONS: Show important tops and base of formations penetrated. Detail all cores. Report all drill stem tests giving interval tested, time tool open and closed, flowing and shut-in pressures, whether shut-in pressure reached static level, hydrostatic pressures, bottom hole temperature, fluid recovery, and flow rates if gas to surface during test. Attach extra sheet if more space is needed. Attach copy of log.**

Drill Stem Tests Taken  Yes  No  
 Samples Sent to Geological Survey  Yes  No  
 Cores Taken  Yes  No

DST #1 - 3877 - 3906 (A, B)  
 60-45-60-45  
 ISIP - 1258 FSIP - 1238  
 IFP - 78-87 FFP - 87-107  
 Recovery: 135' MW

DST #2 - 4032 - 4058 (Z)  
 30-45-30-30  
 ISIP - 40 FSIP - 29  
 IFP - 29-29 FFP - 29-29  
 Recovery: 5' mud

DST #3 - 4055 - 4076 (J)  
 30-30-30-30  
 ISIP - 48 FSIP - 48  
 IFP - 48-48 FFP - 48-48  
 Recovery: 25' mud

Name	Formation Description	
	Top	Bottom
Topeka	3624	(-1088)
Heebner	3846	(-1310)
Toronto	3868	(-1332)
Lansing-K.C.	3882	(-1346)
L.T.D.	4128	(-1592)
R.T.D.	4128	(-1592)

**CASING RECORD**  New  Used  
 Report all strings set-conductor, surface, intermediate, production, etc.

Purpose of String	Size Hole Drilled	Size Casing Set (in O.D.)	Weight Lbs/Ft.	Setting Depth	Type of Cement	#Sacks Used	Type and Percent Additives
Surface	12 1/4"	8-5/8"	20#	217'	60/40 port	140	3% c.c. 2% gel.

PERFORATION RECORD		Acid, Fracture, Shot, Cement Squeeze Record	
Shots Per Foot	Specify Footage of Each Interval Perforated	(Amount and Kind of Material Used)	Depth

**TUBING RECORD** Size Set At Packer at Liner Run  Yes  No

Date of First Production Producing Method  
 Flowing  Pumping  Gas Lift  Other (explain).....

Estimated Production Per 24 Hours	Oil Bbls	Gas MCF	Water Bbls	Gas-Oil Ratio CFPB	Gravity

**METHOD OF COMPLETION** Production Interval

Disposition of gas:  Vented  Open Hole  Perforation  
 Sold  Other (Specify) .....  
 Used on Lease

Dually Completed  
 Commingled

STATE CORPORATION COMMISSION

DEC 19 1986  
 12-19-1986  
 CONSERVATION DIVISION  
 Wichita, Kansas