

KANSAS CORPORATION COMMISSION  
OIL & GAS CONSERVATION DIVISION  
**WELL PLUGGING APPLICATION**  
Please TYPE Form and File ONE Copy

Form CP-1  
March 2009  
This Form must be Typed  
Form must be Signed  
All blanks must be Filled

OPERATOR: License #: 5817  
Name: Benson Mineral Group, Inc  
Address 1: 1560 Broadway, Suite 1900  
Address 2: \_\_\_\_\_  
City: Denver State: CO Zip: 80202 + \_\_\_\_\_  
Contact Person: Bruce D. Benson  
Phone: (303) 863-3500

API No. 15 - 127-20135 - 0000  
If pre 1967, supply original completion date: \_\_\_\_\_  
Spot Description: Center of the Southwest Quarter  
C - SW Sec. 11 Twp. 16 S. R. 7  East  West  
1,320 Feet from  North /  South Line of Section  
1,320 Feet from  East /  West Line of Section  
Footages Calculated from Nearest Outside Section Corner:  
 NE  NW  SE  SW  
County: Morris  
Lease Name: Leeds Well #: 1-11

Check One:  Oil Well  Gas Well  OG  D&A  Cathodic  Water Supply Well  Other: \_\_\_\_\_  
 SWD Permit #: \_\_\_\_\_  ENHR Permit #: \_\_\_\_\_  Gas Storage Permit #: \_\_\_\_\_  
Conductor Casing Size: \_\_\_\_\_ Set at: \_\_\_\_\_ Cemented with: \_\_\_\_\_ Sacks  
Surface Casing Size: 7" Set at: 50' Cemented with: 168 Sacks  
Production Casing Size: 2 7/8" Set at: 1487' Cemented with: cement circulated to surface Sacks

List (ALL) Perforations and Bridge Plug Sets:

**Perforated 1460 to 1470**

Elevation: 1530 ( G.L. /  K.B.) T.D.: \_\_\_\_\_ PBD: 1487 Anhydrite Depth: \_\_\_\_\_  
(Stone Corral Formation)

Condition of Well:  Good  Poor  Junk in Hole  Casing Leak at: \_\_\_\_\_  
(Interval)

Proposed Method of Plugging (attach a separate page if additional space is needed):

According to the Rules and Regulations of the Kansas State Corporation Commission. **KANSAS CORPORATION COMMISSION**

Is Well Log attached to this application?  Yes  No Is ACO-1 filed?  Yes  No

If ACO-1 not filed, explain why:

**MAY 11 2009  
RECEIVED**

Plugging of this Well will be done in accordance with K.S.A. 55-101 et. seq. and the Rules and Regulations of the State Corporation Commission

Company Representative authorized to supervise plugging operations: Ken Werner w/Knighton Oil Company, Inc.

Address: P.O. Box 1580 City: Hays State: KS Zip: 67601 + \_\_\_\_\_

Phone: (785) 366-6649

Plugging Contractor License #: 34016 Name: Ruf Nek Well Service & Supply

Address 1: P.O. Box 157 Address 2: \_\_\_\_\_

City: Lincolnvillle State: KS Zip: 66858 + \_\_\_\_\_

Phone: (620) 924-5717

Proposed Date of Plugging (if known): As soon as possible, weather permitting.

Payment of the Plugging Fee (K.A.R. 82-3-118) will be guaranteed by Operator or Agent Benson Mineral Group, Inc.

Date: May 5, 2009 Authorized Operator / Agent: Michele Sorensen, V.P. (Signature)

Mail to: KCC - Conservation Division, 130 S. Market - Room 2078, Wichita, Kansas 67202

*Dist 2  
PKT*

WICHITA BRANCH  
KANSAS DRILLERS LOG  
**K. G. S. LIBRARY**  
CONFIDENTIAL  
Released 9/25/80

11-16-NE  
C-5W/4

API No. 15 — 127 — 20,135  
County Number

S. 11 T. 16 R. 7 E

Loc. Center SW 1/4

County Morris

Operator  
BMG, INC.

Address  
1400 Metro Bank Bldg., 475 17th St., Denver, CO 80202

Well No. #1-11 Lease Name Leeds

Footage Location  
feet from (N) (S) line      feet from (E) (W) line

Principal Contractor B & N Drilling Company Geologist Mike Carr

Spud Date 2/2/77 Total Depth 1500' P.B.T.D.

Date Completed 2/7/77 Oil Purchaser

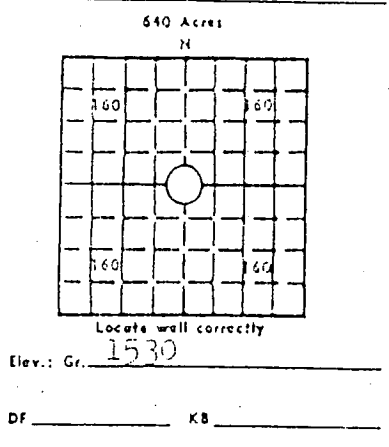

CASING RECORD

Report of all strings set — surface, intermediate, production, etc.

Purpose of string	Size hole drilled	Size casing set (in O.D.)	Weight lbs/ft.	Setting depth	Type cement	Sacks	Type and percent additives
Surface	8 3/4"	7"		123'			
Production	6 1/2"	2 7/8"		1500'	Regular	163	
DST #1 attached.							
Gamma Ray, Neutron, Perforate Log attached.							

LINER RECORD

PERFORATION RECORD

Top, ft.	Bottom, ft.	Sacks cement	Shots per ft.	Size & type	Depth interval
			1 sh/ft		1460'-1500'

TUBING RECORD

Size	Setting depth	Packer set at

ACID, FRACTURE, SHOT, CEMENT SQUEEZE RECORD

Amount and kind of material used	Depth interval treated
150 gal acid	Same as perf.
3000 # sd:	

INITIAL PRODUCTION

Date of first production <u>None</u>	Producing method (flowing, pumping, gas lift, etc.)			
RATE OF PRODUCTION PER 24 HOURS	Oil	Gas	Water	Gas-oil ratio
Disposition of gas (vented, used on lease or sold)	bbls.	MCF	bbls.	CFPB
Possible rework			Producing Interval(s)	

KANSAS CORPORATION COMMISSION  
MAY 11 2009  
RECEIVED

INSTRUCTIONS: As provided in KCC Rule 82-2-125, within 90 days after completion of a well, one completed copy of this Drillers Log shall be transmitted to the State Geological Survey of Kansas, 4150 Monroe Street, Wichita, Kansas 67209. Copies of this form are available from the Conservation Division, State Corporation Commission, 3830 So. Meridian (P.O. Box 17027), Wichita, Kansas 66217. Phone AC 316-522-2206. If confidential custody is desired, please note Rule 82-2-125. Drillers Logs will be on open file in the Oil and Gas Division, State Geological Survey of Kansas, Lawrence, Kansas 66044.

Operator  
 BMG, INC. -

DESIGNATE TYPE OF COMP.: OIL, GAS, DRY HOLE, SWDW, ETC.:

Well No. #1-11      Lease Name Leeds

Temporary Abandon

S 11 T 16 R 7 E

**WELL LOG**

Show all important zones of porosity and contents thereof; cored intervals, and all drill-stem tests, including depth interval tested, cushion used, lime tool open, flowing and shut-in pressures, and recoveries.

SHOW GEOLOGICAL MARKERS, LOGS RUN, OR OTHER DESCRIPTIVE INFORMATION.

FORMATION DESCRIPTION, CONTENTS, ETC.	TOP	BOTTOM	NAME	DEPTH
soil	0	8		
lime	8	13		
shale/sand	13	20		
lime/shale streaks	20	34		
hard lime	34	36		
shale/lime streaks	36	52		
hard lime	52	55		
lime/shale streaks	55	81		
hard lime	81	89		
lime/shale streaks	89	95		
lime/shale	95	117		
lime	117	124		
shale	124	138		
lime	138	140		
shale	140	143		
lime	143	145		
lime/shale	145	153		
shale	153	167		
shale/lime	167	176		
lime	176	179		
shale	179	187		
lime/shale	187	210		
shale/lime	210	250		
shale	250	280		
lime/shale	280	325		
shale	325	340		
shale/lime	340	400		
shale	400	491		
shale/lime	491	655		
lime/shale	655	693		
shale	693	703		
lime/shale	703	837		
lime	837	844		
shale	844	866		
lime/shale streaks	866	882		
shale/sand streaks	882	901		
shale/lime streaks	901	927		
lime/shale streaks	927	1183		
lime	1183	1235		
shale	1235	1404		
lime/shale streaks	1404	1418		

KANSAS CORPORATION COMMISSION  
 MAY 11 2009  
 RECEIVED

USE ADDITIONAL SHEETS, IF NECESSARY, TO COMPLETE WELL RECORD.

Date Received

Signature

Production Manager

Title

November 2, 1977

Date

shale 1418 1439  
 Lansing lime 1439 1500



CORPORATION COMMISSION

Mark Parkinson, Governor Thomas E. Wright, Chairman Michael C. Moffet, Commissioner Joseph F. Harkins, Commissioner

**NOTICE OF RECEIPT OF WELL PLUGGING APPLICATION (CP-1)**

BENSON MINERAL GROUP, INC.  
1560 BROADWAY STE 1900  
DENVER, CO 80202-5153

May 13, 2009

Re: LEEDS #1-11  
API 15-127-20135-00-00  
11-16S-7E, 1320 FSL 1320 FWL  
MORRIS COUNTY, KANSAS

Dear Operator:

This letter is to notify you that the Conservation Division has received your plugging proposal, form CP-1, for the above well and has reviewed the proposal for completeness. The central office will now forward your CP-1 to the district office listed below for review of the proposed plugging method. **Please contact the district office for approval of your proposed plugging method at least five (5) days before plugging the well, pursuant to K.A.R. 82-3-113(b). If a workover pit will be used during the plugging of the well it must be permitted. A CDP-1 form must be filed and approved prior to the use of the pit in accordance with K.A.R. 82-3-600.**

The Conservation Division's review of form CP-1, either in the central or district office, does not include an inquiry into well ownership or the filing operator's legal right to plug the well. This notice in no way constitutes authorization to plug the above well by persons not having legal rights of ownership or interest in the well.

**This notice is void after November 9, 2009. The CP-1 filing does not bring the above well into compliance with K.A.R. 82-3-111 with regard to the Commission's temporary abandonment requirements.**

District: #2  
3450 N. Rock Road, Suite 601  
Wichita, KS 67226  
(316) 630-4000

Sincerely,

Steve Bond  
Production Department Supervisor