

Give All Information Completely
Make Required Affidavit
Mail or Deliver Report to:
Conservation Division
State Corporation Commission
212 North Market, Insurance Bldg.
Wichita, Kansas

WELL PLUGGING RECORD

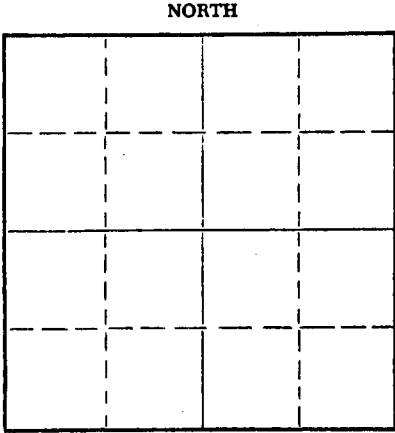

Locate well correctly on above Section Plat

Gove County. Sec. 4 Twp. 11s Rge. 30W (E) (W)
Location as "NE/CNW/SW" or footage from lines C SW SW
Lease Owner John O. Farmer, Inc.
Lease Name Dreiling Well No. 1
Office Address P.O. Box 352, Russell, Kansas
Character of Well (completed as Oil, Gas or Dry Hole) Dry Hole
Date well completed 11/22/64
Application for plugging filed 11/22/64
Application for plugging approved 11/22/64
Plugging commenced 11/22/64
Plugging completed 12 midnight 11/22/64
Reason for abandonment of well or producing formation Dry hole

If a producing well is abandoned, date of last production _____ 19____
Was permission obtained from the Conservation Division or its agents before plugging was commenced? Yes

Name of Conservation Agent who supervised plugging of this well W. L. Nichols, Morland, Kansas
Producing formation _____ Depth to top _____ Bottom _____ Total Depth of Well 4692 Feet
Show depth and thickness of all water, oil and gas formations.

OIL, GAS OR WATER RECORDS

CASING RECORD

FORMATION	CONTENT	FROM	TO	SIZE	PUT IN	PULLED OUT

Describe in detail the manner in which the well was plugged, indicating where the mud fluid was placed and the method or methods used in introducing it into the hole. If cement or other plugs were used, state the character of same and depth placed, from _____ feet to _____ feet for each plug set.

Plug # 1 600' 20 sx. cement
Plug # 2 150' 20 sx. cement
Plug # 3 40' 10 sx. cement
Completed: 12 midnight 11/22/64

RECEIVED
STATE CORPORATION COMMISSION
11-30-1964
NOV 30 1964
CONSERVATION DIVISION
Wichita, Kansas

(If additional description is necessary, use BACK of this sheet)
Name of Plugging Contractor John O. Farmer, Inc.
Address P.O. Box 352, Russell, Kansas

STATE OF KANSAS, COUNTY OF RUSSELL, ss.
JOHN O. FARMER, President (employee of owner) or (owner or operator) of the above-described

well, being first duly sworn on oath, says: That I have knowledge of the facts, statements, and matters herein contained and the log of the above-described well as filed and that the same are true and correct. So help me God.

(Signature) John O. Farmer
P.O. Box 352, Russell, Kansas (Address)

SUBSCRIBED AND SWORN to before me this 28th day of November, 1964

My commission expires February 15, 1967
Helen Carlson Notary Public.

OPERATOR John O. Farmer, Inc.

ADDRESS P.O. Box 352, Russell, Kansas

FORMATION RECORD

Give detailed description and thickness of all formation drilled through, contents of sand, whether dry, water, oil or gas.

15-063-00114-00-00
30W
11S
4
1
8
Dreiling
FARM NAME

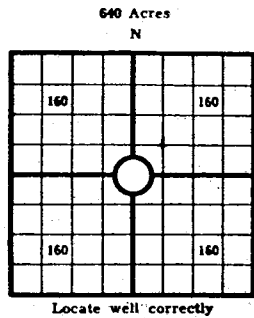

COUNTY Gove, SEC. 4, TWP. 11s, RGE. 30W
 COMPANY OPERATING John O. Farmer, Inc.
 OFFICE ADDRESS P.O. Box 352, Russell, Kansas
 DRILLING STARTED 11/11, 1964, DRILLING FINISHED 11/22, 1964
 DATE OF FIRST PRODUCTION _____ COMPLETED _____
 WELL LOCATED C 1/4 SW 1/4 SW 1/4, North of South
 Line and _____ ft. East of West Line of Quarter Section
 Elevation (Relative to sea level), DERRICK FLOOR 2917 GROUND, 2914
 CHARACTER OF WELL (Oil, gas or dryhole) Dry Hole

OIL OR GAS SANDS OR ZONES

Name	From	To	Name	From	To
1			4		
2			5		
3			6		

Perforating Record If Any				Shot Record			
Formation	From	To	No. of Shots	Formation	From	To	Size of Shot

CASING RECORD

Amount Set						Amount Pulled				Packer Record	
Size	Wt.	Thds.	Make	Ft.	In.	Ft.	In.	Size	Length	Depth Set	Make

Liner Record: Amount _____ Kind _____ Top _____ Bottom _____

CEMENTING AND MUDDING

Size	Amount Set		Sacks Cement	Chemical		Method of Cementing	Amount	Mudding Method	Results (See Note)
	Ft.	In.		Gal.	Make				
5/8"	156		140	SX-					

Note: What method was used to protect sands if outer strings were pulled? _____

NOTE: Were bottom hole plugs used? _____ If so, state kind, depth set and results obtained _____

TOOLS USED
 Rotary Tools were used from 0 feet to R.T.D. Cable tools were used from _____ feet to _____ feet, and from _____ feet to _____ feet, and from _____ feet to _____ feet
 Type Rig Rotary

INITIAL PRODUCTION TEST
 Describe initial test: whether by flow through tubing or casing or by pumping _____

Amount of Oil Production _____ bbls. Size of choke, if any _____ Length of test _____ Water Production _____ bbls. Gravity of oil _____ Type of Pump if pump is used, describe _____

Formation	Top	Bottom	Formation	Top	Bottom
Surface		156			
Shale & Sand	156	1120			
Shale	1120	1950			
Shale & Sand	1950	2475			
Anhydrite	2475	2510			
Shale & Shells	2510	2815			
Shale & Lime	2815	3290			
Lime & Shale	3290	2770			
Lime	3770	4692			
R.T.D.	4692'				

Electric Log Tops:

Heebner	3940'
Toronto	3963'
Lansing	3977'
B/ Kansas City	4251'
Fort Scott	4449'
Cherokee	4479'
Spergen	4554'
Warsaw	4609'
Osage	4659'
Log T.D.	4689'

RECEIVED
 STATE CORPORATION COMMISSION
 11-30-1964
 NOV 30 1964
 CONSERVATION DIVISION
 WICHITA, KANSAS

I, the undersigned, being first duly sworn upon oath state that this well record is true, correct and complete according to the records of this office and to the best of my knowledge and belief.

John O. Farmer
 Name and title of representative of company
 President

Subscribed and sworn to before me this 28th day of November, 1964

My Commission expires 2/15/67
Helen Carlson
 Notary Public.