

FOR KCC USE:

15-063-21485-00-00

FORM C-1 7/91

FORM MUST BE TYPED

FORM MUST BE SIGNED

ALL BLANKS MUST BE FILLED

EFFECTIVE DATE: 12-4-94

State of Kansas

DISTRICT #

NOTICE OF INTENTION TO DRILL

SGA? Yes No

Must be approved by the K.C.C. five (5) days prior to commencing well

Expected Spud Date December 7, 1994 month day year

Spot S12 SE NE Sec 21 Twp 11 S Rg 31 East West

OPERATOR: License # 03655 STAAB ENERGY & LEASING 2514 Haney Drive Hays, Kansas 67601

2310 feet from South / North line of Section 660 feet from East / West line of Section IS SECTION X REGULAR IRREGULAR?

CONTRACTOR: License #: 4958 Mallard JV, Inc.

(NOTE: Locate well on the Section Plat on Reverse Side) County: Gove Lease Name: Wieland Well #: 1 Field Name: Wildcat

Well Drilled For: Oil Gas OWWO Seismic; # of Holes Other Well Class: Enh Rec Storage Disposal # of Holes Type Equipment: Infield Pool Ext. Wildcat Other

Is this a Prorated/Spaced Field? yes no Target Formation(s): LKC Nearest lease or unit boundary: 330' Ground Surface Elevation: 2941 feet MSL

If OWWO: old well information as follows: Operator: Well Name: Comp. Date: Old Total Depth

Water well within one-quarter mile: yes no Public water supply well within one mile: yes no Depth to bottom of fresh water: 250' Depth to bottom of usable water: 250' 1540 Surface Pipe by Alternate: 1 2 300 Length of Surface Pipe Planned to be set: 200' 300 Length of Conductor pipe required: N/A Projected Total Depth: 4,650' Formation at Total Depth: Mississippi Water Source for Drilling Operations: well farm pond other

Directional, Deviated or Horizontal wellbore? yes no If yes, true vertical depth: Bottom Hole Location:

DWR Permit #: Will Cores Be Taken? yes no If yes, proposed zone:

AFFIDAVIT

The undersigned hereby affirms that the drilling, completion and eventual plugging of this well shall comply with K.S.A. 55-101, et. seq. It is agreed that the following minimum requirements will be met:

RECEIVED STATE CORPORATION COMMISSION NOV 30 1994

- 1. Notify the appropriate district office prior to spudding of well; 2. A copy of the approved notice of intent to drill shall be posted on each drilling rig; 3. The minimum amount of surface pipe as specified below shall be set by circulating cement to the top of all cases surface pipe shall be set through all unconsolidated materials plus a minimum of 20 feet into the underlying formation; 4. If the well is dry hole, an agreement between the operator and the district office on plug length and placement is necessary prior to plugging; 5. The appropriate district office will be notified before well is either plugged or production casing is cemented in; 6. IF AN ALTERNATE II COMPLETION, PRODUCTION PIPE SHALL BE CEMENTED FROM BELOW ANY USABLE WATER TO SURFACE WITHIN 120 DAYS OF SPUD DATE. IN ALL CASES, NOTIFY DISTRICT OFFICE PRIOR TO ANY CEMENTING.

I hereby certify that the statements made herein are true and to the best of my knowledge and belief. Date: Nov 29, 1994 Signature of Operator or Agent: Title: Owner

FOR KCC USE: API # 15- 063 - 21458 Conductor pipe required 7100 feet Minimum surface pipe required 300 feet per Alt. X 2 Approved by: CB 11-29-94 This authorization expires: 5-29-95 (This authorization void if drilling not started within 6 months of effective date.) Spud date: Agent:

REMEMBER TO:

- File Drill Pit Application (form CDP-1) with Intent to Drill; - File Completion Form ACO-1 within 120 days of spud date; - File acreage attribution plat according to field proration orders; - Notify appropriate district office 48 hours prior to workover or re-entry; - Submit plugging report (CP-4) after plugging is completed; - Obtain written approval before disposing or injecting salt water.

Mail to: Conservation Division, 200 Colorado Derby Building, 202 W. First St., Wichita, Kansas 67202-1286.

21 11 31

IN ALL CASES PLOT THE INTENDED WELL ON THE PLAT BELOW

PLAT OF ACREAGE ATTRIBUTABLE TO A WELL IN A PRORATED OR SPACED FIELD

If the intended well is in a prorated or spaced field, please fully complete this side of the form. If the intended well is in a prorated or spaced field complete the plat below showing that the well will be properly located in relationship to other wells producing from the common source of supply. Please show all the wells within 1 mile of the boundaries of the proposed acreage attribution unit for gas wells and within 1/2 mile of the boundaries of the proposed acreage attribution unit for oil wells.

API NO. 15- _____
 OPERATOR STAAB ENERGY & LEASING
 LEASE WIELAND
 WELL NUMBER 3
 FIELD WILDCAT

LOCATION OF WELL: COUNTY GOVE
2310 feet from ~~XXXXX~~/north line of section
660 feet from east/~~WEST~~ line of section
 SECTION 21 TWP 11s RG 31w

NUMBER OF ACRES ATTRIBUTABLE TO WELL 160
 QTR/QTR/QTR OF ACREAGE S/2 - SE - NE

IS SECTION X REGULAR or _____ IRREGULAR
IF SECTION IS IRREGULAR, LOCATE WELL FROM NEAREST CORNER BOUNDARY.

Section corner used: X NE _____ NW _____ SE _____ SW

PLAT

(Show location of the well and shade attributable acreage for prorated or spaced wells.)
 (Show footage to the nearest lease or unit boundary line.)

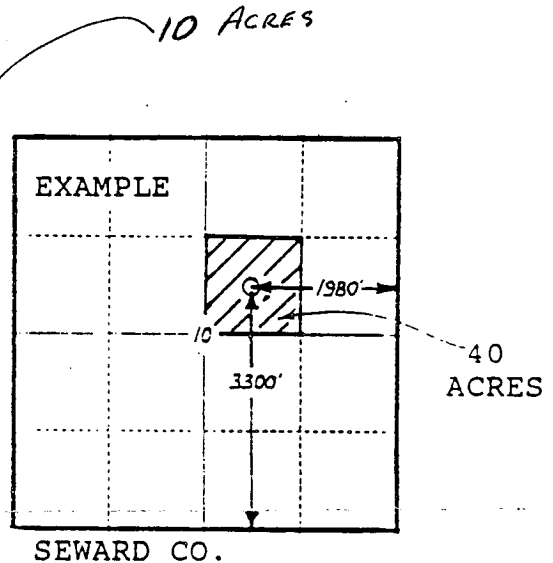
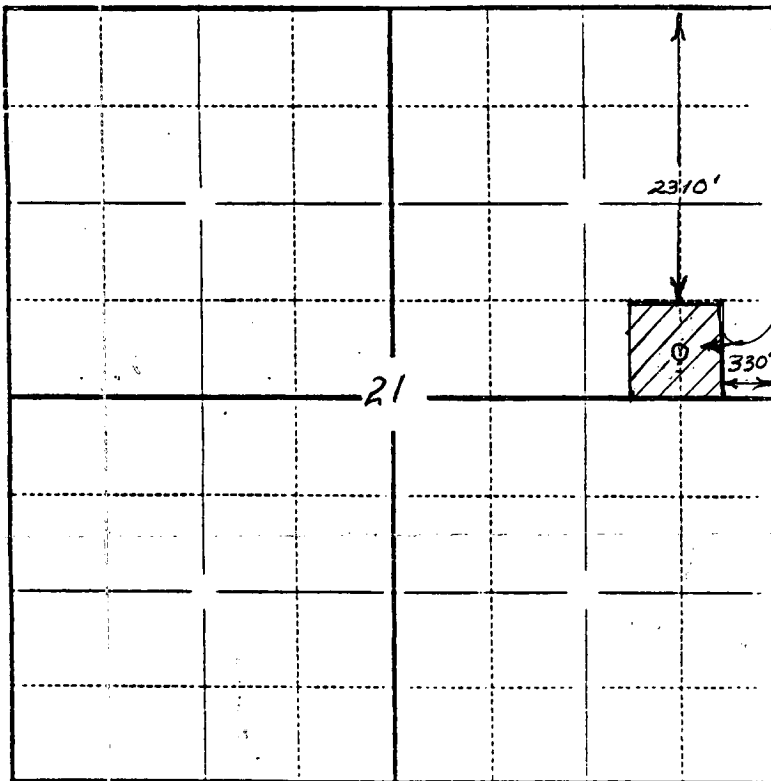

GOVE COUNTY

In plotting the proposed location of the well, you must show:

- 1) The manner in which you are using the depicted plat by identifying section lines, i.e. 1 section, 1 section with 8 surrounding sections, 4 sections, etc.;
- 2) the distance of the proposed drilling location from the section's south/north and east/west lines; and
- 3) the distance to the nearest lease or unit boundary line.