

EFFECTIVE DATE: 12-31-96

State of Kansas

FORM MUST BE TYPED

DISTRICT # 4

NOTICE OF INTENTION TO DRILL

FORM MUST BE SIGNED

SGA? Yes No

Must be approved by the K.C.C. five (5) days prior to commencing well.

ALL BLANKS MUST BE FILLED

Expected Spud Date 1 7 97 month day year

Spot W/2 SE SE Sec 22 Twp 11 S, Rg 33 East West

OPERATOR: License # 31120 Name: Pelican Hill Oil & Gas Inc. Address: 1401 N. El Camino Rd. #203 City/State/Zip: San Clemente, Ca. 92672 Contact Person: Al Gross Phone: 714-498-2101

660' feet from South North line of Section 990' feet from East West line of Section IS SECTION X REGULAR IRREGULAR?

CONTRACTOR: License #: 30684 Name: Abercrombie RTD, Inc.

(NOTE: Locate well on the Section Plat on Reverse Side) County: Logan Lease Name: SCHEETZ 'C' Well #: 3 Field Name: wildcat

Well Drilled For: Well Class: Type Equipment: XX Oil Enh Rec Infield XX Mud Rotary Gas Storage Pool Ext. Air Rotary OWWO Disposal XX Wildcat Cable Seismic; # of Holes Other

Is this a Prorated/Spaced Field? yes XX no Target Formation(s): LKC Nearest lease or unit boundary: 660' Ground Surface Elevation: 3130' est. feet MSL

If OWWO: old well information as follows: Operator: Well Name: Comp. Date: Old Total Depth

Water well within one-quarter mile: yes XX no Public water supply well within one mile: yes XX no Depth to bottom of fresh water: 200' Depth to bottom of usable water: 1680' 1740'

Directional, Deviated or Horizontal wellbore? yes XX no If yes, true vertical depth: Bottom Hole Location:

Surface Pipe by Alternate: 1 XX 2 Length of Surface Pipe Planned to be set: 260' Length of Conductor pipe required: -0-

Projected Total Depth: 4700' Formation at Total Depth: Mississippian Water Source for Drilling Operations:

well farm pond XX other

Will Cores Be Taken? yes XX no If yes, proposed zone:

AFFIDAVIT

The undersigned hereby affirms that the drilling, completion and eventual plugging of this well will comply with K.S.A. 55-101, et. seq.

It is agreed that the following minimum requirements will be met:

- 1. Notify the appropriate district office prior to spudding of well; 2. A copy of the approved notice of intent to drill shall be posted on each drilling rig; 3. The minimum amount of surface pipe as specified below shall be set by circulating cement to the top; in all cases surface pipe shall be set through all unconsolidated materials plus a minimum of 20 feet into the underlying formation; 4. If the well is dry hole, an agreement between the operator and the district office on plug length and placement is necessary prior to plugging; 5. The appropriate district office will be notified before well is either plugged or production casing is cemented in; 6. IF AN ALTERNATE II COMPLETION, PRODUCTION PIPE SHALL BE CEMENTED FROM BELOW ANY USABLE WATER TO SURFACE WITHIN 120 DAYS OF SPUD DATE. IN ALL CASES, NOTIFY DISTRICT OFFICE PRIOR TO ANY CEMENTING.

I hereby certify that the statements made herein are true and to the best of my knowledge and belief.

Date: 12-24-96 Signature of Operator or Agent: Mark R. Galvon Title: Vice-President

FOR KCC USE: API # 15-109-20639-0000 Conductor pipe required NONE feet Minimum surface pipe required 220 feet per Alt. X(2) Approved by: DW 12-26-96 This authorization expires: 6-26-97 (This authorization void if drilling not started within 6 months of effective date.) Spud date: Agent:

REMEMBER TO:

- File Drill Pit Application (form CDP-1) with Intent to Drill; - File Completion Form ACO-1 within 120 days of spud date; - File acreage attribution plat according to field proration orders; - Notify appropriate district office 48 hours prior to workover or re-entry; - Submit plugging report (CP-4) after plugging is completed; - Obtain written approval before disposing or injecting salt water.

Mail to: KCC - Conservation Division, 130 S. Market - Room 2078, Wichita, Kansas 67202.

Handwritten notes and stamps: 22, 11, 33w, 12-26-1996, 9661-72-21, NOV 26 AM 10

IN ALL CASES PLOT THE INTENDED WELL ON THE PLAT BELOW

PLAT OF ACREAGE ATTRIBUTABLE TO A WELL IN A PRORATED OR SPACED FIELD

If the intended well is in a prorated or spaced field, please fully complete this side of the form. If the intended well is in a prorated or spaced field complete the plat below showing that the well will be properly located in relationship to other wells producing from the common source of supply. Please show all the wells within 1 mile of the boundaries of the proposed acreage attribution unit for gas wells and within 1/2 mile of the boundaries of the proposed acreage attribution unit for oil wells.

API NO. 15- _____
 OPERATOR _____ LOCATION OF WELL: COUNTY _____
 LEASE _____ feet from south/north line of section
 WELL NUMBER _____ feet from east/west line of section
 FIELD _____ SECTION _____ TWP _____ RG _____

NUMBER OF ACRES ATTRIBUTABLE TO WELL _____ IS SECTION X REGULAR or _____ IRREGULAR
 QTR/QTR/QTR OF ACREAGE _____ **IF SECTION IS IRREGULAR, LOCATE WELL FROM NEAREST CORNER BOUNDARY.**

Section corner used: _____ NE _____ NW _____ SE _____ SW
PLAT

(Show location of the well and shade attributable acreage for prorated or spaced wells.)
 (Show footage to the nearest lease or unit boundary line.)

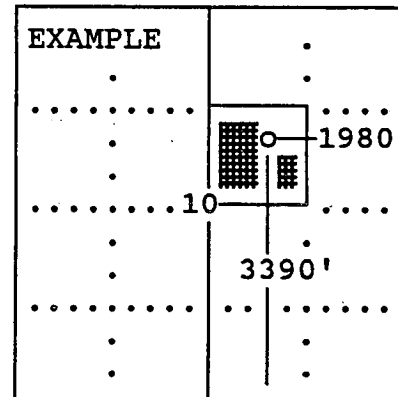
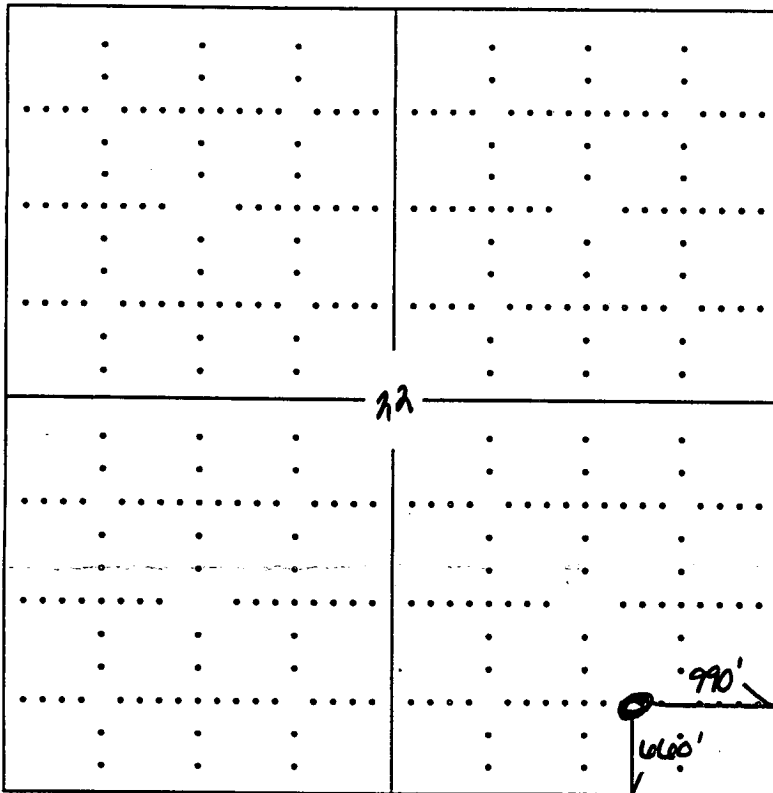

SEWARD CO.

In plotting the proposed location of the well, you must show:

- 1) The manner in which you are using the depicted plat by identifying section lines, i.e. 1 section, 1 section with 8 surrounding sections, 4 sections, etc.;
- 2) the distance of the proposed drilling location from the section's south/north and east/west; and
- 3) the distance to the nearest lease or unit boundary line.