

STATE CORPORATION COMMISSION OF KANSAS  
OIL & GAS CONSERVATION DIVISION

WELL COMPLETION OR RECOMPLETION FORM  
ACO-1 WELL HISTORY

DESCRIPTION OF WELL AND LEASE

Operator: License # 8541  
Name PETEX, Inc.  
Address Rt. 2, Box 553, Rogersville, MO 65742  
City/State/Zip

Purchaser Clear Creek

Operator Contact Person Larry Childress  
Phone (417) 887-8289

Contractor: License # 5104  
Name Blue Goose Drilling

Wellsite Geologist Tom Funk  
Phone (318) 686-5836

Designate Type of Completion  
 New Well  Re-Entry  Workover  
 Oil  SWD  Temp Abd  
 Gas  Inj  Delayed Comp.  
 Dry  Other (Core, Water Supply etc.)

If OWWO: old well info as follows:  
Operator  
Well Name  
Comp. Date Old Total Depth

WELL HISTORY

Drilling Method:  
 Mud Rotary  Air Rotary  Cable  
9/16/87 9/24/87 9/24/87  
Spud Date Date Reached TD Completion Date  
4650  
Total Depth PBTD

Amount of Surface Pipe Set and Cemented at 225 feet  
Multiple Stage Cementing Collar Used?  Yes  No  
If yes, show depth set 2472 feet  
If alternate 2 completion, cement circulated from 0 feet depth to 2472 w/ 550 SX cmt  
BJ TITAN Invoiced XU163 DWD

API NO. 15-063-21146  
County Gove  
NE NE SE Sec. 11 Twp. 11 Rge. 31  East  West

2310 Ft North from Southeast Corner of Section  
330 Ft West from Southeast Corner of Section  
(Note: Locate well in section plat below)

Lease Name Lockwood Well # 1

Field Name Campus Siding, South

Producing Formation Marmaton

Elevation: Ground 2950 KB 2957  
Section Plat

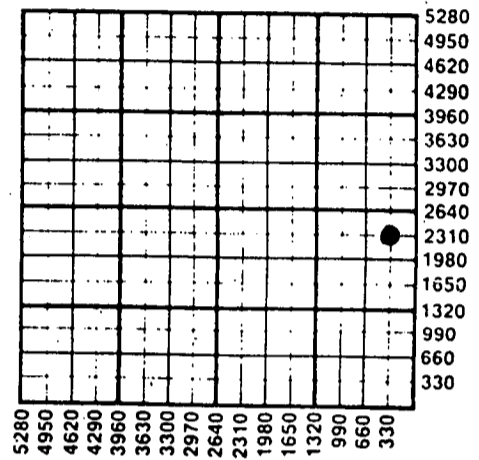

WATER SUPPLY INFORMATION  
Disposition of Produced Water:  Disposal  Repressuring  
Docket #

Questions on this portion of the ACO-1 call:  
Water Resources Board (913) 296-3717

Source of Water:  
Division of Water Resources Permit #  
 Groundwater at wellsite  
..... Ft North from Southeast Corner (Well) ..... Ft West from Southeast Corner of Sec Twp Rge  East  West  
 Surface Water ..... Ft North from Southeast Corner (Stream, pond etc) ..... Ft West from Southeast Corner Sec Twp Rge  East  West  
 Other (explain) (purchased from city, R.W.D. #)

INSTRUCTIONS: This form shall be completed in duplicate and filed with the Kansas Corporation Commission, 200 Colorado Derby Building, Wichita, Kansas 67202, within 90 days after completion or recompletion of any well. Rule 82-3-130 and 82-3-107 apply. Information on side two of this form will be held confidential for a period of 12 months if requested in writing and submitted with the form. See rule 82-3-107 for confidentiality in excess of 12 months. One copy of all wireline logs and drillers time log shall be attached with this form. Submit CP-4 form with all plugged wells. Submit CP-111 form with all temporarily abandoned wells.

All requirements of the statutes, rules and regulations promulgated to regulate the oil and gas industry have been fully complied with and the statements herein are complete and correct to the best of my knowledge.

Signature Larry Childress  
Title President Date 10/29/87

Subscribed and sworn to before me this 29th day of October 1987.  
Notary Public Peggy Steelman  
Date Commission Expires 7/29/91

K.C.C. OFFICE USE ONLY  
 Letter of Confidentiality Attached  
 Wireline Log Received  
 Drillers Timelog Received  
Distribution  
 KCC  SWD/Rep  NGPA  
 KGS  Plug  Other  
STATE CORPORATION COMMISSION (Specify)

RECEIVED  
NOV 2 1987  
11-2-1987  
CONSERVATION DIVISION  
Wichita, Kansas

Sec. 11, Twp. 11, Rge. 31

Operator Name ..... PETEX, Inc. ..... Lease Name..... Lockwood ..... Well #..... 1

Sec... 11 ..... Twp... 11 ..... Rge... 31 .....  East  West County..... Gove .....

WELL LOG

INSTRUCTIONS: Show important tops and base of formations penetrated. Detail all cores. Report all drill stem tests giving interval tested, time tool open and closed, flowing and shut-in pressures, whether shut-in pressure reached static level, hydrostatic pressures, bottom hole temperature, fluid recovery, and flow rates if gas to surface during test. Attach extra sheet if more space is needed. Attach copy of log.

Drill Stem Tests Taken  Yes  No  
Samples Sent to Geological Survey  Yes  No  
Cores Taken  Yes  No

Formation Description  
 Log  Sample

DST #	Interval	Name	Top	Bottom
DST #1	4141-4205; 30-30-30-30; Rec: 65' mud IFP 137-137; FFP 137-137; ISIP 1114 FSIP 874	Anhydrite	2496	+461
		B/Anhydrite	2523	+434
		Heebner	3976	-1019
DST #2	4198-4270; 30-45-45-60; REc: 120' GIP, 80' G&OCM; IFP 148-148; FFP 148-148; ISIP 476; FSIP 423	Lansing	4014	-1057
		Stark	4235	-1278
		B/KC	4291	-1334
		Pawnee	4419	-1462
DST #3	4386 - 4445; 30-30-30-30; Rec: 230' G&WCM; 720' GMWCO, 120' GOMCW, 850' GIP; IFP 254-455; FFP 560-633; ISIP 1083; FSIP 1125	FT. Scott	4486	-1529
		Cherokee	4512	-1555
		Miss	4590	-1633
		TD	4650	
DST #4	4463 - 4475; 30-30-15-15; Rec: 3' mud; IFP 63-63; FFP 63-63; ISIP 95; FSIP 74			

RELEASED  
1-11-1989  
JAN 11 1989

FROM CONFIDENTIAL

CASING RECORD  New  Used

Report all strings set-conductor, surface, intermediate, production, etc.

Purpose of String	Size Hole Drilled	Size Casing Set (In O.D.)	Weight Lbs/Ft.	Setting Depth	Type of Cement	#Sacks Used	Type and Percent Additives
Surface	12 1/4	8 5/8	20	225	60-40	145	2% gel 3% gel
production	7 7/8	4 1/2	10 1/2	4498	60-40 poz	200	10% salt 2% gel

PERFORATION RECORD

Shots Per Foot	Specify Footage of Each Interval Perforated	Acid, Fracture, Shot, Cement Squeeze Record (Amount and Kind of Material Used)	Depth
4 spf	4428 - 30	none	
4 spf	4418 - 20	370 gal 15% INS acid	

TUBING RECORD

Size 2 3/8 Set At 4419 Packer at Liner Run  Yes  No

Date of First Production 10/25/87 Producing Method  Flowing  Pumping  Gas Lift  Other (explain).....

Estimated Production Per 24 Hours	Oil Bbls	Gas MCF	Water Bbls	Gas-Oil Ratio CFPB	Gravity
	50		5		40

METHOD OF COMPLETION

Production Interval

Disposition of gas:  Vented  Sold  Used on Lease  Open Hole  Perforation  Other (Specify) ..... 4418-20 .....  Dually Completed  Commingled .....

BJ-TITAN SERVICES COMPANY

15-063-21146-00-00

INVOICE DATE  
10/09/87

DIRECT BILLING INQUIRIES TO: 713-895-5821	TERMS NET AMOUNT DUE 30 DAYS FROM DATE OF INVOICE	REMIT TO: BJ-TITAN SERVICES P.O. BOX 200416 HOUSTON, TX 77216
--	--	--

PAGE 1	INVOICE NO. XU163
-----------	----------------------

AUTHORIZED BY 281833
-------------------------

PURCH. ORDER REF. NO.
-----------------------

PETEX INCORPORATED

RT 2 BOX 214

ROGERSVILLE

MO 65742

WELL NUMBER : 1

*Comp INTAN*

CUSTOMER NUMBER : 06311008

LEASE NAME AND NUMBER LOCKWOOD	STATE 15	COUNTY/PARISH	CITY	DISTRICT NAME OAKLEY	DISTR. NO. 3320
JOB LOCATION/FIELD	MTA DISTRICT	DATE OF JOB 10/09/87	TYPE OF SERVICE LAND-LONG STRING/PRODUCT		

PRODUCT NUMBER	QUANTITY	DESCRIPTION	UNIT PRICE	U/M	EXTENDED PRICE
10100315	1.00	CEMENTING CASING 1500 TO 3000 FT.	879.00		879.00
10109005	18.00	MILEAGE CHRG, FROM NEAREST BASE OF	1.10		19.80
10415005	550.00	LITE	5.56	CF	3,058.00
10427510	2.00		5.00	CW	10.00
10940101	219.00	DRAYAGE, PER TON MILE	0.70		153.30
10880085	550.00	MIXING CUSTOMERS MATERIALS, PER CUB	0.95		522.50
10430585	1.00	BEAUMONT HEAD RENTAL, PER JOB	60.00		60.00
SUBTOTAL					4,702.60
DISCOUNT					1,316.72

ACCOUNT	4.00000% STATE TAX 1.00000% COUNTY TAX	3385.88 3385.88	135.45 33.85
---------	---	--------------------	-----------------

*pd 10/26/87*

TAX EXEMPTION STATUS:

PAY THIS AMOUNT

3,555.18

DIRECT BILLING INQUIRIES TO: 713-895-5821	TERMS NET AMOUNT DUE 30 DAYS FROM DATE OF INVOICE	REMIT TO: BJ-TITAN SERVICES P.O. BOX 200416 HOUSTON, TX 77216
--	--	--

PAGE 2	INVOICE NO. XE006
-----------	----------------------

PETEX INCORPORATED  
RT 2 BOX 214  
ROGERSVILLE

15-063-21146-00-00  
MO 65742

AUTHORIZED BY 281827
-------------------------

PURCH. ORDER REF. NO.
-----------------------

WELL NUMBER : 1

CUSTOMER NUMBER : 06311008

LEASE NAME AND NUMBER LOCKWOOD	STATE 15	COUNTY/PARISH	CITY	DISTRICT NAME OAKLEY	DISTR. NO. 3320
JOB LOCATION/FIELD BLUE GOOSE DR LG	MTA DISTRICT	DATE OF JOB 09/27/87	TYPE OF SERVICE LAND-LONG STRING/PRODU		

PRODUCT NUMBER	QUANTITY	DESCRIPTION	UNIT PRICE	U/M	EXTENDED PRICE
10409600	1.00	PORT COLLAR	1,260.00	GL	1,260.00
10425010	500.00	MUD-SWEEP, WITH BJ-TITAN PUMPI	1.45	GL	725.00
SUBTOTAL					5,978.70
DISCOUNT					1,674.02

*Handwritten signature*  
15/26/87

ACCOUNT	4.00000% STATE TAX 1.00000% COUNTY TAX	4304.68 4304.68	172.20 43.04
---------	---	--------------------	-----------------

TAX EXEMPTION STATUS: PAY THIS AMOUNT → 4,519.92

**BJ-TITAN SERVICES COMPANY**

INVOICE DATE  
09/27/87

15-063-21146-00-00

DIRECT BILLING INQUIRIES TO: 713-895-5821	TERMS NET AMOUNT DUE 30 DAYS FROM DATE OF INVOICE	REMIT TO: BJ-TITAN SERVICES P.O. BOX 200416 HOUSTON, TX 77216
--	--	--

PAGE 1	INVOICE NO. XE006
-----------	----------------------

PETEX INCORPORATED  
RT 2 BOX 214  
ROGERSVILLE

*Comp. Intan*

MO 65742

AUTHORIZED BY 281827
-------------------------

PURCH. ORDER REF. NO.
-----------------------

WELL NUMBER : 1

CUSTOMER NUMBER : 06311008

LEASE NAME AND NUMBER LOCKWOOD	STATE 15	COUNTY/PARISH	CITY	DISTRICT NAME OAKLEY	DISTR. NO. 3320
JOB LOCATION/FIELD BLUE GOOSE DR/G	MTA DISTRICT		DATE OF JOB 09/27/87	TYPE OF SERVICE LAND-LONG STRING/PRODU	

PRODUCT NUMBER	QUANTITY	DESCRIPTION	UNIT PRICE	U/M	EXTENDED PRICE
10100320	1.00	CEMENTING CASING 3001 TO 5000	879.00		879.00
10100325	14.96	PLUS PER 100 FT. BELOW 3000 FT	9.00		134.64
10109005	18.00	MILEAGE CHRG, FROM NEAREST BAS	1.10		19.80
10410504	120.00	CLASS "A" CEMENT	6.00	CF	720.00
10415018	80.00	DIAMIX F	3.62	CF	289.60
10415038	21.00	A-5 SALT	6.30	CW	132.30
10420145	3.44	BJ-TITAN GEL, BENTONITE, BULK	6.75	CW	23.22
10424005	129.00	CD-31	3.87	LB	499.23
10424520	28.00	FP-6	2.20	LB	61.60
10430508	1.00	4-1/2" TOP RUBBER PLUG	40.00	EA	40.00
10940101	87.30	DRAYAGE, PER TON MILE	0.70		61.11
10880085	200.00	MIXING CUSTOMERS MATERIALS, PE	0.95		190.00
10409600	6.00	CENTRALIZERS	42.30	GL	253.80
10409600	3.00	CENT-STYLE BASKETS	150.30	GL	450.90
10409600	1.00	INSERT	144.90	GL	144.90
10409600	1.00	GUIDE SHOE	93.60	GL	93.60

ACCOUNT:

TAX EXEMPTION STATUS

15-063-21146-00-00

PETEX, INC.  
Lockwood Prospect  
T. 11 s., R. 31 w.  
Gove Co., KS.

DATUM: Cherokee Shale  
INTERVAL: 10'

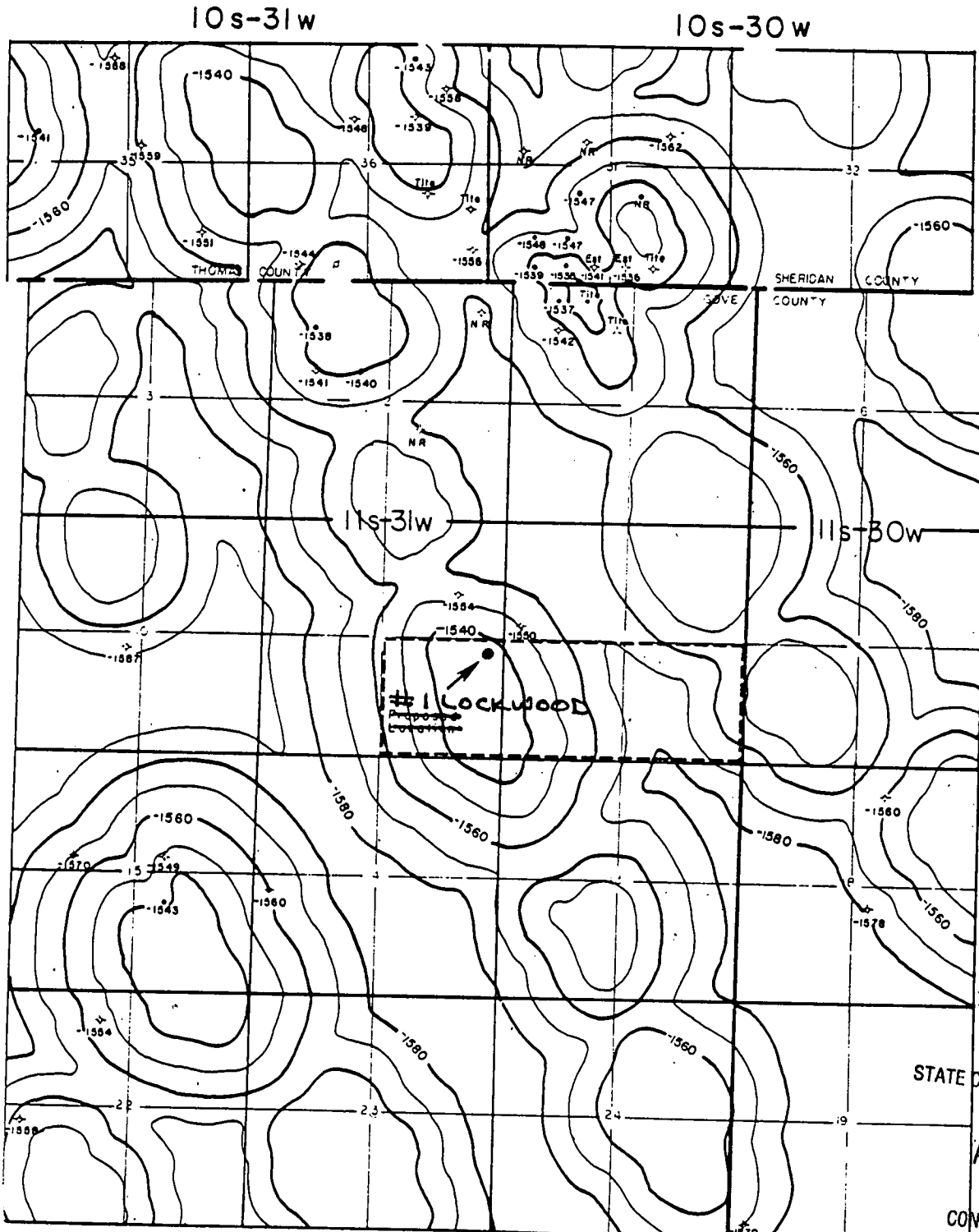

RECEIVED  
STATE CORPORATION COMMISSION  
4-20-1988  
APR 20 1988  
CONSERVATION DIVISION  
Wichita, Kansas