

STATE CORPORATION COMMISSION OF KANSAS  
OIL & GAS CONSERVATION DIVISION  
WELL COMPLETION OR RECOMPLETION FORM  
ACO-1 WELL HISTORY  
DESCRIPTION OF WELL AND LEASE

S

API NO. 15-063,21,249  
County...Gove  
100' E of  
NE NW NE Sec 6 Twp 11S Rge 31 East  
..... X West

Operator: License # 5123  
Name Pickrell Drilling Company, Inc.  
Address 110 N. Market  
Suite 205  
City/State/Zip Wichita, KS 67202

4950 Ft North from Southeast Corner of Section  
1550 Ft West from Southeast Corner of Section  
1650  
(Note: Locate well in section plat below)

Purchaser Koch Oil Company  
Wichita, Kansas

Lease Name Miller Trust Well # 1-A  
Field Name Wildeat Donmutary

Operator Contact Person Jay McNeil  
Phone 262-8427

Producing Formation Lansing  
Elevation: Ground 3010 KB 3015

Contractor: License # 5123  
Name Pickrell Drilling Company, Inc.

Wellsite Geologist Billy G. Klaver  
Phone 721-4051

RECEIVED  
MAY 26 1989  
5-26-1989  
CONSERVATION DIVISION  
Wichita, Kansas

Designate Type of Completion  
X New Well Re-Entry Workover  
X Oil SWD Temp Abd  
Gas Inj Delayed Comp.  
Dry Other (Core, Water Supply etc.)  
If OWO: old well info as follows:  
Operator  
Well Name  
Comp. Date Old Total Depth

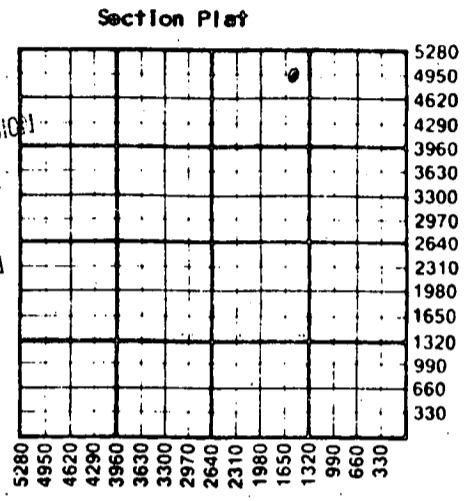

WELL HISTORY

Drilling Method:  
X Mud Rotary Air Rotary Cable  
2-14-89 2-26-89 4-18-89  
Spud Date Date Reached TD Completion Date  
4700 4221 (Loggers)  
Total Depth PBTD  
Amount of Surface Pipe Set and Cemented at 233 feet  
Multiple Stage Cementing Collar Used? X Yes No  
If yes, show depth set 2550 feet  
If alternate 2 completion, cement circulated from 2550 feet depth to 0 w/ 2.75 SX cmt  
Cement Company Name Allied  
Invoice # 4678  
6-27-89

WATER SUPPLY INFORMATION  
Disposition of Produced Water: Disposal  
Docket # Repressuring

Questions on this portion of the ACO-1 call:  
Water Resources Board (913) 296-3717  
Source of Water: P 89-097  
Division of Water Resources Permit #  
X Groundwater Ft North from Southeast Corner (Well) Ft West from Southeast Corner of Sec 6 Twp 11SRge 31 East X West  
Surface Water Ft North from Southeast Corner (Stream, pond etc) Ft West from Southeast Corner Sec Twp Rge East West  
Other (explain) (purchased from city, R.W.D. #)

INSTRUCTIONS: This form shall be completed in triplicate and filed with the Kansas Corporation Commission, 200 Colorado Derby Building, Wichita, Kansas 67202, within 120 days of the spud date of any well. Rule 82-3-130, 82-3-107 and 82-3-106 apply. Information on side two of this form will be held confidential for a period of 12 months if requested in writing and submitted with the form. See rule 82-3-107 for confidentiality in excess of 12 months. One copy of all wireline logs and drillers time log shall be attached with this form. Submit CP-4 form with all plugged wells. Submit CP-111 form with all temporarily abandoned wells.

All requirements of the statutes, rules and regulations promulgated to regulate the oil and gas industry have been fully complied with and the statements herein are complete and correct to the best of my knowledge.

Signature C.W. Sebitts  
Title C.W. Sebitts, President Date 5-24-89

Subscribed and sworn to before me this 24th day of May 1989  
Notary Public Katherine J. Rule  
Date Commission Expires June 29, 1992

K.C.C. OFFICE USE ONLY  
F Letter of Confidentiality Attached  
C Wireline Log Received  
C Drillers Timelog Received  
Distribution  
KCC SWD/Rep NGPA  
KGS Plug Other (Specify)  
5-26-89  
Form ACO-1 (5-86)



Sec. 6 Twp. 11 Rge. 21W

**SIDE TWO**

Operator Name Pickrell Drilling Company, Inc. Lease Name Miller Trust Well # 1-A

Sec. 6 Twp. 11S Rge. 31  East  West County Gove

**WELL LOG**

**INSTRUCTIONS: Show important tops and base of formations penetrated. Detail all cores. Report all drill stem tests giving interval tested, time tool open and closed, flowing and shut-in pressures, whether shut-in pressure reached static level, hydrostatic pressures, bottom hole temperature, fluid recovery, and flow rates if gas to surface during test. Attach extra sheet if more space is needed. Attach copy of log.**

Drill Stem Tests Taken  Yes  No  
 Samples Sent to Geological Survey  Yes  No  
 Cores Taken  Yes  No

Formation Description  
 Log  Sample

DST #1 4088-4102, 30"-30"-30"-30", Rec. 45' DM, IFP 10#-10#, FFP 10#-10#, ISIP 1099#, FSIP 1120#.

DST #2 4115-4137, 30"-45"-60"-60"; Rec. 70' GIP, 300' Gsy Oil, 56' Gsy OCM (10% G, 15%O), IFP 52#-84#, FFP 116#-148#, ISIP 1151#, FSIP 1089#.

DST #3 4180-4238, 30"-45"-90"-90", Rec. 105' VS10CM, IFP 10#-10#, FFP 21#-21#, ISIP 1040#, FSIP 1040#.

DST #4 4236-4264, 30"-45"-30"-30", Rec. 20' mud, IFP 10#-10#, FFP 10#-10#, ISIP 10#, FSIP 10#.

DST #5 4268-4296, 30"-45"-90"-90", Rec. 60' DF, 112' MW, IFP 31#-31#, FFP 63#-73#, ISIP 1348#, FSIP 1360#.

DST #6 4438-4458, 30"-45"-30"-30", Rec. 110' OCM, IFP 63#-63#, FFP 73#-73#, ISIP 1109#, FSIP 560#.

Name	Top	Bottom
Anhydrite	2544(+471)	
Heebner	4008(-993)	
Lansing	4049(-1034)	
Stark	4261(-1245)	
B/Kansas City	4322(-1307)	
Fort Scott	4508(-1493)	
Cherokee	4536(-1522)	
Mississippi	4636(-1621)	

CASING RECORD <input checked="" type="checkbox"/> New <input checked="" type="checkbox"/> Used							
Report all strings set-conductor, surface, intermediate, production, etc.							
Purpose of String	Size Hole Drilled	Size Casing Set (in O.D.)	Weight Lbs/Ft.	Setting Depth	Type of Cement	#Sacks Used	Type and Percent Additives
Surface	12 1/4"	8 5/8"	20#	233' KB	60/40poz	150	2%gel 3%CC
Production	7 7/8"	4 1/2" used	10 1/2#	4294'	Common	150	Salt Sat.
Stage Collar				2550'	ATL	275	
PERFORATION RECORD				Acid, Fracture, Shot, Cement Squeeze Record			
Shots Per Foot	Specify Footage of Each Interval Perforated			(Amount and Kind of Material Used)		Depth	
4	4196-4198			A .500gal 15%		A 1000gal 28%	
4	4119-4121 & 4112-4114			A .500gal DS Fe		A 2000 gal	
				.15% NE w/12 ball sealers		4119-21	
						4112-14	
TUBING RECORD				Liner Run <input type="checkbox"/> Yes <input checked="" type="checkbox"/> No			
	Size 2 3/8	Set At 4145	Packer at				
Date of First Production		Producing Method					
4-18-89		<input type="checkbox"/> Flowing <input checked="" type="checkbox"/> Pumping <input type="checkbox"/> Gas Lift <input type="checkbox"/> Other (explain).....					
Estimated Production Per 24 Hours		Oil	Gas	Water	Gas-Oil Ratio	Gravity	
8.35 Bbls		Nil	MCF	87 Bbls	CFPB		

**METHOD OF COMPLETION**

**Production Interval**

Disposition of gas:  Vented  Open Hole  Perforation  
 Sold  Other (Specify) ..... 4112-4114  
 Used on Lease  Dually Completed 4119-4121  
 Commingled

NOTE: Perfs 4196-4198 blanked off below CIBP @ 4160'.

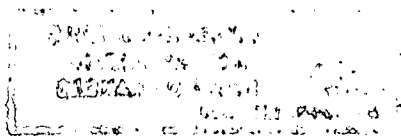

15-063-21249-00-00

PICKRELL DRILLING COMPANY, INC.

WICHITA, KANSAS 67202

Memo to: KCC

Additional DST's for #1 Miller Trust 'A'  
100' E of NE NW NE  
Sec. 6-11S-31W  
Gove County, KS

DST #7, 4470-4560, 30"-45"-30"-30", Rec. 90' SOCM,  
IFP 42#-42#, FFP 52#-63#, ISIP 943#, FSIP 169#.

DST #8, 4564-4614, 30"-45"-30"-30", Rec. 20' OCM (10%),  
IFP 21#-21#, FFP 31#-31#, ISIP 232#, FSIP 52#.

RECEIVED  
STATE CORPORATION COMMISSION  
5-26-1989  
MAY 26 1989  
CONSERVATION DIVISION  
Wichita, Kansas

483-2627, Russell, Kansas  
 16-793-5861, Great Bend, Kansas

15-063-21249-00-00

Phone Plainville 913-434-2812  
 Phone Ness City 913-798-3843

# ALLIED CEMENTING CO., INC. N<sup>o</sup> 4677

Home Office P. O. Box 31

Russell, Kansas 67665

*New*

Date	2-26-89	Sec.	6	Twp.	11	Range	31	Called Out	6:30 PM	On Location	9:30 PM	Job Start	1:30 AM	Finish	2:35 AM
Lease	Miller Trust	Well No.	1-A			Location	Oakley Exit 1E, IN, W into			County	Gove	State	Kansas		
Contractor	Picknell Drilling						Owner	Same							
Type Job	2-Stage - Bottom														
Hole Size	7 7/8	T.D.	4700'												
Csg.	4 1/2	Depth	4285'-4310'												
Tbg. Size		Depth	4294'												
Drill Pipe		Depth													
Tool	Baker stage collar	Depth	2550'												
Cement Left in Csg.		Shoe Joint	27.90												
Press Max.		Minimum													
Meas Line	yes	Displace	67.8 bbl												
Perf.															

To Allied Cementing Co., Inc.  
 You are hereby requested to rent cementing equipment and furnish  
 cementer and helper to assist owner or contractor to do work as listed.

Charge To *Picknell Drilling Co. Inc.*  
 Street *110 N. Market Suite 205*  
 City *Wichita* State *Ko 67202*  
 The above was done to satisfaction and supervision of owner agent or contractor

Purchase Order No.

X

*E. Mendus*  
**CEMENT**

*New City* EQUIPMENT

No.	Cementer	<i>Ben</i>
Pumptrk <i>158</i>	Helper	
No.	Cementer	<i>A.D.</i>
Pumptrk	Helper	<i>Duane</i>
	Driver	<i>Don</i>
Bulktrk <i>69</i>	Driver	

Amount Ordered	<i>150 Common salt saturated</i>	
Consisting of	<i>10 BBL WFR II 3/4 7/8 CFR</i>	
Common	<i>150</i>	<i>5.00 900.00</i>
Poz. Mix		
Gel.	<i>FRA-11 7/8</i>	<i>4.00 44.00</i>
Chloride		
Quickset	<i>WFR 2-420 gbs.</i>	<i>.21 88.20</i>
Salt-27	<i>4.75</i>	<i>128.25</i>
	Sales Tax	

DEPTH of Job

Reference:	<i>Pump truck charge</i>	<i>838.00</i>
<i>Oakley</i>	<i>Mileage</i>	<i>4.00</i>
	Sub Total	
	Tax	
	Total	<i>842.00</i>

Handling	<i>150 RECEIVED</i>	
Mileage	<i>4</i>	<i>40.00</i>
	STATE CORPORATION COMMISSION	<i>.90 135.00</i>
	Min.	
	Sub Total	
	Total	<i>1335.45</i>

JUN 13 1989  
 6-13-1989  
 CONSERVATION DIVISION  
 Wichita, Kansas

Remarks: *Float did hold.*

Floating Equipment	<i>4 1/2 Baker Stage collar -2800.00</i>
	<i>4 1/2 Bucket - 108.00</i>
	<i>2908.00</i>

TOTAL \$ *5085.45*  
 Less Disc - *1017.09*  
 \$ *4068.36*

*Thank You.*

15-063-21249-00-00

913-483-2627, Russell, Kansas  
316-793-5861, Great Bend, Kansas

Phone Plainville 913-434-2812  
Phone Ness City 913-798-3843

# ALLIED CEMENTING CO., INC. N° 4678

Home Office P. O. Box 31

Russell, Kansas 67665

*New*

Date	2-26-89	Sec.	6	Twp.	11	Range	31	Called Out	6:30 PM	On Location	9:30 PM	Job Start	3:15 AM	Finish	4:25 AM
Lease	Miller Trust	Well No.	1-A			Location	Oakley Exit 1E, IN, Winto			County	Yone	State	Kansas		
Contractor	Picknell Drilling														
Type Job	2-Stage-Top														
Hole Size	7 7/8	T.D.	4700'												
Csg.	4 1/2	Depth	4285-4310'												
Tbg. Size		Depth	4294'												
Drill Pipe		Depth													
Tool	Baker	Depth	2550'												
Cement Left in Csg.		Shoe Joint													
Press Max.		Minimum													
Meas Line	*No yes 2554'		Displace	40.1 bbl											
Perf.															

Owner *Same*

To Allied Cementing Co., Inc.  
You are hereby requested to rent cementing equipment and furnish cementer and helper to assist owner or contractor to do work as listed.

Charge To *Picknell Drilling Co. Inc*

Street *110 N. Market Suite 205*

City *Wichita* State *Ks 67202*

The above was done to satisfaction and supervision of owner agent or contractor

Purchase Order No.

X *[Signature]*

**CEMENT**

Amount Ordered *275 ox ATL*

Consisting of

Common	<i>275 ATL</i>	<i>6.25</i>	<i>1718.75</i>
Poz. Mix			
Gel.			
Chloride			
Quickset			

Sales Tax

Handling *275* *.90* *247.50*

Mileage *4* *Min* *40.00*

OAKLEY

RECEIVED  
STATE CORPORATION COMMISSION  
6-13-1989  
JUN 13 1989

Sub Total

Floating Equipment

CONSERVATION DIVISION  
Wichita, Kansas

Total *2006.25*

*New City*

**EQUIPMENT**

No.	Cementer	<i>Ben</i>
Pumptrk <i>158</i>	Helper	
No.	Cementer	<i>P.D.</i>
Pumptrk	Helper	<i>Quane</i>
	Driver	<i>Tracy</i>
Bulktrk <i>192</i>		
Bulktrk	Driver	

**DEPTH of Job**

Reference:	<i>Pump truck charge</i>	<i>450.00</i>
	<i>Mileage</i>	
	Sub Total	
	Tax	
	Total	<i>450.00</i>

Remarks: *Cement did Circulate.*

*Thank You.*

Total \$ *2456.25*

Less Disc - *491.25*

*1965.00*