

Amended
STATE CORPORATION COMMISSION OF KANSAS
OIL & GAS CONSERVATION DIVISION
WELL COMPLETION OR RECOMPLETION FORM
ACO-1 WELL HISTORY
DESCRIPTION OF WELL AND LEASE

API NO. 15-063-21,239

County...Gove
NE NE NW Sec 28 Twp 11S Rge 31 East X West

Operator: License # 6725
Name Eric Waddell Company
Address Box 349
City/State/Zip Natoma, KS 67651

4950 Ft North from Southeast Corner of Section
2970 Ft West from Southeast Corner of Section
(Note: Locate well in section plat below)

* Purchaser FARMLAND

Lease Name Glassman Well # 1

Field Name Penny, SE

Operator Contact Person Eric Waddell
Phone (913) 885-4497

Producing Formation

Elevation: Ground 2901 KB 2907

Contractor: License # 5422
Name Abercrombie Drilling, Inc.

Wellsite Geologist
Phone

Designate Type of Completion
 New Well Re-Entry Workover

Oil SWD Temp Abd
 Gas Inj Delayed Comp.
 Dry Other (Core, Water Supply etc.)

If OMWO: old well info as follows:
Operator
Well Name
Comp. Date Old Total Depth

Drilling Method:
 Mud Rotary Air Rotary Cable

12-10-88 12-19-88 12-20-88
Spud Date Date Reached TD Completion Date
4550 4512
Total Depth PBTD

Amount of Surface Pipe Set and Cemented at 221 feet
Multiple Stage Cementing Collar Used? Yes No
If yes, show depth set 2434 feet
If alternate 2 completion, cement circulated from 2434 feet depth to 0 w/ 450 SX cmt
Cement Company Name A1111
Invoice # 4044
3-6-87

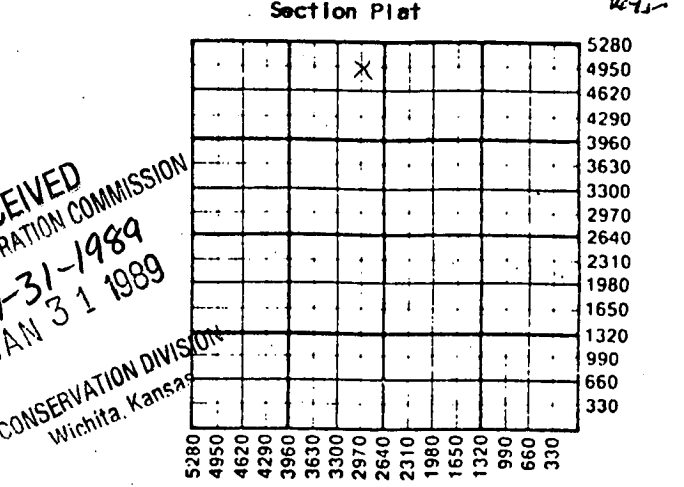

WATER SUPPLY INFORMATION
Disposition of Produced Water: Disposal Repressuring
Docket #

Questions on this portion of the ACO-1 call:
Water Resources Board (913) 296-3717
Source of Water:
Division of Water Resources Permit # T 88-615
 Groundwater 2310 Ft North from Southeast Corner
(Well) 4290 Ft West from Southeast Corner of
Gove Sec 8 Twp 11S Rge 31 East West
 Surface Water Ft North from Southeast Corner
(Stream, pond etc) Ft West from Southeast Corner
Sec Twp Rge East West
 Other (explain)
(purchased from city, R.W.D. #)

INSTRUCTIONS: This form shall be completed in triplicate and filed with the Kansas Corporation Commission, 200 Colorado Derby Building, Wichita, Kansas 67202, within 120 days of the spud date of any well. Rule 82-3-130, 82-3-107 and 82-3-106 apply.
Information on side two of this form will be held confidential for a period of 12 months if requested in writing and submitted with the form. See rule 82-3-107 for confidentiality in excess of 12 months.
One copy of all wireline logs and drillers time log shall be attached with this form. Submit CP-4 form with all plugged wells. Submit CP-111 form with all temporarily abandoned wells.

All requirements of the statutes, rules and regulations promulgated to regulate the oil and gas industry have been fully complied with and the statements herein are complete and correct to the best of my knowledge.

Signature J. Tracy L. Cooley
Title Geologist Date 1-23-89

Subscribed and sworn to before me this 23 day of JANUARY
19 89
Notary Public Reva F. Musgrove
Date Commission Expires 3-28-92

K.C.C. OFFICE USE ONLY
F. Letter of Confidentiality Attached
C Wireline Log Received
C Drillers Timelog Received
Distribution
 KCC SWD/Rep NGPA
 KGS Plug Other
(Specify)
1-31-89
Form ACO-1 (5-86)

REVA F. MUSGROVE
State of Kansas
My Appt. Exp. 3-28-92

Sec 8 Twp 11 Rge 31 W

SIDE TWO

Operator Name Eric Waddell Company Lease Name Glassman Well # 1

Sec. 28 Twp. 11S Rge. 31 East West County Gove

WELL LOG

INSTRUCTIONS: Show important tops and base of formations penetrated. Detail all cores. Report all drill stem tests giving interval tested, time tool open and closed, flowing and shut-in pressures, whether shut-in pressure reached static level, hydrostatic pressures, bottom hole temperature, fluid recovery, and flow rates if gas to surface during test. Attach extra sheet if more space is needed. Attach copy of log.

Drill Stem Tests Taken Yes No
 Samples Sent to Geological Survey Yes No
 Cores Taken Yes No

Formation Description
 Log Sample

DST #1) LKC c-d, 3960-4007, 60-45-60-45,, SIP: 84-84/84

Name	Top	Bottom
ANH	2540	
TOPEKA	3792	
LKC	4056	
BKC	4336	
MARMATOn	4320	
JONHSON	4582	
MISSISSIPPI	4640	

CASING RECORD New Used
 Report all strings set-conductor, surface, intermediate, production, etc.

Purpose of String	Size Hole Drilled	Size Casing Set (in O.D.)	Weight Lbs/Ft.	Setting Depth	Type of Cement	#Sacks Used	Type and Percent Additives
Surface	12 1/4"	8 5/8"	20#	221'	60/40pos	160	2% gel, 3% cc
Production		4 1/2"	10 1/2#	4549'	60/40pos	225	10% salt, 5% gilsonite
					Lite	450	1/4# Cello flake

PERFORATION RECORD
 Shots Per Foot | Specify Footage of Each Interval Perforated | Acid, Fracture, Shot, Cement Squeeze Record (Amount and Kind of Material Used) | Depth

4spf	4386-90	250 gal.; 15% HCl; N.E.	4386-90
------	---------	-------------------------	---------

TUBING RECORD
 Size 2 3/8" Set At 4446.47 Packer at none Liner Run Yes No

Date of First Production 1-18-89 Producing Method Flowing Pumping Gas Lift Other (explain).....

Estimated Production Per 24 Hours	Oil Bbls	Gas MCF	Water Bbls	Gas-Oil Ratio CFPB	Gravity
	45		8		45

METHOD OF COMPLETION

Production Interval

Disposition of gas: Vented Open Hole Perforation
 Sold Other (Specify)
 Used on Lease Dually Completed Commingled

4386-90

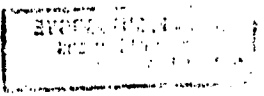

15-063-21239-00-00

ALLIED CEMENTING COMPANY, INC.

P. O. BOX 31

RUSSELL, KANSAS 67665

TELEPHONE:

AREA CODE 913 483-2627

TO: Eric Waddell
Box 349
Natoma, Kansas 67651

INVOICE NO. 53133
PURCHASE ORDER NO.
LEASE NAME Glassman #1
DATE Dec. 20, 1988

SERVICE AND MATERIALS AS FOLLOWS:

RECEIVED
STATE CORPORATION COMMISSION
3-1-1989
MAR 01 1989
CONSERVATION DIVISION
Wichita, Kansas

Table with 3 columns: Description, Price, Total. Includes items like Common 135 sks @\$5.85, Pozmix 90 sks @\$2.25, Salt 19 sks @\$4.75, G11 956#@\$.29, Flosesl 56#@\$1.60, Handling 225 sks @\$0.90, Mileage (9) @\$0.03c per sk per mi, Two stage bottom Mi @\$1.00 pmp. trk., 5-4 1/2" cent., 3 baskets, 1 AFU, 1 g. shoe, 1 DV tool.

If account CURRENT 20% discount will be allowed ONLY if paid within 30 days from date of invoice.

Pd. 12-23-88

Total \$ 5,629.59
1125.92
4503.67

THANK YOU
All Prices Are Net, Payable 20th of Month Following Date of Invoice. % of 1% Charged Thereafter

Main invoice table with columns for Description, Price, and Total. Includes items like Floating Equipment, 5-Centralizers, 3-Baskets, 1-AFU Insert, 1-Guide Shoe, 1-Arrow D.V. Tool. Total 3061.00.

Handwritten signature: M. [unclear]

483-2627, Russell, Kansas

316-793-5861, Great Bend, Kansas

Phone Plainville 913-434-2812

Phone Ness City 913-798-3843

ALLIED CEMENTING CO., INC.

Home Office P. O. Box 31

Russell, Kansas 67665

Form No. 4044

Date	12-20-88	Sec	28	Twp	11	Range	31	Called Out	4:30 AM	On Location	8:00 AM	Job Start	1:00 PM	Finish	2 PM
Lease	Glassman	Well No.	#1	Location	Campus & 21st St E			County	Gove	State	Kansas				
Contractor	Abercrombie only Rig 5														
Type Job	Production Top Stage														
Hole Size	7 7/8" T.D. 4550'														
Csg.	4 1/2" Depth 4549'														
Tbg. Size	Depth 4549'														
Drill Pipe	Depth 2433'														
Tool	Arrow P.V. Tool														
Cement Left in Csg.	40.54 Shoe Joint 40.54														
Press Max.	Minimum														
Meas Line	Yes Displace														
Perf.															

Charge To **Eric Waddell**

Street **Box 349**

City **Atatama** State **Kan 67651**

The above was done to satisfaction and supervision of owner agent or contractor.

Purchase Order No. **Eric Waddell**

CEMENT

Amount Ordered **450 SKS Light**

Consisting of

Common	450 SKS Light	1,800.00
Poz. Mix		
Gel.		
Chloride		
Quickset		
Handling	90¢	405.00
Mileage	3¢	12.50
Sub Total		2,326.50
Total		2,326.50

#153 No.	Cementer	m Kaufman
Pumptrk	Helper	Gerald K
#156 No.	Cementer	
Pumptrk	Helper	SCOTT R.
Bulktrk	Driver	
Bulktrk	Driver	
DEPTH of Job		
Reference:	# NEAR PUMP 2A Trk	450.00
Sub-Total		450.00
Tax		
Total		450.00

Remarks: **Cement Dicker**

SALES TAX

RECEIVED

STATE CORPORATION COMMISSION

Frank

MAR 01 1989

3-1-1989

CONSERVATION DIVISION
Wichita, Kansas

313-483-2627, Russell, Kansas

15-063-21239-00-00

Phone Plainville 913-434-2812

316-793-5861, Great Bend, Kansas

Phone Ness City 913-798-3843

ALLIED CEMENTING CO., INC. No. 4043

Home Office P. O. Box 31

Russell, Kansas 67665

New

Date	12-20-88	Sec No.	28	Twp No.	11	Range	31	Called Out	4:30 AM	On Location	8:00 AM	Job Start	11:30 AM	Finish	12:50 PM
Lease	Glassman	Well No.	#1	Location	Campus 170 1/2 S 20 1/2 E Gove			County	Gove			State	Kansas		
Contractor	Abercrombie Drig Rig 5														
Type Job	Production Bottom Stage														
Hole Size	7 7/8" T.D. 4550'														
Csg.	4 1/2" 2" GALLIA L. Depth 4549'														
Tbg. Size	Depth 4550'														
Drill Pipe	Depth 2433'														
Tool	Arrow D.V. Depth 2433'														
Cement Left in Csg.	40.54' Shoe Joint 40.54'														
Press Max.	Minimum 2433'														
Meas Line	Yes Displace														
Perf.															

Owner Same

To Allied Cementing Co., Inc. You are hereby requested to rent cementing equipment and furnish cement and helper to assist owner or contractor to do work as listed.

Charge: Eric Waddell
 To: Box 349
 Street: Natoma
 City: Natoma State Kan 67651

The above was done to satisfaction and supervision of owner agent or contractor.

Purchase Order No. 7 Waddell 12-12-88

CEMENT

Amount Ordered 225 SKS 60/40 Pwt 10% Salt 58 bit
 Consisting of 14 # Flo Seal Per Sack

# 153 No.	Cementer	M Kaufman
Pumptrk	Helper	Gerald K
# 160	Driver	Joel C.
Bulktrk	Driver	
DEPTH of Job		
Reference #	PUMP Tck	838.00
	1.00 per mile	9.00
	Sub Total	
	Tax	
	Total	847.00
Remarks:	15 SKS in Rat Hole	
	10 RECEIVED	
	STATE CORPORATION COMMISSION	
	MAR 01 1989	
	3-1-1989	
	CONSERVATION DIVISION	
	Wichita, Kansas	

Common	135 SKS @ 5.85	789.75
Poz. Mix	90 SKS @ 2.35	211.50
Salt	19 SKS @ 4.75	90.25
Chloride	61 956 lbs @ 2.94	277.24
	56 185 Flo-Seal @ 1.60	89.60
Handling	90¢	202.50
Mileage	3¢	60.25
9 mile		
Sub Total		1721.89
Floating Equipment		
5 - Centralizers		205.00
3 - Baskets		324.00
1 - AFU Insert		161.00
1 - Guide Shoe		104.00
1 - Arrow D.V. Tool		2,262.00
Total		3061.00

Thankes

15-063-21239-00-00

ALLIED CEMENTING COMPANY, INC.

P. O. BOX 31

RUSSELL, KANSAS 67665

TELEPHONE:
AREA CODE 913 483-2627

TO: Eric Waddell
Box 349
Natoma, Kansas 67651

INVOICE NO. 53134
PURCHASE ORDER NO. _____
LEASE NAME Glassman #1
DATE Dec. 20, 1988

SERVICE AND MATERIALS AS FOLLOWS:

Lite wt 450 sks @\$4.00	<u>\$ 1,800.00</u>	\$ 1,800.00
Handling 450 sks @\$0.90	405.00	
Mileage (9) @\$0.03¢ per sk per mi	121.50	
Two stage top stage	<u>450.00</u>	<u>976.50</u>

Total \$ 2,776.50

Cement circ.

if amount CURRENT 20% discount will be allowed ONLY if paid within 30 days from date of invoice.

555.30
2221.20

RECEIVED
STATE CORPORATION COMMISSION

THANK YOU

MAR 01 1989
3-1-1989
CONSERVATION DIVISION
Wichita Kansas

pd 12-23-88

All Prices Are Net, Payable 20th of Month Following Date of Invoice. % of 1% Charged Thereafter

DEPTH of Job	Reference #	450.00	Handling	90¢	405.00
	<i>PUMP TRK</i>		Mileage	3¢	121.50
					2326.50
		450.00			
Remarks:	<i>Cement Dd Cr</i>				