

For KCC Use: 8-3-2009
 Effective Date: _____
 District # 4
 SGA? Yes No

KANSAS CORPORATION COMMISSION
 OIL & GAS CONSERVATION DIVISION

Form C-1
 October 2007
 Form must be Typed
 Form must be Signed
 All blanks must be Filled

NOTICE OF INTENT TO DRILL

Must be approved by KCC five (5) days prior to commencing well

Expected Spud Date August 15 2009
 month day year

Spot Description: 165'E of
 NW SE SW Sec 23 Twp. 9 S Rng. 30 E W

OPERATOR: License # 5003 ✓
 Name: McCoy Petroleum Corporation
 Address 1: 8080 E. Central, Suite #300
 Address 2: _____
 City: Wichita State: KS Zip: 67206-2366
 Contact Person: Scott Hampel
 Phone: 316-636-2737 x 104

_____ feet from N / S Line of Section
990
 _____ feet from E / W Line of Section
1815

Is SECTION: Regular Irregular?
 (Note: Locate well on the Section Plat on reverse side)

CONTRACTOR: License # 30606 ✓
 Name: Murfin Drilling Company

County: Sheridan
 Lease Name: LAGER "A" Well #: #1-23

Field Name: Wildcat
 Is this a Prorated / Spaced Field? Yes No

Target Information(s): LKC
 Nearest Lease or unit boundary (in footage): 645'

Ground Surface Elevation: ~ 2890' feet MSL

Water well within one-quarter mile: Yes No
 Public water supply well within one mile: Yes No

Depth to bottom of fresh water: 200 220'

Depth to bottom of usable water: 1650'

Surface Pipe by Alternate: I II

Length of Surface Pipe Planned to be set: 270'+

Length of Conductor Pipe (if any): None

Projected Total Depth: 4650'

Formation at Total Depth: Cherokee Lime

Water Source for Drilling Operations:
 Well Farm Pond Other

DWR Permit #: _____
 (Note: Apply for Permit with DWR)

Will Cores be taken? Yes No

If Yes, proposed zone: _____

Well Drilled For: Oil Gas
 Enh Rec Storage Disposal
 Seismic: # of Holes _____
 Other: _____

Well Class: Infield Pool Ext. Wildcat Other

Type Equipment: Mud Rotary Air Rotary Cable

If OWWO: old well information as follows:

Operator: _____

Well Name: _____

Original Completion Date: _____ Original Total Depth: _____

Directional, Deviated or Horizontal wellbore? Yes No

If Yes, true vertical depth: _____

Bottom Hole Location: _____

KCC DKT #: _____

AFFIDAVIT

KANSAS CORPORATION COMMISSION

The undersigned hereby affirms that the drilling, completion and eventual plugging of this well will comply with K.S.A. 55 et. seq.

It is agreed that the following minimum requirements will be met:

1. Notify the appropriate district office **prior** to spudding of well;
2. A copy of the approved notice of intent to drill **shall be** posted on each drilling rig;
3. The minimum amount of surface pipe as specified below **shall be set** by circulating cement to the top, in all cases surface pipe shall be set through all unconsolidated materials plus a minimum of 20 feet into the underlying formation.
4. If the well is dry hole, an agreement between the operator and the district office on plug length and placement is necessary **prior to plugging**;
5. The appropriate district office will be notified before well is either plugged or production casing is cemented in;
6. If an ALTERNATE II COMPLETION, production pipe shall be cemented from below any unable water to surface within **120 days** of plug date. Or pursuant to Appendix "B" - Eastern Kansas surface casing order #133,891-C, which applies to the KCC District 3 area, alternate II cementing must be completed within 30 days of the spud date or the well shall be plugged. **In all cases, NOTIFY district office** prior to any cementing.

I hereby certify that the statements made herein are true and to the best of my knowledge and belief.

Date: 7/28/09 Signature of Operator or Agent: _____

Scott Hampel
 Scott Hampel

Title: Vice President - Production

JUL 29 2009
 RECEIVED

For KCC Use ONLY
 API # 15 - 179-21236-00-00
 Conductor pipe required None feet
 Minimum surface pipe required 250 feet per ALT. I II
 Approved by: RW 7-29-2009
 This authorization expires: 7-29-2010
 (This authorization void if drilling not started within 12 months of effective date.)
 Spud date: _____ Agent: _____

- Remember to:
- File Drill Pit Application (form CDP-1) with Intent to Drill;
 - File Completion Form ACO-1 within 120 days of spud date;
 - File acreage attribution plat according to field proration orders;
 - Notify appropriate district office 48 hours prior to workover or re-entry;
 - Submit plugging report (CP-4) after plugging is completed (within 60 days);
 - Obtain written approval before disposing or injecting salt water.
 - If this permit has expired (See: authorized expiration date) please check the box below and return to the address below.

Well Not Drilled - Permit Expired Date: _____
 Signature of Operator or Agent: _____

23-9-30
 E
 W

IN ALL CASES PLOT THE INTENDED WELL ON THE PLAT BELOW

Plat of acreage attributable to a well in a prorated or spaced field

If the intended well is in a prorated or spaced field, please fully complete this side of the form. If the intended well is in a prorated or spaced field complete the plat below showing that the well will be properly located in relationship to other wells producing from the common source of supply. Please show all the wells and within 1 mile of the boundaries of the proposed acreage attribution unit for gas wells and within 1/2 mile of the boundaries of the proposed acreage attribution unit for oil wells.

API No. 15 - 179-21236-00-00
 Operator: McCoy Petroleum Corporation
 Lease: LAGER "A" #1-23
 Well Number: #1-23
 Field: Wildcat
 Number of Acres attributable to well: _____
 QTR / QTR / QTR of acreage: NW SE SW

Location of Well: County: 165'E of NW SE SW, Sheridan County, KS
 _____ 990 feet from N S (check one) Line of Section
 _____ 1815 feet from E W (check one) Line of Section
 Sec 23 Twp 9 S. R. 30 East West
 Is Section: Regular Irregular?
If Section is Irregular, locate well from nearest corner boundary.
 Section corner used: NE NW SE SW

PLAT

*(Show location of the well and shade attributable acreage for prorated or spaced wells)
 (Show footage to the nearest lease or unit boundary fine.)*

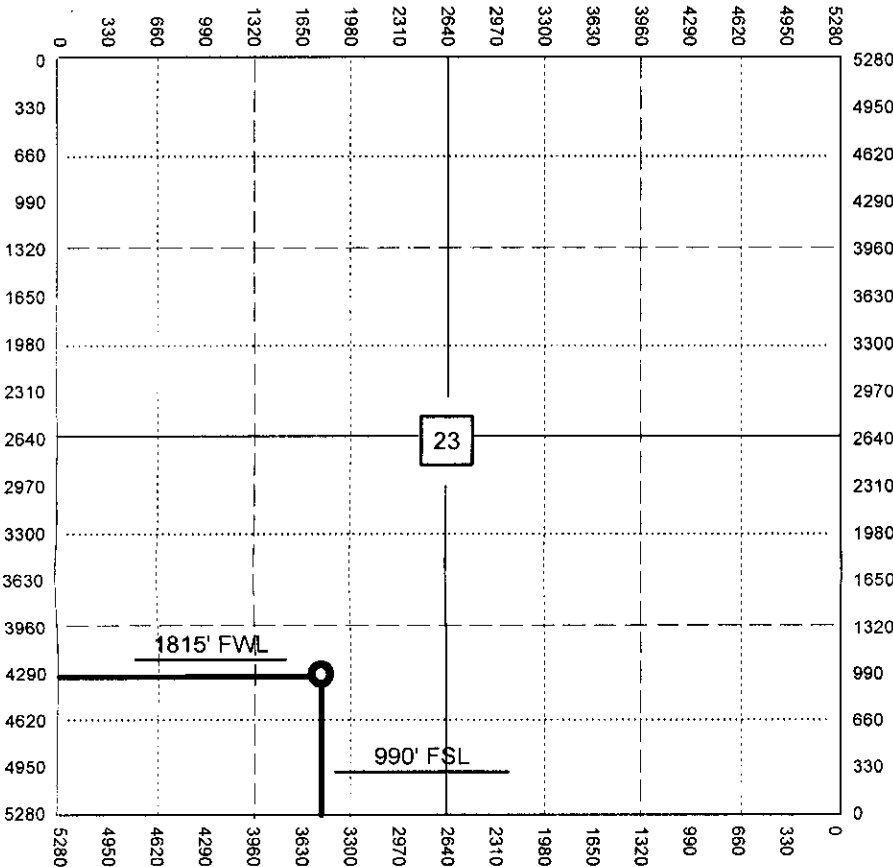

NOTE: In all cases locate the spot of the proposed drilling location.

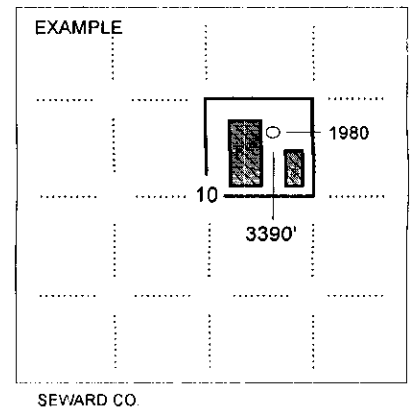

In plotting the proposed location of the well, you must show.

1. The manner in which you are using the depicted plat by identifying section lines, i.e. 1 section, 1 section with 8 surrounding sections, 4 sections, etc.
2. The distance of the proposed drilling location from the south / north and east / west outside section lines.
3. The distance to the nearest lease or unit boundary line (in footage).
4. If proposed location is located within a prorated or spaced field a certificate of acreage attribution plat must be attached: (CO-7 for oil wells; CG-8 for gas wells).

**KANSAS CORPORATION COMMISSION
OIL & GAS CONSERVATION DIVISION
APPLICATION FOR SURFACE PIT**

Form CDP-1
April 2004
Form must be Typed

Submit in Duplicate

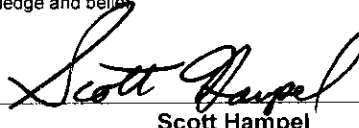
Operator Name: McCoy Petroleum Corporation		License Number: 5003
Operator Address: 8080 E. Central, Suite #300, Wichita, KS 67206-2366		
Contact Person: Scott Hampel		Phone Number: 316-636-2737x104
Lease Name & Well No.: LAGER "A" #1-23		Pit Location (QQQQ): 165'E of NW SE SW Sec 23 Twp 9 s R 30 <input type="checkbox"/> East <input checked="" type="checkbox"/> West 990 Feet from <input type="checkbox"/> North / <input checked="" type="checkbox"/> South Line of Section 1815 Feet from <input type="checkbox"/> East / <input checked="" type="checkbox"/> West Line of Section Sheridan County
Type of Pit: <input type="checkbox"/> Emergency Pit <input type="checkbox"/> Burn Pit <input type="checkbox"/> Settling Pit <input checked="" type="checkbox"/> Drilling Pit <input type="checkbox"/> Workover Pit <input type="checkbox"/> Haul-Off Pit <small>(If WP Supply API No. or Year Drilled)</small>	Pit is: <input checked="" type="checkbox"/> Proposed <input type="checkbox"/> Existing If Existing, date constructed: _____ Pit capacity: 3600 (bbls)	
Is the pit located in a Sensitive Ground Water Area? <input type="checkbox"/> Yes <input checked="" type="checkbox"/> No		Chloride concentration: _____ mg/l <small>(For Emergency Pits and Settling Pits only)</small>
Is the bottom below ground level? <input checked="" type="checkbox"/> Yes <input type="checkbox"/> No	Artificial Liner? <input type="checkbox"/> Yes <input checked="" type="checkbox"/> No	How is the pit lined if a plastic liner is not used? Bentonite / Drilling Mud
Pit dimensions (all but working pits): 80 Length (feet) 80 Width (feet) N/A: Steel Pits Depth from ground level to deepest point: 4 (feet)		
If the pit is lined give a brief description of the liner material, thickness and installation procedure.		Describe procedures for periodic maintenance and determining liner integrity, including any special monitoring. <div style="text-align: right;">KANSAS CORPORATION COMMISSION JUL 29 2009 RECORDED</div>
Distance to nearest water well within one-mile of pit: NA 270 feet Depth of water well NA 135 feet	Depth to shallowest fresh water NA 65 feet. Source of information: <input type="checkbox"/> measured <input checked="" type="checkbox"/> well owner <input type="checkbox"/> electric log <input type="checkbox"/> KDWR	
Emergency, Settling and Burn Pits ONLY: Producing Formation: _____ Number of producing wells on lease: _____ Barrels of fluid produced daily: _____ Does the slope from the tank battery allow all spilled fluids to flow into the pit? <input type="checkbox"/> Yes <input type="checkbox"/> No	Drilling, Workover and Haul-Off Pits ONLY: Type of material utilized in drilling/workover: Bentonite Number of working pits to be utilized: 3 Abandonment procedure: Let dry, backfill and return location to original condition. Drill pits must be closed within 365 days of spud date.	
I hereby certify that the above statements are true and correct to the best of my knowledge and belief		
7/28/09 Date	 Signature of Applicant or Agent Scott Hampel	
KCC OFFICE USE ONLY		
Date Received: 7/29/09 Permit Number: _____ Permit Date: 7/29/09 Lease Inspection: <input type="checkbox"/> Yes <input checked="" type="checkbox"/> No		

15-179-21236-00-00

Mail to: KCC - Conservation Division, 130 S. Market - Room 2078, Wichita, Kansas 67202