

IMPORTANT
Kans. Geo. Survey request
samples on this well.

KANSAS DRILLERS LOG

S. 6 T. 11 R. 34 ^E/_W

API No. 15 — 109 — 20,032
County Number

Loc. SE NE

County Logan

Operator
Abercrombie Drilling, Inc.

Address
801 Union Center Wichita, Kansas 67202

Well No. #1 Lease Name James

Footage Location
1980 feet from (N) ~~(S)~~ line 660 feet from (E) ~~(W)~~ line

Principal Contractor Abercrombie Drilling, Inc. Geologist Benny Singleton

Spud Date December 27, 1974 Total Depth 4855' P.B.T.D.

Date Completed January 7, 1975 Oil Purchaser None

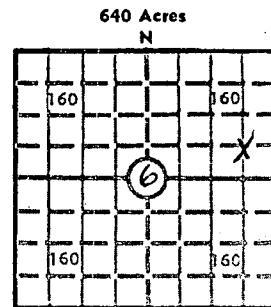

Elev.: Gr. 3239'

DF 3242' KB 3244'

CASING RECORD

Report of all strings set — surface, intermediate, production, etc.

Purpose of string	Size hole drilled	Size casing set (in O.D.)	Weight lbs/ft.	Setting depth	Type cement	Sacks	Type and percent additives
Surface	12 1/4"	8-5/8"		263'	Sunset	200	N/A

LINER RECORD

PERFORATION RECORD

Top, ft.	Bottom, ft.	Sacks cement	Shots per ft.	Size & type	Depth interval

TUBING RECORD

Size	Setting depth	Packer set at

ACID, FRACTURE, SHOT, CEMENT SQUEEZE RECORD

Amount and kind of material used	Depth interval treated

RECEIVED
STATE CORPORATION COMMISSION
1-14-1975
JAN 14 1975
CONSERVATION DIVISION
Wichita, Kansas

INITIAL PRODUCTION

Date of first production		Producing method (flowing, pumping, gas lift, etc.)			
RATE OF PRODUCTION PER 24 HOURS	Oil bbls.	Gas MCF	Water bbls.	Gas-oil ratio CFPB	
Disposition of gas (vented, used on lease or sold)			Producing interval (s)		

INSTRUCTIONS: As provided in KCC Rule 82-2-125, within 90 days after completion of a well, one completed copy of this Drillers Log shall be transmitted to the State Geological Survey of Kansas, 4150 Monroe Street, Wichita, Kansas 67209. Copies of this form are available from the Conservation Division, State Corporation Commission, 3830 So. Meridian (P.O. Box 17027), Wichita, Kansas 66217. Phone AC 316-522-2206. If confidential custody is desired, please note Rule 82-2-125. Drillers Logs will be on open file in the Oil and Gas Division, State Geological Survey of Kansas, Lawrence, Kansas 66044.

Operator Abercrombie Drilling, Inc.		DESIGNATE TYPE OF COMP.: OIL, GAS, DRY HOLE, SWDW, ETC.:
Well No. #1	Lease Name JAMES	DRY HOLE
S 6 - T 11 R 34 ^W _W		

WELL LOG

Show all important zones of porosity and contents thereof; cored intervals, and all drill-stem tests, including depth interval tested, cushion used, time tool open, flowing and shut-in pressures, and recoveries.

SHOW GEOLOGICAL MARKERS, LOGS RUN, OR OTHER DESCRIPTIVE INFORMATION.

FORMATION DESCRIPTION, CONTENTS, ETC.	TOP	BOTTOM	NAME	DEPTH
			<u>ELECTRIC LOG:</u>	
Surface Clay & Sand	0	155		
Sand & Shale	155	268	Anhydrite	2731
Shale	268	685	B/Anhydrite	2757
Shale & Sand	685	1600	Heebner	4115
Shale	1600	2450	Toronto	4138
Shale & Sand	2450	2733	Lansing	4156
Anhydrite	2733	2779	B/Kansas City	4465
Shale	2779	3305	Fort Scott	4613
Shale & Lime	3305	3597	Cherokee	4630
Lime	3597	3775	Sandy Conglomerate	4767
Lime & Shale	3775	3890	Mississippian	4823
Lime	3890	4160	ELTD	4857
Lime & Shale	4160	4314		
Lime	4314	4855		
Rotary Total Depth		4855		
<p>DST #1 (4258-4314) 30", 45", 60", 60" Strong blow-dec. to weak. Recovered 2600' salt water. IFP 26#; IBHP 1311#; FFP 1346#; FBHP 1346#.</p> <p>DST #2 (4323-4380) 30", 30", 30", 30". Seak blow for 15". Recovered 10' Mud. IFP 0#; IBHP 1346#; FFP 23#; FBHP 1346#. BHT 119°.</p>				

USE ADDITIONAL SHEETS, IF NECESSARY, TO COMPLETE WELL RECORD.

Date Received	<i>Jack K. Wharton</i>
	Jack K. Wharton Geologist
	January 13, 1975
	Signature Title Date