

15-109-20156-00-00

IMPORTANT
Kans. Geo. Survey request
samples on this well.

KANSAS

**WELL COMPLETION REPORT AND
DRILLER'S LOG**

API No. 15 — 109 — 20,156
County Number

Operator
Abercrombie Drilling, Inc.

Address
801 Union Center, Wichita, Kansas 67202

Well No. 1 Lease Name SCHEETZ

Footage Location
feet from (N) (S) line feet from (E) (W) line

Principal Contractor Abercrombie Drilling Inc. Geologist

Spud Date 10-24-80 Date Completed 11-03-80 Total Depth 4855' P.B.T.D.

Directional Deviation Oil and/or Gas Purchaser

S. 35 T. 11 R. 34 ^EW
Loc. 150' NW of C NE NW
County Logan

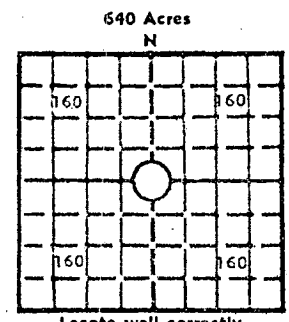

Locate well correctly
Elev.: Gr. 3195'
DF 3198 KB 3200

CASING RECORD

Report of all strings set — surface, intermediate, production, etc.

Purpose of string	Size hole drilled	Size casing set (in O.D.)	Weight lbs/ft.	Setting depth	Type cement	Sacks	Type and percent additives
Surface	12-1/4"	8-5/8"	20#	286'	60/40 posmix	210	3% NACL & 2% gel

LINER RECORD

PERFORATION RECORD

Top, ft.	Bottom, ft.	Sacks cement	Shots per ft.	Size & type	Depth interval

TUBING RECORD

Size	Setting depth	Packer set at

ACID, FRACTURE, SHOT, CEMENT SQUEEZE RECORD

Amount and kind of material used	Depth interval treated

RECEIVED
11-21-1980
LOGAN COUNTY

INITIAL PRODUCTION

Date of first production Producing method (flowing, pumping, gas lift, etc.)

RATE OF PRODUCTION PER 24 HOURS	Oil	Gas	Water	Gas-oil ratio
	bbls.	MCF	bbls.	CFPB

Disposition of gas (vented, used on lease or sold) Producing interval(s)

INSTRUCTIONS: As provided in KCC Rule 82-2-125, within 90 days after completion of a well, one completed copy of this Drillers Log shall be trans-
mitted to the State Geological Survey of Kansas, 4150 Monroe Street, Wichita, Kansas 67209. Copies of this form are available from the Conservation
Division, State Corporation Commission, 245 No. Water, Wichita, Kansas 67202. Phone AC 316-522-2206. If confidential custody is desired, please note
Rule 82-2-125. Drillers Logs will be on open file in the Oil and Gas Division, State Geological Survey of Kansas, Lawrence, Kansas 66044.

Operator: Abercrombie Drilling, Inc. DESIGNATE TYPE OF COMP.: OIL, GAS, DRY HOLE, SWDW, ETC.: Dry Hole

Well No. 1 Lease Name SCHEETZ

S 35 T 11 S R 34 EX W

WELL LOG
 Show all important zones of porosity and contents thereof; cored intervals, and all drill-stem tests, including depth interval tested, cushion used, time tool open, flowing and shut-in pressures, and recoveries.
 SHOW GEOLOGICAL MARKERS, LOGS RUN, OR OTHER DESCRIPTIVE INFORMATION.

FORMATION DESCRIPTION, CONTENTS, ETC.	TOP	BOTTOM	NAME	DEPTH
Clay, Sand & Shale	0	287	SAMPLE TOPS:	
Shale & Sand	287	2663		
Anhydrite	2663	2688	Anhydrite	2663'
Shale	2688	3629	B/Anhydrite	2688'
Lime & Shale	3629	4382	Heebner	4078' (- 878)
Lime	4382	4526	Toronto	4100' (- 900)
Lime & Shale	4526	4708	Lansing	4119' (- 919)
Lime	4708	4855		
Rotary Total Depth		4855		
DST #1 (4110'-4166') 30", 60", 30", 60" Recovered 1100' SW, IFP 67#-357#, IBHP 1250#, FFP 386#-530#, FBHP 1241#				
DST #2 (4193'-4215') 30", 45", 30", 60" 345' MSW, IFP 28#-67#, IBHP 1003#, FFP 96#-144#, FBHP 685#. Temp 118°				
DST #3 (4327'-4354') 30", 30", 30", 30" Recovered 10' mud. IFP 19#-19#, IBHP 1108#, FFP 19#-19#, FBHP 1184#. Temp. 118°				
DST #4 (4349'-4382') 30", 45", 60", 45" Recovered 840' MSW, IFP 38#-164#, IBHP 1212#, FFP 222#-337#, FBHP 916#. Temp 122°				
ELECTRIC LOG TOPS:				
			Anhydrite	2660'
			Heebner	4073'
			Toronto	4094'
			Lansing	4115'
			Miss.	4773'
			LTD	4853'

USE ADDITIONAL SHEETS, IF NECESSARY, TO COMPLETE WELL RECORD.

Date Received

Signature: *Jack L. Partridge*
 Title: Jack L. Partridge, Asst. Sec.-Treas.
 Date: 11-18-80