

KANSAS DRILLERS LOG

15-109-20034-00-00

S. 36 T. 11 R. 34 ^E/_W

API No. 15 — 109 — 20,034
County Number

Loc. C SE NW

County Logan

Operator
Abercrombie Drilling, Inc.

Address
801 Union Center Building Wichita, Kansas 67202

Well No. #1 Lease Name Colglazier

Footage Location
1980 feet from (N) line 1980 feet from (W) line

Principal Contractor Abercrombie Drilling, Inc. Geologist George Dent

Spud Date March 29, 1975 Total Depth 4790' P.B.T.D.

Date Completed April 7, 1975 Oil Purchaser None

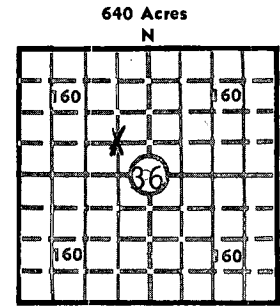

Locate well correctly
 Elev.: Gr. 3179'

DF 3182' KB 3184'

CASING RECORD

Report of all strings set — surface, intermediate, production, etc.

| Purpose of string | Size hole drilled | Size casing set (in O.D.) | Weight lbs/ft. | Setting depth | Type cement | Sacks | Type and percent additives |
|-------------------|-------------------|---------------------------|----------------|---------------|-------------|-------|----------------------------|
| Surface | 12 1/4" | 8-5/8" | | 270.65' | Sunset | 175 | |
| | | | | | | | |
| | | | | | | | |
| | | | | | | | |

LINER RECORD

PERFORATION RECORD

| Top, ft. | Bottom, ft. | Sacks cement | Shots per ft. | Size & type | Depth interval |
|----------|-------------|--------------|---------------|-------------|----------------|
| | | | | | |
| | | | | | |

TUBING RECORD

| Size | Setting depth | Packer set at |
|------|---------------|---------------|
| | | |

ACID, FRACTURE, SHOT, CEMENT SQUEEZE RECORD

| Amount and kind of material used | Depth interval treated |
|----------------------------------|------------------------|
| | |
| | |

RECEIVED
 STATE CORPORATION COMMISSION
 4-17-1975
 CONSERVATION DIVISION
 Wichita, Kansas

INITIAL PRODUCTION

| | | | | | |
|--|-------|---|-----------------------|---------------|--|
| Date of first production | | Producing method (flowing, pumping, gas lift, etc.) | | | |
| RATE OF PRODUCTION PER 24 HOURS | Oil | Gas | Water | Gas-oil ratio | |
| | bbls. | MCF | bbls. | CFPB | |
| Disposition of gas (vented, used on lease or sold) | | | Producing interval(s) | | |

INSTRUCTIONS: As provided in KCC Rule 82-2-125, within 90 days after completion of a well, one completed copy of this Drillers Log shall be transmitted to the State Geological Survey of Kansas, 4150 Monroe Street, Wichita, Kansas 67209. Copies of this form are available from the Conservation Division, State Corporation Commission, 3830 So. Meridian (P.O. Box 17027), Wichita, Kansas 66217. Phone AC 316-522-2206. If confidential custody is desired, please note Rule 82-2-125. Drillers Logs will be on open file in the Oil and Gas Division, State Geological Survey of Kansas, Lawrence, Kansas 66044.

Operator
Abercrombie Drilling, Inc.

DESIGNATE TYPE OF COMP.: OIL, GAS,
DRY HOLE, SWDW, ETC.:

Well No. 1 Lease Name COLGLAZIER

DRY HOLE

S 36 T 11S R 34 K
W

WELL LOG

Show all important zones of porosity and contents thereof; cored intervals, and all drill-stem tests, including depth interval tested, cushion used, time tool open, flowing and shut-in pressures, and recoveries.

SHOW GEOLOGICAL MARKERS, LOGS RUN,
OR OTHER DESCRIPTIVE INFORMATION.

| FORMATION DESCRIPTION, CONTENTS, ETC. | TOP | BOTTOM | NAME | DEPTH |
|---|------|--------|--------------------|-------|
| Surface Dirt & Sand | 0 | 240 | ELECTRIC LOG TOPS: | |
| Shale | 240 | 2653 | | |
| Anhydrite | 2653 | 2685 | Anhydrite | 2654 |
| Shale | 2685 | 3305 | B/Anhydrite | 2678 |
| Shale & Lime | 3305 | 3515 | Heebner | 4069 |
| Lime | 3515 | 3560 | Lansing | 4110 |
| Shale & Lime | 3560 | 3680 | B/Kansas City | 4405 |
| Lime & Shale | 3680 | 3910 | Marmaton | 4444 |
| Lime | 3910 | 4790 | Mississippi | 4750 |
| Rotary Total Depth | | 4790 | ELTD | 4790 |
| No Drill Stem Tests Taken. | | | | |
| Plugged & Abandoned: | | | | |
| 1st Plug Set @1500' w/70 sx. 50/50 Posmix, 6% gel | | | | |
| 2nd Plug Set @ 270' w/20 sx. | | | | |
| 3rd Plug Set @ 40' w/10 sx. | | | | |
| Plug down @ 6:00 p.m., 4-7-75, State Plugger: | | | | |
| Gilbert Balthazor | | | | |

USE ADDITIONAL SHEETS, IF NECESSARY, TO COMPLETE WELL RECORD.

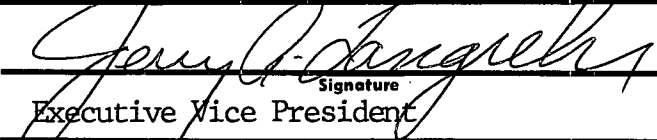
| | | |
|----------------|--|------|
| Date Received |  | |
| | Signature | |
| | Executive Vice President | |
| | Title | |
| April 16, 1975 | | Date |