

STATE CORPORATION COMMISSION OF KANSAS
OIL & GAS CONSERVATION DIVISION

WELL COMPLETION OR RECOMPLETION FORM
ACO-1 WELL HISTORY

DESCRIPTION OF WELL AND LEASE

Operator: License # 9860
Name Castle Resources
Address Box 503
City/State/Zip Hays, Kansas 67601

Purchaser.....

Operator Contact Person Jerry Green
Phone (913) 625-9023

Contractor: License # 5381
Name Big Springs Drilling, Inc.

Wellsite Geologist.....
Phone.....

Designate Type of Completion
 New Well Re-Entry Workover

Oil SWD Temp Abd
 Gas Inj Delayed Comp.
 Dry Other (Core, Water Supply etc.)

If OWWO: old well Info as follows:
Operator.....
Well Name.....
Comp. Date.....Old Total Depth.....

WELL HISTORY

Drilling Method:
 Mud Rotary Air Rotary Cable
7-12-85 7-21-85 7-21-85
Spud Date Date Reached TD Completion Date
3240'
Total Depth PBSD

Amount of Surface Pipe Set and Cemented at 217' feet
Multiple Stage Cementing Collar Used? Yes No
If yes, show depth set.....feet
If alternate 2 completion, cement circulated from 0 feet depth to 217' w/ 150 SX cmt

API No. 15-167 - 22,629 -00-00
County Russell
SE SE SE 19 12S 13W
..... Soc..... Twp..... Rge..... West

330 Ft North from Southeast Corner of Section
330 Ft West from Southeast Corner of Section
(Note: Locate well in section plat below)

Lease Name Paradise Creek Well # 1
Field Name.....

Producing Formation.....
Elevation: Ground 1553' KB 1558'

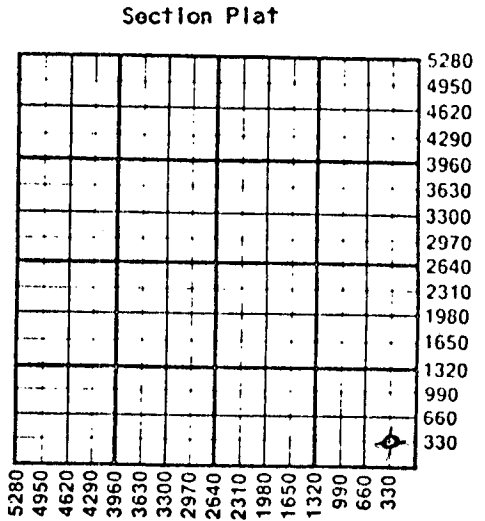

WATER SUPPLY INFORMATION
Disposition of Produced Water: Disposal Repressuring
Docket #

Questions on this portion of the ACO-1 call:
Water Resources Board (913) 296-3717
Source of Water:
Division of Water Resources Permit #.....
 Groundwater.....Ft North from Southeast Corner (Well)Ft West from Southeast Corner of Sec Twp Rge East West
 Surface Water.....Ft North from Southeast Corner (Stream, pond etc).....Ft West from Southeast Corner Sec Twp Rge East West
 Other (explain).....
(purchased from city, R.W.D. #)

INSTRUCTIONS: This form shall be completed in duplicate and filed with the Kansas Corporation Commission, 200 Colorado Derby Building, Wichita, Kansas 67202, within 90 days after completion or recompletion of any well. Rule 82-3-130 and 82-3-107 apply.
Information on side two of this form will be held confidential for a period of 12 months if requested in writing and submitted with the form. See rule 82-3-107 for confidentiality in excess of 12 months.
One copy of all wireline logs and drillers time log shall be attached with this form. Submit CP-4 form with all plugged wells. Submit CP-111 form with all temporarily abandoned wells.

All requirements of the statutes, rules and regulations promulgated to regulate the oil and gas industry have been fully complied with and the statements herein are complete and correct to the best of my knowledge.

Signature Gary Green
Title Owner Date 9/11/85

Subscribed and sworn to before me this 11th day of September 1985
Notary Public Darlene Pearson

Date Commission Expires 7-10-89

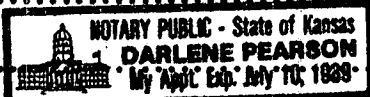

K.C.C. OFFICE USE ONLY
F Letter of Confidentiality Attached
C Wireline Log Received
C Drillers Timelog Received
Distribution
 KCC RECEIVED
 SWD/Rep NCIPA
 Other (Specify)
SEP 12 1985

Sec. 19 Twp. 12 Rge. 13 W

Operator Name Castle Resources Lease Name Paradise Creek Well # 1

Sec. 19 Twp. 12S Rge. 13W East West County Russell

WELL LOG

INSTRUCTIONS: Show important tops and base of formations penetrated. Detail all cores. Report all drill stem tests giving interval tested, time tool open and closed, flowing and shut-in pressures, whether shut-in pressure reached static level, hydrostatic pressures, bottom hole temperature, fluid recovery, and flow rates if gas to surface during test. Attach extra sheet if more space is needed. Attach copy of log.

Drill Stem Tests Taken Yes No
 Samples Sent to Geological Survey Yes No
 Cores Taken Yes No

Formation Description
 Log Sample

| Name | Top | Bottom |
|---------------|-------------------------|--------|
| Tupcka | 2483 | 2713 |
| Hebner | 2713 | 2717 |
| Trento | 2732 | 45 |
| Lansing - Ke | 2768 2879 | 3055 |
| Viola | 3100 | 3213 |
| Simpson Sand | 3226 | 3 |
| Simpson Shale | 3231 | 40 |

CASING RECORD New Used
 Report all strings set-conductor, surface, intermediate, production, etc.

| Purpose of String | Size Hole Drilled | Size Casing Set (In O.D.) | Weight Lbs/Ft. | Setting Depth | Type of Cement | #Sacks Used | Type and Percent Additives |
|-------------------|-------------------|---------------------------|----------------|---------------|----------------|-------------|----------------------------|
| Surface | 12 1/4" | 8 5/8" | 20# | 217' | 60-40 POZ | 150 | 2% gel 3%cc1 |

| Shots Per Foot | Specify Footage of Each Interval Perforated | Acid, Fracture, Shot, Cement Squeeze Record (Amount and Kind of Material Used) | Depth |
|----------------|---|--|-------|
| | | | |
| | | | |
| | | | |
| | | | |

TUBING RECORD Size Set At Packer at Liner Run Yes No

Date of First Production Producing Method Flowing Pumping Gas Lift Other (explain).....

| Estimated Production Per 24 Hours | Oil | Gas | Water | Gas-Oil Ratio | Gravity |
|-----------------------------------|-------|-------|-------|---------------|---------|
| | Bbls | MCF | Bbls | CFPB | |
| | | | | | |

METHOD OF COMPLETION Production Interval

Disposition of gas: Vented Open Hole Perforation
 Sold Other (Specify)
 Used on Lease Dually Completed
 Conmingled