

CARD MUST BE TYPED

State of Kansas  
**NOTICE OF INTENTION TO DRILL**  
(see rules on reverse side)

CARD MUST BE SIGNED

Starting Date: ..... 9 - 23 - 87 .....  
month day year

API Number 15-063-21, 154-00-00 ✓

OPERATOR: License # 5290.....  
Name Hinkle Oil Company.....  
Address 1016 Union Center.....  
City/State/Zip Wichita, KS 67202.....  
Contact Person Orvie Howell.....  
Phone (316) 267-0231.....

..... East  
NW NE SE Sec .28. Twp .11. S, Rge 26.  West  
(location)

.....2310..... Ft North from Southeast Corner of Section  
.....990..... Ft West from Southeast Corner of Section  
(Note: Locate well on Section Plat on reverse side)

CONTRACTOR: License # 4083.....  
Name Western Kansas Drilling, Inc.....  
City/State Box 126, Hays, KS 67601.....

Nearest lease or unit boundary line ..330..... feet.  
County Gove.....  
Lease Name Sanger..... Well# 1.....

Domestic well within 330 feet :  yes  no  
Municipal well within one mile :  yes  no

Well Drilled For: Well Class: Type Equipment:  
 Oil  Swd  Infield  Mud Rotary  
 Gas  Inj  Pool Ext.  Air Rotary  
 OWWO  Expl  Wildcat  Cable

Depth to Bottom of fresh water .....140..... feet  
Lowest usable water formation .....Dakota.....  
Depth to Bottom of usable water .....1300..... feet  
Surface pipe by Alternate: 1  2   
Surface pipe to be set .....300..... feet  
Conductor pipe if any required .....None..... feet  
Ground surface elevation .....2651..... feet MSI  
This Authorization Expires 3-21-88 Effective 9-26-87  
Approved By P.H. 9-21-87

If OWWO: old well info as follows:

Operator .....  
Well Name .....  
Comp Date ..... Old Total Depth .....  
Projected Total Depth ...4600..... feet  
Projected Formation at TD..Mississippian.....  
Expected Producing Formations LKC-MISS.....

I certify that we will comply with K.S.A. 55-101, et seq., plus eventually plugging hole to K.C.C. specifications.

min. surface pipe: 200'

Date ..9/21/87..... Signature of Operator or Agent

Title General Manager-Geologist

Must be filed with the K.C.C. five (5) days prior to commencing well  
 This card void if drilling not started within six (6) months of date received by K.C.C.

A Regular Section of Land  
 1 Mile = 5,280 Ft.

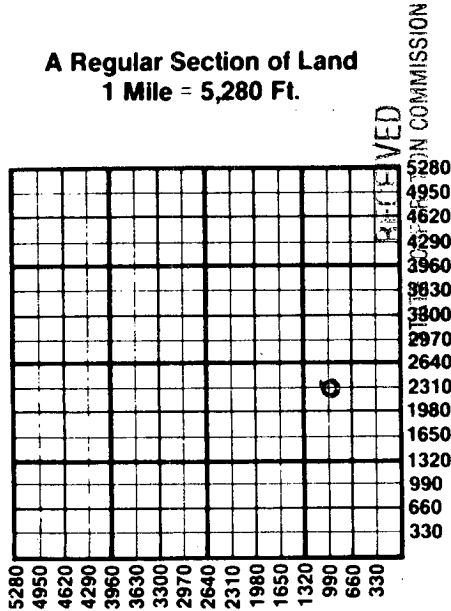

SEP 21 1987  
 09-21-1987  
 CONSERVATION DIVISION  
 WICHITA, KANSAS

**Important procedures to follow :**

1. Notify District office before setting surface casing.
2. Set surface casing by circulating cement to the top.
3. File completion forms ACO-1 with K.C.C. within 90 days of well completion, following instructions on ACO-1, side 1, and including copies of wireline logs.
4. Notify District office 48 hours prior to old well workover or re-entry.
5. Prior to plugging, prepare a plugging plan, then obtain agreement from the appropriate district office for an approved plugging plan.
6. Submit plugging report (CP-4) to K.C.C. after plugging is completed.
7. Obtain an approved injection docket number before disposing of salt water.
8. Notify K.C.C. within 10 days when injection commences or terminates.
9. If an alternate 2 completion, cement in the production pipe from below any usable water to surface within 120 days of spud date.

State Corporation Commission of Kansas  
 Conservation Division  
 200 Colorado Derby Building  
 Wichita, Kansas 67202  
 (316) 263-3238