

STATE CORPORATION COMMISSION OF KANSAS
OIL & GAS CONSERVATION DIVISION
WELL COMPLETION OR RECOMPLETION FORM
ACO-1 WELL HISTORY
DESCRIPTION OF WELL AND LEASE

API NO. 15-109-20,456-00-00

County Logan

SE NE SW Sec. 23 Twp. 11 Rge. 33 East West

1650 Ft North from Southeast Corner of Section
2970 Ft West from Southeast Corner of Section
(Note: Locate well in section plat below)

Lease Name Holm Well # 1

Field Name

Producing Formation

Elevation: Ground 3132 KB 3137

Operator: License # 4656
Name Davis Petroleum, Inc.
Address R.R. 1 Box 183 B
City/State/Zip Great Bend, Kansas 67530

Purchaser

Operator Contact Person L. D. Davis
Phone (316) 793-3051

Contractor: License # 6039
Name I. D. Drilling, Inc.

Wellsite Geologist Kim Shoemaker
Phone (316) 682-1537

Designate Type of Completion
 New Well Re-Entry Workover
 Oil SWD Temp Abd
 Gas Inj Delayed Comp.
 Dry Other (Core, Water Supply etc.)

If OWWO: old well info as follows:
Operator
Well Name
Comp. Date Old Total Depth

WELL HISTORY

Drilling Method:
 Mud Rotary Air Rotary Cable

2-16-88 2-26-88 2-26-88
Spud Date Date Reached TD Completion Date
4712'
Total Depth PBD 325'

Amount of Surface Pipe Set and Cemented at....feet
Multiple Stage Cementing Collar Used? Yes No
If yes, show depth set.....feet
If alternate 2 completion, cement circulated from.....feet depth to.....w/.....SX cmt
Cement Company Name
Invoice #

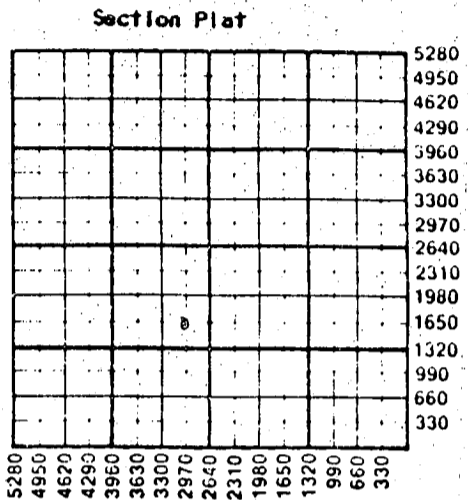

WATER SUPPLY INFORMATION

Disposition of Produced Water: Disposal Repressuring
Docket #

Questions on this portion of the ACO-1 call:

Water Resources Board (913) 296-3717

Source of Water:
Division of Water Resources Permit # T-88-86

Groundwater..1650 Ft North from Southeast Corner (Well) ..2970 Ft West from Southeast Corner of Sec 23 Twp 11 Rge 33 East X West

Surface Water.....Ft North from Southeast Corner (Stream, pond etc).....Ft West from Southeast Corner Sec Twp Rge East West

Other (explain).....
(purchased from city, R.W.D. #)

INSTRUCTIONS: This form shall be completed in triplicate and filed with the Kansas Corporation Commission, 200 Colorado Derby Building, Wichita, Kansas 67202, within 120 days of the spud date of any well. Rule 82-3-130, 82-3-107 and 82-3-106 apply. Information on side two of this form will be held confidential for a period of 12 months if requested in writing and submitted with the form. See rule 82-3-107 for confidentiality in excess of 12 months. One copy of all wireline logs and drillers time log shall be attached with this form. Submit CP-4 form with all plugged wells. Submit CP-111 form with all temporarily abandoned wells.

All requirements of the statutes, rules and regulations promulgated to regulate the oil and gas industry have been fully complied with and the statements herein are complete and correct to the best of my knowledge.

Signature L. D. Davis
Title President Date 3-8-88

Subscribed and sworn to before me this 8th day of 1988.
Notary Public Bessie M. DeWerff
Date Commission Expires 5-20-89

K.C.C. OFFICE USE ONLY
F Letter of Confidentiality Attached
C Wireline Log Received
C Drillers Time Log Received
Distribution
KCC SWD/Rep NGPA
KGS Plug Other (Specify)

RECEIVED
STATE CORPORATION COMMISSION
MAR 10 1988
3-10-1988
CONSERVATION DIVISION
Wichita, Kansas
Form ACO-1 (5-86)

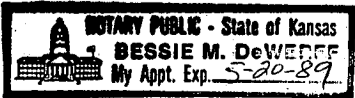

Sec 23 Twp 11 Rge 33

Operator Name Davis Petroleum, Inc. Lease Name..... Holm Well #..... 1

Sec. 23 Twp. 11 Rge. 33 East West County..... LOGAN

WELL LOG

INSTRUCTIONS: Show important tops and base of formations penetrated. Detail all cores. Report all drill stem tests giving interval tested, time tool open and closed, flowing and shut-in pressures, whether shut-in pressure reached static level, hydrostatic pressures, bottom hole temperature, fluid recovery, and flow rates if gas to surface during test. Attach extra sheet if more space is needed. Attach copy of log.

Drill Stem Tests Taken Yes No
 Samples Sent to Geological Survey Yes No
 Cores Taken Yes No

Formation Description
 Log Sample

DST #1 4171-4190 E Zone

Times: 45-45-45-45
 Blow: 1st open: 5" blow
 2nd open: 4" blow
 Recovery: 200' muddy water
 IFP: 59-71 FFP: 95-121
 ISIP: 1231 FSIP: 1206

DST #2 4235-4290

Times: 30-30
 Blow: weak blow died in 25 min.
 Recovery: 25' mud
 IFP: 71-173 FFP:
 ISIP: 634 FSIP:

DST #3 4280-4312 180' Zone

TIMES: 45-45-45-45
 Blow: 1st open: built to bb in 32 min.
 2nd open: weak 1 1/2" blow
 Recovery: 300' gip, 70' cgo, 49' HOcm
 IFP: 61-64 FFP: 77-79 ISIP: 956 FSIP: 77-79 937

Name	Top	Bottom
Heebner	4054	(-917)
Toronto	4071	(-934)
Lans. K/C	4093	(-956)
Muncie Creek	4229	(-1092)
Stark	4309	(-1172)
Base K/C	4366	(-1229)
Marmiton	4398	(-1261)
Pawnee	4501	(-1373)
Fort Scott	4567	(-1430)
Cherokee Shale	4595	(-1458)
Johnson	4638	(-1501)
Miss.	4689	(-1552)

CASING RECORD <input checked="" type="checkbox"/> New <input type="checkbox"/> Used							
Report all strings set-conductor, surface, intermediate, production, etc.							
Purpose of String	Size Hole Drilled	Size Casing Set (in O.D.)	Weight Lbs/Ft.	Setting Depth	Type of Cement	#Sacks Used	Type and Percent Additives
Surface	12 1/4"	8 5/8"	20#	325'	60/40 Pozmix	190	2% GE1, 3% CC
PERFORATION RECORD				Acid, Fracture, Shot, Cement Squeeze Record			
Shots Per Foot	Specify Footage of Each Interval Perforated			(Amount and Kind of Material Used)		Depth	
.....	
.....	
.....	
TUBING RECORD				Liner Run <input type="checkbox"/> Yes <input type="checkbox"/> No			
Date of First Production	Producing Method <input type="checkbox"/> Flowing <input type="checkbox"/> Pumping <input type="checkbox"/> Gas Lift <input type="checkbox"/> Other (explain).....						
Estimated Production Per 24 Hours	Oil Bbls	Gas MCF	Water Bbls	Gas-Oil Ratio	Gravity		

METHOD OF COMPLETION Production Interval

Disposition of gas: Vented Open Hole Perforation
 Sold Other (Specify)
 Used on Lease Dually Completed
 Conningled

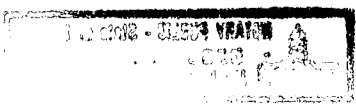

SIDE TWO

Operator Name Davis Petroleum, Inc. Lease Name..... HOLM Well #..... 1

Sec..... 23 Twp..... 11 Rge..... 33 East West County..... LOGAN

WELL LOG

INSTRUCTIONS: Show important tops and base of formations penetrated. Detail all cores. Report all drill stem tests giving interval tested, time tool open and closed, flowing and shut-in pressures, whether shut-in pressure reached static level, hydrostatic pressures, bottom hole temperature, fluid recovery, and flow rates if gas to surface during test. Attach extra sheet if more space is needed. Attach copy of log.

.....

Drill Stem Tests Taken Yes No
Samples Sent to Geological Survey Yes No
Cores Taken Yes No

Formation Description
 Log Sample

Name Top Bottom

DST # 4 4307-4340

TIMES: 15-15-
BLOW: weak blow that died
Recovery: 15' mud with oil specks
IFP: 69-73 FFP:
ISIP: 534 FSIP:

DST #5 4592-4675

Times: 30-30
Blow: 1st open: weak blow died in 5 min.
2nd open: No blow
Recovery: 5' DRilling Mud
IFP: 79-81 FFP:
ISIP: 111