

FOR KCC USE:

EFFECTIVE DATE: 10-15-95

FORM MUST BE TYPED

DISTRICT # 4  
SEAT Yes No

State of Kansas  
NOTICE OF INTENTION TO DRILL

FORM MUST BE SIGNED

ALL BLANKS MUST BE FILLED

Must be approved by the K.C.C. five (5) days prior to commencing well

Expected Spud Date October 16 1995  
month day year

Spot NE NE SE Sec 23 Twp 11 S, Rg 34 East X West

OPERATOR: License # 5030  
Name: Vess Oil Corporation  
Address: 8100 E. 22nd St. North, Bldg. 300  
City/State/Zip: Wichita, KS 67226  
Contact Person: W.R. Horigan  
Phone: 316-682-1537

2310' feet from South North line of Section  
330' feet from East West line of Section  
IS SECTION X REGULAR IRREGULAR?

(NOTE: Locate well on the Section Plat on Reverse Side)

CONTRACTOR: License #: 6039  
Name: L. D. Drilling, Inc.

County: Logan  
Lease Name: Avila Well #: 1-23  
Field Name: Unnamed

Is this a Prorated/Spaced Field? ... yes X no

Target Formation(s): LKC

Nearest lease or unit boundary: 330'

Ground Surface Elevation: 3150' feet MSL

Water well within one-quarter mile: X yes no

Public water supply well within one mile: yes X no

Depth to bottom of fresh water: 180'

Depth to bottom of usable water: 1650'

Surface Pipe by Alternate: 1 X 2

Length of Surface Pipe Planned to be set: 300

Length of Conductor pipe required: N/A

Projected Total Depth: 4750'

Formation at Total Depth: Miss.

Water Source for Drilling Operations:

X well ... farm pond ... other

DWR Permit #: ...

Will Cores Be Taken? ... yes ... no

If yes, proposed zone: ...

Well Drilled For: Well Class: Type Equipment:  
XX Oil Enh Rec Infield XX Mud Rotary  
... Gas Storage XX Pool Ext. ... Air Rotary  
... OWWO Disposal ... Wildcat ... Cable  
... Seismic; ... # of Holes ... Other

If OWWO: old well information as follows:

Operator: ...

Well Name: ...

Comp. Date: ... Old Total Depth ...

Directional, Deviated or Horizontal wellbore? ... yes XX no

If yes, true vertical depth: ...

Bottom Hole Location: ...

AFFIDAVIT

The undersigned hereby affirms that the drilling, completion and eventual plugging of this well will comply with K.S.A. 55-101, et. seq.

It is agreed that the following minimum requirements will be met:

- 1. Notify the appropriate district office prior to spudding of well;
- 2. A copy of the approved notice of intent to drill shall be posted on each drilling rig;
- 3. The minimum amount of surface pipe as specified below shall be set by circulating cement to the top; in all cases surface pipe shall be set through all unconsolidated materials plus a minimum of 20 feet into the underlying formation;
- 4. If the well is dry hole, an agreement between the operator and the district office on plug length and placement is necessary prior to plugging;
- 5. The appropriate district office will be notified before well is either plugged or production casing is cemented in;
- 6. IF AN ALTERNATE II COMPLETION, PRODUCTION PIPE SHALL BE CEMENTED FROM BELOW ANY USABLE WATER TO SURFACE WITHIN 120 DAYS OF SPUD DATE. IN ALL CASES, NOTIFY DISTRICT OFFICE PRIOR TO ANY CEMENTING.

I hereby certify that the statements made herein are true and to the best of my knowledge and belief.

Date: October 9, 1995 Signature of Operator or Agent: [Signature] Title: Operations Manager

FOR KCC USE:  
API # 15- 109-205970000  
Conductor pipe required NONE feet  
Minimum surface pipe required 230' feet per Alt. X (2)  
Approved by: JK 10-10-95  
This authorization expires: 4-10-96  
(This authorization void if drilling not started within 6 months of effective date.)  
Spud date: Agent:

REMEMBER TO:

- File Drill Pit Application (form CDP-1) with Intent to Drill;
- File Completion Form ACO-1 within 120 days of spud date;
- File acreage attribution plat according to field proration orders;
- Notify appropriate district office 48 hours prior to workover or re-entry;
- Submit plugging report (CP-4) after plugging is completed;
- Obtain written approval before disposing or injecting salt water.

Mail to: Conservation Division, 200 Colorado Derby Building, 202 W. First St., Wichita, Kansas 67202-1286.

RECEIVED  
STATE CORPORATION COMMISSION  
10-10-1995  
OCT 10 1995  
CONSERVATION DIVISION  
Wichita, Kansas

11  
34W

IN ALL CASES PLOT THE INTENDED WELL ON THE PLAT BELOW

**PLAT OF ACREAGE ATTRIBUTABLE TO A WELL IN A PRORATED OR SPACED FIELD**

If the intended well is in a prorated or spaced field, please fully complete this side of the form. If the intended well is in a prorated or spaced field complete the plat below showing that the well will be properly located in relationship to other wells producing from the common source of supply. Please show all the wells within 1 mile of the boundaries of the proposed acreage attribution unit for gas wells and within 1/2 mile of the boundaries of the proposed acreage attribution unit for oil wells.

API NO. 15- \_\_\_\_\_  
 OPERATOR \_\_\_\_\_  
 LEASE \_\_\_\_\_  
 WELL NUMBER \_\_\_\_\_  
 FIELD \_\_\_\_\_

LOCATION OF WELL: COUNTY \_\_\_\_\_  
 \_\_\_\_\_ feet from south/north line of section  
 \_\_\_\_\_ feet from east/west line of section  
 SECTION \_\_\_\_\_ TWP \_\_\_\_\_ RG \_\_\_\_\_

NUMBER OF ACRES ATTRIBUTABLE TO WELL \_\_\_\_\_  
 QTR/QTR/QTR OF ACREAGE \_\_\_\_\_

IS SECTION \_\_\_\_\_ REGULAR or \_\_\_\_\_ IRREGULAR  
IF SECTION IS IRREGULAR, LOCATE WELL FROM NEAREST CORNER BOUNDARY.

Section corner used: \_\_\_\_\_ NE \_\_\_\_\_ NW \_\_\_\_\_ SE \_\_\_\_\_ SW

**PLAT**

(Show location of the well and shade attributable acreage for prorated or spaced wells.)  
 (Show footage to the nearest lease or unit boundary line.)

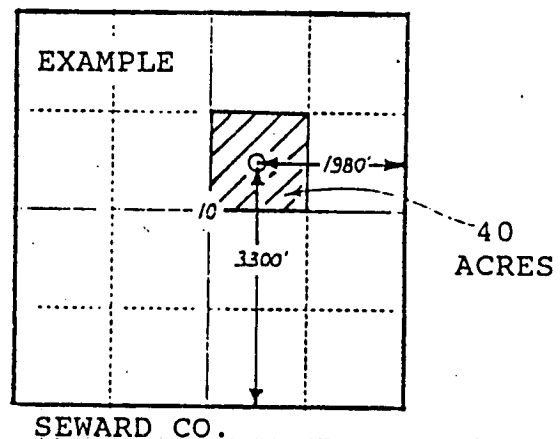
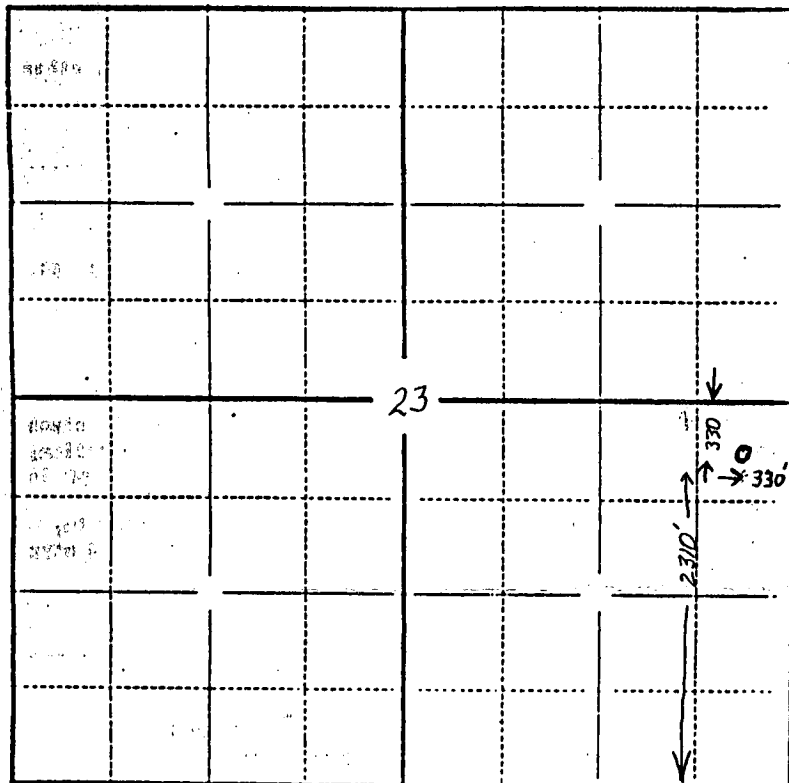

In plotting the proposed location of the well, you must show:

- 1) The manner in which you are using the depicted plat by identifying section lines, i.e. 1 section, 1 section with 8 surrounding sections, 4 sections, etc.;
- 2) the distance of the proposed drilling location from the section's south/north and east/west lines; and
- 3) the distance to the nearest lease or unit boundary line.