

EFFECTIVE DATE: 7-22-95

State of Kansas

DISTRICT # 2

CATHODIC PROTECTION BOREHOLE INTENT DRAFT

ALL BLANKS MUST BE FILLED IN

SGA? Yes / No

Must be approved by the K.C.C. sixty (60) days prior to commencing well.

152'S & 318'E

Expected Spud (Starting) Date 7.....24.....95.....  
month day year

Spot (Location) Q/Q/Q East  
SE... SE... SW... Sec 23. Twp 12. S, Rg 1... X West  
.....178.. feet from South / North line of Section  
.....2628.. feet from East / West line of Section  
(Circle directions from nearest outside corner boundaries)

OPERATOR: License # ...5952.....

IS SECTION X REGULAR \_\_\_\_\_ IRREGULAR?  
(Spot well on the Section Plat on Reverse Side)  
County: Ottawa.....

Name: Amoco Pipeline Company.....

Address: P.O. Box 246.....

City/State/Zip: Watkins, CO 80137.....

Contact Person: Bob Gilmister.....

Lease Name: APL #0020..... Well #: 3.....

Phone: (303) 261-0453.....

Facility Name: Niles Station.....

Ground Surface Elevation: 1250..... MSL

Cathodic Borehole Total Depth 250..... ft. ✓

Depth to Bedrock ..... ft.

CONTRACTOR: License # Will advise on ACO-1.....

Name: .....  
.....

Type Drilling Equipment: X Mud Rotary .... Cable  
..... Air Rotary .... Other

WATER INFORMATION:

Aquifer Penetration: .... None X Single .... Multiple

Depth to bottom of fresh water: 70.....

Depth to bottom of usable water: .....

Water well within one-quarter mile: X yes .... no

Public water supply well within one mile: .... yes X no

Water Source for Drilling Operations:

.... well .... farm pond .... stream X other

Water Well Location: .....

DWR Permit #: .....

Standard Dimension Ratio (SDR) is = SC-40 PVC.....

(cathodic surface OD csg. in inches / MWT in inches = SDR)

CONSTRUCTION FEATURES

Length of Cathodic Surface (Non-Metallic) Casing 70'

Planned to be set: ..... 20..... ft.

Length of Conductor pipe (if any?): N/A..... ft.

Size of the borehole (I.D.): 14"..... 7-7/8..... inches

Cathodic surface casing size: 7-7/8"..... 14..... inches

Cathodic surface casing centralizers set at depths of: 20;

40; 60; ..... ; ..... ; ..... ; ..... ; ..... ; ..... ; .....

Cathodic surface casing will terminate at:

... Above surface ... Surface Vault X Below Surface Vault

Annular space between borehole and casing will be grouted

with: .... Concrete .... Bentonite Cement

..... Neat cement ..... X Bentonite clay

Pitless casing adaptor will be used: X (Yes) / No at Depth 2..ft.

Anode vent pipe will be set at: 4.. ft. above surface

Anode installation depths are: 1.10 ; 1.20 ; 1.30 ; 1.40 ;

Anode conductor (backfill) material TYPE: Loresco SC-2

1.50 ; 1.60 ; 1.70 ; 1.80 ; 1.90 ; 2.00 ; 2.10 ; 2.20 ; 2.30 ;

Depth to BASE of Backfill installation material: 250ft.

240 , 250

Depth to TOP of Backfill installation material : 90ft.

AFFIDAVIT

The undersigned hereby affirms that the drilling, completion and eventual plugging of this well will comply with K.S.A. 55-101, et. seq. It is agreed that the following minimum requirements will be met:

1. Notify the appropriate district office prior to spudding of and again before plugging well;
2. A copy of the approved notice of intent to drill shall be posted on each drilling rig;
3. The minimum amount of cathodic surface casing as specified below shall be set by grouting to the top.
4. An agreement between the operator and the district office on plugs and placement is necessary prior to plugging;
5. The appropriate district office will be notified before well is either plugged or casing is grouted in;
6. IN ALL CASES, NOTIFY DISTRICT OFFICE PRIOR TO ANY CEMENTING.

I hereby certify that the statements made herein are true and to the best of my knowledge and belief.

Date: 6/6/95..... Signature of Operator or Agent: Bob Gilmister..... Title: Corrosion Specialist

RECEIVED  
STATE CORPORATION COMMISSION  
JUN 7 6-13-1995  
CORROSION DIVISION  
WICHITA, KANSAS

FOR KCC USE:  
 API # 15- 143-200090000  
 Conductor pipe required NONE feet  
 Minimum cathodic surface casing required 70' feet  
 Approved by: JK 7-17-95  
 MAXIMUM WELL DEPTH = 250'  
 This authorization expires: 1-17-96  
 (This authorization void if drilling not started within  
 6 months of effective date.)  
 Spud date: \_\_\_\_\_ Agent: \_\_\_\_\_

REMEMBER TO:

- File Drill Pit Application (form CDP-1) with Intent to Install;
- File Completion Form CB-2 within 30 days of spud date;
- Notify appropriate district office 48 hours prior to workover or re-entry;
- Submit plugging report (CB-4) within 30 days after plugging is completed.

Mail to: Conservation Division, 200 Colorado Derby Building, 202 W. First St., Wichita, Kansas 67202-1286.

23  
12  
13

cathodic borehole. Please show all the wells, existing cathodic boreholes, pipelines or facilities within 1/2 mile of the proposed borehole.

API NO. 15- \_\_\_\_\_  
 OPERATOR \_\_\_\_\_  
 LEASE \_\_\_\_\_  
 WELL NUMBER \_\_\_\_\_  
 FACILITY NAME \_\_\_\_\_

LOCATION OF WELL: COUNTY Ottawa  
2628 feet from south/north line of section  
178 feet from east/west line of section  
 SECTION 23 TWP 12S RG 1W

SPOT: QTR/QTR/QTR/QTR OF ACREAGE  
 \_\_\_\_\_ - \_\_\_\_\_ - \_\_\_\_\_ - \_\_\_\_\_

IS SECTION X REGULAR or \_\_\_\_\_ IRREGULAR  
IF SECTION IS IRREGULAR, LOCATE WELL FROM NEAREST CORNER BOUNDARY.

Section corner used: \_\_\_\_\_ NE \_\_\_\_\_ NW \_\_\_\_\_ SE \_\_\_\_\_ SW

**PLAT**

(Show location of intended cathodic borehole.)

(Show footage from nearest lease, unit or outside section boundary line.)

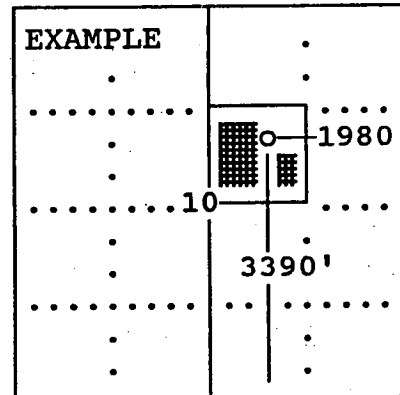
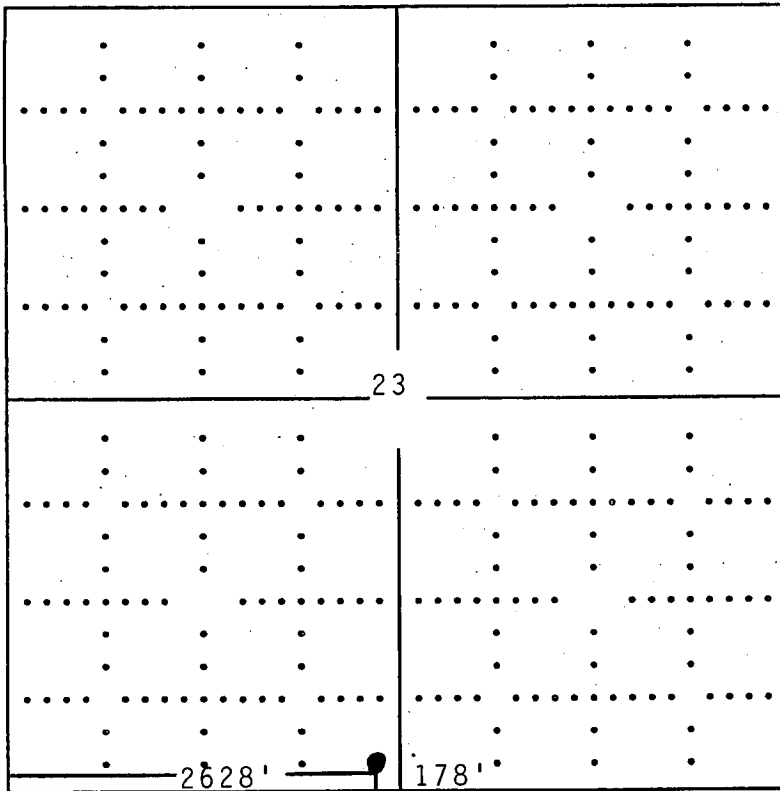

SEWARD CO.

In plotting the proposed location of the well, you must show:

- 1) The manner in which you are using the depicted plat by identifying section lines, i.e. 1 section, 1 section with 8 surrounding sections, 4 sections, etc.;
- 2) the distance of the proposed drilling location from the section's south/north and east/west; and
- 3) the distance to the nearest lease, unit or outside section boundary line.