

ORIGINAL

KANSAS CORPORATION COMMISSION
OIL & GAS CONSERVATION DIVISION

Form ACO-1
October 2008
Form Must Be Typed

WELL COMPLETION FORM
WELL HISTORY - DESCRIPTION OF WELL & LEASE

OPERATOR: License # 30537
Name: Venture Resources, Inc.
Address 1: P.O. Box 101234
Address 2: _____
City: Denver State: CO Zip: 80250 + 1234
Contact Person: Ron Mackey
Phone: (303) 722-2899
CONTRACTOR: License # 32028
Name: Chito's Well Service, LLC
Wellsite Geologist: None/ Production Man, John Cearley
Purchaser: NA

Designate Type of Completion:
____ New Well ____ Re-Entry Workover
____ Oil SWD ____ SIOW
____ Gas ____ ENHR ____ SIGW
____ CM (Coal Bed Methane) ____ Temp. Abd.
____ Dry ____ Other _____
(Core, WSW, Expl., Cathodic, etc.)

If Workover/Re-entry: Old Well Info as follows:
Operator: Helmerich & Payne, Inc.
Well Name: Roy Carmichael #10
Original Comp. Date: 2-28-86 Original Total Depth: 3480'
 Deepening ____ Re-perf. ____ Conv. to Enhr. Conv. to SWD
____ Plug Back: _____ Plug Back Total Depth
____ Commingled Docket No.: _____
____ Dual Completion Docket No.: _____
____ Other (SWD or Enhr.?) Docket No.: D-30121
12-18-08 2-04-09 2-09-09
Spud Date or Date Reached TD Completion Date or Recompletion Date

API No. 15 - 051-34,387-0003
Spot Description: _____
____ SW ____ SE ____ Sec. 4 Twp. 11 S. R. 17 East West
430 Feet from North / South Line of Section
930 Feet from East / West Line of Section
Footages Calculated from Nearest Outside Section Corner:
 NE NW SE SW
County: Ellis
Lease Name: Roy Carmichael Well #: 10
Field Name: U. Turkville NW
Producing Formation: Conglomerate
Elevation: Ground: 1828' Kelly Bushing: 1833'
Total Depth: 3710 Plug Back Total Depth: NA
Amount of Surface Pipe Set and Cemented at: 262 Feet
Multiple Stage Cementing Collar Used? Yes No
If yes, show depth set: 1146' Feet
If Alternate II completion, cement circulated from: 1146
feet depth to: Surface w/ 300 ^{sq. cmt.} Art. Dig. 7/6/09

Drilling Fluid Management Plan
(Data must be collected from the Reserve Pit)
Chloride content: Fresh ppm Fluid volume: 80 bbls
Dewatering method used: NA
Location of fluid disposal if hauled offsite:
Operator Name: Venture Resources, Inc.
Lease Name: Ridler A-W License No.: 30537
Quarter NW Sec. 12 Twp. 11 S. R. 18 East West
County: Ellis Docket No.: 34,293-C (C-1764)

INSTRUCTIONS: An original and two copies of this form shall be filed with the Kansas Corporation Commission, 130 S. Market - Room 2078, Wichita, Kansas 67202, within 120 days of the spud date, recompletion, workover or conversion of a well. Rule 82-3-130, 82-3-106 and 82-3-107 apply. Information of side two of this form will be held confidential for a period of 12 months if requested in writing and submitted with the form (see rule 82-3-107 for confidentiality in excess of 12 months). One copy of all wireline logs and geologist well report shall be attached with this form. ALL CEMENTING TICKETS MUST BE ATTACHED. Submit CP-4 form with all plugged wells. Submit CP-111 form with all temporarily abandoned wells.

All requirements of the statutes, rules and regulations promulgated to regulate the oil and gas industry have been fully complied with and the statements herein are complete and correct to the best of my knowledge.

Signature: _____
Title: Landman Date: June 5, 2009
Subscribed and sworn to before me this 5 day of June, 2009.
Notary Public: _____
Date Commission Expires: _____

GREGORY L MACKAY
Notary Public
State of Colorado

My Commission Expires October 16, 2010

KCC Office Use ONLY *(Art. AE' stat. by ZS 6/10/09)*
 Letter of Confidentiality Received
 If Denied, Yes Date: _____
 Wireline Log Received
 Geologist Report Received
 UIC Distribution

RECEIVED
JUN 08 2009

KCC WICHITA

RECEIVED

JUN 08 2009

KCC WICHITA

Operator Name: Venture Resources, Inc. Lease Name: Roy Carmichael Well #: 10
 Sec. 4 Twp. 11 S. R. 17 East West County: Ellis

INSTRUCTIONS: Show important tops and base of formations penetrated. Detail all cores. Report all final copies of drill stems tests giving interval tested, time tool open and closed, flowing and shut-in pressures, whether shut-in pressure reached static level, hydrostatic pressures, bottom hole temperature, fluid recovery, and flow rates if gas to surface test, along with final chart(s). Attach extra sheet if more space is needed. Attach copy of all Electric Wireline Logs surveyed. Attach final geological well site report.

Drill Stem Tests Taken Yes No
 (Attach Additional Sheets)

Samples Sent to Geological Survey Yes No

Cores Taken Yes No

Electric Log Run Yes No
 (Submit Copy)

List All E. Logs Run:

R. A. Guard Log

Log Formation (Top), Depth and Datum Sample

Name	Top	Datum
Topeka	2779'	-946'
Heebner	3009'	-1176'
Toronto	3032'	-1199'
Lansing	3052'	-1219'
BKC	3287'	-1404'
Conglomerate	3308'	-1425'
Arbuckle	3406'	-1523'

CASING RECORD <input checked="" type="checkbox"/> New <input type="checkbox"/> Used							
Report all strings set-conductor, surface, intermediate, production, etc.							
Purpose of String	Size Hole Drilled	Size Casing Set (In O.D.)	Weight Lbs. / Ft.	Setting Depth	Type of Cement	# Sacks Used	Type and Percent Additives
Surface	12 1/4"	8 5/8"	24#	266'	Class A	150	3%CC, 2% gel
Prod. 1-Stage	7 7/8"	5 1/2"	14#	3480'	Class A	150	Surefill
Prod. 2-Stage	7 7/8"	5 1/2"	14#	1146'	Lt. Weight	300	

ADDITIONAL CEMENTING / SQUEEZE RECORD				
Purpose:	Depth Top Bottom	Type of Cement	#Sacks Used	Type and Percent Additives
<input type="checkbox"/> Perforate <input type="checkbox"/> Protect Casing <input type="checkbox"/> Plug Back TD <input checked="" type="checkbox"/> Plug Off Zone	3333-3364	Common	150	

Shots Per Foot	PERFORATION RECORD - Bridge Plugs Set/Type	Acid, Fracture, Shot, Cement Squeeze Record	Depth
	Specify Footage of Each Interval Perforated	(Amount and Kind of Material Used)	
4	3333-3340, 3344-3354, 3358-3364 (Original perfs and acid/frac job)	2000 gal 7%, Frac w/30000 gal. x-linked Purgel w/ 2000# 100 mesh sd. 30000 sx. 20-40 sd. & 15000# 12-20 sd.	3333-64
Remarks	SQZD, Prod. Perfs. w/150 sks., small lk. polymer w/12 bbl lk block		

TUBING RECORD:		Size:	Set At:	Packer At:	Liner Run:
		2 3/8"	3444'	3444'	<input type="checkbox"/> Yes <input checked="" type="checkbox"/> No
Date of First, Resumed Production, SWD or Enhr.		Producing Method:			
MIT 5-12-2009, Permit approval 6-01-2009		<input type="checkbox"/> Flowing <input type="checkbox"/> Pumping <input type="checkbox"/> Gas Lift <input type="checkbox"/> Other (Explain)			
Estimated Production Per 24 Hours	Oil Bbbs.	Gas Mcf	Water Bbbs.	Gas-Oil Ratio	Gravity
	NA	NA	NA	NA	NA

Don't allow off spec. on logs for you

DISPOSITION OF GAS:	METHOD OF COMPLETION:	PRODUCTION INTERVAL:
<input type="checkbox"/> Vented <input type="checkbox"/> Sold <input type="checkbox"/> Used on Lease (If vented, Submit ACO-18.)	<input checked="" type="checkbox"/> Open Hole <input type="checkbox"/> Perf. <input type="checkbox"/> Dually Comp. <input type="checkbox"/> Commingled <input type="checkbox"/> Other (Specify) _____	_____ _____

RECEIVED
JUN 08 2009

S. C. SIDE ONE

STATE CORPORATION COMMISSION OF KANSAS
OIL & GAS CONSERVATION DIVISION

WELL COMPLETION OR RECOMPLETION FORM
ACO-1 WELL HISTORY

DESCRIPTION OF WELL AND LEASE:

Operator: License # 5293
Name Helmerich & Payne, Inc.
Address P.O. Box 558
City/State/Zip Garden City, KS 67846

Purchaser Mobil

Operator Contact Person Millard Lindsay
Phone 316-276-3693

Contractor: License # 9087
Name R & C Drilling Co., Inc.

Wellsite Geologist Alan Downing
Phone 913-625-2993

Designate Type of Completion
 New Well Re-Entry Workover
 Oil SWD Temp Abd
 Gas Inj Delayed Comp.
 Dry Other (Core, Water Supply etc.)

If OWMO: old well info as follows:
Operator
Well Name
Comp. Date Old Total Depth

WELL HISTORY

Drilling Method:
 Mud Rotary Air Rotary Cable
1-22-86 1-30-86 2-28-86
Spud Date Date Reached TD Completion Date
3480' 3467' State Test
Total Depth PBDT 3-24-86

Amount of Surface Pipe Set and Cemented at 266' feet
Multiple Stage Cementing Collar Used? Yes No
If yes, show depth set 1146 feet
If alternate 2 completion, cement circulated from 1146 feet depth to Surf w/ 300 SX cmt
by B.J. Titan Services # 279374

API No. 15-051-24,387
County Ellis
SW SE SE Sec. 4 Twp. 11 Rge. 17 East West

KCC WICHITA

430 Ft North from Southeast Corner of Section
930 Ft West from Southeast Corner of Section
(Note: Locate well in section plat below)

Lease Name Roy Carmichael Well # 10

Field Name U. Turkville NW

Producing Formation Conglomerate

Elevation: Ground 1828' KB 1833'

Section Plat

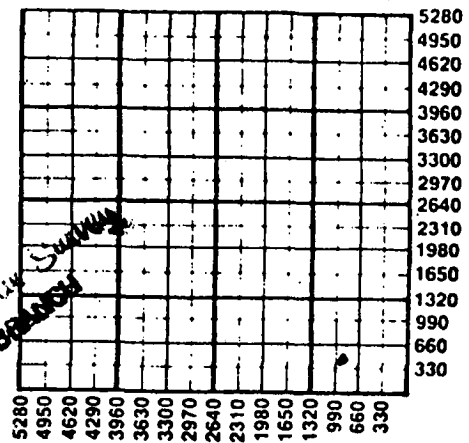

WATER SUPPLY INFORMATION
Disposition of Produced Water: Disposal Repressuring
Docket #

Questions on this portion of the ACO-1 call:
Water Resources Board (913) 296-3717

Source of Water:
Division of Water Resources Permit #
 Groundwater.....Ft North from Southeast Corner (Well)Ft West from Southeast Corner of Sec Twp Rge East West
 Surface Water.....Ft North from Southeast Corner (Stream, pond etc).....Ft West from Southeast Corner Sec Twp Rge East West
 Other (explain).....
(purchased from city, R.W.D. #)
Hauled by private contractor from Saline River

INSTRUCTIONS: This form shall be completed in duplicate and filed with the Kansas Corporation Commission, 200 Colorado Derby Building, Wichita, Kansas 67202, within 90 days after completion or recompletion of any well. Rule 82-3-130 and 82-3-107 apply.
Information on side two of this form will be held confidential for a period of 12 months if requested in writing and submitted with the form. See rule 82-3-107 for confidentiality in excess of 12 months.
One copy of all wireline logs and drillers time log shall be attached with this form. Submit CP-4 form with all plugged wells. Submit CP-111 form with all temporarily abandoned wells.

SIDE TWO

Operator Name Helmerich & Payne, Inc. Lease Name Roy Carmichael Well # 10

Sec. 4 Twp. 11 Rge. 17 East West County Ellis

METHOD OF COMPLETION

Production Interval

Disposition of gas: Vented Open Hole Perforation
 Sold Other (Specify) 3333 - 3340
 Used on Lease

None Dually Completed 3344 - 3354
 Conmingled 3358 - 3364
 pressure reached static level, hydrostatic pressures, bottom hole temperature, fluid recovery, and flow rates if gas to surface during test. Attach extra sheet if more space is needed. Attach copy of log.

Drill Stem Tests Taken Yes No
 Samples Sent to Geological Survey Yes No
 Cores Taken Yes No

Formation Description
 Log Sample

0' to 189' Sand & Shale & Post Rock
 189' to 1067' Sand & Shale
 1067' to 1100' Anhydrite
 1100' to 1660' Sand & Shale
 1660' to 2435' Shale
 2435' to 3330' Lime & Shale
 3330' to 3352' Shale & Conglomerate
 3352' to 3369' Conglomerate
 3369' to 3399' Lime & Shale
 3399' to 3440' Arbuckle
 3440' to 3480' Shale & Lime R.T.D.

Name	Top	Bottom
Topeka	2779	
Heebner	3009	
Toronto	3032	
LKC	3052	
BKC	3287	
Conglomerate	3308	
Arbuckle	3406	

RECEIVED
 JUN 08 2009
 KCC WICHITA

Zones of Interest

LKC "F"	3130 - 3134	14% ϕ N	38%SW
Conglom.	3332 - 3340	22% ϕ N	32%SW
Conglom.	3344 - 3355	15% ϕ N	30%SW
Conglom.	3358 - 3366	12% ϕ N	31%SW

Core #1 - 3330 - 3351 Recovered 14', Lost 7' Shale, Sandstone & chert
 Core #2 - 3351 - 3358 Recovered 7' chert w/ interbedded ss.
 Core #3 - 3358 - 3369 Recovered 11' shale & chert

Estimated Production Per 24 Hours	Oil	Gas	Water	Gas-Oil Ratio	Gravity
	52.3 Bbls	MCF	56.7 Bbls	CFPB	30.3

Size Note	Size Casing	Height	Setting Depth	Type of Cement	#Sacks Used	Percent Additives	
Surface	12"	8 5/8"	24'	266'	Class A	150	3%CC, 2%gel.
Prod. 1 Stage	7 7/8"	5"	14'	3480'	Class A	150	Surfill
Prod. 2 Stage	7 7/8"	5"	14'	1146'	Lt. weight	300	

PERFORATION RECORD	Acid, Fracture, Shot, Cement Squeeze Record (Amount and Kind of Material Used)
Shots Per Foot Specify Footage of Each Interval Perforated	Depth
1 3333 - 3340	2000 gal 7% HCL
1 3344 - 3354	Frac. w/ 30000 gal. x-linked
1 3358 - 3364	Purge. w/ 2000# 100 mesh sand & 30000 #20-40 sand & 15000 #12-20 sand

TUBING RECORD Size 2 3/8 Set At 3309 Packer at _____ Liner Run Yes No

Date of First Production 2-28-86 Producing Method Flowing Pumping Gas Lift Other (explain).....



COPY

THE STATE CORPORATION COMMISSION
OF THE STATE OF KANSAS
CONSERVATION DIVISION

DISPOSAL WELL PERMIT

Oper. License #: 30537

Permit #: D-30,121

Operator: Venture Resources, Inc.

Well Name & No.: Roy Carmichael #10

Address: 2255 S. Wadsworth, STE 205

Location: 430°FSL 930°FEL

City: Lakewood

Sec. 4 TWP 11 RGE 17 (E) (W)

State: Colorado

County: Ellis

Zip Code: 80227

Field Name: Upper Turkville

Project Acreage: S/2 Sec 4-11-17W

RECEIVED
JUN 08 2009
KCC WICHITA

After reviewing the operator's application for Disposal Well Permit dated February 19, 2008, the Conservation Division grants a permit for the injection of produced saltwater or other fluids approved by the Conservation Division. The permitted well is subject to the specifications and requirements of this permit including any attachments or any attached amendments.

- > The injection formation is known as the Arbuckle.
- > The depth of the permitted injection interval is from 3480' to 3710', (PF), (OH)
- > The maximum authorized injection rate is 1500 barrels of fluid per day.
- > The maximum authorized injection pressure is 0 PSIG.
- > Yearly MIT's
- > Attachment YES, NO.

Complete casing information is as follows:

	<u>SIZE</u>	<u>SEAT DEPTH</u>	<u>INTERVAL CEMENTED</u>	<u>SACKS CEMENT USED</u>
Surface	8 5/8"	262'	0' to 262'	150
Production	5 1/2"	3480'	2580' to 3480'	150
Tubing	2 3/8"	3444'		

Additional Cementing: DV Tool @ 1146'. Cement to surface w/300 sxs. Squeeze perforations from 3333' to 3364' w/150 sxs

Packer type and setting depth: AD-1 set @ 3610'

Well(s), Leases(s) and Facilities supplying fluid for injection:

Lease Operator	Lease Name	Lease Description
H & C Operating	Simpson 'A'	W/2 Sec 3-11-17W
Venture Resources, Inc.	Orlan Carmichael	NE/4 Sec 4-11-17W
Venture Resources, Inc.	Roy Carmichael	S/2 Sec 4-11-17W
Venture Resources, Inc.	Simpson 'D'	NE/4 Sec 9-11-17W
Venture Resources, Inc	Evelyn	W/2 NW/4 10-11-17W

In addition to the specific permit conditions and requirements set out above or on the attachment hereto, this permit is subject to all of the provisions of K.A.R. 83-3-400 et seq. Injection authority cannot be transferred without approval of the Conservation Division.

Date of Approval: June 1, 2009

Director, Underground Injection Control
Conservation Division

RECEIVED

JUN 08 2009

KCC WICHITA

5 1/2" csg. coat / 7.85 ST
HELMERICH & PAYNE, INC.
MORNING REPORT FORM

NAME Armstrong	NO 10	DATE 1/31/86	DAYS 9	PREP OPERATION W.O.C.	DEPTH 3480	FOOTAGE 40	ROT HRS 2
CONTRACTOR R&C	RIG NO 1	BOG	CONN GAS	TRIP GAS	FLARE	BIT WEIGHT 35	RPM 65
FORMATIONS Pol	EFF #1 90	SPM #1 64	OPB #2	EFF #2	SPM #2	GPM 287	PUMP PSI 1000
SIZE 2.5	DC SIZE 6.25	DP AV 166	DC AV 303	IMPACT FORCE	HP/50 IN	OVER PULL	TORQUE
SIZE 2.6	VISCOSITY 52	PV 10122	VP 14116	OELS 11	HT-HP	PH 6.5	CHLORIDES 56000
TR	SAND OUT	SOLIDS 6	NITRATES 40	OIL	LCM	BBLs LOST	MISC
SIZE 2.3	SIZE 2 7/8	MFR HTC	TYPE J22	API CODE	JET #1 13	JET #2 13	JET #3 13
DEPTH OUT 3480	FOOTAGE 52	HRS 5.5	FTAIR 9.4	CUM ROT HRS 149.75	T 1	B 1	SERIAL #

WELL DEPTH 3480	DEGREES 2°	DIRECTION	WL <input type="checkbox"/>	DROP <input checked="" type="checkbox"/>	TELEDIFT <input type="checkbox"/>
Dry Hole COST R.C.C. W.O.C.	43107	38940	82047		

1590 ITEM 224	DAILY COST
ROADS & LOCATION CHARGES	2345
CONTRACTOR CHARGES	113
FOOTAGE, DAY WORK, COMP., WO	8088
DAILY MUD COST	675
CEMENTING SERVICE & FLOAT EQUIPMENT	27365
ELECTRIC LOGGING	436
CORNING-DRIFT-EMT CSQ Crew	270
MUD LOGGING	
DIRECTIONAL DRLG. & SVYS.	
FISHING TOOLS & SERVICES	
WATER, FUEL, BITS (Csg.)	
EQUIPMENT RENTALS	
TRUCKING 178/5 1/2"	
GENERAL: 52 Blast	
MISC. LABOR & SERVICES	
SUPERVISION	
DAILY WELL COST	39516
PREV. CUM. COST	42531
INV. COST	
CUM. WELL COST	82047
CUM. MUD COST	
CUM. BIT COST	2423

HOURS	ACTIVITY
1.25	S.R.
2	O. (Reached T.D. 3480 9:15)
2	C.C. mud for logs
1.5	Made S.T. (10 STD)
1.5	C.C. mud
1.75	T.H. for logs (Strong Noconn)
1.25	Logging w/ Great Hand
1.50	T.H.
1.75	C.C. mud
2	L.D. DP & DC
3	Rh & Run 5 1/2" Csg.
1.50	Cutting w/ B.T.
5	W.O.C. & Released Rig
	2 1/2 L 10
	10 in Co Time
	TOTAL HOURS

ITEMS	OD	ITEM	ID	THREAD	LENGTH	W/FT	WEIGHT
27 JTS	5 1/2" OD	14# Baker D.V. Tool	14#	K-55 STK	82L	1095.64	
55 JTS	5 1/2" OD	Insert float valve	14#	K-55 STK	82L	1.68	
1 JTS	5 1/2" OD	Accident shoe	14#	K-55 STK	82L	2376.61	
23 JTS		total Csg string				11.96	
23 JTS		total Csg (3489.21')				1.00	
n 20		Wire loop scratched spaced				3486.89	
Controlizer on JTS # 1, # 3.		LONG STRAIN DRILL PIPE				6.88	
1		MANUFACTURER		MODEL		3480.00	
2		Pen Art Basket		Two Controlizer or D.V. Tool		200'	

TOUR MORN	REACTION TIME 6:00	FT DOWN ON KELLY Said to tested csg on B.T.M	DRILLING FOREMAN JAY L Roy
--------------	-----------------------	---	-------------------------------