



KANSAS CORPORATION COMMISSION  
OIL & GAS CONSERVATION DIVISION

1023919

Form C-1  
October 2007

Form must be Typed  
Form must be Signed  
All blanks must be Filled

For KCC Use:  
Effective Date: 09/30/2008  
District # 3  
SGA?  Yes  No

**NOTICE OF INTENT TO DRILL**  
Must be approved by KCC five (5) days prior to commencing well

Expected Spud Date: 09/30/2008  
month day year

OPERATOR: License# 33539  
Name: Cherokee Wells LLC  
Address 1: P.O. Box 296  
Address 2:  
City: Fredonia State: KS Zip: 66736 +  
Contact Person: Tracy Miller  
Phone: 6203783650

CONTRACTOR: License#  
Name: Advise on ACO-1 -- Must be licensed by KCC

Well Drilled For:  Oil  Gas  Seismic; # of Holes  Other  
Well Class:  Enh Rec  Storage  Disposal  Other  
Type Equipment:  Infield  Pool Ext.  Wildcat  Mud Rotary  Air Rotary  Cable

If OWWO: old well information as follows:  
Operator:  
Well Name:  
Original Completion Date: Original Total Depth:

Directional, Deviated or Horizontal wellbore?  Yes  No  
If Yes, true vertical depth:  
Bottom Hole Location:  
KCC DKT #:

Spot Description:  
- SW - SW Sec. 20 Twp. 28 S. R. 14  E  W  
660 feet from  N /  S Line of Section  
660 feet from  E /  W Line of Section

Is SECTION:  Regular  Irregular?  
(Note: Locate well on the Section Plat on reverse side)

County: Wilson  
Lease Name: L. Collins Well #: A-4  
Field Name: Cherokee Basin Coal Gas Area

Is this a Prorated / Spaced Field?  Yes  No  
Target Formation(s): Mississippian

Nearest Lease or unit boundary line (in footage): 660  
Ground Surface Elevation: 972 Estimated Estimated feet MSL  
Water well within one-quarter mile:  Yes  No  
Public water supply well within one mile:  Yes  No

Depth to bottom of fresh water: 100  
Depth to bottom of usable water: 200  
Surface Pipe by Alternate:  I  II  
Length of Surface Pipe Planned to be set: 40

Length of Conductor Pipe (if any):  
Projected Total Depth: 1350  
Formation at Total Depth: Mississippian

Water Source for Drilling Operations:  
 Well  Farm Pond  Other:  
DWR Permit #:

(Note: Apply for Permit with DWR )  
Will Cores be taken?  Yes  No  
If Yes, proposed zone:

**AFFIDAVIT**

The undersigned hereby affirms that the drilling, completion and eventual plugging of this well will comply with K.S.A. 55 et. seq.  
It is agreed that the following minimum requirements will be met:

- 1. Notify the appropriate district office prior to spudding of well;
- 2. A copy of the approved notice of intent to drill shall be posted on each drilling rig;
- 3. The minimum amount of surface pipe as specified below shall be set by circulating cement to the top; in all cases surface pipe shall be set through all unconsolidated materials plus a minimum of 20 feet into the underlying formation.
- 4. If the well is dry hole, an agreement between the operator and the district office on plug length and placement is necessary prior to plugging;
- 5. The appropriate district office will be notified before well is either plugged or production casing is cemented in;
- 6. If an ALTERNATE II COMPLETION, production pipe shall be cemented from below any usable water to surface within 120 DAYS of spud date. Or pursuant to Appendix "B" - Eastern Kansas surface casing order #133,891-C, which applies to the KCC District 3 area, alternate II cementing must be completed within 30 days of the spud date or the well shall be plugged. In all cases, NOTIFY district office prior to any cementing.

**Submitted Electronically**

For KCC Use ONLY  
API # 15 - 15-205-27684-00-00  
Conductor pipe required 0 feet  
Minimum surface pipe required 40 feet per ALT.  I  II  
Approved by: Rick Hestermann 11/12/2008  
This authorization expires: 09/25/2009  
(This authorization void if drilling not started within 12 months of approval date.)  
Spud date: Agent:

**Remember to:**

- File Drill Pit Application (form CDP-1) with Intent to Drill;
- File Completion Form ACO-1 within 120 days of spud date;
- File acreage attribution plat according to field proration orders;
- Notify appropriate district office 48 hours prior to workover or re-entry;
- Submit plugging report (CP-4) after plugging is completed (within 60 days);
- Obtain written approval before disposing or injecting salt water.
- If this permit has expired (See: authorized expiration date) please check the box below and return to the address below.

Well Not Drilled - Permit Expired Date: Signature of Operator or Agent:

20 28 14  E  W



**IN ALL CASES PLOT THE INTENDED WELL ON THE PLAT BELOW**

*Plat of acreage attributable to a well in a prorated or spaced field*

**If the intended well is in a prorated or spaced field, please fully complete this side of the form.** If the intended well is in a prorated or spaced field complete the plat below showing that the well will be properly located in relationship to other wells producing from the common source of supply. Please show all the wells and within 1 mile of the boundaries of the proposed acreage attribution unit for gas wells and within 1/2 mile of the boundaries of the proposed acreage attribution unit for oil wells.

API No. 15 - 15-205-27684-00-00  
 Operator: Cherokee Wells LLC  
 Lease: L. Collins  
 Well Number: A-4  
 Field: Cherokee Basin Coal Gas Area

Location of Well: County: Wilson  
660 feet from  N /  S Line of Section  
660 feet from  E /  W Line of Section  
 Sec. 20 Twp. 28 S. R. 14  E  W

Number of Acres attributable to well: \_\_\_\_\_  
 QTR/QTR/QTR/QTR of acreage: \_\_\_\_\_ - \_\_\_\_\_ - SW - SW

Is Section:  Regular or  Irregular

**If Section is Irregular, locate well from nearest corner boundary.**

Section corner used:  NE  NW  SE  SW

**PLAT**

*(Show location of the well and shade attributable acreage for prorated or spaced wells.)*

*(Show footage to the nearest lease or unit boundary line.)*

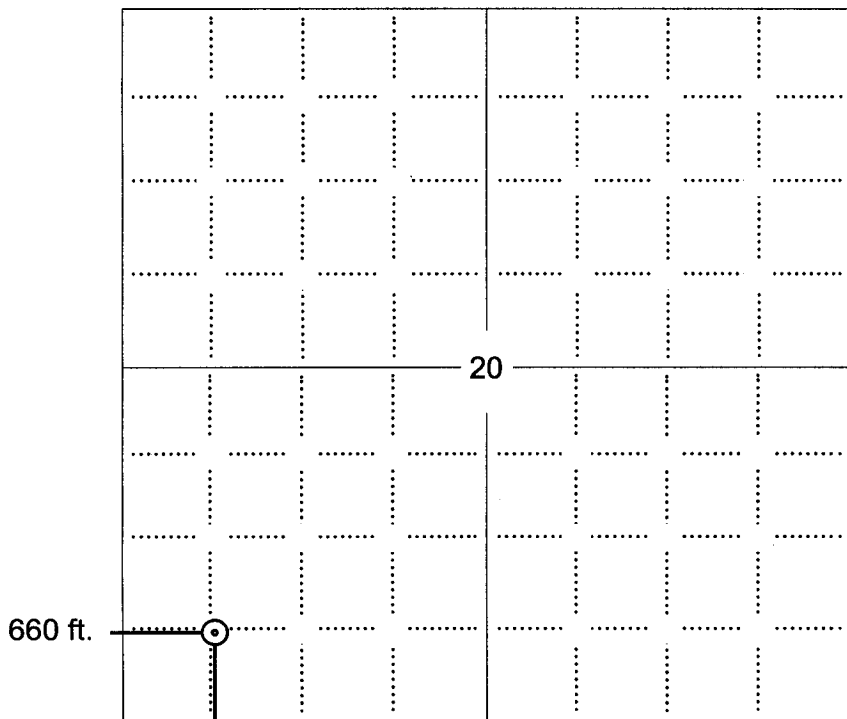

**NOTE: In all cases locate the spot of the proposed drilling location.**

660 ft.

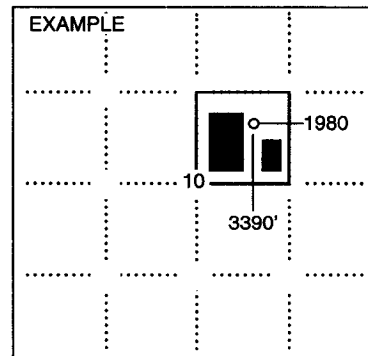

SEWARD CO.

**In plotting the proposed location of the well, you must show:**

1. The manner in which you are using the depicted plat by identifying section lines, i.e. 1 section, 1 section with 8 surrounding sections, 4 sections, etc.
2. The distance of the proposed drilling location from the south / north and east / west outside section lines.
3. The distance to the nearest lease or unit boundary line (in footage).
4. If proposed location is located within a prorated or spaced field a certificate of acreage attribution plat must be attached: (CO-7 for oil wells; CG-8 for gas wells).

CORRECTION #1



KANSAS CORPORATION COMMISSION 1023919  
OIL & GAS CONSERVATION DIVISION

Form CDP-1  
April 2004  
Form must be Typed

## APPLICATION FOR SURFACE PIT

Submit in Duplicate

Operator Name: Cherokee Wells LLC		License Number: 33539	
Operator Address: P.O. Box 296		Fredonia KS 66736	
Contact Person: Tracy Miller		Phone Number: 6203783650	
Lease Name & Well No.: L. Collins A-4		Pit Location (QQQQ): _____ - _____ - SW - SW	
Type of Pit: <input type="checkbox"/> Emergency Pit <input type="checkbox"/> Burn Pit <input type="checkbox"/> Settling Pit <input checked="" type="checkbox"/> Drilling Pit <input type="checkbox"/> Workover Pit <input type="checkbox"/> Haul-Off Pit <i>(If WP Supply API No. or Year Drilled)</i>		Pit is: <input checked="" type="checkbox"/> Proposed <input type="checkbox"/> Existing If Existing, date constructed: _____ Pit capacity: 800 (bbls)	
Is the pit located in a Sensitive Ground Water Area? <input type="checkbox"/> Yes <input checked="" type="checkbox"/> No		Chloride concentration: _____ mg/l <i>(For Emergency Pits and Settling Pits only)</i>	
Is the bottom below ground level? <input checked="" type="checkbox"/> Yes <input type="checkbox"/> No		Artificial Liner? <input type="checkbox"/> Yes <input checked="" type="checkbox"/> No	
How is the pit lined if a plastic liner is not used? Natural Clay & Earth			
Pit dimensions (all but working pits):    30    Length (feet)    40    Width (feet) <input type="checkbox"/> N/A: Steel Pits Depth from ground level to deepest point:    6    (feet) <input type="checkbox"/> No Pit			
If the pit is lined give a brief description of the liner material, thickness and installation procedure.		Describe procedures for periodic maintenance and determining liner integrity, including any special monitoring.	
Distance to nearest water well within one-mile of pit _____ feet    Depth of water well _____ feet		Depth to shallowest fresh water _____ feet. Source of information: <input type="checkbox"/> measured <input type="checkbox"/> well owner <input type="checkbox"/> electric log <input checked="" type="checkbox"/> KDWR	
<b>Emergency, Settling and Burn Pits ONLY:</b> Producing Formation: _____ Number of producing wells on lease: _____ Barrels of fluid produced daily: _____ Does the slope from the tank battery allow all spilled fluids to flow into the pit? <input type="checkbox"/> Yes <input type="checkbox"/> No		<b>Drilling, Workover and Haul-Off Pits ONLY:</b> Type of material utilized in drilling/workover: Fresh Water Number of working pits to be utilized: 1 Abandonment procedure: Allow to Dry, Level Surface Drill pits must be closed within 365 days of spud date.	
Submitted Electronically			
<b>KCC OFFICE USE ONLY</b>			
Date Received: 11/11/2008		Permit Number: 15-205-27684-00-00	
Permit Date: 11/12/2008		Lease Inspection: <input type="checkbox"/> Yes <input checked="" type="checkbox"/> No	
Steel Pit <input type="checkbox"/> RFAC <input type="checkbox"/> RFAS <input type="checkbox"/>			

Mail to: KCC - Conservation Division, 130 S. Market - Room 2078, Wichita, Kansas 67202

### Summary of Changes

Lease Name and Number: L. Collins A-4

API/Permit #: 15-205-27684-00-00

Doc ID: 1023919

Correction Number: 1

Approved By: Rick Hestermann 11/12/2008

Field Name	Previous Value	New Value
Contractor Name	Advise on ACO-1 -- Must be licensed by KCC	Advise on ACO-1 -- Must be licensed by KCC
Fresh Water Information Source: KDWR	No	Yes
Ground Surface Elevation	958	972
KCC Only - Approved By	Rick Hestermann 09/25/2008	Rick Hestermann 11/12/2008
KCC Only - Date Received	09/25/2008	11/11/2008
KCC Only - Permit Date	09/25/2008	11/12/2008
KCC Only - Regular Section Quarter Calls	NW SE SW SW	SW SW
LocationInfoLink	<a href="https://solar.kgs.ku.edu/kcc/detail/locationInformation.cfm?section=20&amp;t350">https://solar.kgs.ku.edu/ kcc/detail/locationInform ation.cfm?section=20&amp;t 350</a>	<a href="https://solar.kgs.ku.edu/kcc/detail/locationInformation.cfm?section=20&amp;t660">https://solar.kgs.ku.edu/ kcc/detail/locationInform ation.cfm?section=20&amp;t 660</a>
Nearest Lease Or Unit Boundary		
Number of Feet East or West From Section Line	960	660

Summary of changes for correction 1 continued

Field Name	Previous Value	New Value
Number of Feet East or West From Section Line	960	660
Number of Feet North or South From Section Line	350	660
Number of Feet North or South From Section Line	350	660
Quarter Call 3	SE	
Quarter Call 3	SE	
Quarter Call 4 - Smallest	NW	
Quarter Call 4 - Smallest	NW	
Save Link	../kcc/detail/operatorEditDetail.cfm?docID=1022594	../kcc/detail/operatorEditDetail.cfm?docID=1023919
Well Number	A-5	A-4
	Surveyed	Estimated
	958 Surveyed	972 Estimated

