

For KCC Use:  
 Effective Date: 8-12-2009  
 District #: 2  
 SGA?  Yes  No

KANSAS CORPORATION COMMISSION  
 OIL & GAS CONSERVATION DIVISION  
**NOTICE OF INTENT TO DRILL**  
*Must be approved by KCC five (5) days prior to commencing well*

Form C-1  
 October 2007  
**Form must be Typed**  
**Form must be Signed**  
**All blanks must be Filled**

Expected Spud Date: 8-10-2009  
month day year

OPERATOR: License# 33608  
 Name: W.D. Short Oil Co., LLC  
 Address 1: PO Box 729  
 Address 2: 102 S River Road  
 City: Oxford State: KS Zip: 67119  
 Contact Person: William D. (Don) Short, Jr.  
 Phone: 620-455-3576

CONTRACTOR: License# 32854  
 Name: Gulick Drilling Co., Inc.

Well Drilled For:  Oil  Gas  Seismic  Other  
 Enh Rec  Storage  Disposal  # of Holes \_\_\_\_\_  
 Well Class:  Infield  Pool Ext.  Wildcat  Other  
 Type Equipment:  Mud Rotary  Air Rotary  Cable

If OWWO: old well information as follows:  
 Operator: \_\_\_\_\_  
 Well Name: \_\_\_\_\_  
 Original Completion Date: \_\_\_\_\_ Original Total Depth: \_\_\_\_\_

Directional, Deviated or Horizontal wellbore?  Yes  No  
 If Yes, true vertical depth: \_\_\_\_\_  
 Bottom Hole Location: \_\_\_\_\_  
 KCC DKT #: \_\_\_\_\_

Spot Description: S2 NW - NW - SW SE Sec. 5 Twp. 34 S. R. 6  E  W  
2,100 feet from  N /  S Line of Section  
300 feet from  E /  W Line of Section  
 Is SECTION:  Regular  Irregular?

(Note: Locate well on the Section Plat on reverse side)  
 County: Cowley  
 Lease Name: Waldschmidt Well #: 6A  
 Field Name: Rahn

Is this a Prorated / Spaced Field?  Yes  No  
 Target Formation(s): Layton, Stalnaker, Bartlesville

Nearest Lease or unit boundary line (in footage): 2200' ESL - 170' FWL - 2617' NW  
 Ground Surface Elevation: 1123 feet MSL  
 Water well within one-quarter mile:  Yes  No  
 Public water supply well within one mile:  Yes  No

Depth to bottom of fresh water: N/A 100  
 Depth to bottom of usable water: N/A 280  
 Surface Pipe by Alternate:  I  II  
 Length of Surface Pipe Planned to be set: 300' 300' min  
 Length of Conductor Pipe (if any): N/A  
 Projected Total Depth: 2900'  
 Formation at Total Depth: Bartlesville

Water Source for Drilling Operations:  
 Well  Farm Pond  Other:  
 DWR Permit #: \_\_\_\_\_  
 (Note: Apply for Permit with DWR )  
 Will Cores be taken?  Yes  No  
 If Yes, proposed zone: \_\_\_\_\_

**AFFIDAVIT**

The undersigned hereby affirms that the drilling, completion and eventual plugging of this well will comply with K.S.A. 55 et. seq.  
 It is agreed that the following minimum requirements will be met:

1. Notify the appropriate district office **prior** to spudding of well;
2. A copy of the approved notice of intent to drill **shall be** posted on each drilling rig;
3. The minimum amount of surface pipe as specified below **shall be set** by circulating cement to the top; in all cases surface pipe **shall be set** through all unconsolidated materials plus a minimum of 20 feet into the underlying formation.
4. If the well is dry hole, an agreement between the operator and the district office on plug length and placement is necessary **prior to plugging**;
5. The appropriate district office will be notified before well is either plugged or production casing is cemented in;
6. If an ALTERNATE II COMPLETION, production pipe shall be cemented from below any usable water to surface within **120 DAYS** of spud date.  
 Or pursuant to Appendix "B" - Eastern Kansas surface casing order #133,891-C, which applies to the KCC District 3 area, alternate II cementing must be completed within 30 days of the spud date or the well shall be plugged. **In all cases, NOTIFY district office** prior to any cementing.

I hereby certify that the statements made herein are true and correct to the best of my knowledge and belief.

Date: 8-4-2009 Signature of Operator or Agent: Marjorie O'Short Title: member mgr.

KANSAS CORPORATION COMMISSION  
**AUG 05 2009**  
**RECEIVED**

**For KCC Use ONLY**  
 API # 15: 035-24335-00-00  
 Conductor pipe required: None feet  
 Minimum surface pipe required: 300 feet per ALT.  I  II  
 Approved by: RW 8-7-2009  
 This authorization expires: 8-7-2010  
 (This authorization void if drilling not started within 12 months of approval date.)  
 Spud date: \_\_\_\_\_ Agent: \_\_\_\_\_

**Remember to:**

- File Drill Pit Application (form CDP-1) with Intent to Drill;
- File Completion Form ACO-1 within 120 days of spud date;
- File acreage attribution plat according to field proration orders;
- Notify appropriate district office 48 hours prior to workover or re-entry;
- Submit plugging report (CP-4) after plugging is completed (within 60 days);
- Obtain written approval before disposing or injecting salt water.
- If this permit has expired (See: authorized expiration date) please check the box below and return to the address below.

Well Not Drilled - Permit Expired Date: \_\_\_\_\_  
 Signature of Operator or Agent: \_\_\_\_\_

**IN ALL CASES PLOT THE INTENDED WELL ON THE PLAT BELOW**

*Plat of acreage attributable to a well in a prorated or spaced field*

**If the intended well is in a prorated or spaced field, please fully complete this side of the form.** If the intended well is in a prorated or spaced field complete the plat below showing that the well will be properly located in relationship to other wells producing from the common source of supply. Please show all the wells and within 1 mile of the boundaries of the proposed acreage attribution unit for gas wells and within 1/2 mile of the boundaries of the proposed acreage attribution unit for oil wells.

API No. 15 - 035-24335-00-00  
Operator: W.D. Short Oil Co., LLC  
Lease: Waldschmidt  
Well Number: 6A  
Field: Rahn  
Number of Acres attributable to well: 120  
QTR/QTR/QTR/QTR of acreage: \_\_\_\_\_ - \_\_\_\_\_ - \_\_\_\_\_ - SE

Location of Well: County: Cowley  
\_\_\_\_\_ feet from  N /  S Line of Section  
\_\_\_\_\_ feet from  E /  W Line of Section  
Sec. 5 Twp. 34 S. R. 6  E  W

Is Section:  Regular or  Irregular

**If Section is Irregular, locate well from nearest corner boundary.**

Section corner used:  NE  NW  SE  SW

**PLAT**

*(Show location of the well and shade attributable acreage for prorated or spaced wells.)*

*(Show footage to the nearest lease or unit boundary line.)*

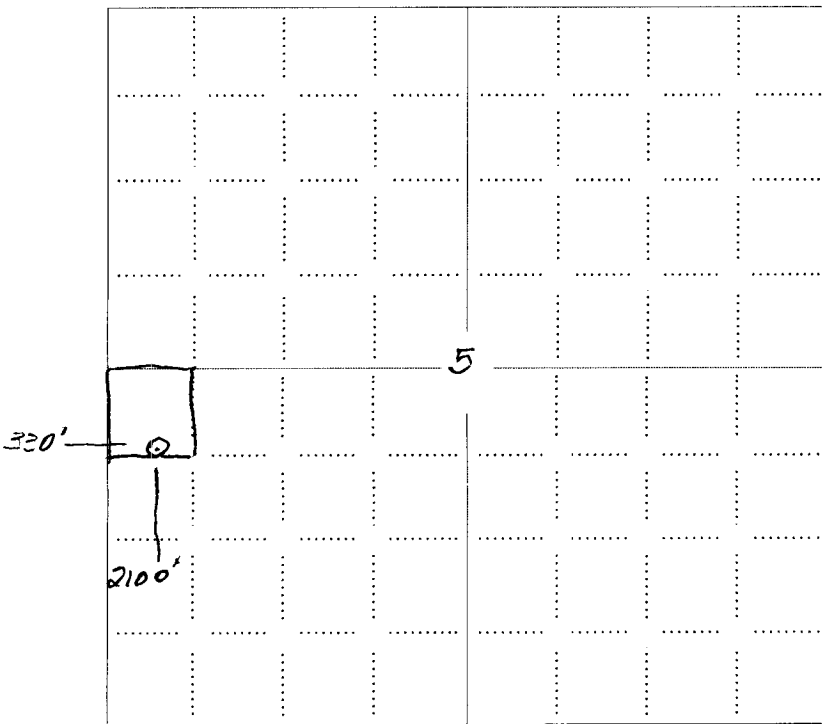

KANSAS CORPORATION COMMISSION

AUG 05 2009

RECEIVED

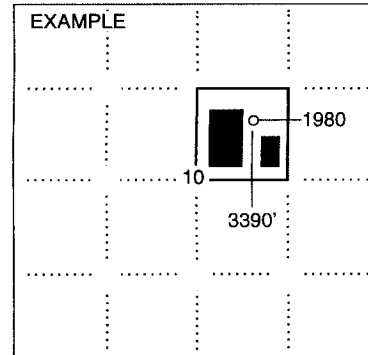

SEWARD CO.

**NOTE: In all cases locate the spot of the proposed drilling locaton.**

**In plotting the proposed location of the well, you must show:**

1. The manner in which you are using the depicted plat by identifying section lines, i.e. 1 section, 1 section with 8 surrounding sections, 4 sections, etc.
2. The distance of the proposed drilling location from the south / north and east / west outside section lines.
3. The distance to the nearest lease or unit boundary line (in footage).
4. If proposed location is located within a prorated or spaced field a certificate of acreage attribution plat must be attached: (CO-7 for oil wells; CG-8 for gas wells).



# ROBERT E. MOSER, R.L.S.

Oil Field Surveying

335 N. Mission Road • Wichita, Kansas 67206

(316) 683-2853

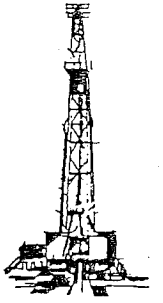

KM0730092

INVOICE NO.

W.D. SHORT OIL CO., LLC

OPERATOR

per plat

NO.

M.K. Walderschmidt

FARM

Cowley (KS)

COUNTY

5 34s 06e

S T R

per plat below

LOCATION

ELEVATION: per plat below

W.D. SHORT OIL CO., LLC

Box 1

Oxford, KS 67119-0001

AUTHORIZED BY: Mike Amestine (?) 7/28/09

SCALE: 1" = 1000'

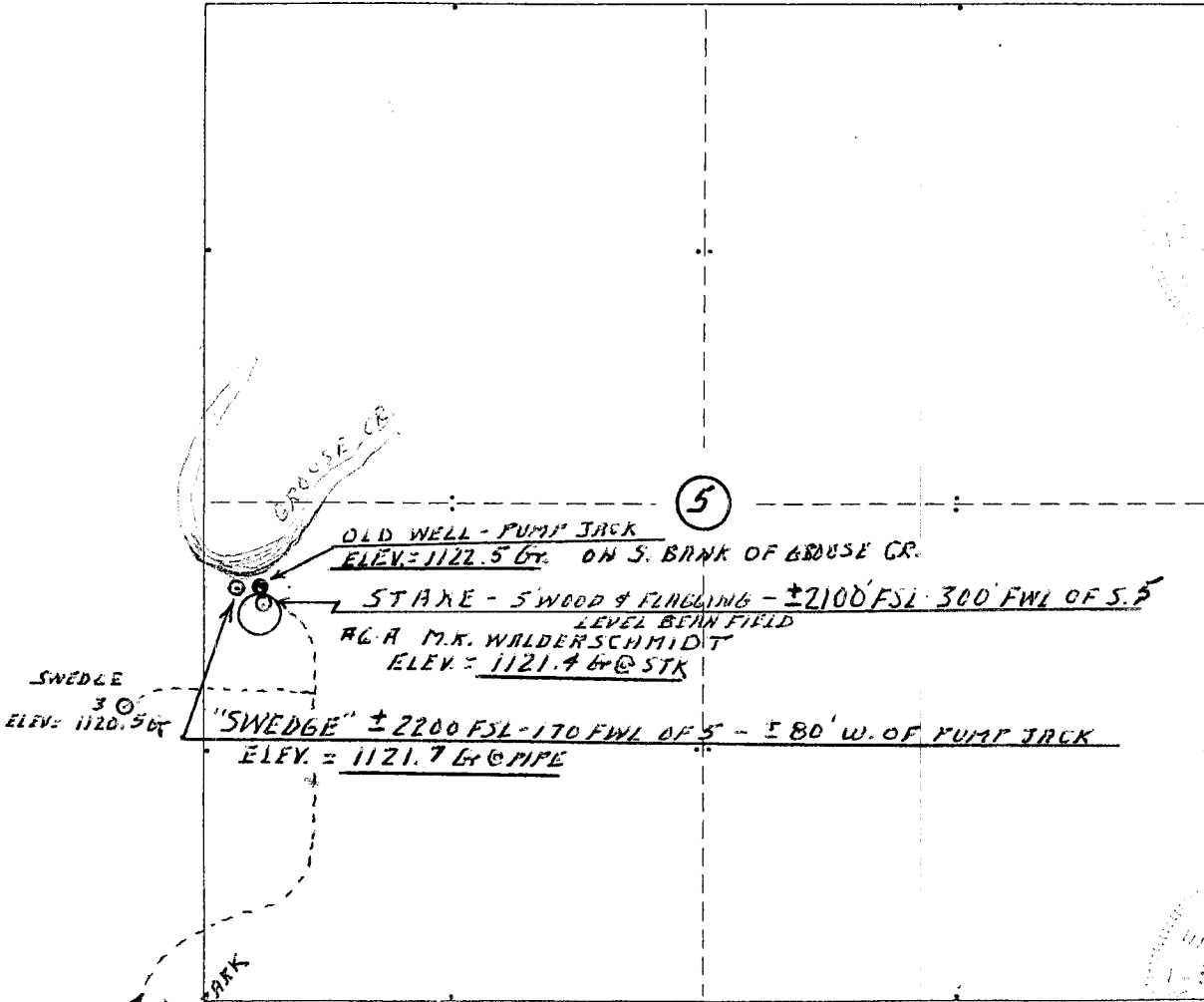

KANSAS CORPORATION COMMISSION  
RECEIVED  
AUG 05 2009

Note: M.A. present and assisted. Thanks.

Date: 30 July 2009

*R. E. Moser*

Surveyor: R.E. Moser, R.L.S. #329

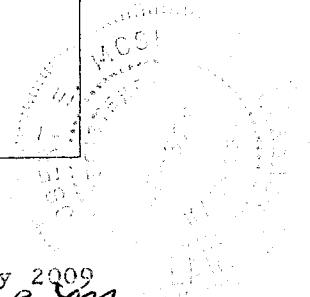

**KANSAS CORPORATION COMMISSION  
OIL & GAS CONSERVATION DIVISION  
APPLICATION FOR SURFACE PIT**

Form CDP-1  
April 2004  
Form must be Typed

*Submit in Duplicate*

Operator Name: <b>W.D. Short Oil Co., LLC</b>		License Number: <b>33608</b>
Operator Address: <b>PO Box 729</b>		<b>102 S River Road Oxford KS 67119</b>
Contact Person: <b>William D. (Don) Short, Jr.</b>		Phone Number: <b>620-455-3576</b>
Lease Name & Well No.: <b>Waldschmidt 6A</b>		Pit Location (QQQQ): <b>SW</b>
Type of Pit: <input type="checkbox"/> Emergency Pit <input type="checkbox"/> Burn Pit <input type="checkbox"/> Settling Pit <input checked="" type="checkbox"/> Drilling Pit <input type="checkbox"/> Workover Pit <input type="checkbox"/> Haul-Off Pit <small>(If WP Supply API No. or Year Drilled)</small>	Pit is: <input checked="" type="checkbox"/> Proposed <input type="checkbox"/> Existing If Existing, date constructed: _____ Pit capacity: <b>500</b> (bbls)	Sec. <b>5</b> Twp. <b>34</b> R. <b>6</b> <input checked="" type="checkbox"/> East <input type="checkbox"/> West <b>2100</b> Feet from <input type="checkbox"/> North / <input checked="" type="checkbox"/> South Line of Section <b>330</b> Feet from <input checked="" type="checkbox"/> East / <input checked="" type="checkbox"/> West Line of Section <b>Cowley</b> County
Is the pit located in a Sensitive Ground Water Area? <input checked="" type="checkbox"/> Yes <input checked="" type="checkbox"/> No		Chloride concentration: _____ mg/l <small>(For Emergency Pits and Settling Pits only)</small>
Is the bottom below ground level? <input checked="" type="checkbox"/> Yes <input type="checkbox"/> No	Artificial Liner? <input type="checkbox"/> Yes <input checked="" type="checkbox"/> No	How is the pit lined if a plastic liner is not used? <b>Coated with Bentonite</b>
Pit dimensions (all but working pits): <b>100</b> Length (feet) <b>100</b> Width (feet) <input type="checkbox"/> N/A: Steel Pits Depth from ground level to deepest point: <b>4</b> (feet) <input type="checkbox"/> No Pit		
If the pit is lined give a brief description of the liner material, thickness and installation procedure.		Describe procedures for periodic maintenance and determining liner integrity, including any special monitoring.
		KANSAS CORPORATION COMMISSION <b>AUG 05 2009</b> <b>RECEIVED</b>
Distance to nearest water well within one-mile of pit <b>Unknown</b> feet    Depth of water well <b>NA</b> feet	Depth to shallowest fresh water <b>NA</b> feet. Source of information: <input type="checkbox"/> measured <input type="checkbox"/> well owner <input type="checkbox"/> electric log <input type="checkbox"/> KDWR	<b>15-035-24335-0000</b>
<b>Emergency, Settling and Burn Pits ONLY:</b> Producing Formation: _____ Number of producing wells on lease: _____ Barrels of fluid produced daily: _____ Does the slope from the tank battery allow all spilled fluids to flow into the pit? <input type="checkbox"/> Yes <input type="checkbox"/> No	<b>Drilling, Workover and Haul-Off Pits ONLY:</b> Type of material utilized in drilling/workover: <b>Chemical Mud</b> Number of working pits to be utilized: <b>4</b> Abandonment procedure: <b>Empty, Let Dry &amp; Backfill</b> Drill pits must be closed within 365 days of spud date.	
I hereby certify that the above statements are true and correct to the best of my knowledge and belief.		
<b>8/4/09</b> Date	<i>Marjorie Oshorn, Member Mgr.</i> Signature of Applicant or Agent	
<b>KCC OFFICE USE ONLY</b>		
Date Received: <b>8/5/09</b> Permit Number: _____ Permit Date: <b>8/4/09</b>	Steel Pit <input type="checkbox"/> RFAC <input checked="" type="checkbox"/> RFAS <input type="checkbox"/>	Case Inspection: <input checked="" type="checkbox"/> Yes <input type="checkbox"/> No

Mail to: KCC - Conservation Division, 130 S. Market - Room 2078, Wichita, Kansas 67202



Mark Parkinson, Governor  
Thomas E. Wright, Chairman  
Michael C. Moffet, Commissioner  
Joseph F. Harkins, Commissioner

August 6, 2009

W.D. Short Oil Co., LLC  
PO Box 729  
102 S. River Rd  
Oxford, KS 67119

Re: Drilling Pit Application  
Waldschmidt Lease Well No. 6A  
SW/4 Sec. 05-34S-06E  
Cowley County, Kansas

Dear Sir or Madam:

District staff has inspected the above referenced location and has determined that the reserve pit shall be constructed **without slots**, the bottom shall be flat and reasonably level, and the free fluids must be removed. The fluids are to be removed from the reserve pit within 72 hours of drilling completion.

**If production casing is set all completion fluids shall be removed from the working pits daily. NO completion fluids or non-exempt wastes shall be placed in the reserve pit.**

The fluids should be taken to an authorized disposal well. Please call the District Office at (316) 630-4000 when the fluids have been removed. Please file form CDP-5 (August 2004), Exploration and Production Waste Transfer, within 30 days of fluid removal. Conservation division forms are available through our office and on the KCC web site: [www.kcc.state.ks.us/conservation/forms](http://www.kcc.state.ks.us/conservation/forms).

**A copy of this letter should be posted in the doghouse along with the approved Intent to Drill.**

If you have any questions or concerns please feel free to contact the undersigned at the above address.

Sincerely,

A handwritten signature in black ink that reads "Kathy Haynes".

Kathy Haynes  
Environmental Protection and Remediation Department

cc: File

CONSERVATION DIVISION

Finney State Office Building, 130 S. Market, Room 2078, Wichita, KS 67202-3802  
(316) 337-6200 • Fax: (316) 337-6211 • <http://kcc.ks.gov/>

15-035-24335-0000

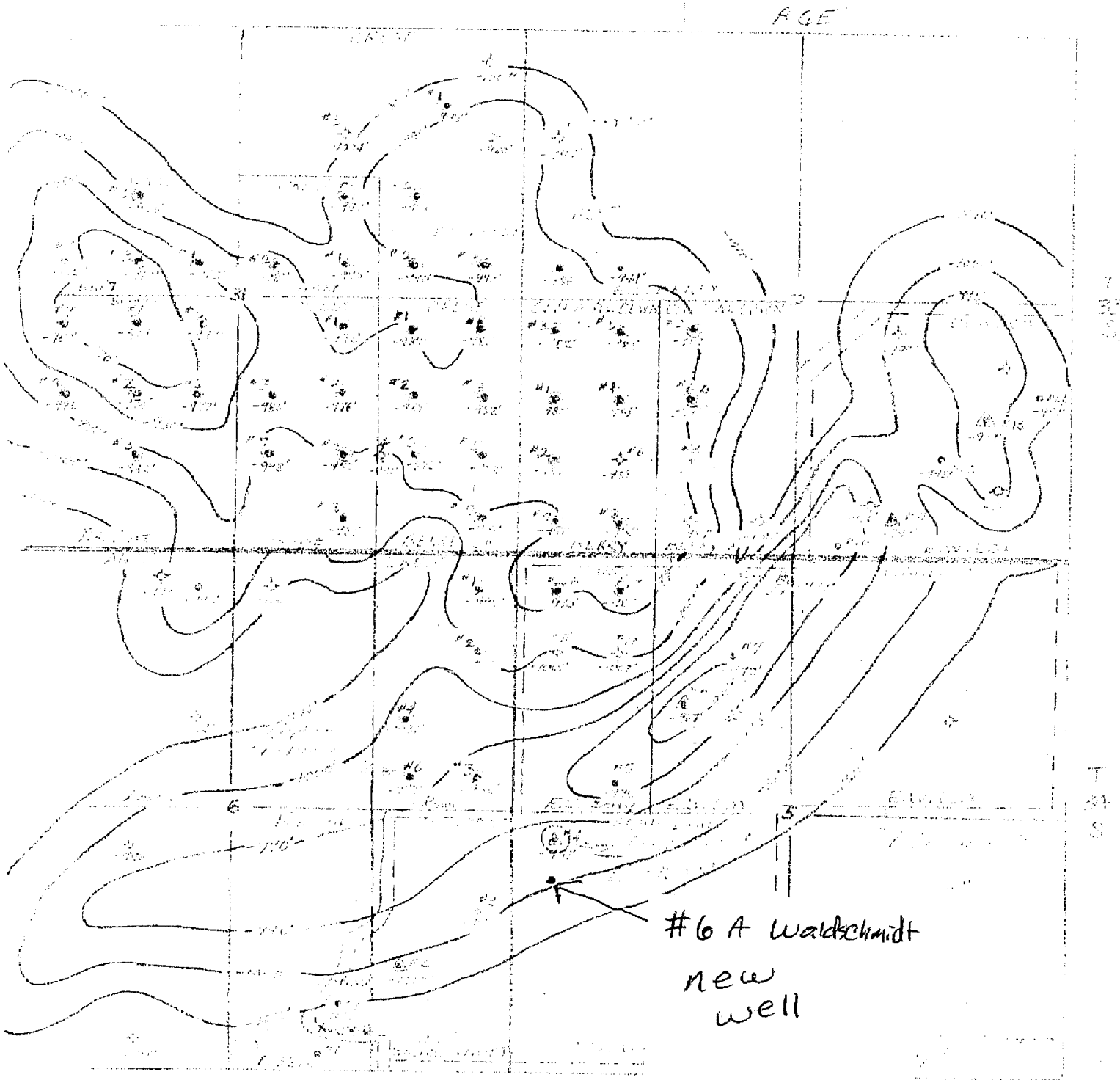

KANSAS CORPORATION COMMISSION

AUG 07 2009  
RECEIVED

15-03524335-0000

R 6 E

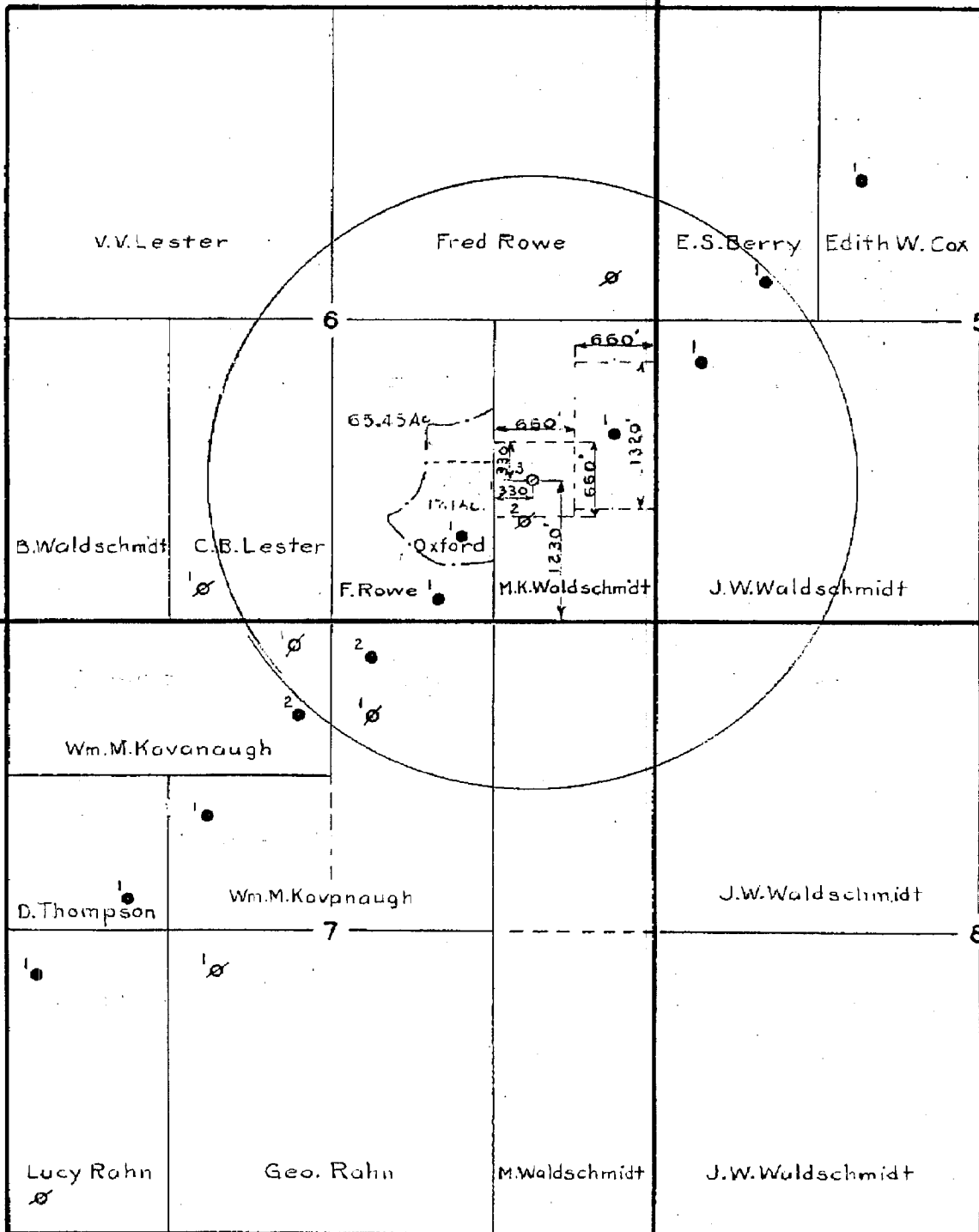

T  
34  
S

CONTINENTAL OIL COMPANY'S — M.K.WALDSCHMIDT LSE  
AND OFFSETS

RAHN POOL

COWLEY COUNTY, KANSAS

KANSAS CORPORATION COMMISSION

AUG 07 2009

RECEIVED





15035-24335000



# W. D. Short Oil Company LLC

Office: 102 S. River Road  
Oxford, Kansas  
Phone: (620) 455-3576

Mailing Address: P.O. Box 729  
Oxford, KS 67119-0729  
Fax: (620) 455-2980

**OIL PRODUCTION**

Marjorie O. Short  
Don Short

To: Rick Hesterman  
316-337-6211

From: Mike Anstine/Marjorie Short

Date: August 7, 2009

Page 1 of 4 pages (including this page)

# FAX

# message:

Waldschmidt Maps

KANSAS CORPORATION COMMISSION  
AUG 07 2009  
RECEIVED