

For KCC Use:
 Effective Date: 9-26-2009
 District # 2
 SGA? Yes No

KANSAS CORPORATION COMMISSION
 OIL & GAS CONSERVATION DIVISION

Form C-1
 October 2007
 Form must be Typed
 Form must be Signed
 All blanks must be Filled

NOTICE OF INTENT TO DRILL

Must be approved by KCC five (5) days prior to commencing well

Expected Spud Date: September 28 2009
month day year

OPERATOR: License# 33971
 Name: TriPower Resources, LLC
 Address 1: P.O. Box 849
 Address 2:
 City: Ardmore State: Ok zip: 73402
 Contact Person: W.B. Curry
 Phone: 580-226-6700 ext 215

CONTRACTOR: License# 33217
 Name: Three Rivers Exploration, LLC

Well Drilled For:	Well Class:	Type Equipment:
<input checked="" type="checkbox"/> Oil	<input type="checkbox"/> Enh Rec	<input checked="" type="checkbox"/> Infield
<input checked="" type="checkbox"/> Gas	<input type="checkbox"/> Storage	<input type="checkbox"/> Pool Ext.
<input type="checkbox"/> Seismic	<input type="checkbox"/> Disposal	<input type="checkbox"/> Wildcat
<input type="checkbox"/> Other: _____	<input type="checkbox"/> # of Holes _____	<input type="checkbox"/> Other _____
<input type="checkbox"/> If OWWO: old well information as follows:		

Operator: _____
 Well Name: _____
 Original Completion Date: _____ Original Total Depth: _____

Directional, Deviated or Horizontal wellbore? Yes No
 If Yes, true vertical depth: _____
 Bottom Hole Location: _____
 KCC DKT #: _____

Spot Description: ~~SE NW NW SE~~
S2 NW NW SE Sec. 26 Twp. 24S S. R. 4
(a.a.a.)
2150 feet from N / S Line of Section
2310 feet from E / W Line of Section

Is SECTION: Regular Irregular?
 (Note: Locate well on the Section Plat on reverse side)

County: Butler
 Lease Name: Mingenback Well #: 5
 Field Name: Plum Grove South
 Is this a Prorated / Spaced Field? Yes No
 Target Formation(s): Mississippian

Nearest Lease or unit boundary line (in footage): 330'
 Ground Surface Elevation: Est 1435 feet MSL
 Water well within one-quarter mile: Yes No
 Public water supply well within one mile: Yes No
 Depth to bottom of fresh water: 150'
 Depth to bottom of usable water: 180'
 Surface Pipe by Alternate: I II
 Length of Surface Pipe Planned to be set: 200'
 Length of Conductor Pipe (if any): None
 Projected Total Depth: 2700'
 Formation at Total Depth: Mississippian

Water Source for Drilling Operations:
 Well Farm Pond Other: To Haul Purchased Water
 DWR Permit #: _____
 (Note: Apply for Permit with DWR)

Will Cores be taken? Yes No
 If Yes, proposed zone: _____

AFFIDAVIT

The undersigned hereby affirms that the drilling, completion and eventual plugging of this well will comply with K.S.A. 55 et. seq.
 It is agreed that the following minimum requirements will be met:

RECEIVED
 SEP 21 2009
 KCC WICHITA

1. Notify the appropriate district office **prior** to spudding of well;
2. A copy of the approved notice of intent to drill **shall be** posted on each drilling rig;
3. The minimum amount of surface pipe as specified below **shall be set** by circulating cement to the top; in all cases surface pipe **shall be set** through all unconsolidated materials plus a minimum of 20 feet into the underlying formation;
4. If the well is dry hole, an agreement between the operator and the district office on plug length and placement is necessary **prior to plugging**;
5. The appropriate district office will be notified before well is either plugged or production casing is cemented in;
6. If an ALTERNATE II COMPLETION, production pipe shall be cemented from below any usable water to surface within **120 DAYS** of spud date. Or pursuant to Appendix "B" - Eastern Kansas surface casing order #133,891-C, which applies to the KCC District 3 area, alternate II cementing must be completed within 30 days of the spud date or the well shall be plugged. **In all cases, NOTIFY district office** prior to any cementing.

I hereby certify that the statements made herein are true and correct to the best of my knowledge and belief.

Date: 9-17-09 Signature of Operator or Agent: W.B. Curry Title: Agent

For KCC Use ONLY
 API # 15 - 015-23839-00-00
 Conductor pipe required None feet
 Minimum surface pipe required 200 feet per ALT. I II
 Approved by: YMA 9-21-2009
 This authorization expires: 9-21-2010
(This authorization void if drilling not started within 12 months of approval date.)
 Spud date: _____ Agent: _____

Remember to:

- File Drill Pit Application (form CDP-1) with Intent to Drill;
- File Completion Form ACO-1 within 120 days of spud date;
- File acreage attribution plat according to field proration orders;
- Notify appropriate district office 48 hours prior to workover or re-entry;
- Submit plugging report (CP-4) after plugging is completed (within 60 days);
- Obtain written approval before disposing or injecting salt water.
- If this permit has expired (See: authorized expiration date) please check the box below and return to the address below.

Well Not Drilled - Permit Expired Date: _____
 Signature of Operator or Agent: _____

26-24-4
 E
 W

IN ALL CASES PLOT THE INTENDED WELL ON THE PLAT BELOW

Plat of acreage attributable to a well in a prorated or spaced field

If the intended well is in a prorated or spaced field, please fully complete this side of the form. If the intended well is in a prorated or spaced field complete the plat below showing that the well will be properly located in relationship to other wells producing from the common source of supply. Please show all the wells and within 1 mile of the boundaries of the proposed acreage attribution unit for gas wells and within 1/2 mile of the boundaries of the proposed acreage attribution unit for oil wells.

API No. 15 - 015-23839-00-00
~~Pending Assignment~~

Operator: TriPower Resources, LLC

Lease: Mingenback

Well Number: 5

Field: Plum Grove South

Number of Acres attributable to well: 160

QTR/QTR/QTR/QTR of acreage: SE NW NW SE .Sec. 26

Location of Well: County: Butler

2150 feet from N / S Line of Section

2310 feet from E / W Line of Section

Sec. 26 Twp. 24 S. R. 4 E W

Is Section: Regular or Irregular

If Section is Irregular, locate well from nearest corner boundary.

Section corner used: NE NW SE SW

PLAT

(Show location of the well and shade acreage for prorated or spaced wells.)

(Show footage to the nearest lease or unit boundary line.)

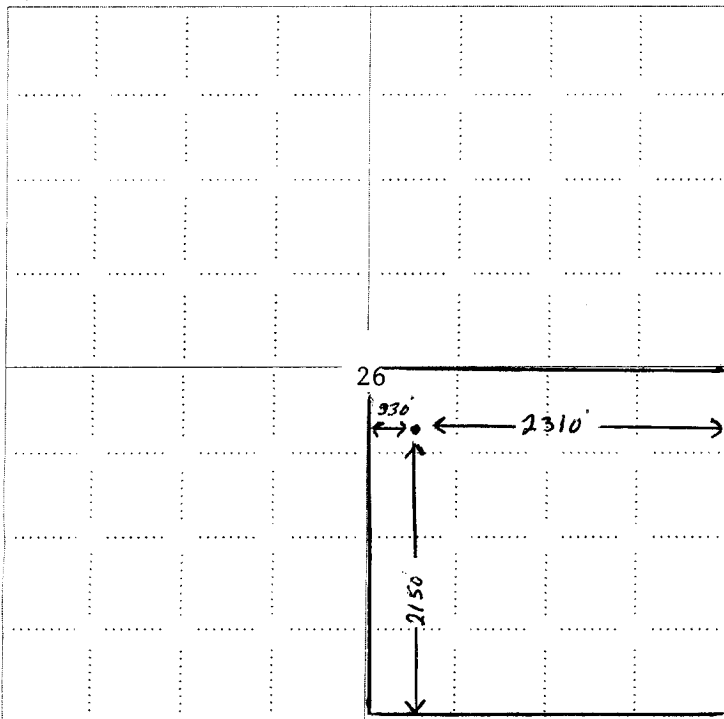

RECEIVED
 SEP 21 2009
 KCC WICHITA

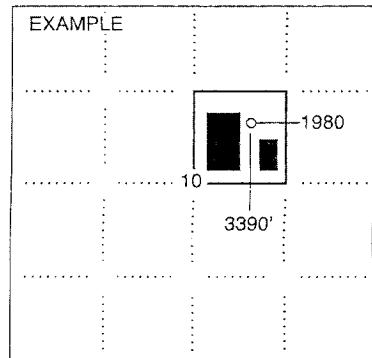

SEWARD CO.

NOTE: In all cases locate the spot of the proposed drilling location.

In plotting the proposed location of the well, you must show:

1. The manner in which you are using the depicted plat by identifying section lines, i.e. 1 section, 1 section with 8 surrounding sections, 4 sections, etc.
2. The distance of the proposed drilling location from the south / north and east / west outside section lines.
3. The distance to the nearest lease or unit boundary line (in footage).
4. If proposed location is located within a prorated or spaced field a certificate of acreage attribution plat must be attached: (CO-7 for oil wells; CG-8 for gas wells).

**KANSAS CORPORATION COMMISSION
OIL & GAS CONSERVATION DIVISION
APPLICATION FOR SURFACE PIT**

Form CDP-1
April 2004
Form must be Typed

Submit in Duplicate

Operator Name: TriPower Resources, LLC		License Number: 33971
Operator Address: P.O. Box 849, Ardmore, Ok. 73402		
Contact Person: W.B. Curry		Phone Number: (580) 226-6700, ext 215
Lease Name & Well No.: Mingenback # 5		Pit Location (QQQQ): SE NW NW SE Sec. 26 Twp. 24S R. 4 <input checked="" type="checkbox"/> East <input type="checkbox"/> West 2150 Feet from <input type="checkbox"/> North / <input checked="" type="checkbox"/> South Line of Section 2310 Feet from <input checked="" type="checkbox"/> East / <input type="checkbox"/> West Line of Section Butler County
Type of Pit: <input type="checkbox"/> Emergency Pit <input type="checkbox"/> Burn Pit <input type="checkbox"/> Settling Pit <input checked="" type="checkbox"/> Drilling Pit <input type="checkbox"/> Workover Pit <input type="checkbox"/> Haul-Off Pit <small>(If WP Supply API No. or Year Drilled)</small>		Pit is: <input checked="" type="checkbox"/> Proposed <input type="checkbox"/> Existing If Existing, date constructed: _____ Pit capacity: _____ (bbbls)
Is the pit located in a Sensitive Ground Water Area? <input type="checkbox"/> Yes <input checked="" type="checkbox"/> No		Chloride concentration: NA mg/l <small>(For Emergency Pits and Settling Pits only)</small>
Is the bottom below ground level? <input checked="" type="checkbox"/> Yes <input type="checkbox"/> No	Artificial Liner? <input type="checkbox"/> Yes <input checked="" type="checkbox"/> No	How is the pit lined if a plastic liner is not used? Native Clay & Drilling Mud
Pit dimensions (all but working pits): 60 Length (feet) 6 Width (feet) (400 bbl) N/A: Steel Pits Depth from ground level to deepest point: 5 (feet)		
If the pit is lined give a brief description of the liner material, thickness and installation procedure. Not Required in Area		Describe procedures for periodic maintenance and determining liner integrity, including any special monitoring. -----
Distance to nearest water well within one-mile of pit 629 ^{339} feet Depth of water well 56 ^{92} feet		Depth to shallowest fresh water 150 ^{45} feet. KCC WICHITA Source of information: _____ measured _____ well owner _____ electric log <input checked="" type="checkbox"/> ^{2} KDWR
Emergency, Settling and Burn Pits ONLY: Producing Formation: _____ Number of producing wells on lease: _____ Barrels of fluid produced daily: _____ Does the slope from the tank battery allow all spilled fluids to flow into the pit? <input type="checkbox"/> Yes <input type="checkbox"/> No		Drilling, Workover and Haul-Off Pits ONLY: Type of material utilized in drilling/workover: Water Base Mud Number of working pits to be utilized: 1 Abandonment procedure: Empty, backfill, level & restore surface. Drill pits must be closed within 365 days of spud date.
I hereby certify that the above statements are true and correct to the best of my knowledge and belief.		
9-17-09 Date	<i>W.B. Curry</i> Signature of Applicant or Agent W.B. Curry	

15-015-23839-00-00

**RECEIVED
SEP 21 2009
KCC WICHITA**

KCC OFFICE USE ONLY			
Date Received: 9/21/09	Permit Number: _____	Permit Date: 9/21/09	Lease Inspection: <input type="checkbox"/> Yes <input checked="" type="checkbox"/> No