

**WELL COMPLETION FORM**  
**WELL HISTORY - DESCRIPTION OF WELL & LEASE**

Operator: License # 33019  
Name: Rosewood Resources, Inc.  
Address: 2711 N. Haskell Ave., Suite 2800, LB 22  
City/State/Zip: Dallas, TX 75201  
Purchaser: \_\_\_\_\_  
Operator Contact Person: Tom Roelfs  
Phone: ( 970 ) 324-1686  
Contractor: Name: Mann Drilling Company  
License: n/a  
Wellsite Geologist: Steven VonFeldt  
Designate Type of Completion:  
 New Well     Re-Entry     Workover  
 Oil     SWD     SIOW     Temp. Abd.  
 Gas     ENHR     SIGW  
 Dry     Other (Core, WSW, Expl., Cathodic, etc)  
If Workover/Re-entry: Old Well Info as follows:  
Operator: \_\_\_\_\_  
Well Name: \_\_\_\_\_  
Original Comp. Date: \_\_\_\_\_ Original Total Depth: \_\_\_\_\_  
 Deepening     Re-perf.     Conv. to Enhr./SWD  
 Plug Back \_\_\_\_\_ Plug Back Total Depth \_\_\_\_\_  
 Commingled    Docket No. \_\_\_\_\_  
 Dual Completion    Docket No. \_\_\_\_\_  
 Other (SWD or Enhr.?)    Docket No. \_\_\_\_\_  
8/31/2006    8/31/2006    9/9/2006  
Spud Date or    Date Reached TD    Completion Date or  
Recompletion Date       Recompletion Date

API No. 15 - 181-20423-04-00  
County: Sherman  
SW SW SE Sec. 21 Twp. 7 S. R. 39  East  West  
125 feet from S N (circle one) Line of Section  
2325 feet from E W (circle one) Line of Section  
Footages Calculated from Nearest Outside Section Corner:  
(circle one) NE SE NW SW  
Lease Name: G. Ihrig Well #: 34-21H  
Field Name: Goodland  
Producing Formation: Niobrara  
Elevation: Ground: 3618' Kelly Bushing: 3625'  
Total Depth: 1102' Plug Back Total Depth: 3425.25'  
Amount of Surface Pipe Set and Cemented at 395' KB \_\_\_\_\_ Feet  
Multiple Stage Cementing Collar Used?  Yes  No  
If yes, show depth set 1155.97 Feet  
If Alternate II completion, cement circulated from \_\_\_\_\_  
feet depth to \_\_\_\_\_ w/ \_\_\_\_\_ sx cmt.

**Drilling Fluid Management Plan**  
(Data must be collected from the Reserve Pit)  
Chloride content 5000 ppm Fluid volume 200 bbls  
Dewatering method used Evaporation  
Location of fluid disposal if hauled offsite: \_\_\_\_\_  
Operator Name: \_\_\_\_\_  
Lease Name: \_\_\_\_\_ License No.: \_\_\_\_\_  
Quarter \_\_\_\_\_ Sec. \_\_\_\_\_ Twp. \_\_\_\_\_ S. R. \_\_\_\_\_  East  West  
County: \_\_\_\_\_ Docket No.: \_\_\_\_\_

*Alt-1 Dlg - 12/2/08*

**INSTRUCTIONS:** An original and two copies of this form shall be filed with the Kansas Corporation Commission, 130 S. Market - Room 2078, Wichita, Kansas 67202, within 120 days of the spud date, recompletion, workover or conversion of a well. Rule 82-3-130, 82-3-106 and 82-3-107 apply. Information of side two of this form will be held confidential for a period of 12 months if requested in writing and submitted with the form (see rule 82-3-107 for confidentiality in excess of 12 months). One copy of all wireline logs and geologist well report shall be attached with this form. ALL CEMENTING TICKETS MUST BE ATTACHED. Submit CP-4 form with all plugged wells. Submit CP-111 form with all temporarily abandoned wells.

All requirements of the statutes, rules and regulations promulgated to regulate the oil and gas industry have been fully complied with and the statements herein are complete and correct to the best of my knowledge.

Signature: Jannell Geved  
Title: Production Asst. Date: 11-30-06  
Subscribed and sworn to before me this 30 day of November  
06  
Notary Public: Kathy Roelfs  
Date Commission Expires: 6-30-09

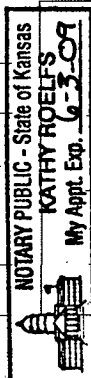

**KCC Office Use ONLY**

- Letter of Confidentiality Received
- If Denied, Yes  Date: \_\_\_\_\_
- Wireline Log Received
- Geologist Report Received
- UIC Distribution

**RECEIVED**  
DEC 04 2006  
KCC WICHITA

Operator Name: Rosewood Resources, Inc. Lease Name: G. Ihrig Well #: 34-21H  
 Sec. 21 Twp. 7 S. R. 39  East  West County: Sherman

INSTRUCTIONS: Show important tops and base of formations penetrated. Detail all cores. Report all final copies of drill stems tests giving interval tested, time tool open and closed, flowing and shut-in pressures, whether shut-in pressure reached static level, hydrostatic pressures, bottom hole temperature, fluid recovery, and flow rates if gas to surface test, along with final chart(s). Attach extra sheet if more space is needed. Attach copy of all Electric Wireline Logs surveyed. Attach final geological well site report.

Drill Stem Tests Taken <input type="checkbox"/> Yes <input checked="" type="checkbox"/> No (Attach Additional Sheets)  Samples Sent to Geological Survey <input type="checkbox"/> Yes <input checked="" type="checkbox"/> No  Cores Taken <input type="checkbox"/> Yes <input checked="" type="checkbox"/> No Electric Log Run <input checked="" type="checkbox"/> Yes <input type="checkbox"/> No (Submit Copy)  List All E. Logs Run:  <b>GR</b>	<input type="checkbox"/> Log Formation (Top), Depth and Datum <input type="checkbox"/> Sample Name Top Datum  Niobrara 1025' KB 12
---	---

CASING RECORD <input checked="" type="checkbox"/> New <input type="checkbox"/> Used							
Report all strings set-conductor, surface, intermediate, production, etc.							
Purpose of String	Size Hole Drilled	Size Casing Set (In O.D.)	Weight Lbs. / Ft.	Setting Depth	Type of Cement	# Sacks Used	Type and Percent Additives
Surface	9 1/2"	7"	17#	395'	Neat	95	
Intermediate	N/A	N/A	N/A	N/A	N/A	N/A	N/A
Production	6 1/4"	4 1/2"	10.5#	3425.25	Type 1	50	

ADDITIONAL CEMENTING / SQUEEZE RECORD				
Purpose:	Depth Top Bottom	Type of Cement	#Sacks Used	Type and Percent Additives
<input type="checkbox"/> Perforate <input type="checkbox"/> Protect Casing <input type="checkbox"/> Plug Back TD <input type="checkbox"/> Plug Off Zone				

Shots Per Foot	PERFORATION RECORD - Bridge Plugs Set/Type Specify Footage of Each Interval Perforated	Acid, Fracture, Shot, Cement Squeeze Record (Amount and Kind of Material Used)	Depth
4	3342' to 3357'	N/A	

TUBING RECORD	Size	Set At	Packer At	Liner Run <input type="checkbox"/> Yes <input checked="" type="checkbox"/> No
none				

Date of First, Resumerd Production, SWD or Enhr. 11/16/2006	Producing Method <input checked="" type="checkbox"/> Flowing <input type="checkbox"/> Pumping <input type="checkbox"/> Gas Lift <input type="checkbox"/> Other (Explain)
--	---

Estimated Production Per 24 Hours	Oil Bbls.	Gas Mcf	Water Bbls.	Gas-Oil Ratio	Gravity
		56			

Disposition of Gas      METHOD OF COMPLETION      Production Interval

Vented  Sold  Used on Lease  Open Hole  Perf.  Dually Comp.  Commingled  
 (If vented, Submit ACO-18.)  Other (Specify) \_\_\_\_\_

RECEIVED  
 DEC 04 2006  
 KCC WICHITA

SCHAAL DRILLING, CO.  
PO BOX 416  
BURLINGTON, CO. 80807  
719-346-8032

FIELD REPORT  
SURFACE CASING, DRILLING AND CEMENTING

DRILLING DATE 8-31-06

WELL NAME & LEASE # Ithrig G 34-21 H

MOVE IN, RIG UP, DIG PITS ETC. DATE 8-30-06 TIME 2:00  AM  PM

SPUD TIME 7:15  AM  PM SHALE DEPTH 290 TIME 9:15  AM  PM

HOLE DIA: 9 1/2 FROM 0 TO 383 TD TIME 10:00  AM  PM

CIRCULATE, T.O.O.H. SET 381.79 FT CASING 394.79 KB FT DEPTH

9 JOINTS 7 OD #/FT  14  15.5  17  20  23

PUMP 95 SAC CEMENT 627 GAL DISP. CIRC. 1 1/2 BBL TO PIT

PLUG DOWN TIME 12:00  AM  PM DATE 8-31-06

CEMENT LEFT IN CSG. 20 FT TYPE: PORTLAND CEMENT I/II ASTM C 150

CENTRALIZER 1 CEMENT COST \$-1495.76

ELEVATION 3618  
+12KB 3630

PIPE TALLY

1. 42.39
2. 42.36
3. 42.35
4. 42.37
5. 42.34
6. 42.46
7. 42.66
8. 42.40
9. 42.46
- 10.
- 11.
- 12.
- 13.
- 14.

TOTAL 381.79

RECEIVED

DEC 04 2006

KCC WICHITA

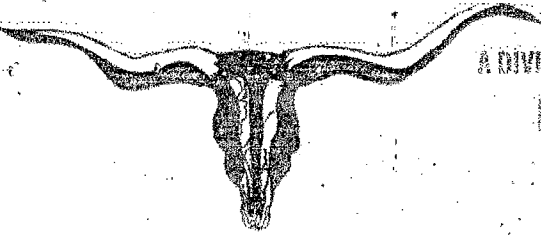

A DIVISION OF ADVANCED DRILLING TECHNOLOGIES, LLC.

**LONGHORN CEMENTING CO.**

P.O. BOX 209 YUMA, COLORADO 80759  
 Phone: 970-843-0799 Fax: 970-843-0799

**FIELD SERVICE TICKET  
 AND INVOICE**

0848

DATE 9-9-06 TICKET NO.

DATE OF JOB <u>9-9-06</u>	DISTRICT	NEW WELL <input checked="" type="checkbox"/>	OLD WELL <input type="checkbox"/>	PROD <input type="checkbox"/>	INJ <input type="checkbox"/>	WDW <input type="checkbox"/>	CUSTOMER ORDER NO.			
CUSTOMER <u>Rosewood</u>	LEASE <u>E. I-114</u>	WELL NO. <u>34-21H</u>								
ADDRESS	COUNTY	STATE								
CITY	SERVICE CREW <u>Mark, Brian &amp; Van</u>		EQUIPMENT <u>M</u>							
AUTHORIZED BY	TYPE JOB <u>Logstring</u>		DEPTH FT.	CEMENT DATA: SACKS <input type="checkbox"/>	BULK <input checked="" type="checkbox"/>	SAND DATA: SACKS <input type="checkbox"/>	TRUCK CALLED	DATE	AM	TIME
SIZE LOGS	DEPTH	FT.	SACKS	BRAND	TYPE	% USE	ARRIVED AT JOB		AM	PM
SET A WT. CASTING	DEPTH	FT.	<u>50</u>	<u>A</u>	<u>TII</u>		START OPERATION		AM	PM
SIZE & WT. C. PIPE OR TUBING	DEPTH	FT.					FINISH OPERATION		AM	PM
TOP PLUGS	TYPE	WEIGHT OF SLURRY	<u>14.8</u>	LBS. /	<u>6.3</u>	LBS. / GAL.	RELEASED		AM	PM
		VOLUME OF SLURRY	<u>1.32</u>						AM	PM
		<u>50</u> SACKS CEMENT TREATED WITH	<u>2</u> % OF	<u>Kcl</u>			MILES FROM STATION TO WELL	<u>100</u>		
	MAX DEPTH	FT.		MAX PRESSURE	<u>1800</u>	RSE				

CONTRACT CONDITIONS: (This contract must be signed before the job is commenced or merchandise is delivered).

The undersigned hereby agrees to execute this contract as an agent of the customer. As such, the undersigned agrees and acknowledges that this contract for services, materials, products, and/or supplies includes all of and only those terms and conditions appearing on the front and back of this document. No additional or substitute terms and/or conditions shall become a part of this contract without written consent of an officer of Advanced Drilling Technologies, LLC.

SIGNED:

(WELL OWNER, OPERATOR, CONTRACTOR OR AGENT)

ITEM / PRICE / SER. NUMBER	MATERIAL, EQUIPMENT AND SERVICES USED	UNIT	QUANTITY	UNIT PRICE	\$ AMOUNT
<del>001-1</del>	<del>Depth Charge</del>				<del>1500 00</del>
100-1	mileage		200 miles		2170 00
200-1	Cement per sack		50 sk		875 00
300-2	4 1/2" Accu-Seal Float Shoe		1		267 07
300-4	4 1/2" Latchdown plug & Baffle		1		226 00
300-6	4 1/2" Centralizers		6		215 04
300-7	4 1/2" Cement Baskets		2		300 00
300-9	4 1/2" Cable Scratchers		8		278 40
300-12	7" Centralizer		1		36 44
400-2	clay stay		2.5		236 25
400-4	Kcl		100 lb		40 30
					6144 50
	<u>Bumper Plug 2130</u>				

SUB TOTAL

ACID DATA:		
GALLONS	%	ADDITIVES
HCL		
HCL		

SERVICE & EQUIPMENT	% TAX ON \$
MATERIALS	% TAX ON \$
TOTAL	

SERVICE REPRESENTATIVE  
 FIELD SERVICE ORDER NO.

THE ABOVE MATERIAL AND SERVICE ORDERED BY CUSTOMER AND RECEIVED BY:

*Tom W. [Signature]*  
 (WELL OWNER, OPERATOR, CONTRACTOR OR AGENT)

RECEIVED

DEC 04 2006

KCC WICHITA

15-181-20423-01-00



**ROSEWOOD RESOURCES INC.**

Field: Sherman County, KS  
 Site: G. Ihrig 34-21H  
 Well: #34-21H  
 Wellpath: Lateral

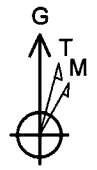

Azimuths to Grid North  
 True North: 2.33°  
 Magnetic North: 9.98°  
 Magnetic Field  
 Strength: 53488nT  
 Dip Angle: 66.93°  
 Date: 9/7/2006  
 Model: igrf2005

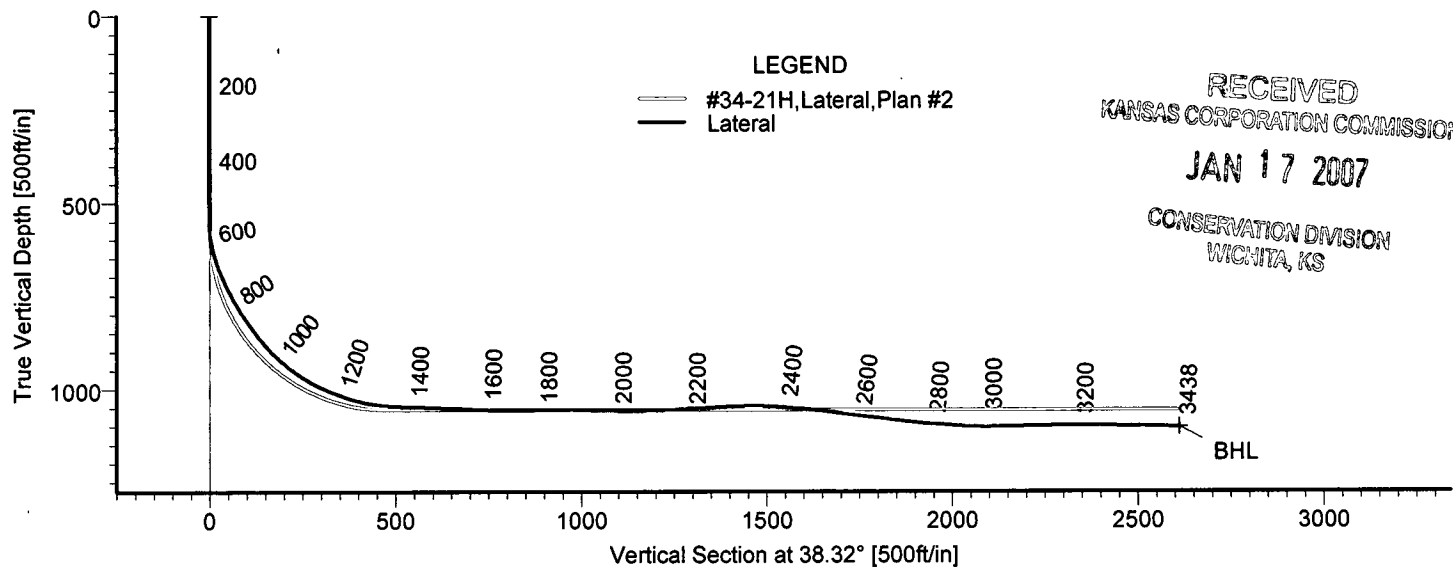
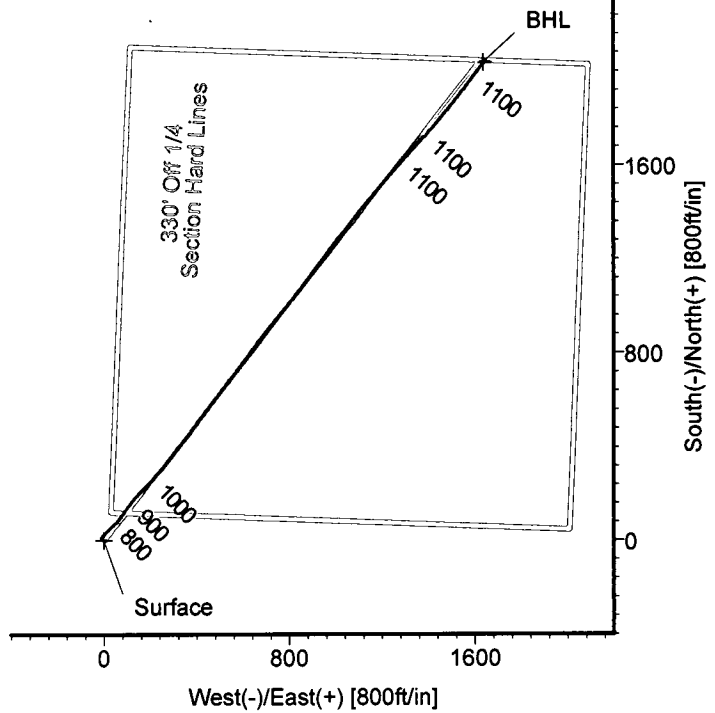
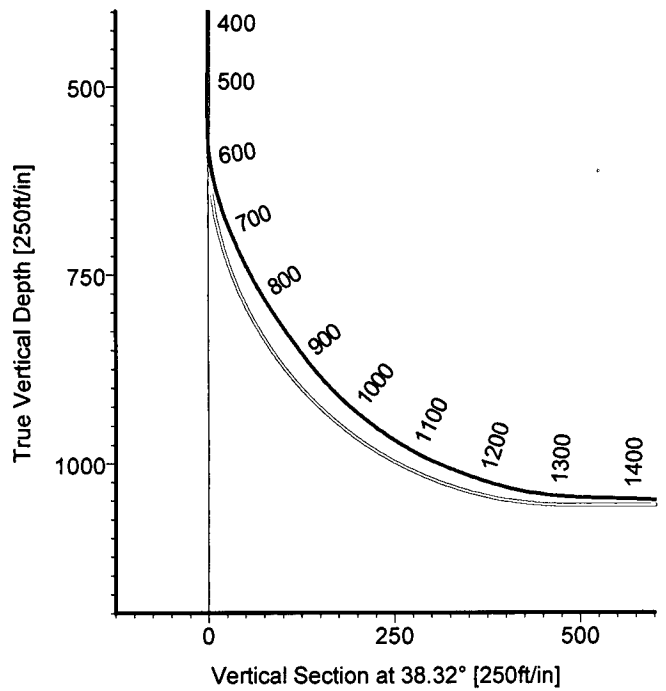

RECEIVED  
 KANSAS CORPORATION COMMISSION  
 JAN 17 2007  
 CONSERVATION DIVISION  
 WICHITA, KS

**TARGET DETAILS**

Name	TVD	+N/-S	+E/-W	Northing	Easting	Latitude	Longitude	Shape
Surface	0.00	0.00	0.00	418469.60	961141.90	39°25'27.784N	101°40'42.298W	Point
BHL	1103.12	2035.09	1637.05	420504.69	962778.95	39°25'48.538N	101°40'22.505W	Point



STRATA DIRECTIONAL TECHNOLOGY, INC.  
 1034 Regional Park Drive Houston, Texas 77060  
 Phone: 713-934-9600 Fax: 713-934-9067

Wellpath: (#34-21H/Lateral)  
 Created By: David Vogler Date: 9/25/2006  
 Checked: \_\_\_\_\_ Date: \_\_\_\_\_

# Strata Directional Technology, Inc.

## Survey Report

<b>Company:</b> ROSEWOOD RESOURCES INC.	<b>Date:</b> 9/25/2006	<b>Time:</b> 14:03:49	<b>Page:</b> 1
<b>Field:</b> Sherman County, KS	<b>Co-ordinate(NE) Reference:</b> Well: #34-21H, Grid North		
<b>Site:</b> G. Ihrig 34-21H	<b>Vertical (TVD) Reference:</b> 3618'GL+4'KB 3622.0		
<b>Well:</b> #34-21H	<b>Section (VS) Reference:</b> Well (0.00N,0.00E,38.32Azi)		
<b>Wellpath:</b> Lateral	<b>Survey Calculation Method:</b> Minimum Curvature	<b>Db:</b> Adapti	

<b>Field:</b> Sherman County, KS		
<b>Map System:</b> US State Plane Coordinate System 1927	<b>Map Zone:</b>	Kansas, Northern Zone
<b>Geo Datum:</b> NAD27 (Clarke 1866)	<b>Coordinate System:</b>	Well Centre
<b>Sys Datum:</b> Mean Sea Level	<b>Geomagnetic Model:</b>	igrf2005

<b>Site:</b> G. Ihrig 34-21H		
<b>Site Position:</b>	<b>Northing:</b> 418469.60 ft	<b>Latitude:</b> 39 25 27.784 N
<b>From: Map</b>	<b>Easting:</b> 961141.90 ft	<b>Longitude:</b> 101 40 42.298 W
<b>Position Uncertainty:</b> 0.00 ft		<b>North Reference:</b> Grid
<b>Ground Level:</b> 3618.00 ft		<b>Grid Convergence:</b> -2.33 deg

<b>Well:</b> #34-21H			<b>Slot Name:</b>		
<b>Well Position:</b>	<b>+N/-S</b> 0.00 ft	<b>Northing:</b> 418469.60 ft	<b>Latitude:</b> 39 25 27.784 N	<b>+E/-W</b> 0.00 ft	<b>Easting:</b> 961141.90 ft
			<b>Longitude:</b> 101 40 42.298 W		
<b>Position Uncertainty:</b>	0.00 ft				

<b>Wellpath:</b> Lateral			<b>Drilled From:</b> Surface		
<b>Current Datum:</b> 3618'GL+4'KB	<b>Height</b> 3622.00 ft		<b>Tie-on Depth:</b>	0.00 ft	
<b>Magnetic Data:</b> 9/7/2006			<b>Above System Datum:</b>	Mean Sea Level	
<b>Field Strength:</b> 53488 nT			<b>Declination:</b>	7.66 deg	
<b>Vertical Section:</b>	<b>Depth From (TVD)</b>	<b>+N/-S</b>	<b>Mag Dip Angle:</b>	66.93 deg	
	ft	ft	<b>+E/-W</b>	<b>Direction</b>	deg
	0.00	0.00	ft	deg	
				38.32	

<b>Survey Program for Definitive Wellpath</b>					
<b>Date:</b> 9/10/2006	<b>Validated:</b> No	<b>Version:</b> 0			
<b>Actual From</b>	<b>To</b>	<b>Survey</b>	<b>Toolcode</b>	<b>Tool Name</b>	
ft	ft				
394.00	3378.00	Survey #1 (394.00-3378.00)	MWD	Std MWD	
3438.00	3438.00	Survey #2 (3438.00-3438.00)	Project	Projection	

Survey										
MD	Incl	Azim	TVD	+N/-S	+E/-W	VS	DLS	Build	Turn	Tool/Comment
ft	deg	deg	ft	ft	ft	ft	deg/100ft	deg/100ft	deg/100ft	
0.00	0.00	0.00	0.00	0.00	0.00	0.00	0.00	0.00	0.00	TIE LINE
394.00	1.90	303.30	393.93	3.59	-5.46	-0.57	0.48	0.48	0.00	MWD
485.00	4.10	297.80	484.80	5.93	-9.60	-1.30	2.44	2.42	-6.04	MWD
516.00	4.50	309.80	515.71	7.23	-11.51	-1.47	3.17	1.29	38.71	MWD
548.00	4.00	322.90	547.62	8.92	-13.15	-1.16	3.40	-1.56	40.94	MWD
579.00	5.10	12.40	578.54	11.13	-13.51	0.36	12.70	3.55	159.68	MWD
611.00	10.50	35.60	610.24	14.89	-11.50	4.55	19.21	16.87	72.50	MWD
643.00	15.90	40.50	641.38	20.60	-6.96	11.85	17.22	16.87	15.31	MWD
675.00	20.30	44.50	671.79	27.90	-0.21	21.76	14.28	13.75	12.50	MWD
707.00	23.80	45.60	701.44	36.38	8.29	33.68	11.01	10.94	3.44	MWD
738.00	26.10	46.20	729.55	45.48	17.68	46.64	7.46	7.42	1.94	MWD
770.00	29.40	47.80	757.87	55.63	28.59	61.37	10.57	10.31	5.00	MWD
802.00	32.40	47.00	785.32	66.75	40.68	77.59	9.46	9.37	-2.50	MWD
833.00	34.50	45.00	811.19	78.63	52.96	94.53	7.65	6.77	-6.45	MWD
865.00	35.80	38.60	837.36	92.35	65.21	112.89	12.20	4.06	-20.00	MWD
897.00	38.40	36.10	862.88	107.70	76.91	132.19	9.39	8.12	-7.81	MWD
928.00	41.70	34.50	886.61	123.98	88.43	152.10	11.15	10.65	-5.16	MWD
960.00	45.80	35.70	909.72	142.08	101.16	174.19	13.07	12.81	3.75	MWD
992.00	50.40	37.50	931.09	161.18	115.36	197.99	14.97	14.37	5.62	MWD
1024.00	53.40	41.40	950.83	180.61	131.37	223.16	13.41	9.37	12.19	MWD
1056.00	57.70	42.90	968.93	200.16	149.08	249.48	13.98	13.44	4.69	MWD
1088.00	61.30	43.20	985.17	220.31	167.90	276.95	11.28	11.25	0.94	MWD

# Strata Directional Technology, Inc.

## Survey Report

<b>Company:</b> ROSEWOOD RESOURCES INC.	<b>Date:</b> 9/25/2006	<b>Time:</b> 14:03:49	<b>Page:</b> 2
<b>Field:</b> Sherman County, KS	<b>Co-ordinate(NE) Reference:</b> Well: #34-21H, Grid North		
<b>Site:</b> G. Ihrig 34-21H	<b>Vertical (TVD) Reference:</b> 3618'GL+4'KB 3622.0		
<b>Well:</b> #34-21H	<b>Section (VS) Reference:</b> Well (0.00N,0.00E,38.32Azi)		
<b>Wellpath:</b> Lateral	<b>Survey Calculation Method:</b> Minimum Curvature	<b>Db:</b> Adapti	

### Survey

MD ft	Incl deg	Azim deg	TVD ft	+N/-S ft	+E/-W ft	VS ft	DLS deg/100ft	Build deg/100ft	Turn deg/100ft	Tool/Comment
1120.00	66.50	42.90	999.24	241.30	187.51	305.58	16.27	16.25	-0.94	MWD
1151.00	68.70	42.40	1011.06	262.38	206.92	334.16	7.25	7.10	-1.61	MWD
1183.00	71.30	40.70	1022.00	284.88	226.86	364.17	9.54	8.12	-5.31	MWD
1215.00	74.90	41.00	1031.30	308.04	246.89	394.76	11.29	11.25	0.94	MWD
1247.00	79.50	38.20	1038.39	332.08	266.76	425.94	16.72	14.37	-8.75	MWD
1278.00	83.50	37.80	1042.97	356.23	285.64	456.60	12.97	12.90	-1.29	MWD
1309.00	87.00	38.90	1045.54	380.46	304.80	487.48	11.83	11.29	3.55	MWD
1341.00	88.40	38.90	1046.82	405.34	324.88	519.46	4.37	4.37	0.00	MWD
1372.00	88.50	38.50	1047.66	429.52	344.26	550.44	1.33	0.32	-1.29	MWD
1404.00	88.00	38.10	1048.64	454.62	364.08	582.43	2.00	-1.56	-1.25	MWD
1500.00	86.40	36.90	1053.33	530.69	422.45	678.30	2.08	-1.67	-1.25	MWD
1597.00	88.80	37.80	1057.39	607.73	481.24	775.19	2.64	2.47	0.93	MWD
1692.00	90.70	38.60	1057.80	682.38	539.99	870.19	2.17	2.00	0.84	MWD
1787.00	90.70	37.40	1056.64	757.23	598.47	965.18	1.26	0.00	-1.26	MWD
1883.00	88.20	36.50	1057.56	833.94	656.17	1061.14	2.77	-2.60	-0.94	MWD
1978.00	90.60	39.30	1058.56	908.89	714.51	1156.11	3.88	2.53	2.95	MWD
2074.00	93.50	39.70	1055.13	982.91	775.53	1252.02	3.05	3.02	0.42	MWD
2170.00	93.70	37.80	1049.10	1057.63	835.50	1347.82	1.99	0.21	-1.98	MWD
2265.00	91.30	37.10	1044.95	1132.97	893.20	1442.71	2.63	-2.53	-0.74	MWD
2361.00	85.60	36.40	1047.55	1209.83	950.60	1538.60	5.98	-5.94	-0.73	MWD
2456.00	82.50	38.70	1057.40	1284.73	1008.17	1633.06	4.06	-3.26	2.42	MWD
2552.00	83.10	39.00	1069.43	1358.90	1067.91	1728.30	0.70	0.62	0.31	MWD
2648.00	83.10	39.30	1080.96	1432.81	1128.08	1823.60	0.31	0.00	0.31	MWD
2743.00	84.40	40.30	1091.30	1505.36	1188.53	1918.00	1.72	1.37	1.05	MWD
2839.00	86.20	41.30	1099.17	1577.78	1251.05	2013.58	2.14	1.87	1.04	MWD
2934.00	90.90	42.80	1101.57	1648.28	1314.64	2108.32	5.19	4.95	1.58	MWD
3028.00	91.40	42.80	1099.69	1717.24	1378.49	2202.01	0.53	0.53	0.00	MWD
3124.00	90.70	40.50	1097.93	1788.95	1442.27	2297.83	2.50	-0.73	-2.40	MWD
3219.00	89.50	39.00	1097.76	1861.99	1503.02	2392.79	2.02	-1.26	-1.58	MWD
3315.00	88.40	37.40	1099.52	1937.41	1562.37	2488.77	2.02	-1.15	-1.67	MWD
3378.00	88.30	37.40	1101.34	1987.44	1600.62	2551.74	0.16	-0.16	0.00	MWD
3438.00	88.30	37.40	1103.12	2035.09	1637.05	2611.70	0.00	0.00	0.00	Project

### Targets

Name	Description		TVD ft	+N/-S ft	+E/-W ft	Map Northing ft	Map Easting ft	<--- Latitude --->			<--- Longitude --->				
	Dip.	Dir.						Deg	Min	Sec	Deg	Min	Sec		
Surface			0.00	0.00	0.00	418469.60	961141.90	39	25	27.784	N	101	40	42.298	W
BHL			1103.12	2035.09	1637.05	420504.69	962778.95	39	25	48.538	N	101	40	22.505	W