

15-163-00778-0000

STATE OF KANSAS  
STATE CORPORATION COMMISSION

Give All Information Completely  
Make Required Affidavit  
Mail or Deliver Report to:  
Conservation Division  
State Corporation Commission  
211 No. Broadway  
Wichita, Kansas

WELL PLUGGING RECORD

ROOKS County. Sec. 27 Twp. 10 Rge. 18 (X) W (W)

Location as "NE/CNW%SW%" or footage from lines NE NE SE

Lease Owner PETROLEUM, INC.

Lease Name EILERS Well No. 1

Office Address ROUTE 2, GREAT BEND, KANSAS

Character of Well (completed as Oil, Gas or Dry Hole) DRY HOLE

Date well completed January 22, 19 58

Application for plugging filed January 22, 19 58

Application for plugging approved January 23, 19 58

Plugging commenced January 22, 19 58

Plugging completed January 22, 19 58

Reason for abandonment of well or producing formation  
No Producing Zones

If a producing well is abandoned, date of last production None 19

Was permission obtained from the Conservation Division or its agents before plugging was commenced? Yes

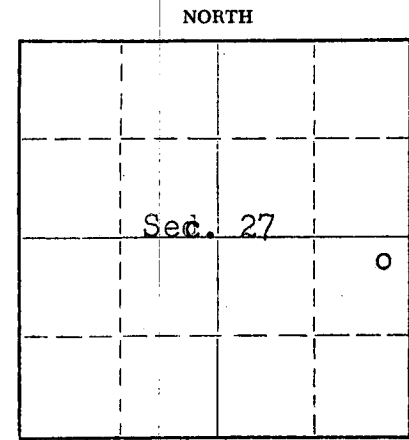

Locate well correctly on above Section Plat

Name of Conservation Agent who supervised plugging of this well Eldon Petty, Box 326, Hays, Kansas

Producing formation ----- Depth to top ----- Bottom ----- Total Depth of Well 3673 Feet

Show depth and thickness of all water, oil and gas formations.

OIL, GAS OR WATER RECORDS

CASING RECORD

FORMATION	CONTENT	FROM	TO	SIZE	PUT IN	PULLED OUT
				8-5/8"	252'	None

Describe in detail the manner in which the well was plugged, indicating where the mud fluid was placed and the method or methods used in introducing it into the hole. If cement or other plugs were used, state the character of same and depth placed, from \_\_\_\_\_ feet to \_\_\_\_\_ feet for each plug set.

Mud up with heavy mud to 600' followed by wooden plug at 600'.  
Placed 20 sacks cement through drill pipe on to plug. Mud up to 240'  
pushed down 1/2 sack hulls to 240' followed by wooden plug. Placed 15  
sacks cement on top of plug. Mud up to 40' and placed 1/2 sack hulls at  
40' followed by wooden plug and 10 sacks cement to base of well cellar.

1-31-58

(If additional description is necessary, use BACK of this sheet)

Name of Plugging Contractor GARVEY DRILLING COMPANY

Address ROUTE 2, GREAT BEND, KANSAS

STATE OF KANSAS, COUNTY OF BARTON, ss.

Don Searle (employee of owner) or (owner/operator) of the above-described well, being first duly sworn on oath, says: That I have knowledge of the facts, statements, and matters herein contained and the log of the above-described well as filed and that the same are true and correct. So help me God.

(Signature) Don Searle

Route 2, Great Bend, Kansas

(Address)

SUBSCRIBED AND SWORN TO before me this 29th day of January, 19 58

Notary Public signature

My commission expires July 11, 1960

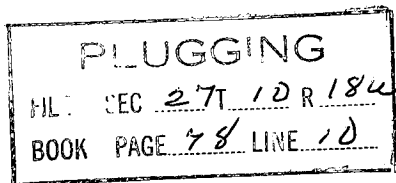

# WELL LOG

15-163-00778-0000

COMPANY PETROLEUM, INCORPORATED

SEC. 27 T. 10S R. 18W

FARM EILERS NO. 1

LOC. NE, NE, SE

TOTAL DEPTH 3673'

COUNTY ROOKS CO., KANSAS

COMM. January 11, 1958 COMP. January 22, 1958

CONTRACTOR GARVEY DRILLING COMPANY

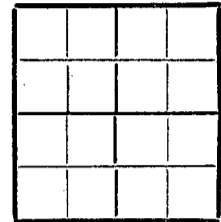

CASING 8 5/8" @ 252' W/150 sax.

ELEVATION 2026' DF

PRODUCTION D & A

FIGURES INDICATE BOTTOM OF FORMATIONS

170	Surface clay & shale
485	Blue shale & shells
690	Shale
870	Sand & pyrite
1050	Sand
1225	Red bed
1365	Shale & shells
1400	Anhydrite
1915	Shale & shells
3103	Lime & shale
3540	Lime
3608	Conglomerate & chert
3651	Conglomerate
3673	Lime
3673	T. D.

REC  
STATE OFFICE

JAN 31 1958

COMMISSIONER DIVISION  
OF REVENUE  
TOPEKA, KANSAS

**PLUGGING**  
 FILE SEC 27 T. 10 R. 18W  
 BOOK PAGE 78 LINE 10

State of KANSAS }  
County of BARTON } SS:

I, VERNE A. MORRIS of GARVEY DRILLING COMPANY

upon oath state that the above and foregoing is a true and correct copy of the log of the #1 Eilers well

*Verne A. Morris*

Subscribed and sworn to before me this 28th day of January 19 58

My Commission Expires: July 11, 1960

*Del J. Brown*  
NOTARY PUBLIC