

FOR KCC USE:

15-163-20828-0001

FORM C-1 7/91

FORM MUST BE TYPED

FORM MUST BE SIGNED

ALL BLANKS MUST BE FILLED

EFFECTIVE DATE: 10-13-92

State of Kansas

NOTICE OF INTENTION TO DRILL

Must be approved by the K.C.C. five (5) days prior to commencing well

DISTRICT # 4
SEAT... Yes... No

Expected Spud Date October 10, 1992
month day year

Spot NE SW NE 28 10 18 East
Sec Twp S. Rg X West

OPERATOR: License # 8507
Name: PAXCO, INC.
Address: 8920 Peppertree Circle
City/State/Zip: Wichita, Kansas 67226
Contact Person: Jay Clark
Phone: 316/634-1714

3630 feet from South / North line of Section
1650 feet from East / West line of Section

IS SECTION X REGULAR IRREGULAR?

(NOTE: Locate well on the Section Plat on Reverse Side)

County: Rooks
Lease Name: Henn Well #: 1
Field Name: Unknown

Is this a Prorated/Spaced Field? yes X no

Target Formation(s): Lansing

CONTRACTOR: License # 5929
Name: DUKE DRILLING CO., INC.

Nearest lease or unit boundary: 1650'

Ground Surface Elevation: 2077 feet MSL

Water well within one-quarter mile: yes X no

Public water supply well within one mile: yes X no

Depth to bottom of fresh water: 160

Depth to bottom of usable water: 805

Surface Pipe by Alternate: 1 X 2

Length of Surface Pipe ~~XXXXXX~~ set: 256' X

Length of Conductor pipe required: N/A

Projected Total Depth: 3670'

Formation at Total Depth: Arbuckle

Water Source for Drilling Operations:

well farm pond X other

DWR Permit #: _____

Will Cores Be Taken?: yes X no

If yes, proposed zone: _____

Well Drilled For: Well Class: Type Equipment:
X Oil ... Enh Rec X Infield X Mud Rotary
Gas ... Storage ... Pool Ext. ... Air Rotary
X OWWO ... Disposal ... Wildcat ... Cable
Seismic: # of Holes ... Other

If OWWO: old well information as follows:
Operator: JOHN P. JENNINGS OIL CO.
Well Name: Henn #1
Comp. Date: 7/23/78 Old Total Depth 3670'

Directional, Deviated or Horizontal wellbore? yes X no

If yes, true vertical depth: _____

Bottom Hole Location: _____

AFFIDAVIT

The undersigned hereby affirms that the drilling, completion and eventual plugging of this well will comply with K.S.A. 55-101, et. seq.

It is agreed that the following minimum requirements will be met:

- 1. Notify the appropriate district office prior to spudding of well;
- 2. A copy of the approved notice of intent to drill shall be posted on each drilling rig;
- 3. The minimum amount of surface pipe as specified below shall be set by circulating cement to the top; in all cases surface pipe shall be set through all unconsolidated materials plus a minimum of 20 feet into the underlying formation;
- 4. If the well is dry hole, an agreement between the operator and the district office on plug length and placement is necessary prior to plugging;
- 5. The appropriate district office will be notified before well is either plugged or production casing is cemented in;
- 6. IF AN ALTERNATE II COMPLETION, PRODUCTION PIPE SHALL BE CEMENTED FROM BELOW ANY USABLE WATER TO SURFACE WITHIN 120 DAYS OF SPUD DATE. IN ALL CASES, NOTIFY DISTRICT OFFICE PRIOR TO ANY CEMENTING.

I hereby certify that the statements made herein are true and to the best of my knowledge and belief.

Date: 10/5/92 Signature of Operator or Agent: Sally R. Byers Title: Agent

FOR KCC USE:
API # 15- 163 20828-0001 "OWWO"
Conductor pipe required None feet
Minimum surface pipe required 256 feet per Alt. X
Approved by: C.B. 10-8-92
This authorization expires: 4-8-93
(This authorization void if drilling not started within 6 months of effective date.)
Spud date: _____ Agent: _____

alternate II
Ext. April 13th 1993
RECEIVED
STATE CORPORATION COMMISSION
10-6-92
OCT 6 1992
TO

REMEMBER TO:

- File Drill Pit Application (form CDP-1) with Intent to Drill;
- File Completion Form ACO-1 within 120 days of spud date;
- File acreage attribution plat according to field proration orders;
- Notify appropriate district office 48 hours prior to workover or re-entry;
- Submit plugging report (CP-4) after plugging is completed;
- Obtain written approval before disposing or injecting salt water.

Mail to: Conservation Division, 200 Colorado Derby Building, 202 W. First St., Wichita, Kansas 67202-1286.

IN ALL CASES PLOT THE INTENDED WELL ON THE PLAT BELOW

PLAT OF ACREAGE ATTRIBUTABLE TO A WELL IN A PRORATED OR SPACED FIELD

If the intended well is in a prorated or spaced field, please fully complete this side of the form. If the intended well is in a prorated or spaced field complete the plat below showing that the well will be properly located in relationship to other wells producing from the common source of supply. Please show all the wells within 1 mile of the boundaries of the proposed acreage attribution unit for gas wells and within 1/2 mile of the boundaries of the proposed acreage attribution unit for oil wells.

API NO. 15- _____
 OPERATOR _____
 LEASE _____
 WELL NUMBER _____
 FIELD _____

LOCATION OF WELL: COUNTY _____
 _____ feet from south/north line of section
 _____ feet from east/west line of section
 SECTION _____ TWP _____ RG _____

NUMBER OF ACRES ATTRIBUTABLE TO WELL _____
 QTR/QTR/QTR OF ACREAGE _____ - _____ - _____

IS SECTION _____ REGULAR or _____ IRREGULAR
IF SECTION IS IRREGULAR, LOCATE WELL FROM NEAREST CORNER BOUNDARY.

Section corner used: _____ NE _____ NW _____ SE _____ SW

PLAT

(Show location of the well and shade attributable acreage for prorated or spaced wells.)
 (Show footage to the nearest lease or unit boundary line.)

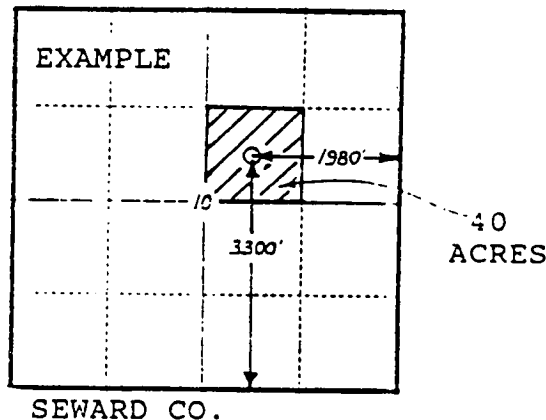
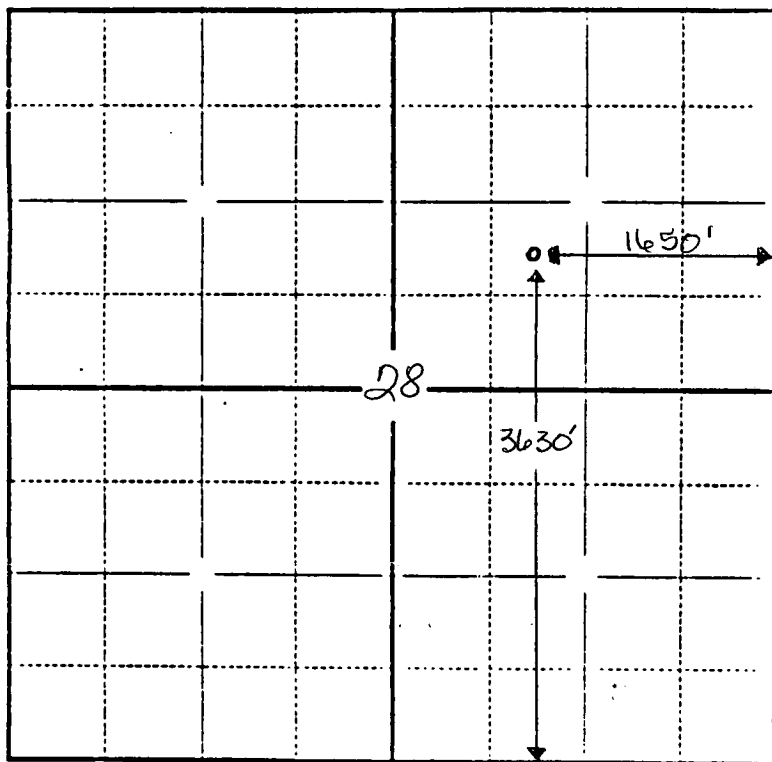

In plotting the proposed location of the well, you must show:

- 1) The manner in which you are using the depicted plat by identifying section lines, i.e. 1 section, 1 section with 8 surrounding sections, 4 sections, etc.;
- 2) the distance of the proposed drilling location from the section's south/north and east/west lines; and
- 3) the distance to the nearest lease or unit boundary line.

Joan Finney
Governor

Jim Robinson
Chairman

F. S. Jack Alexander
Commissioner

Rachel C. Lipman
Commissioner

Judith McConnell
Executive Director

Brian Moline
General Counsel



Kansas Corporation Commission

February 3, 1993

Jay C. Clark
PAXCO, Inc.
8920 Peppertree Circle
Wichita, Kansas 67226

Re: Alternate II
Henn #1
Rooks County, Kansas

Dear Mr. Clark:

This letter is written to inform you that you have been granted a sixty (60) day extension of time to complete Alternate II cementing on the above-described well.

Your original 120 days for completion expires February 13, 1993. Thus, this extension will expire on April 13, 1993. I urge you to make every effort to complete the cementing within this time frame. Extension of this time frame, pursuant to K.A.R. 82-3-106, automatically extends the time period for filing the ACO-1, pursuant to K.A.R. 82-3-130. Before completing the cementing of this well, please contact the Hays District Office at (913) 628-1200.

If you have any questions in this regard, please do not hesitate to contact me.

Very sincerely yours,

William R. Bryson, Director
Conservation Division

WRB:nao

cc: Rick Hestermann
Chris Bean
Priscilla Zadoka
Don Rider
District Office 4
File

Conservation Division
William R. Bryson
Director
200 Colorado Derby Bldg.
202 W. 1st Street
Wichita, Kansas 67202-1286
Telephone (316) 263-3238