

For KCC Use:
 Effective Date: 9-26-2009
 District #: 2
 SGA? Yes No

KANSAS CORPORATION COMMISSION
 OIL & GAS CONSERVATION DIVISION

** Correction*
CORRECTED

Form C-1
 October 2007

Form must be Typed
 Form must be Signed
 All blanks must be Filled

NOTICE OF INTENT TO DRILL

Must be approved by KCC five (5) days prior to commencing well

Expected Spud Date: September 28 2009
 month day year
 OPERATOR: License# 33971
 Name: TriPower Resources, LLC
 Address: P.O. Box 849
 Address 2:
 City: Ardmore State: Ok zip: 73402
 Contact Person: W.B. Curry
 Phone: 580-226-6700 ext 215
 CONTRACTOR: License# 33217
 Name: Three Rivers Exploration, LLC

Spot Description: SE NW NW SE
 * C SE NW NW SE Sec. 26 Twp. 24S S. R. 4 E W
 (Acres) * 2310 2150 feet from N / S Line of Section
2310 feet from E / W Line of Section
 Is SECTION: Regular Irregular?

(Note: Locate well on the Section Plat on reverse side!)

County: Butler
 Lease Name: Mingenback Well #. 5
 Field Name: Plum Grove South
 Is this a Prorated / Spaced Field? Yes No
 Target Formation(s): Mississippian
 Nearest Lease or unit boundary line (in footage): 330'
 * Ground Surface Elevation: Est 1435 1434 feet MSL
 Water well within one-quarter mile: Yes No
 Public water supply well within one mile: Yes No
 Depth to bottom of fresh water: 150'
 Depth to bottom of usable water: 180'
 Surface Pipe by Alternate: I II
 Length of Surface Pipe Planned to be set: 200'
 Length of Conductor Pipe (if any): None
 Projected Total Depth: 2700'
 Formation at Total Depth: Mississippian

Well Drilled For: Well Class: Type Equipment:
 Oil Enn Rec Infield Mud Rotary
 Gas Storage Pool Ext. Air Rotary
 Disposal Wildcat Cable
 Seismic # of Holes Other
 Other:
 If OWWO, old well information as follows:

Operator:
 Well Name:
 Original Completion Date: Original Total Depth:

Directional, Deviated or Horizontal wellbore? Yes No

If Yes, true vertical depth:

Bottom Hole Location:

KCC DKT #:

* WAS: S2-NW-NW-SE; 2150' FSL; Elev. 1435'
IS: NW-NW-SE; 2310' FSL; Elev. 1434'

AFFIDAVIT

The undersigned hereby affirms that the drilling, completion and eventual plugging of this well will comply with K.S.A. 55 et. seq.

It is agreed that the following minimum requirements will be met:

1. Notify the appropriate district office **prior** to spudding of well;
2. A copy of the approved notice of intent to drill **shall be** posted on each drilling rig;
3. The minimum amount of surface pipe as specified below **shall be set** by circulating cement to the top; in all cases surface pipe **shall be set** through all unconsolidated materials plus a minimum of 20 feet into the underlying formation.
4. If the well is dry hole, an agreement between the operator and the district office on plug length and placement is necessary **prior to plugging**;
5. The appropriate district office will be notified before well is either plugged or production casing is cemented in;
6. If an ALTERNATE II COMPLETION, production pipe shall be cemented from below any usable water to surface within **120 DAYS** of spud date. Or pursuant to Appendix "B" - Eastern Kansas surface casing order #133.891-C, which applies to the KCC District 3 area, alternate II cementing must be completed within 30 days of the spud date or the well shall be plugged. **In all cases, NOTIFY district office** prior to any cementing.

I hereby certify that the statements made herein are true and correct to the best of my knowledge and belief.

Date: 9-17-09 Signature of Operator or Agent: W.B. Curry Title: Agent

For KCC Use ONLY
 API # 15: 015-23839-00-00
 Conductor pipe required None feet
 Minimum surface pipe required 200 feet per ALT. I II
 Approved by: W.B. Curry 9-21-2009 / W.B. Curry 9-28-2009
 This authorization expires: 9-21-2010
 (This authorization void if drilling not started within 12 months of approval date.)
 Spud date: Agent:

Remember to:

- File Drill Pit Application (form CDP-1) with Intent to Drill;
- File Completion Form ACO-1 within 120 days of spud date;
- File acreage attribution plat according to field proration orders;
- Notify appropriate district office 48 hours prior to workover or re-entry;
- Submit plugging report (CP-4) after plugging is completed (within 60 days);
- Obtain written approval before disposing or injecting salt water
- If this permit has expired (See: authorized expiration date) please check the box below and return to the address below

Well Not Drilled - Permit Expired Date: Signature of Operator or Agent:

RECEIVED
 KANSAS CORPORATION COMMISSION

Mail to: KCC - Conservation Division, 130 S. Market - Room 2078, Wichita, Kansas 67202

SEP 28 2009

CONSERVATION DIVISION
 WICHITA, KS

RECEIVED
 SEP 21 2009
 KCC WICHITA

26-24-4
 E W

* Correction

IN ALL CASES PLOT THE INTENDED WELL ON THE PLAT BELOW

Plat of acreage attributable to a well in a prorated or spaced field

CORRECTED

If the intended well is in a prorated or spaced field, please fully complete this side of the form. If the intended well is in a prorated or spaced field complete the plat below showing that the well will be properly located in relationship to other wells producing from the common source of supply. Please show all the wells and within 1 mile of the boundaries of the proposed acreage attribution unit for gas wells and within 1/2 mile of the boundaries of the proposed acreage attribution unit for oil wells.

API No. 15 - 015-23839-00-00

Operator: TriPower Resources, LLC

Lease: Mingenback

Well Number: 5

Field: Plum Grove South

Number of Acres attributable to well: 160

QTR/QTR/QTR/QTR of acreage: SE - NW - NW - SE

* C

Location of Well: County: Butler

* 2,150 2,310 feet from N / S Line of Section

2,310 feet from E / W Line of Section

Sec. 26 Twp. 24 S. R. 4 E W

Is Section: Regular or Irregular

If Section is Irregular, locate well from nearest corner boundary.

Section corner used: NE NW SE SW

PLAT (Corrected Plat)

(Show location of the well and shade attributable acreage for prorated or spaced wells.)

(Show footage to the nearest lease or unit boundary line.)

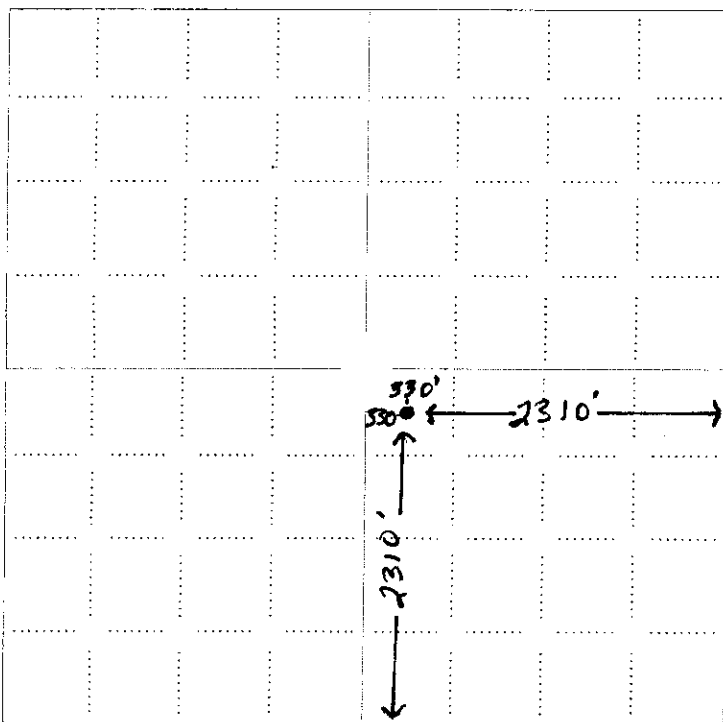

RECEIVED KANSAS CORPORATION COMMISSION

SEP 28 2009

CONSERVATION DIVISION WICHITA, KS

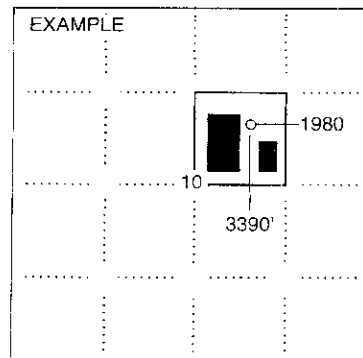

SEWARD CO.

NOTE: In all cases locate the spot of the proposed drilling locaton.

In plotting the proposed location of the well, you must show:

1. The manner in which you are using the depicted plat by identifying section lines, i.e. 1 section, 1 section with 8 surrounding sections, 4 sections, etc.
2. The distance of the proposed drilling location from the south / north and east / west outside section lines.
3. The distance to the nearest lease or unit boundary line (in footage).
4. If proposed location is located within a prorated or spaced field a certificate of acreage attribution plat must be attached: (CO-7 for oil wells; CG-8 for gas wells).

CORRECTED

KANSAS CORPORATION COMMISSION
OIL & GAS CONSERVATION DIVISION
APPLICATION FOR SURFACE PIT

* Correction

Form GDP-1
April 2004
Form must be Typed

Submit in Duplicate

Operator Name: TriPower Resources, LLC		License Number: 33971
Operator Address: P.O. Box 849, Ardmore, Ok. 73402		
Contact Person: W.B. Curry		Phone Number: (580) 226-6700, ext 215
Lease Name & Well No.: Mingenback # 5		Pit Location (QQQQ): *CSE NW NW SE
Type of Pit: <input type="checkbox"/> Emergency Pit <input type="checkbox"/> Burn Pit <input type="checkbox"/> Settling Pit <input checked="" type="checkbox"/> Drilling Pit <input type="checkbox"/> Workover Pit <input type="checkbox"/> Haul-Off Pit <small>(If WP Supply API No. or Year Drilled)</small>	Pit is: <input checked="" type="checkbox"/> Proposed <input type="checkbox"/> Existing If Existing, date constructed: _____ Pit capacity: _____ (bbbl)	Sec. 26 Twp. 24S R. 4 <input type="checkbox"/> East <input type="checkbox"/> West *2310 Feet from <input type="checkbox"/> North / <input checked="" type="checkbox"/> South Line of Section 2310 Feet from <input checked="" type="checkbox"/> East / <input type="checkbox"/> West Line of Section BUTLER County
Is the pit located in a Sensitive Ground Water Area? <input type="checkbox"/> Yes <input checked="" type="checkbox"/> No		Chloride concentration: NA mg/l <small>(For Emergency Pits and Settling Pits only)</small>
Is the bottom below ground level? <input checked="" type="checkbox"/> Yes <input type="checkbox"/> No	Artificial Liner? <input type="checkbox"/> Yes <input checked="" type="checkbox"/> No	How is the pit lined if a plastic liner is not used? Native Clay & Drilling Mud
Pit dimensions (all but working pits): 60 Length (feet) 6 Width (feet) (400 bbl) N/A : Steel Pits Depth from ground level to deepest point: 5 (feet)		
If the pit is lined give a brief description of the liner material, thickness and installation procedure. Not Required in Area		Describe procedures for periodic maintenance and determining liner integrity, including any special monitoring. ---
Distance to nearest water well within one-mile of pit 1771 629 feet Depth of water well 56 feet		Depth to shallowest fresh water ~45-150 feet. Source of information: _____ measured _____ well owner _____ electric log <input checked="" type="checkbox"/> (6) KDWR
Emergency, Settling and Burn Pits ONLY: Producing Formation: _____ Number of producing wells on lease: _____ Barrels of fluid produced daily: _____ Does the slope from the tank battery allow all spilled fluids to flow into the pit? <input type="checkbox"/> Yes <input type="checkbox"/> No		Drilling, Workover and Haul-Off Pits ONLY: Type of material utilized in drilling/workover: Water Base Mud Number of working pits to be utilized: 1 Abandonment procedure: Empty, backfill, level & restore surface. Drill pits must be closed within 365 days of spud date.
I hereby certify that the above statements are true and correct to the best of my knowledge and belief. 9-17-09 Date Signature of Applicant or Agent W.B. Curry		
KCC OFFICE USE ONLY		
Date Received: 9/28/09 Permit Number: _____ Permit Date: 9/28/09 Lease Inspection: <input type="checkbox"/> Yes <input checked="" type="checkbox"/> No		

RECEIVED
KANSAS CORPORATION COMMISSION
SEP 28 2009
CONSERVATION DIVISION
WICHITA, KS