

15-163-23352-00-00

KANSAS CORPORATION COMMISSION  
OIL & GAS CONSERVATION DIVISION  
NOTICE OF INTENT TO DRILL

RECEIVED  
8-16-02  
AUG 16 2002  
KCC WICHITA

Form C-1  
September 1999  
Form must be Typed  
Form must be Signed  
All blanks must be Filled

For KCC Use:  
Effective Date: 8-21-03  
District #: 4  
SGA?  Yes  No

Must be approved by KCC five (5) days prior to commencing well

Expected Spud Date 8 19 02  
month day year

Spot RT KLL  
NE NE NW NW  
NW NE NW Sec. 6 Twp. 10 S. R. 19  
 East  West

OPERATOR: License# 33037  
Name: Ron Cummings dba C C OIL  
Address: 2607 C AUGUSTA LANE  
City/State/Zip: HAYS KS 67601  
Contact Person: RON CUMMINGS  
Phone: 785-625-7202

150 feet from S (circle one) Line of Section  
1100 feet from N (circle one) Line of Section  
Is SECTION  Regular  Irregular?

CONTRACTOR: License# 30076  
Name: A & A PRODUCTION

(Note: Locate well on the Section Plat on reverse side)  
County: ROOKS  
Lease Name: CHILDS Well #: 2  
Field Name: \_\_\_\_\_

Well Utilized For:  Oil  Enh Rec  Gas  OWWO  Seismic;  Other  
Well Class:  Infield  Pool Ext.  Wildcat  Other  
Type Equipment:  Mud Rotary  Air Rotary  Cable

is this a Prorated / Spaced Field?  Yes  No  
Target Formation(s): LANSING/ KANSAS CITY

\* Nearest Lease or unit boundary: 1100 to Unit Boundary  
Ground Surface Elevation: 2194 feet MSL

Water well within one-quarter mile: Yes  No  
Public water supply well within one mile:  Yes  No

Depth to bottom of fresh water: 180  
Depth to bottom of usable water: 940

Surface Pipe by Alternate: 1  2  
Length of Surface Pipe Planned to be set: 220

Length of Conductor Pipe required: none  
Projected Total Depth: 3800

Formation at Total Depth: LANSING / KANSAS CITY  
Water Source for Drilling Operations:  Well  Farm Pond  Other

DWR Permit #: \_\_\_\_\_  
(Note: Apply for Permit with DWR )

Will Cores be taken?  Yes  No  
If Yes, proposed zone: \_\_\_\_\_

If OWWO: old well information as follows:  
Operator: \_\_\_\_\_  
Well Name: \_\_\_\_\_  
Original Completion Date: \_\_\_\_\_ Original Total Depth: \_\_\_\_\_

Directional, Deviated or Horizontal wellbore?  Yes  No

If Yes, true vertical depth: \_\_\_\_\_  
Bottom Hole Location: \_\_\_\_\_  
KCC DKT #: \_\_\_\_\_

\* BOOLED: see 15-163-23349-0000 Childswl, 6-10-19w

AFFIDAVIT

The undersigned hereby affirms that the drilling, completion and eventual plugging of this well will comply with K.S.A. 55-101, et. seq.  
It is agreed that the following minimum requirements will be met:

1. Notify the appropriate district office prior to spudding of well;
2. A copy of the approved notice of intent to drill shall be posted on each drilling rig;
3. The minimum amount of surface pipe as specified below shall be set by circulating cement to the top; in all cases surface pipe shall be set through all unconsolidated materials plus a minimum of 20 feet into the underlying formation.
4. If the well is dry hole, an agreement between the operator and the district office on plug length and placement is necessary prior to plugging;
5. The appropriate district office will be notified before well is either plugged or production casing is cemented in;
6. If an ALTERNATE II COMPLETION, production pipe shall be cemented from below any usable water to surface within 120 days of spud date. In all cases, NOTIFY district office prior to any cementing.

I hereby certify that the statements made herein are true and to the best of my knowledge and belief.

Date: 8-14-02 Signature of Operator or Agent: Andy Anderson Title: Contractor

For KCC Use ONLY  
API # 15 - 163-23352-00-00  
Conductor pipe required NONE feet  
Minimum surface pipe required 200 feet per Alt. (2)  
Approved by: RJP 8-16-02  
This authorization expires: 2-16-03  
(This authorization void if drilling not started within 6 months of effective date.)  
Spud date: \_\_\_\_\_ Agent: \_\_\_\_\_

- Remember to:
- File Drill Pit Application (form CDF-1) with Intent to Drill;
  - File Completion Form ACO-1 within 120 days of spud date;
  - File acreage attribution plat according to field proration orders;
  - Notify appropriate district office 48 hours prior to workover or re-entry;
  - Submit plugging report (CP-4) after plugging is completed;
  - Obtain written approval before disposing or injecting salt water.

6  
10  
19w

IN ALL CASES PLOT THE INTENDED WELL ON THE PLAT BELOW

Plat of acreage attributable to a well in a prorated or spaced field

RECEIVED

AUG 16 2002

KCC WICHITA

If the intended well is in a prorated or spaced field, please fully complete this side of the form. If the intended well is in a prorated or spaced field complete the plat below showing that the well will be properly located in relationship to other wells producing from the common source of supply. Please show all the wells and within 1 mile of the boundaries of the proposed acreage attribution unit for gas wells and within 1/2 mile of the boundaries of the proposed acreage attribution unit for oil wells.

Pl No. 15 - \_\_\_\_\_  
Operator: C C OIL  
Lease: CHILDS  
Well Number: 2  
Field: \_\_\_\_\_

Location of Well: County: ROOKS  
\_\_\_\_\_ 150 feet from S (N circled one) Line of Section  
\_\_\_\_\_ 1100 feet from E (W circled one) Line of Section  
Sec. 6 Twp. 10 S. R. 19  East  West

Number of Acres attributable to well: 10  
TR / QTR / QTR of acreage: NW NE NW

Is Section X Regular or \_\_\_\_\_ Irregular

If Section Is Irregular, locate well from nearest corner boundary.  
Section corner used: \_\_\_\_\_ NE \_\_\_\_\_ NW \_\_\_\_\_ SE \_\_\_\_\_ SW

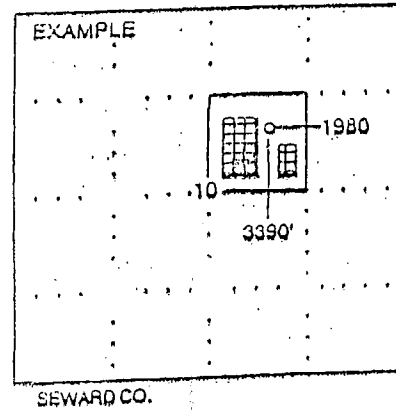
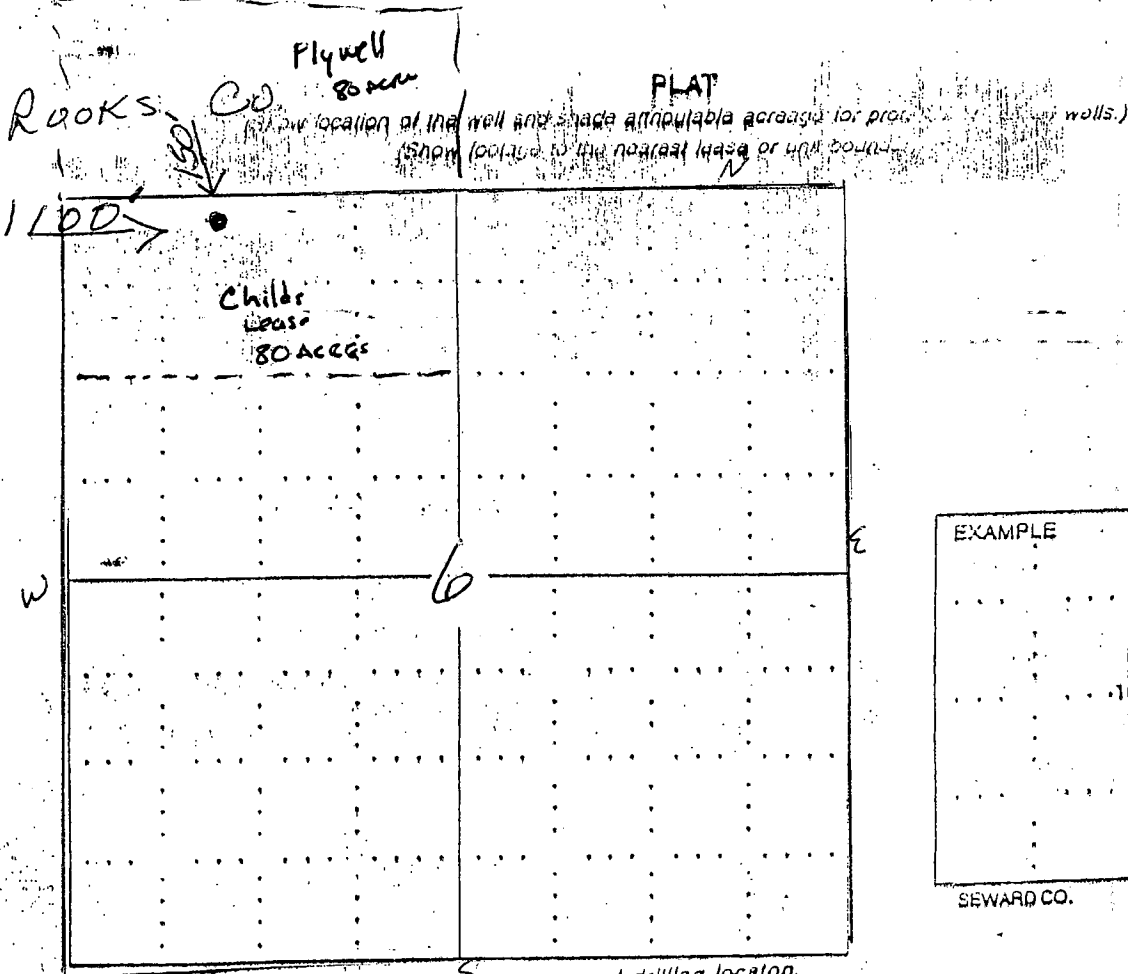

NOTE: In all cases locate the spot of the proposed drilling location.

- 1 plotting the proposed location of the well, you must show:
    - The manner in which you are using the depicted plat by identifying section lines, i.e. 1 section, 1 section with 8 surrounding sections, 4 sections, etc.
    - The distance of the proposed drilling location from the section's south / north and east / west boundary line.
    - The distance to the nearest lease or well boundary line.
- Plat of acreage attribution for prorated or spaced wells. (Show location to the nearest lease or well boundary line.)
- Plat of acreage attribution for prorated or spaced wells. Certificate of acreage attribution plat must be attached: (C07 for oil wells; C08 for gas wells).