

Give All Information Completely
Make Required Affidavit
Mail or Deliver Report to:
Conservation Division
State Corporation Commission
212 North Market, Insurance Bldg.
Wichita, Kansas

WELL PLUGGING RECORD

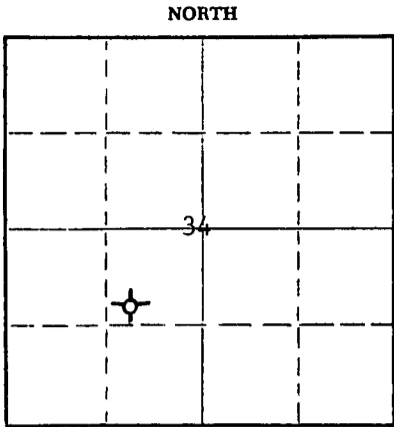

Locate well correctly on above Section Plat

Rooks County. Sec. 34 Twp. 10S Rge. 19W ~~(X)~~ (W)
Location as "NE/CNWxSWx" or footage from lines SW NE SW
Lease Owner John O. Farmer, Inc.
Lease Name Boys Town Well No. #1
Office Address P.O. Box 352, Russell, KS 67665
Character of Well (completed as Oil, Gas or Dry Hole) Dry Hole
Date well completed May 7, 1980
Application for plugging filed Yes 1980
Application for plugging approved 19
Plugging commenced 19
Plugging completed 2:15 P.M., May 7, 1980
Reason for abandonment of well or producing formation _____

If a producing well is abandoned, date of last production _____ 19____
Was permission obtained from the Conservation Division or its agents before plugging was commenced? Yes

Name of Conservation Agent who supervised plugging of this well Marion Smith
Producing formation _____ Depth to top _____ Bottom _____ Total Depth of Well _____ Feet
Show depth and thickness of all water, oil and gas formations.

OIL, GAS OR WATER RECORDS

CASING RECORD

FORMATION	CONTENT	FROM	TO	SIZE	PUT IN	PULLED OUT

Describe in detail the manner in which the well was plugged, indicating where the mud fluid was placed and the method or methods used in introducing it into the hole. If cement or other plugs were used, state the character of same and depth placed, from _____ feet to _____ feet for each plug set.

Plug #1 set @ 740' w/70 sx. cement
Plug #2 set @ 210' w/20 sx. cement
Plug #3 set @ 40' w/10 sx. cement

RECEIVED
5-21-80
WICHITA, KANSAS

(If additional description is necessary, use BACK of this sheet)
Name of Plugging Contractor John O. Farmer, Inc.
Address P.O. Box 352, Russell, KS 67665

STATE OF Kansas COUNTY OF Russell, ss.
John O. Farmer (employee or owner) or (owner or operator) of the above-described well, being first duly sworn on oath, says: That I have knowledge of the facts, statements and matters herein contained and the log of the above-described well as filed and that the same are true and correct. So help me God.

(Signature) John O. Farmer
P.O. Box 352, Russell, KS 67665
(Address)

Subscribed and sworn to before me this 19th day of May, 1980
Debbie Maier
Debbie Maier Notary Public.



KANSAS DRILLERS LOG

S. 34 T. 10S R. 19W
 Loc. SW NE SW
 County Rooks

API No. 15 — 163 — 21,064
 County Number

Operator John O. Farmer, Inc.

Address P.O. Box 352, Russell, KS 67665

Well No. #1 Lease Name Boys Town

Footage Location 990 feet from (N) ~~XX~~ line 990 feet from (E) ~~XX~~ line

Principal Contractor John O. Farmer, Inc. Geologist Sam Farmer

Spud Date 4-30-80 Total Depth 3560' P.B.T.D.

Date Completed 5-7-80 Oil Purchaser

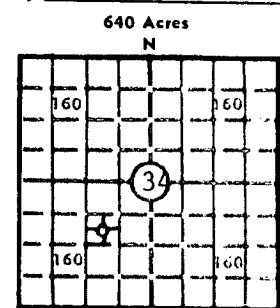

Locate well correctly
 Elev.: Gr. 2131'
 DF 2134' KB 2136'

CASING RECORD

Report of all strings set — surface, intermediate, production, etc.

Purpose of string	Size hole drilled	Size casing set (in O.D.)	Weight lbs/ft.	Setting depth	Type cement	Sacks	Type and percent additives
Surface	12-1/4	8-5/8	28	222'	Common	160	

LINER RECORD

PERFORATION RECORD

Top, ft.	Bottom, ft.	Sacks cement	Shots per ft.	Size & type	Depth interval

TUBING RECORD

Size	Setting depth	Packer set at

ACID, FRACTURE, SHOT, CEMENT SQUEEZE RECORD

Amount and kind of material used	Depth interval treated

INITIAL PRODUCTION

Date of first production	Producing method (flowing, pumping, gas lift, etc.)
RATE OF PRODUCTION PER 24 HOURS	Oil bbls. Gas MCF Water bbls. Gas-oil-ratio
Disposition of gas (vented, used on lease or sold)	Producing interval(s) CFPB

RECEIVED
 MAY 21 1980
 CONSERVATION DIVISION
 STATE GEOLOGICAL SURVEY OF KANSAS

INSTRUCTIONS: As provided in KCC Rule 82-2-125, within 90 days after completion of a well, one completed copy of this Drillers Log shall be transmitted to the State Geological Survey of Kansas, 4150 Monroe Street, Wichita, Kansas 67209. Copies of this form are available from the Conservation Division, State Corporation Commission, 3830 So. Meridian (P.O. Box 17027), Wichita, Kansas 66217. Phone AC 316-522-2206. If confidential custody is desired, please note Rule 82-2-125. Drillers Logs will be on open file in the Oil and Gas Division, State Geological Survey of Kansas, Lawrence, Kansas 66044.

Operator **John O. Farmer, Inc.** DESIGNATE TYPE OF COMP.: OIL, GAS, DRY HOLE, SWDW, ETC.:

Well No. #1 Lease Name **Boys Town** Dry Hole

S 34 T 10S R 19W ^K W

WELL LOG

Show all important zones of porosity and contents thereof; cored intervals, and all drill-stem tests, including depth interval tested, cushion used, time tool open, flowing and shut-in pressures, and recoveries.

SHOW GEOLOGICAL MARKERS, LOGS RUN, OR OTHER DESCRIPTIVE INFORMATION.

FORMATION DESCRIPTION, CONTENTS, ETC.	TOP	BOTTOM	NAME	DEPTH
Clay & Post Rock Sand	-0-	85		<u>Sample Tops</u>
Blue Shale	85	222		
Sand & Shale	222	432	Anhydrite	1465 (+671)
Shale & Sand	432	605	Heebner	3311 (-1175)
Sand	605	765	Toronto	3331 (-1195)
Shale & Sand	765	940	Lansing	3350 (-1214)
Sand	940	1130	T.D.	3560 (-1424)
Red Bed	1130	1465		
Anhydrite	1465	1500		
Shale & Shells	1500	1550		
Shale & Lime	1550	3435		
Lime	3435	3560		

USE ADDITIONAL SHEETS, IF NECESSARY, TO COMPLETE WELL RECORD.

Date Received _____

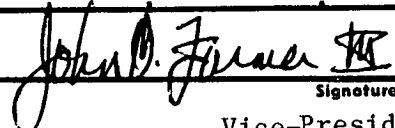
 Signature
 Vice-President
 Title
 May 19, 1980
 Date