

RECEIVED

AUG 26 2009

KANSAS CORPORATION COMMISSION
OIL & GAS CONSERVATION DIVISION

KCC WICHITA

Form CP-1
March 2009

This Form must be Typed
Form must be Signed
All blanks must be Filled

WELL PLUGGING APPLICATION

Please TYPE Form and File ONE Copy

OPERATOR: License #: 5721
Name: Glacier Petroleum, Inc.
Address 1: P.O. Box 577
Address 2: _____
City: Emporia State: KS Zip: 66801 + 0577
Contact Person: J.C Hawes
Phone: (620) 342-1148

API No. 15 - 073-22750 - 0000
If pre 1967, supply original completion date: _____
Spot Description: Approx W/2 SE NW
Sec. 32 Twp. 23 S. R. 10 East West
1,980 Feet from North / South Line of Section
1,640 Feet from East / West Line of Section
Footages Calculated from Nearest Outside Section Corner:
 NE NW SE SW
County: Greenwood
~~McKee~~ Lease Name: McKee Bessie Well #: 6

AK-KCCPRT

Check One: Oil Well Gas Well OG D&A Cathodic Water Supply Well Other: _____
 SWD Permit #: _____ ENHR Permit #: _____ Gas Storage Permit #: _____

Conductor Casing Size: _____ Set at: _____ Cemented with: _____ Sacks
Surface Casing Size: 7" Set at: 205.7 ft Cemented with: 100 Sacks
Production Casing Size: 4 1/2" Set at: 2338 ft Cemented with: 100 Sacks

List (ALL) Perforations and Bridge Plug Sets:

Perf (10 holes) from 2262 ft to 2214 ft.

Elevation: 1348 (G.L. / K.B.) T.D.: 2345 PBTD: 2337 Anhydrite Depth: N/A
(Stone Corral Formation)

Condition of Well: Good Poor Junk in Hole Casing Leak at: _____
(Interval)

Proposed Method of Plugging (attach a separate page if additional space is needed):

Cement plug 2220 ft to 1890 ft, pull casing, cement plug from 250 ft to 150 ft, cement from 60 ft to surface.

Is Well Log attached to this application? Yes No Is ACO-1 filed? Yes No

If ACO-1 not filed, explain why:

Plugging of this Well will be done in accordance with K.S.A. 55-101 et. seq. and the Rules and Regulations of the State Corporation Commission

Company Representative authorized to supervise plugging operations: Mark Lynch
Address: P.O. Box 577 City: Emporia State: Ks Zip: 66801 + 0577
Phone: (620) 344-1471
Plugging Contractor License #: 5721 Name: Glacier Petroleum, Inc.
Address 1: P.O. Box 577 Address 2: _____
City: Emporia State: KS Zip: 66801 + 0577
Phone: (620) 342-1148

Proposed Date of Plugging (if known): unknown

Payment of the Plugging Fee (K.A.R. 82-3-118) will be guaranteed by Operator or Agent

Date: 8/26/09 Authorized Operator / Agent: _____
(Signature)

Mail to: KCC - Conservation Division, 130 S. Market - Room 2078, Wichita, Kansas 67202

Dist 3
PKT

DRILLERS LOG

S. 32 T. 23S R. 10 ^E~~XXX~~

Loc. 1980' FNL 1640' FWL NW4

County Greenwood

API No. 15 - 073 County - 22,750 Number

Operator

Glacier Petroleum Company, Inc.

Address

P.O. Box 577, Emporia, Kansas 66801

Well No.

6

Lease Name

Bessie McKee

Footage Location

1980 feet from (N) (S) line 1640 feet from (E) (W) line

Principal Contractor

Glacier Drilling Company, Inc.

Geologist

Chuck Kuhl

Spud Date

03-06-83

Total Depth

2,345'

P.B.T.D.

2,500'

Date Completed

03-09-83

Oil Purchaser

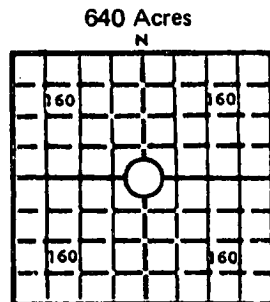

Locate well correctly

Elev.: Gr. 1348'

DF _____ KB _____

CASING RECORD

Report of all strings set—surface, intermediate, production, etc.

Purpose of string	Size hole drilled	Size casing set (in O.D.)	Weight lbs/ft.	Setting depth	Type cement	Sacks	Type and percent additives
SURFACE	9-7/8"	7"		205.76'	Common	100	3% cc
PRODUCTION	6-1/4"	4 1/2"		2,338'	Common	100	2% gel

WELL LOG

Show all important zones of porosity and contents thereof; cored intervals, and all drill-stem tests, including depth interval tested, cushion used, time tool open, flowing and shut-in pressures, and recoveries.

Formation	Top	Btm.	Formation	Top	Btm.	Formation	Top	Btm.
Soil	0	6						
Lime w/shl stks	6	137						
Shale w/lm stks	137	175						
Lime	175	178						
Shale	178	188						
Lime w/shl stks	188	1028						
Shale	1028	1198						
Shale w/lm stks	1198	1291						
Lansing	1291	1578						
Kansas City	1578	1762						
Base of K.C.	1762	1978						
Fort Scott	1978	2034						
Cherokee	2034	2220						
Bartlesville	2220	2287						
Base	2287	2345 TD						

RECEIVED
 AUG 26 2009
 KCC WICHITA



CORPORATION COMMISSION

Mark Parkinson, Governor Thomas E. Wright, Chairman Michael C. Moffet, Commissioner Joseph F. Harkins, Commissioner

NOTICE OF RECEIPT OF WELL PLUGGING APPLICATION (CP-1)

GLACIER PETROLEUM CO., INC.
825 COMMERCIAL ST
PO BOX 577
EMPORIA, KS 66801-2914

September 02, 2009

Re: MCKEE BESSIE #6
API 15-073-22750-00-00
32-23S-10E, 1980 FNL 1640 FWL
GREENWOOD COUNTY, KANSAS

Dear Operator:

This letter is to notify you that the Conservation Division has received your plugging proposal, form CP-1, for the above well and has reviewed the proposal for completeness. The central office will now forward your CP-1 to the district office listed below for review of the proposed plugging method. **Please contact the district office for approval of your proposed plugging method at least five (5) days before plugging the well, pursuant to K.A.R. 82-3-113(b). If a workover pit will be used during the plugging of the well it must be permitted. A CDP-1 form must be filed and approved prior to the use of the pit in accordance with K.A.R. 82-3-600.**

The Conservation Division's review of form CP-1, either in the central or district office, does not include an inquiry into well ownership or the filing operator's legal right to plug the well. This notice in no way constitutes authorization to plug the above well by persons not having legal rights of ownership or interest in the well.

This notice is void after March 1, 2010. The CP-1 filing does not bring the above well into compliance with K.A.R. 82-3-111 with regard to the Commission's temporary abandonment requirements.

Sincerely,

Steve Bond
Production Department Supervisor

District: #3
1500 W. 7th
Chanute, KS 67220
(620) 432-2300