

For KCC Use:
Effective Date: 10-10-2009
District #: 4
SGA? Yes No

KANSAS CORPORATION COMMISSION
OIL & GAS CONSERVATION DIVISION

CORRECTED

Form C-1
October 2007
Form must be Typed
Form must be Signed
All blanks must be Filled

NOTICE OF INTENT TO DRILL

Must be approved by KCC five (5) days prior to commencing well

Expected Spud Date: October 20 2009
month day year

Spot Description: 70'N & 40'W of
C SE Sec 26 Twp. 5 S Rng. 37 E W

OPERATOR: License # 5003
Name: McCoy Petroleum Corporation
Address 1: 8080 E. Central, Suite #300
Address 2:
City: Wichita State: KS Zip: 67206-2366
Contact Person: Scott Hampel
Phone: 316-636-2737 x 104

1390 feet from N/S Line of Section
1360 feet from E/W Line of Section

CONTRACTOR: License # 30606
Name: Murfin Drilling Company

Is SECTION: Regular Irregular?
(Note: Locate well on the Section Plat on reverse side)

County: Cheyenne
Lease Name: FISHER "F" Well #: 1-26

Field Name: Wildcat
Is this a Prorated / Spaced Field? Yes No

Target Information(s): LKC
Nearest Lease or unit boundary (in footage): 660'

Ground Surface Elevation: 3263' feet MSL
Water well within one-quarter mile: Yes No

Public water supply well within one mile: Yes No
Depth to bottom of fresh water: 160'

Depth to bottom of usable water: 160'
Surface Pipe by Alternate: I II

Length of Surface Pipe Planned to be set: 400'
Length of Conductor Pipe (if any): None

Projected Total Depth: 5000'
Formation at Total Depth: Mississippian

Water Source for Drilling Operations: Well Farm Pond Other

DWR Permit #:
(Note: Apply for Permit with DWR)

Will Cores be taken? Yes No
If Yes, proposed zone:

Well Drilled For: Oil Gas Seismic Other
Well Class: Enh Rec Storage Disposal
Type Equipment: Mud Rotary Air Rotary Cable

If OWWO: old well information as follows:
Operator:
Well Name:
Original Completion Date: Original Total Depth:

Directional, Deviated or Horizontal wellbore? Yes No
If Yes, true vertical depth:
Bottom Hole Location:

\*WAS: 150' E OF C-NW-SE 1980' FSL; 1820' FEL
IS: 70' N & 40' W OF C-SE 1390' FSL; 1360' FEL AFFIDAVIT

The undersigned hereby affirms that the drilling, completion and eventual plugging of this well will comply with K.S.A. 55 et. seq.
It is agreed that the following minimum requirements will be met:

- 1. Notify the appropriate district office prior to spudding of well;
2. A copy of the approved notice of intent to drill shall be posted on each drilling rig;
3. The minimum amount of surface pipe as specified below shall be set by circulating cement to the top, in all cases surface pipe shall be set through all unconsolidated materials plus a minimum of 20 feet into the underlying formation.
4. If the well is dry hole, an agreement between the operator and the district office on plug length and placement is necessary prior to plugging;
5. The appropriate district office will be notified before well is either plugged or production casing is cemented in;
6. If an ALTERNATE II COMPLETION, production pipe shall be cemented from below any unable water to surface within 120 days of plug date. Or pursuant to Appendix "B" - Eastern Kansas surface casing order #133,891-C, which applies to the KCC District 3 area, alternate II cementing must be completed within 30 days of the spud date or the well shall be plugged. In all cases, NOTIFY district office prior to any cementing.

I hereby certify that the statements made herein are true and to the best of my knowledge and belief.

Date: 10/28/09 Signature of Operator or Agent: Scott Hampel Title: Vice President - Production

For KCC Use ONLY
API # 15 - 023-21218-00-00 (Previous Assigned)
Conductor pipe required None feet
Minimum surface pipe required 210' feet per ALT. I II
Approved by: Perm 10-5-2009 / Perm 10-29-2009
This authorization expires: 10/5/2010
(This authorization void if drilling not started within 12 months of effective date.)
Spud date: Agent:

- Remember to:
- File Drill Pit Application (form CDP-1) with Intent to Drill;
- File Completion Form ACO-1 within 120 days of spud date;
- File acreage attribution plat according to field proration orders;
- Notify appropriate district office 48 hours prior to workover or re-entry;
- Submit plugging report (CP-4) after plugging is completed (within 60 days);
- Obtain written approval before disposing or injecting salt water.
- If this permit has expired (See: authorized expiration date) please check the box below and return to the address below.

Well Not Drilled - Permit Expired Date:
Signature of Operator or Agent:

Mail to: KCC - Conservation Division, 130 S. Market - Room 2078, Wichita, Kansas 67202

RECEIVED
OCT 29 2009

KCC WICHITA

26-5-37

E W

**CORRECTED**

**ALL CASES PLOT THE INTENDED WELL ON THE PLAT BELOW**

*Plat of acreage attributable to a well in a prorated or spaced field*

*If the intended well is in a prorated or spaced field, please fully complete this side of the form.* If the intended well is in a prorated or spaced field complete the plat below showing that the well will be properly located in relationship to other wells producing from the common source of supply. Please show all the wells and within 1 mile of the boundaries of the proposed acreage attribution unit for gas wells and within 1/2 mile of the boundaries of the proposed acreage attribution unit for oil wells.

API No. 15 - \_\_\_\_\_  
 Operator: McCoy Petroleum Corporation  
 Lease: FISHER "F"  
 Well Number: #1-26  
 Field: Wildcat  
 Number of Acres attributable to well: 160  
 QTR / QTR / QTR of acreage: SE

Location of Well: County: 70°N & 40°W of C SE, Cheyenne Co, KS  
 \_\_\_\_\_  
 1390 feet from  N  S (check one) Line of Section  
 \_\_\_\_\_  
 1360 feet from  E  W (check one) Line of Section  
 Sec 26 Twp 5 S. R. 37  East  West  
 Is Section:  Regular  Irregular?  
 If Section is Irregular, locate well from nearest corner boundary.  
 Section corner used:  NE  NW  SE  SW

**PLAT**

*(Show location of the well and shade attributable acreage for prorated or spaced wells)*  
*(Show footage to the nearest lease or unit boundary line.)*

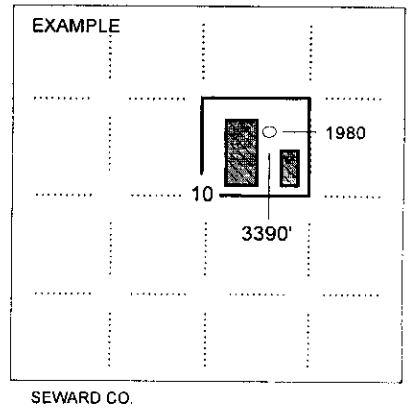
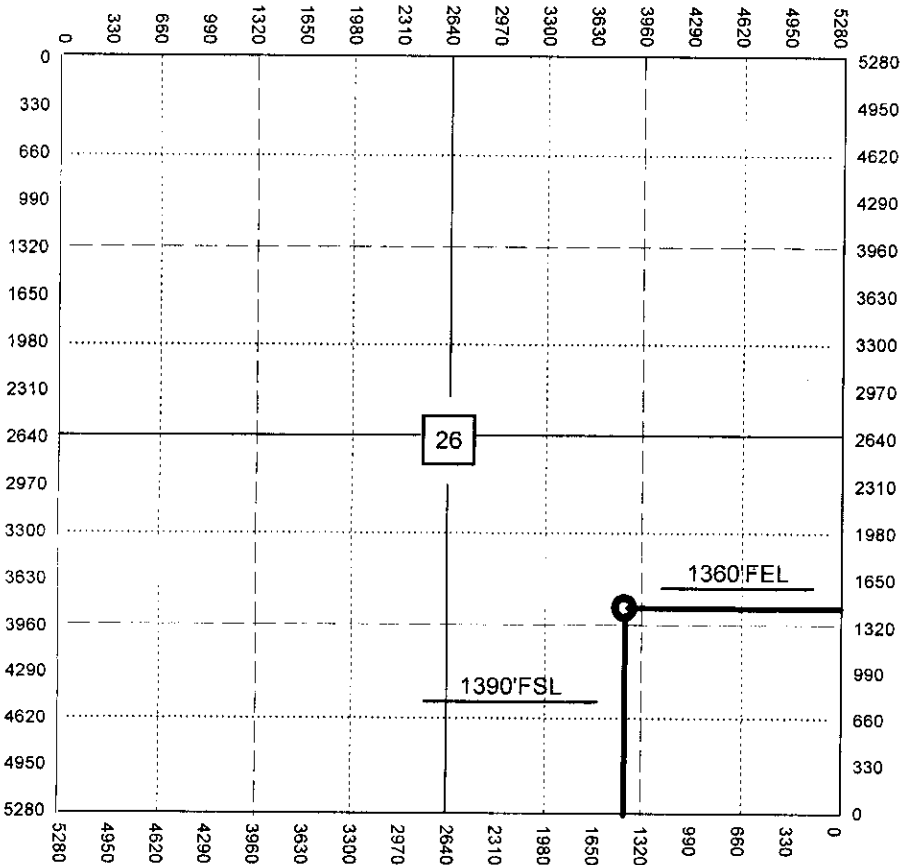

**NOTE: In all cases locate the spot of the proposed drilling location.**

**In plotting the proposed location of the well, you must show.**

1. The manner in which you are using the depicted plat by identifying section lines, i.e. 1 section, 1 section with 8 surrounding sections, 4 sections, etc.
2. The distance of the proposed drilling location from the south / north and east / west outside section lines.
3. The distance to the nearest lease or unit boundary line (in footage).
4. If proposed location is located within a prorated or spaced field a certificate of acreage attribution plat must be attached: (CO-7 for oil wells; CG-8 for gas wells).

MCCOY PETROLEUM CORPORATION  
FISHER LEASE  
SE. 1/4, SECTION 26, T5S, R37W  
CHEYENNE COUNTY, KANSAS

NO ROAD

Notes:

1. Set iron rod at location site.
2. All flagging Red & Yellow.
3. Overhead power available in Sec. 26.
4. Kansas One Call System Inc. should be notified before excavation (1-800-344-7233).
5. CAUTION: Various pipelines in Sec. 26.
6. Contact landowner for best access.
7. Location fell 20' NW. of a creek, set alternate per representative.

DIRT ROAD

ROAD

SCALE 1" = 1000'



NO ROAD

DIRT ROAD

FIELD ENTRANCE

(Revised)  
Drillsite Location  
Fisher "F" #1-26  
1650'FSL 1500'FEL  
Ground Elevation = 3244

\*Set iron rod at  
alternate 260' south &  
140' east of location  
1390'FSL 1360'FEL  
Ground Elevation = 3263

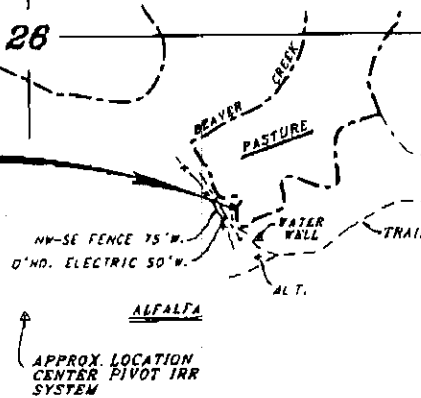

NO ROAD

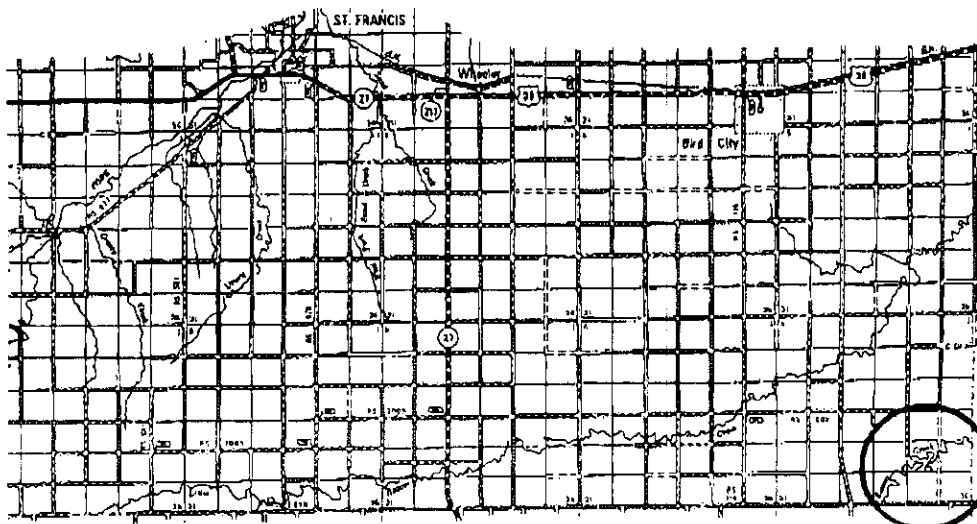

RECEIVED  
OCT 29 2009  
KCC WICHITA

• Controlling data is based upon the best maps and photographs available to us and upon a revised section of land containing 640 acres.  
 • Section/quarter section lines were determined using the normal standard of care of a field surveyor practicing in the state of Kansas; the section corners, which establish the precise section lines, were not necessarily located, and the exact location of the drillsite location in the section is not guaranteed. Therefore, the operator accepting this service and accepting this plat and all other services relying thereon agree to hold Central Kansas Oilfield Services, Inc., its officers and employees harmless from all results, costs and expenses and civil liabilities released from any liability from incidental or consequential damages.  
 • Elevations derived from National Geodetic Vertical Datum.

October 27, 2009

CENTRAL KANSAS OILFIELD SERVICES, INC. (620)792-1977

KANSAS CORPORATION COMMISSION  
OIL & GAS CONSERVATION DIVISION  
APPLICATION FOR SURFACE PIT

Form CDP-1  
April 2004  
Form must be Typed

CORRECTED COPY: 10/28/09

Submit in Duplicate

CORRECTED

Operator Name: <b>McCoy Petroleum Corporation</b>		License Number: <b>5003</b>
Operator Address: <b>8080 E. Central, Suite #300, Wichita, KS 67206-2366</b>		
Contact Person: <b>Scott Hampel</b>		Phone Number: <b>316-636-2737x104</b>
Lease Name & Well No.: <b>FISHER "F" #1-26</b>		Pit Location (QQQQ): <b>70°N &amp; 40°W of C SE</b>
Type of Pit: <input type="checkbox"/> Emergency Pit <input type="checkbox"/> Burn Pit <input type="checkbox"/> Settling Pit <input checked="" type="checkbox"/> Drilling Pit <input type="checkbox"/> Workover Pit <input type="checkbox"/> Haul-Off Pit <small>(If WP Supply API No. or Year Drilled)</small>	Pit is: <input checked="" type="checkbox"/> Proposed <input type="checkbox"/> Existing If Existing, date constructed: _____ Pit capacity: <b>3600</b> (bbls)	Sec <b>26</b> Twp <b>5</b> S Rng <b>37</b> <input type="checkbox"/> East <input checked="" type="checkbox"/> West <b>1390</b> Feet from <input type="checkbox"/> North / <input checked="" type="checkbox"/> South Line of Section <b>1360</b> Feet from <input checked="" type="checkbox"/> East / <input type="checkbox"/> West Line of Section <b>Cheyenne</b> County
Is the pit located in a Sensitive Ground Water Area? <input checked="" type="checkbox"/> Yes <input checked="" type="checkbox"/> No		Chloride concentration: _____ mg/l <small>(For Emergency Pits and Settling Pits only)</small>
Is the bottom below ground level? <input checked="" type="checkbox"/> Yes <input type="checkbox"/> No	Artificial Liner? <input type="checkbox"/> Yes <input checked="" type="checkbox"/> No	How is the pit lined if a plastic liner is not used? <b>Bentonite / Drilling Mud</b>
Pit dimensions (all but working pits): <b>80</b> Length (feet) <b>80</b> Width (feet) <b>N/A: Steel Pits</b> Depth from ground level to deepest point: <b>4</b> (feet)		
If the pit is lined give a brief description of the liner material, thickness and installation procedure.		Describe procedures for periodic maintenance and determining liner integrity, including any special monitoring.
Distance to nearest water well within one-mile of pit <b>NA 414</b> feet    Depth of water well <b>NA 134</b> feet		Depth to shallowest fresh water <b>NA 21</b> feet. Source of information: <input type="checkbox"/> measured <input type="checkbox"/> well owner <input type="checkbox"/> electric log <input type="checkbox"/> KDWR
<b>Emergency, Settling and Burn Pits ONLY:</b> Producing Formation: _____ Number of producing wells on lease: _____ Barrels of fluid produced daily: _____ Does the slope from the tank battery allow all spilled fluids to flow into the pit? <input type="checkbox"/> Yes <input type="checkbox"/> No		<b>Drilling, Workover and Haul-Off Pits ONLY:</b> Type of material utilized in drilling/workover: <b>Bentonite</b> Number of working pits to be utilized: <b>3</b> Abandonment procedure: <b>Allow evaporation and backfill when dry.</b> Drill pits must be closed within 365 days of spud date.
I hereby certify that the above statements are true and correct to the best of my knowledge and belief.		
Date: <b>10/1/09</b> Signature of Applicant or Agent: <i>Scott Hampel</i> <b>Scott Hampel</b>		<b>KCC WICHITA</b> <b>RECEIVED</b> <b>OCT 29 2009</b>

KCC OFFICE USE ONLY		
Date Received: <b>10/29/09</b>	Permit Number: _____	Permit Date: <b>10/29/09</b> Lease Inspection: <input type="checkbox"/> Yes <input checked="" type="checkbox"/> No

Mail to: KCC - Conservation Division, 130 S. Market - Room 2078, Wichita, Kansas 67202