

For KCC Use: 11-9-2009
 Effective Date: 11-9-2009
 District # 2
 SGA? Yes No

KANSAS CORPORATION COMMISSION
 OIL & GAS CONSERVATION DIVISION

Form C-1
 October 2007
 Form must be Typed
 Form must be Signed
 All blanks must be Filled

NOTICE OF INTENT TO DRILL

Must be approved by KCC five (5) days prior to commencing well

Expected Spud Date: November 9th 2009
month day year

OPERATOR: License# 32924 ✓
 Name: Gilbert-Stewart Operating LLC
 Address 1: Suite 450
 Address 2: 1801 Broadway
 City: Denver State: CO Zip: 80202 +
 Contact Person: Kent Gilbert
 Phone: 303-534-1686
 CONTRACTOR: License# 33350 ✓
 Name: Southwind Drilling

Well Drilled For: Oil Gas Enh Rec Storage Disposal Seismic; # of Holes Other:
 Well Class: Infield Pool Ext. ~~Wildcat~~ Other
 Type Equipment: Mud Rotary Air Rotary Cable

If OWWO: old well information as follows:
 Operator: _____
 Well Name: _____
 Original Completion Date: _____ Original Total Depth: _____

Directional, Deviated or Horizontal wellbore? Yes No
 If Yes, true vertical depth: _____
 Bottom Hole Location: _____
 KCC DKT #: _____

Spot Description: _____
 SW - SW - SE - Sec. 6 Twp. 19 S. R. 9 E W
 (0.000) 330 feet from N / S Line of Section
2,310 feet from E / W Line of Section

Is SECTION: Regular Irregular?
 (Note: Locate well on the Section Plat on reverse side)

County: Rice
 Lease Name: Lincoln Well #: 2
 Field Name: Chase Silica

Is this a Prorated / Spaced Field? Yes No

Target Formation(s): Arbuckle
 Nearest Lease or unit boundary line (in footage): 330'

Ground Surface Elevation: 1710' feet MSL

Water well within one-quarter mile: Yes No

Public water supply well within one mile: Yes No

Depth to bottom of fresh water: 150'

Depth to bottom of usable water: 240'

Surface Pipe by Alternate: I II

Length of Surface Pipe Planned to be set: 260-300'

Length of Conductor Pipe (if any): N/A

Projected Total Depth: 3400'

Formation at Total Depth: Arbuckle

Water Source for Drilling Operations: Well Farm Pond Other:

DWR Permit #: _____

(Note: Apply for Permit with DWR)

Will Cores be taken? Yes No

If Yes, proposed zone: _____

AFFIDAVIT

The undersigned hereby affirms that the drilling, completion and eventual plugging of this well will comply with K.S.A. 55 et. seq.
 It is agreed that the following minimum requirements will be met:

1. Notify the appropriate district office **prior** to spudding of well;
2. A copy of the approved notice of intent to drill **shall be** posted on each drilling rig;
3. The minimum amount of surface pipe as specified below **shall be set** by circulating cement to the top; in all cases surface pipe **shall be set** through all unconsolidated materials plus a minimum of 20 feet into the underlying formation.
4. If the well is dry hole, an agreement between the operator and the district office on plug length and placement is necessary **prior to plugging**;
5. The appropriate district office will be notified before well is either plugged or production casing is cemented in;
6. If an ALTERNATE II COMPLETION, production pipe shall be cemented from below any usable water to surface within **120 DAYS** of spud date. Or pursuant to Appendix "B" - Eastern Kansas surface casing order #133,891-C, which applies to the KCC District 3 area, alternate II cementing must be completed within 30 days of the spud date or the well shall be plugged. **In all cases, NOTIFY district office** prior to any cementing.

I hereby certify that the statements made herein are true and correct to the best of my knowledge and belief.

Date: 10/27/09 Signature of Operator or Agent: Kent Gilbert Title: Manager

RECEIVED

OCT 28 2009

KCC WICHITA

For KCC Use ONLY
 API # 15 - 159-22600-00-00
 Conductor pipe required None feet
 Minimum surface pipe required 260 feet per ALT. I II
 Approved by: Sum 11-4-2009
 This authorization expires: 11-4-2010
 (This authorization void if drilling not started within 12 months of approval date.)
 Spud date: _____ Agent: _____

Remember to:

- File Drill Pit Application (form CDP-1) with Intent to Drill;
- File Completion Form ACO-1 within 120 days of spud date;
- File acreage attribution plat according to field proration orders;
- Notify appropriate district office 48 hours prior to workover or re-entry;
- Submit plugging report (CP-4) after plugging is completed (within 60 days);
- Obtain written approval before disposing or injecting salt water.
- If this permit has expired (See: authorized expiration date) please check the box below and return to the address below.

Well Not Drilled - Permit Expired Date: _____
 Signature of Operator or Agent: _____

6
19
9
 E
 W

IN ALL CASES PLOT THE INTENDED WELL ON THE PLAT BELOW

Plat of acreage attributable to a well in a prorated or spaced field

If the intended well is in a prorated or spaced field, please fully complete this side of the form. If the intended well is in a prorated or spaced field complete the plat below showing that the well will be properly located in relationship to other wells producing from the common source of supply. Please show all the wells and within 1 mile of the boundaries of the proposed acreage attribution unit for gas wells and within 1/2 mile of the boundaries of the proposed acreage attribution unit for oil wells.

API No. 15 - 159-22600-00-00
 Operator: Gilbert-Stewart Operating LLC
 Lease: Lincoln
 Well Number: 2
 Field: Chase Silica

Location of Well: County: Rice
 330 feet from N / S Line of Section
 2,310 feet from E / W Line of Section
 Sec. 6 Twp. 19 S. R. 9 E W

Number of Acres attributable to well: _____
 QTR/QTR/QTR/QTR of acreage: SW - SW - SE - _____

Is Section: Regular or Irregular

If Section is Irregular, locate well from nearest corner boundary.

Section corner used: NE NW SE SW

PLAT

(Show location of the well and shade attributable acreage for prorated or spaced wells.)

(Show footage to the nearest lease or unit boundary line.)

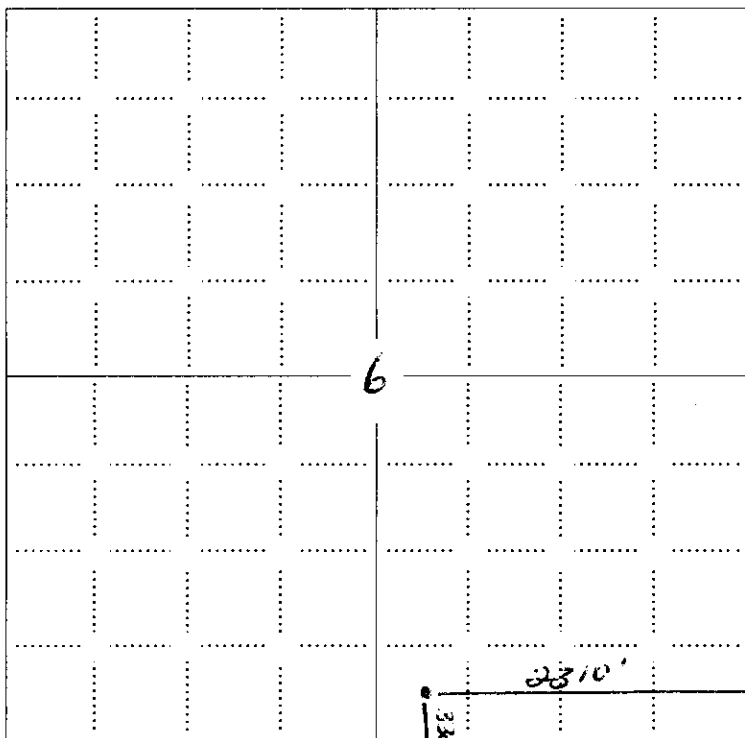

NOTE: In all cases locate the spot of the proposed drilling locaton.

RECEIVED
 OCT 28 2009
 KCC WICHITA

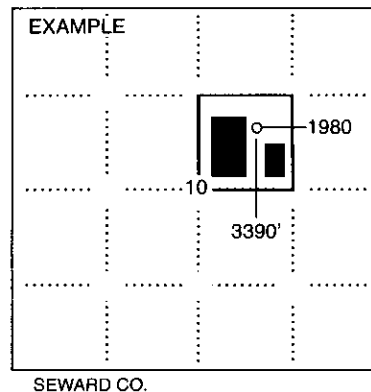

SEWARD CO.

In plotting the proposed location of the well, you must show:

1. The manner in which you are using the depicted plat by identifying section lines, i.e. 1 section, 1 section with 8 surrounding sections, 4 sections, etc.
2. The distance of the proposed drilling location from the south / north and east / west outside section lines.
3. The distance to the nearest lease or unit boundary line (in footage).
4. If proposed location is located within a prorated or spaced field a certificate of acreage attribution plat must be attached: (CO-7 for oil wells; CG-8 for gas wells).

**KANSAS CORPORATION COMMISSION
OIL & GAS CONSERVATION DIVISION
APPLICATION FOR SURFACE PIT**

Form CDP-1
April 2004
Form must be Typed

Submit in Duplicate

Operator Name: Gilbert-Stewart Operating LLC		License Number: 32924	
Operator Address: Suite 450		1801 Broadway Denver CO 80202	
Contact Person: Kent Gilbert		Phone Number: 303-534-1686	
Lease Name & Well No.: Lincoln 2		Pit Location (QQQQ): SW SW SE	
Type of Pit: <input type="checkbox"/> Emergency Pit <input type="checkbox"/> Burn Pit <input type="checkbox"/> Settling Pit <input checked="" type="checkbox"/> Drilling Pit <input type="checkbox"/> Workover Pit <input type="checkbox"/> Haul-Off Pit <i>(If WP Supply API No. or Year Drilled)</i>		Pit is: <input checked="" type="checkbox"/> Proposed <input type="checkbox"/> Existing If Existing, date constructed: _____ Pit capacity: _____ (bbls)	
Is the pit located in a Sensitive Ground Water Area? <input type="checkbox"/> Yes <input checked="" type="checkbox"/> No		Chloride concentration: _____ mg/l <i>(For Emergency Pits and Settling Pits only)</i>	
Is the bottom below ground level? <input checked="" type="checkbox"/> Yes <input type="checkbox"/> No		Artificial Liner? <input type="checkbox"/> Yes <input checked="" type="checkbox"/> No	
How is the pit lined if a plastic liner is not used? Bentonite from the drilling mud will coat the sides and bottom of the pit		How is the pit lined if a plastic liner is not used? Bentonite from the drilling mud will coat the sides and bottom of the pit	
Pit dimensions (all but working pits): <u>80</u> Length (feet) <u>80</u> Width (feet) <input type="checkbox"/> N/A: Steel Pits Depth from ground level to deepest point: <u>4</u> (feet) <input type="checkbox"/> No Pit			
If the pit is lined give a brief description of the liner material, thickness and installation procedure. Bentonite from the drilling mud will coat the sides and bottom of the pit.		Describe procedures for periodic maintenance and determining liner integrity, including any special monitoring. Bentonite from the drilling mud will stay in place until the pit is squeezed and closed.	
Distance to nearest water well within one-mile of pit <u>441</u> feet Depth of water well <u>120</u> feet		Depth to shallowest fresh water <u>20</u> feet. Source of information: <input type="checkbox"/> measured <input type="checkbox"/> well owner <input type="checkbox"/> electric log <input checked="" type="checkbox"/> KDWR	
Emergency, Settling and Burn Pits ONLY: Producing Formation: _____ Number of producing wells on lease: _____ Barrels of fluid produced daily: _____ Does the slope from the tank battery allow all spilled fluids to flow into the pit? <input type="checkbox"/> Yes <input type="checkbox"/> No		Drilling, Workover and Haul-Off Pits ONLY: Type of material utilized in drilling/workover: <u>Fresh Water/Bentonite</u> Number of working pits to be utilized: <u>3</u> Abandonment procedure: <u>Haul off fluids after the salts. Allow the pit to dry. Squeeze and backfill.</u> Drill pits must be closed within 365 days of spud date.	
I hereby certify that the above statements are true and correct to the best of my knowledge and belief. _____ 10-27-09 Date		_____ Signature of Applicant or Agent <div style="text-align: right;"> RECEIVED OCT 28 2009 KCC WICHITA </div>	
KCC OFFICE USE ONLY			
Date Received: <u>10/28/09</u>		Permit Number: _____	
Permit Date: <u>11/3/09</u>		Lease Inspection: <input checked="" type="checkbox"/> Yes <input type="checkbox"/> No	

15-159-22600-00-00



Mark Parkinson, Governor
Thomas E. Wright, Chairman
Michael C. Moffet, Commissioner
Joseph F. Harkins, Commissioner

November 3, 2009

Gilbert-Stewart Operating LLC
1801 Broadway Ste 450
Denver, CO 80202

Re: Drilling Pit Application
Lincoln Lease Well No. 2
SE/4 Sec. 06-19S-09W
Rice County, Kansas

Dear Sir or Madam:

District staff has inspected the above referenced location and has determined that the reserve pit shall be constructed **without slots**, the bottom shall be flat and reasonably level, and the free fluids must be removed. The fluids are to be removed from the reserve pit as soon as the Hutchinson Salt section has been drilled through and displacement of the fluids into the reserve pit has occurred. The fluids should be removed again within 72 hours after drilling operations have ceased.

If production casing is set all completion fluids shall be removed from the working pits daily. NO completion fluids or non-exempt wastes shall be placed in the reserve pit.

The fluids should be taken to an authorized disposal well. Please call the District Office at (316) 630-4000 when the fluids have been removed. Please file form CDP-5 (August 2004), Exploration and Production Waste Transfer, within 30 days of fluid removal. Conservation division forms are available through our office and on the KCC web site:
www.kcc.state.ks.us/conservation/forms.

A copy of this letter should be posted in the doghouse along with the approved Intent to Drill. If you have any questions or concerns please feel free to contact the undersigned at the above address.

Sincerely,

A handwritten signature in black ink that reads "Kathy Haynes".

Kathy Haynes
Environmental Protection and Remediation Department

cc: File