

For KCC Use: 11-10-2009
 Effective Date: _____
 District # _____
 SGA? Yes No

KANSAS CORPORATION COMMISSION
 OIL & GAS CONSERVATION DIVISION

Form C-1
 October 2007
 Form must be Typed
 Form must be Signed
 All blanks must be Filled

NOTICE OF INTENT TO DRILL

Must be approved by KCC five (5) days prior to commencing well

Expected Spud Date: November 11 2009
 month day year

OPERATOR: License# 31093
 Name: _____
 Address 1: Becker Oil Corporation
 Address 2: PO BOX 1150
 City: Ponca City State: OK Zip: 74602 + 1150
 Contact Person: Clyde M. Becker, Jr.
 Phone: 303-816-2013

CONTRACTOR: License# 4958
 Name: Mallard JV, Inc.

Well Drilled For: Oil Gas Seismic; # of Holes _____ Other: _____
 Well Class: Enh Rec Storage Disposal Infield Pool Ext. Wildcat Other _____
 Type Equipment: Mud Rotary Air Rotary Cable

If OWWO: old well information as follows:
 Operator: _____
 Well Name: _____
 Original Completion Date: _____ Original Total Depth: _____

Directional, Deviated or Horizontal wellbore? Yes No
 If Yes, true vertical depth: _____
 Bottom Hole Location: _____
 KCC DKT #: _____

Spot Description: _____
 S/2 S/2 SE NW Sec. 25 Twp. 23 S. R. 24 E W
 (or/ova) 2,518 feet from N / S Line of Section
 2,033 feet from E / W Line of Section

Is SECTION: Regular Irregular?
 (Note: Locate well on the Section Plat on reverse side)
 County: Hodgeman

Lease Name: Schauviège Well #: 3
 Field Name: Dep

Is this a Prorated / Spaced Field? Yes No
 Target Formation(s): Cherokee-Morrow Sd.

Nearest Lease or unit boundary line (in footage): 607
 Ground Surface Elevation: 2374 feet MSL

Water well within one-quarter mile: Yes No
 Public water supply well within one mile: Yes No

Depth to bottom of fresh water: 300 180
 Depth to bottom of usable water: 700

Surface Pipe by Alternate: I II
 Length of Surface Pipe Planned to be set: 315'

Length of Conductor Pipe (if any): _____
 Projected Total Depth: 4770

Formation at Total Depth: Mississippian
 Water Source for Drilling Operations:

Well Farm Pond Other: creek
 DWR Permit #: pending

(Note: Apply for Permit with DWR)
 Will Cores be taken? Yes No

If Yes, proposed zone: _____

Oil & Gas Lease submitted (w/2 Sec. 25)

AFFIDAVIT

The undersigned hereby affirms that the drilling, completion and eventual plugging of this well will comply with K.S.A. 55 et. seq.
 It is agreed that the following minimum requirements will be met:

1. Notify the appropriate district office **prior** to spudding of well;
2. A copy of the approved notice of intent to drill **shall be** posted on each drilling rig;
3. The minimum amount of surface pipe as specified below **shall be set** by circulating cement to the top; in all cases surface pipe **shall be set** through all unconsolidated materials plus a minimum of 20 feet into the underlying formation.
4. If the well is dry hole, an agreement between the operator and the district office on plug length and placement is necessary **prior to plugging**;
5. The appropriate district office will be notified before well is either plugged or production casing is cemented in;
6. If an ALTERNATE II COMPLETION, production pipe shall be cemented from below any usable water to surface within **120 DAYS** of spud date.
 Or pursuant to Appendix "B" - Eastern Kansas surface casing order #133,891-C, which applies to the KCC District 3 area, alternate II cementing must be completed within 30 days of the spud date or the well shall be plugged. **In all cases, NOTIFY district office** prior to any cementing.

I hereby certify that the statements made herein are true and correct to the best of my knowledge and belief.

Date: 10/30/09 Signature of Operator or Agent: Clyde M. Becker Jr Title: President

For KCC Use ONLY
 API # 15 - 083-21616-00-00
 Conductor pipe required None feet
 Minimum surface pipe required 200 feet per ALT. I II
 Approved by KMA 11-5-2009
 This authorization expires: 11-5-2010
 (This authorization void if drilling not started within 12 months of approval date.)
 Spud date: _____ Agent: _____

Remember to:

- File Drill Pit Application (form CDP-1) with Intent to Drill;
- File Completion Form ACO-1 within 120 days of spud date;
- File acreage attribution plat according to field proration orders;
- Notify appropriate district office 48 hours prior to workover or re-entry;
- Submit plugging report (CP-4) after plugging is completed (within 60 days);
- Obtain written approval before disposing or injecting salt water.
- If this permit has expired (See: authorized expiration date) please check the box below and return to the address below.

Well Not Drilled - Permit Expired Date: _____
 Signature of Operator or Agent: _____

25
23
24
 E
 W

RECEIVED
 NOV 2 2009
 KCC WICHITA

IN ALL CASES PLOT THE INTENDED WELL ON THE PLAT BELOW

Plat of acreage attributable to a well in a prorated or spaced field

If the intended well is in a prorated or spaced field, please fully complete this side of the form. If the intended well is in a prorated or spaced field complete the plat below showing that the well will be properly located in relationship to other wells producing from the common source of supply. Please show all the wells and within 1 mile of the boundaries of the proposed acreage attribution unit for gas wells and within 1/2 mile of the boundaries of the proposed acreage attribution unit for oil wells.

API No. 15 - 083-21616-00-00
 Operator: _____
 Lease: Schauvlege
 Well Number: 3
 Field: Don

Location of Well: County: Hodgeman
 2,518 feet from N / S Line of Section
 2,033 feet from E / W Line of Section
 Sec. 25 Twp. 23 S. R. 24 E W

Number of Acres attributable to well: _____
 QTR/QTR/QTR/QTR of acreage: S/2 - S/2 - SE - NW

Is Section: Regular or Irregular

If Section is Irregular, locate well from nearest corner boundary.
 Section corner used: NE NW SE SW

PLAT

*(Show location of the well and shade attributable acreage for prorated or spaced wells.)
 (Show footage to the nearest lease or unit boundary line.)*

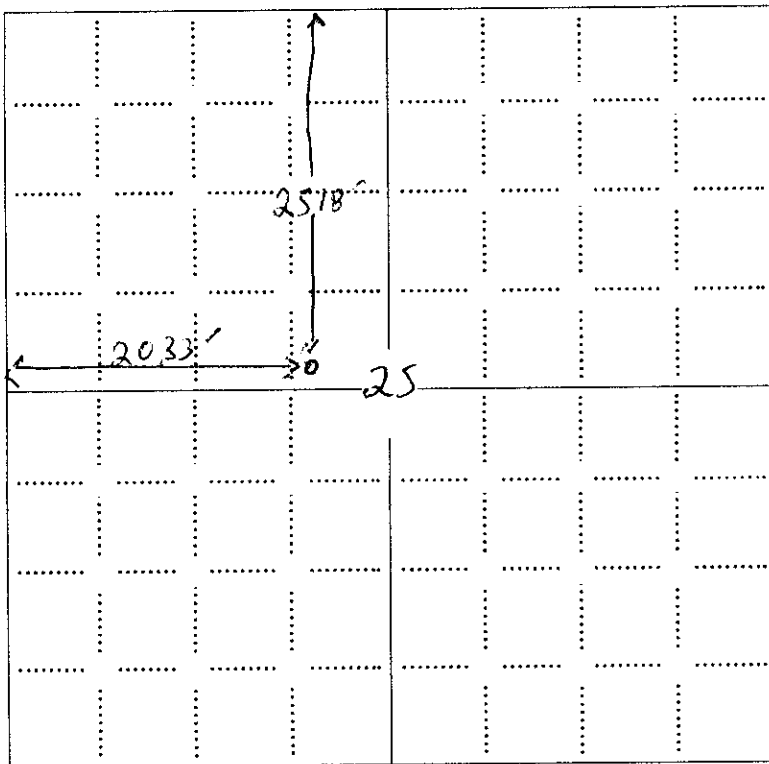

RECEIVED
 NOV 02 2009
 KCC WICHITA

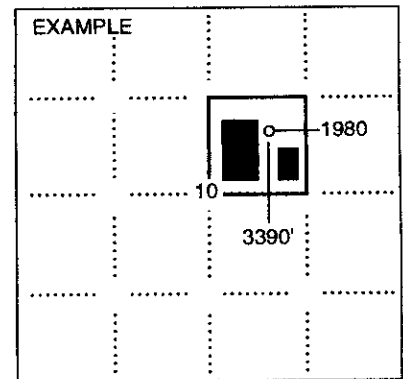

SEWARD CO.

NOTE: In all cases locate the spot of the proposed drilling location.

In plotting the proposed location of the well, you must show:

1. The manner in which you are using the depicted plat by identifying section lines, i.e. 1 section, 1 section with 8 surrounding sections, 4 sections, etc.
2. The distance of the proposed drilling location from the south / north and east / west outside section lines.
3. The distance to the nearest lease or unit boundary line (in footage).
4. If proposed location is located within a prorated or spaced field a certificate of acreage attribution plat must be attached (CO-7 for oil wells)

**KANSAS CORPORATION COMMISSION
OIL & GAS CONSERVATION DIVISION
APPLICATION FOR SURFACE PIT**

Form GDP-1
April 2004
Form must be Typed

Submit in Duplicate

Operator Name:		License Number: 31093	
Operator Address: Becker Oil Corporation		Ponca City OK 74602	
Contact Person: Clyde M. Becker, Jr.		Phone Number: 303-816-2013	
Lease Name & Well No.: Schauvliege 3		Pit Location (QQQQ): S/2 - S/2 - SE - NW	
Type of Pit: <input type="checkbox"/> Emergency Pit <input type="checkbox"/> Burn Pit <input type="checkbox"/> Settling Pit <input checked="" type="checkbox"/> Drilling Pit <input type="checkbox"/> Workover Pit <input type="checkbox"/> Haul-Off Pit <i>(If WP Supply API No. or Year Drilled)</i>		Pit is: <input checked="" type="checkbox"/> Proposed <input type="checkbox"/> Existing If Existing, date constructed: _____ Pit capacity: 1,800 (bbls)	
Is the pit located in a Sensitive Ground Water Area? <input type="checkbox"/> Yes <input checked="" type="checkbox"/> No		Sec. 25 Twp. 23 R. 24 <input type="checkbox"/> East <input checked="" type="checkbox"/> West 2,518 Feet from <input checked="" type="checkbox"/> North / <input type="checkbox"/> South Line of Section 2,033 Feet from <input type="checkbox"/> East / <input checked="" type="checkbox"/> West Line of Section Hodgeman County	
Is the bottom below ground level? <input checked="" type="checkbox"/> Yes <input type="checkbox"/> No		Chloride concentration: _____ mg/l <i>(For Emergency Pits and Settling Pits only)</i>	
Artificial Liner? <input checked="" type="checkbox"/> Yes <input type="checkbox"/> No		How is the pit lined if a plastic liner is not used?	
Pit dimensions (all but working pits): 60 Length (feet) 60 Width (feet) <input type="checkbox"/> N/A: Steel Pits Depth from ground level to deepest point: 3 (feet) <input type="checkbox"/> No Pit			
If the pit is lined give a brief description of the liner material, thickness and installation procedure. Plastic		Describe procedures for periodic maintenance and determining liner integrity, including any special monitoring. RECEIVED NOV 02 2009 KCC WICHITA	
Distance to nearest water well within one-mile of pit 960 feet Depth of water well 60 feet		Depth to shallowest fresh water 20 feet. Source of information: <input type="checkbox"/> measured <input type="checkbox"/> well owner <input type="checkbox"/> electric log <input checked="" type="checkbox"/> KDWR	
Emergency, Settling and Burn Pits ONLY: Producing Formation: _____ Number of producing wells on lease: _____ Barrels of fluid produced daily: _____ Does the slope from the tank battery allow all spilled fluids to flow into the pit? <input type="checkbox"/> Yes <input type="checkbox"/> No		Drilling, Workover and Haul-Off Pits ONLY: Type of material utilized in drilling/workover: <u>Chem mud</u> Number of working pits to be utilized: <u>1</u> Abandonment procedure: <u>allow to evaporate, backfill, replace top soil</u> Drill pits must be closed within 365 days of spud date.	
I hereby certify that the above statements are true and correct to the best of my knowledge and belief.			
10/30/09 Date		 Signature of Applicant or Agent	

KCC OFFICE USE ONLY

Steel Pit RFAC RFAS

Date Received: 11/2/09 Permit Number: _____ Permit Date: 11/4/09 Lease Inspection: Yes No

15-083-21016-00-00