

For KCC Use: 11-17-2009  
 Effective Date: 4  
 District # \_\_\_\_\_  
 SGA?  Yes  No

KANSAS CORPORATION COMMISSION  
 OIL & GAS CONSERVATION DIVISION  
**NOTICE OF INTENT TO DRILL**

Form C-1  
 December 2002  
**Form must be Typed**  
**Form must be Signed**  
**All blanks must be Filled**

Must be approved by KCC five (5) days prior to commencing well

Expected Spud Date 2 11 17 2009  
month day year

OPERATOR: License# 3553  
 Name: Citation Oil & Gas Corp.  
 Address: P O Box 690688  
Houston, TX 77269  
 City/State/Zip:  
 Contact Person: Bridget Lisenbe / Hakim Benhamou  
 Phone: (281) 891-1565 / (281) 891-1486

CONTRACTOR: License# Must be licensed by KCC  
 Name: Advise on ACO-1

<input checked="" type="checkbox"/> Oil	<input type="checkbox"/> Enh Rec	<input checked="" type="checkbox"/> Infield	<input checked="" type="checkbox"/> Mud Rotary
<input type="checkbox"/> Gas	<input type="checkbox"/> Storage	<input type="checkbox"/> Pool Ext.	<input type="checkbox"/> Air Rotary
<input type="checkbox"/> OWWO	<input type="checkbox"/> Disposal	<input type="checkbox"/> Wildcat	<input type="checkbox"/> Cable
<input type="checkbox"/> Seismic; _____ # of Holes	<input type="checkbox"/> Other		
<input type="checkbox"/> Other			

If OWWO: old well information as follows:  
 Operator: \_\_\_\_\_  
 Well Name: \_\_\_\_\_  
 Original Completion Date: \_\_\_\_\_ Original Total Depth: \_\_\_\_\_

Directional, Deviated or Horizontal wellbore?  Yes  No

If Yes, true vertical depth: \_\_\_\_\_

Bottom Hole Location: \_\_\_\_\_

KCC DKT #: \_\_\_\_\_

Spot SE SW - SE Sec. 1 Twp. 13 S. R. 16  
 East  West  
330 feet from  N /  S Line of Section  
1650 feet from  E /  W Line of Section  
 Is SECTION  Regular  Irregular?

(Note: Locate well on the Section Plat on reverse side)

County: Ellis  
 Lease Name: Wieland Well #: 6-17

Field Name: Fairport

Is this a Prorated / Spaced Field?  Yes  No

Target Formation(s): Topeka and LKC

Nearest Lease or unit boundary: 330

Ground Surface Elevation: 1949 feet MSL

Water well within one-quarter mile:  Yes  No

Public water supply well within one mile:  Yes  No

Depth to bottom of fresh water: 180'

Depth to bottom of usable water: 540'

Surface Pipe by Alternate:  1  2

Length of Surface Pipe Planned to be set: 1000

Length of Conductor Pipe required: None

Projected Total Depth: 3590

Formation at Total Depth: Arbuckle

Water Source for Drilling Operations:

Well  Farm Pond  Other

DWR Permit #: \_\_\_\_\_

(Note: Apply for Permit with DWR )

Will Cores be taken?  Yes  No

If Yes, proposed zone: \_\_\_\_\_

**AFFIDAVIT**

The undersigned hereby affirms that the drilling, completion and eventual plugging of this well will comply with K.S.A. 55 et. seq.

It is agreed that the following minimum requirements will be met:

1. Notify the appropriate district office **prior** to spudding of well;
2. A copy of the approved notice of intent to drill **shall be** posted on each drilling rig;
3. The minimum amount of surface pipe as specified below **shall be set** by circulating cement to the top; in all cases surface pipe shall be set through all unconsolidated materials plus a minimum of 20 feet into the underlying formation.
4. If the well is dry hole, an agreement between the operator and the district office on plug length and placement is necessary **prior to plugging**;
5. The appropriate district office will be notified before well is either plugged or production casing is cemented in;
6. If an ALTERNATE II COMPLETION, production pipe shall be cemented from below any usable water to surface within **120 days** of spud date. Or pursuant to Appendix "B" - Eastern Kansas surface casing order #133,891-C, which applies to the KCC District 3 area, alternate II cementing must be completed within 30 days of the spud date or the well shall be plugged. **In all cases, NOTIFY district office** prior to any cementing.

I hereby certify that the statements made herein are true and to the best of my knowledge and belief.

Date: 11/10/2009 Signature of Operator or Agent: Bridget Lisenbe Title: Permitting Analyst

**For KCC Use ONLY**  
 API # 15 - 051-25936-00-00  
 Conductor pipe required None feet  
 Minimum surface pipe required 560 feet per AL. 1 **OK**  
 Approved by: [Signature] 11-12-2009  
 This authorization expires: 11-12-2010  
 (This authorization void if drilling not started within 12 months of approval date.)  
 Spud date: \_\_\_\_\_ Agent: 12

**Remember to:**

- File Drill Pit Application (form CDP-1) with Intent to Drill;
- File Completion Form ACO-1 within 120 days of spud date;
- File acreage attribution plat according to field proration orders;
- Notify appropriate district office 48 hours prior to workover or re-entry;
- Submit plugging report (CP-4) after plugging is completed;
- Obtain written approval before disposing or injecting salt water.
- If this permit has expired (See: authorized expiration date) please check the box below and return to the address below.

Well Not Drilled - Permit Expired

Signature of Operator or Agent: \_\_\_\_\_

Date: \_\_\_\_\_

Mail to: KCC - Conservation Division, 130 S. Market - Room 2078, Wichita, Kansas 67202

RECEIVED

NOV 12 2009

KCC WICHITA

1 - 13 - 16W

**IN ALL CASES PLOT THE INTENDED WELL ON THE PLAT BELOW**

*Plat of acreage attributable to a well in a prorated or spaced field*

**If the intended well is in a prorated or spaced field, please fully complete this side of the form.** If the intended well is in a prorated or spaced field complete the plat below showing that the well will be properly located in relationship to other wells producing from the common source of supply. Please show all the wells and within 1 mile of the boundaries of the proposed acreage attribution unit for gas wells and within 1/2 mile of the boundaries of the proposed acreage attribution unit for oil wells.

API No. 15 - 051-25936-0000  
 Operator: Citation Oil & Gas Corp.  
 Lease: Wieland  
 Well Number: 6-17  
 Field: Fairport  
 Number of Acres attributable to well: \_\_\_\_\_  
 QTR / QTR / QTR of acreage: \_\_\_\_\_ - \_\_\_\_\_ - \_\_\_\_\_ SE

Location of Well: County: Ellis  
 330 \_\_\_\_\_ feet from  N /  S Line of Section  
 1650 \_\_\_\_\_ feet from  E /  W Line of Section  
 Sec. 1 Twp. 13 S. R. 16  East  West

Is Section:  Regular or  Irregular

**If Section is Irregular, locate well from nearest corner boundary.**

Section corner used:  NE  NW  SE  SW

**PLAT**

*(Show location of the well and shade attributable acreage for prorated or spaced wells.)*

*(Show footage to the nearest lease or unit boundary line.)*

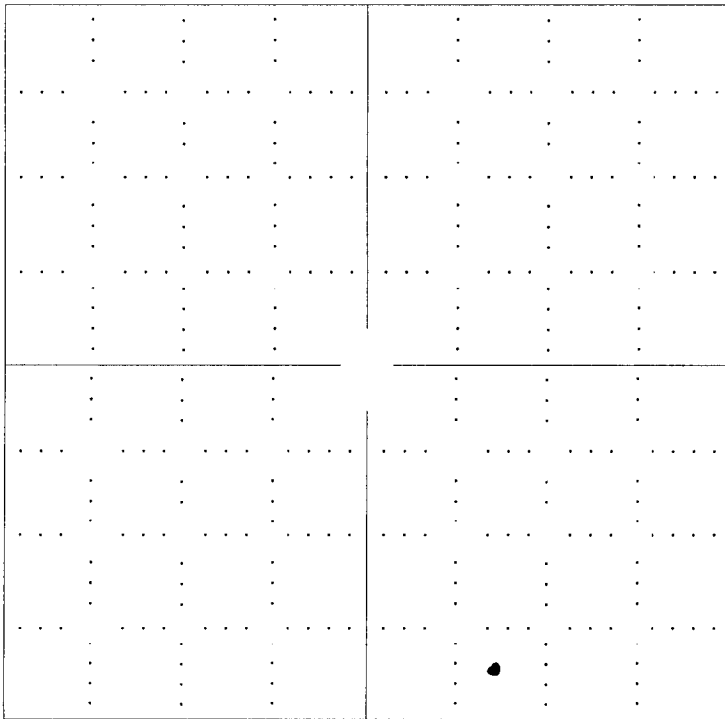

RECEIVED  
 NOV 12 2009  
 KCC WICHITA

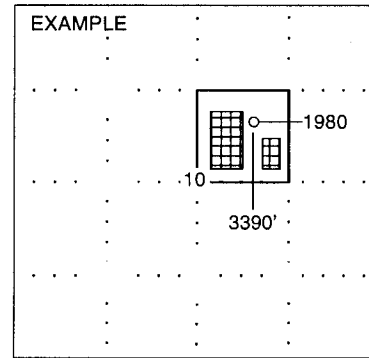

**NOTE: In all cases locate the spot of the proposed drilling locaton.**

**In plotting the proposed location of the well, you must show:**

1. The manner in which you are using the depicted plat by identifying section lines, i.e. 1 section, 1 section with 8 surrounding sections, 4 sections, etc.
2. The distance of the proposed drilling location from the section's south / north and east / west.
3. The distance to the nearest lease or unit boundary line.
4. If proposed location is located within a prorated or spaced field a certificate of acreage attribution plat must be attached: (CO-7 for oil wells; CG-8 for gas wells).

CITATION OIL & GAS CORPORATION  
 WIELAND UNIT LEASE  
 SE. 1/4, SECTION 1, T13S, R16W  
 ELLIS COUNTY, KANSAS

15051-25936-0000 RECEIVED

NOV 12 2009

KGC WICHITA

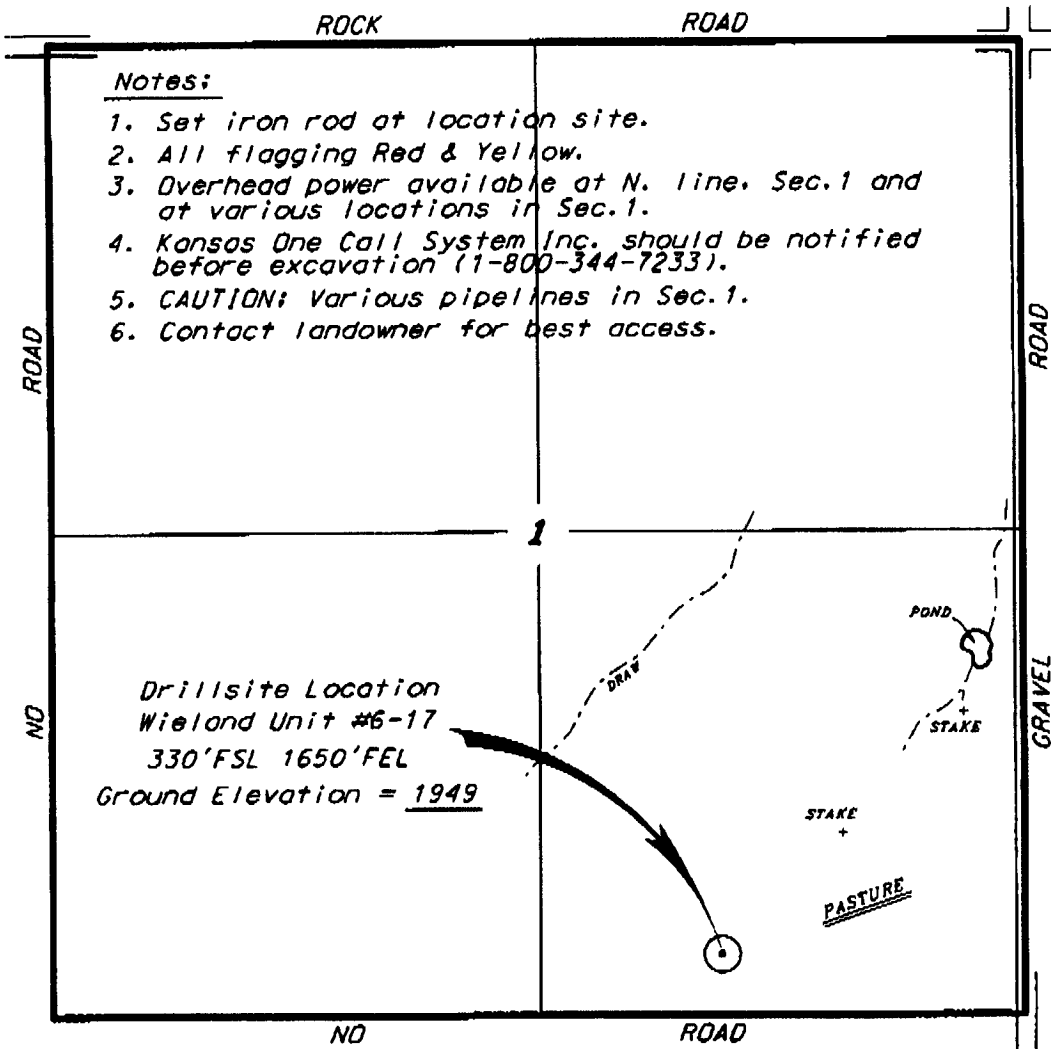

Notes:

1. Set iron rod at location site.
2. All flagging Red & Yellow.
3. Overhead power available at N. line, Sec.1 and at various locations in Sec.1.
4. Kansas One Call System Inc. should be notified before excavation (1-800-344-7233).
5. CAUTION: Various pipelines in Sec.1.
6. Contact landowner for best access.

\*Ingress and egress to location as shown on this plot is per usage only and may not be legally opened for public use. Contact landowner, tenant and county road department for access.

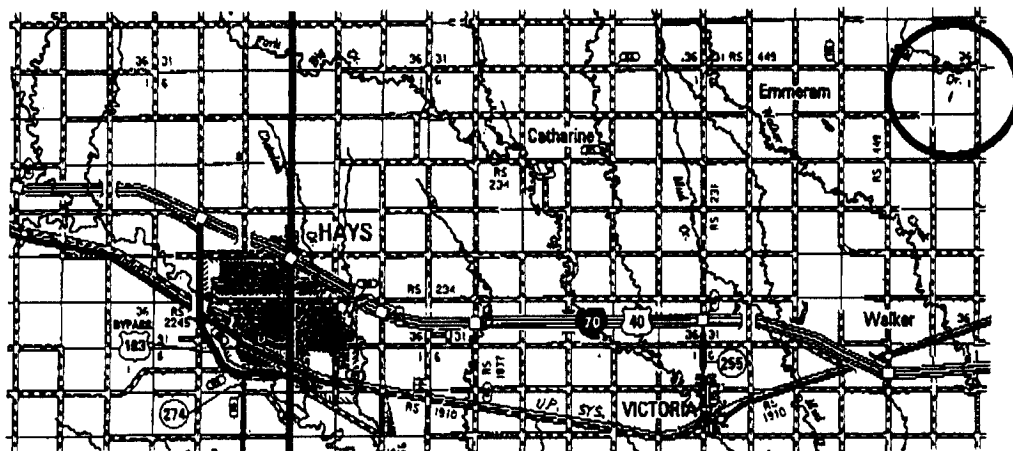
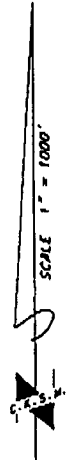

• Controlling data is based upon the best maps and photographs available to us and upon a regular section of land containing 540 acres.  
 • Approximate section lines were determined using the normal standards of care of oilfield surveyors practicing in the state of Kansas. The section corners, which establish the precise section lines, were not necessarily located, and the exact location of the drillsite location in the section is not guaranteed. Therefore, the operator securing this service and accepting this plot and all other parties relying thereon agree to hold Central Kansas Oilfield Services, Inc., its officers and employees harmless from all losses, costs and expenses and to hold parties released from any liability from incidental or consequential damages.  
 • Elevations derived from National Geodetic Vertical Datum.

Date September 18, 2009

**CENTRAL KANSAS OILFIELD SERVICES, INC. (620)792-1977**

RECEIVED

NOV 12 2009

KCC WICHITA

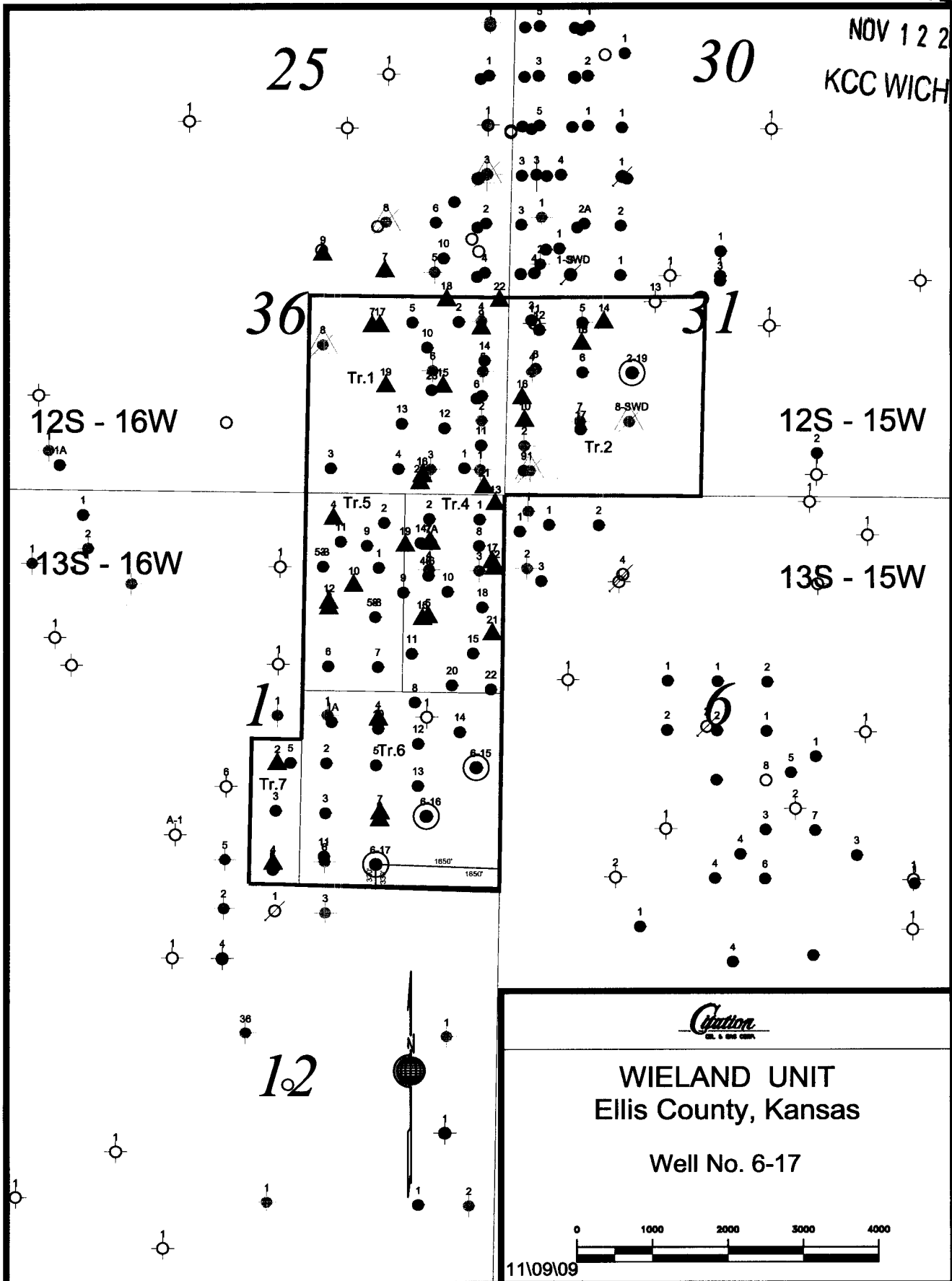

*Castro*  
Oil & Gas Co.

**WIELAND UNIT**  
Ellis County, Kansas

Well No. 6-17

0 1000 2000 3000 4000

11/09/09

**KANSAS CORPORATION COMMISSION  
OIL & GAS CONSERVATION DIVISION  
APPLICATION FOR SURFACE PIT**

Form CDP-1  
April 2004  
Form must be Typed

*Submit in Duplicate*

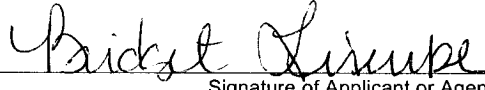
Operator Name: <b>Citation Oil &amp; Gas Corp</b>		License Number: <b>3553</b>
Operator Address: <b>P O Box 690688 Houston, TX 77269</b>		
Contact Person: <b>Bridget Lisenbe</b>		Phone Number: ( <b>281</b> ) <b>891 - 1565</b>
Lease Name & Well No.: <b>Wieland 6/17</b>		Pit Location (QQQQ): <b>SE SW SE</b> Sec. <b>1</b> Twp. <b>13S</b> R. <b>16</b> <input type="checkbox"/> East <input checked="" type="checkbox"/> West <b>330</b> Feet from <input type="checkbox"/> North / <input checked="" type="checkbox"/> South Line of Section <b>1650</b> Feet from <input checked="" type="checkbox"/> East / <input type="checkbox"/> West Line of Section <b>Ellis</b> County
Type of Pit: <input type="checkbox"/> Emergency Pit <input type="checkbox"/> Burn Pit <input type="checkbox"/> Settling Pit <input checked="" type="checkbox"/> Drilling Pit <input type="checkbox"/> Workover Pit <input type="checkbox"/> Haul-Off Pit <small>(If WP Supply API No. or Year Drilled)</small>	Pit is: <input checked="" type="checkbox"/> Proposed <input type="checkbox"/> Existing If Existing, date constructed: _____ Pit capacity: <b>600</b> (bbls)	
Is the pit located in a Sensitive Ground Water Area? <input type="checkbox"/> Yes <input checked="" type="checkbox"/> No		Chloride concentration: _____ mg/l <small>(For Emergency Pits and Settling Pits only)</small>
Is the bottom below ground level? <input checked="" type="checkbox"/> Yes <input type="checkbox"/> No	Artificial Liner? <input type="checkbox"/> Yes <input checked="" type="checkbox"/> No	How is the pit lined if a plastic liner is not used? <b>Bentonite and drill solids</b>
Pit dimensions (all but working pits): <b>100</b> Length (feet) <b>100</b> Width (feet) <b>N/A: Steel Pits</b> Depth from ground level to deepest point: <b>4</b> (feet)		
If the pit is lined give a brief description of the liner material, thickness and installation procedure.		Describe procedures for periodic maintenance and determining liner integrity, including any special monitoring.
Distance to nearest water well within one-mile of pit <input checked="" type="checkbox"/> None feet    Depth of water well <b>N/A</b> feet		Depth to shallowest fresh water <b>180</b> feet. Source of information: _____ measured    _____ well owner    _____ electric log <input checked="" type="checkbox"/> KDWR
<b>Emergency, Settling and Burn Pits ONLY:</b> Producing Formation: _____ Number of producing wells on lease: _____ Barrels of fluid produced daily: _____ Does the slope from the tank battery allow all spilled fluids to flow into the pit? <input type="checkbox"/> Yes <input type="checkbox"/> No		<b>Drilling, Workover and Haul-Off Pits ONLY:</b> Type of material utilized in drilling/workover: <b>Conditioned native mud fresh water</b> Number of working pits to be utilized: <b>1</b> Abandonment procedure: <b>Evaporation and backfill</b> _____ Drill pits must be closed within 365 days of spud date.
I hereby certify that the above statements are true and correct to the best of my knowledge and belief.		
<b>11/20/2009</b> Date	 Signature of Applicant or Agent	<b>RECEIVED NOV 12 2009 KCC WICHITA</b>

15051-25936-0000

<b>KCC OFFICE USE ONLY</b>			
Date Received: <b>11/12/09</b>	Permit Number: _____	Permit Date: <b>11/12/09</b>	Lease Inspection: <input type="checkbox"/> Yes <input checked="" type="checkbox"/> No

Mail to: KCC - Conservation Division, 130 S. Market - Room 2078, Wichita, Kansas 67202

# KCC -- Conservation Division Forms -- 06/01/2009

Internet KCC Home Page -- <http://kcc.ks.gov>

Conservation Division Home Page -- <http://kcc.ks.gov/conservation/index.htm>

Conservation Division Forms -- <http://kcc.ks.gov/conservation/forms/index.htm>

## ADOBE FILL-IN FORM ON INTERNET

### FORM DATE

- Electronic Filing of KCC forms**
- 04/2008 ■ Master Electronic Filing Certificate MEFC
- General Administrative**
- 09/2005 ■ License Application OPL-1  
04/2004 ■ Request for Change of Operator; Transfer of Injection or Surface Pit Permit T-1  
06/2009 ■ Well Intentry OWI-1
- Well Permitting**
- 10/2007 ■ Notice of Intent to Drill C-1 *Please use updated form on future filings*  
04/2004 ■ Application for Surface Pit CDP-1  
12/2008 ■ Cathodic Protection Borehole Intent to Drill CB-1
- Well Completion Reports and Other Well Application**
- 10/2008 ■ Well Completion Form ACO-1  
03/2009 ■ Commingling Application ACO-4  
03/2009 ■ Dual Completion Report ACO-5  
09/2005 ■ Well Location Exception Application Check List ACO-17  
05/2009 ■ Venting-Flaring of Gas ACO-18  
09/2005 ■ Extended Gas Venting Affidavit CG-3  
09/2005 ■ Coalbed Natural Gas Venting Affidavit CG-4  
03/2009 ■ Temporary Abandonment Application CP-111  
09/2003 ■ Verified Affidavit For Vacuum Operations V-1
- Surface Pits and Waste Transfer**
- 04/2004 ■ Application for Surface Pit CDP-1  
04/2004 ■ Closure of Surface Pit CDP-4  
08/2008 ■ Exploration and Production Waste Transfer CDP-5
- Well Plugging Report**
- 03/2009 ■ Well Plugging Application CP-1  
03/2009 ■ Well Plugging Record CP-4  
08/2003 ■ Seismic Hole Affidavit
- Oil & Gas Well Testing Report**
- 10/1996 Oil Productivity Test & GOR Report C-5  
10/1996 Multi-Point Back Pressure Test CG-1  
07/2003 ■ One Point Stabilized Open Flow or Deliverability Test G-2
- Gas Gathering Report**
- 06/2008 ■ Gas Gathering Report GG-1  
06/2007 ■ Gas Gathering Segment Report GG-1a
- Oil and Gas Producer's Report**
- 06/1989 Summary of Oil Producers Report CO-8, CO-8A  
08/2000 ■ Gas Producer/Purchaser Monthly Report CG-7, CG-7A
- Acreage Attribution and Well Spacing Report**
- 12/1994 Oil Acreage Attribution Plat CO-7  
12/1994 Gas Acreage Attribution Plat CG-8
- New Pool and Certificate of Enhancement Projects (Severance Tax Exemptions) Request**
- 07/2006 ■ New Pool Determination-Discovery Allowable ACO-16  
10/1999 ■ Application for Enhanced Recovery Project Certification CER-1, and  
Calculation Sheet Base Production Calculation and Certification CER 1-A
- Underground Injection Control Report**
- 07/2006 ■ UIC Application U-1  
11/2008 ■ Annual Report U3-C. This form is required on an annual basis due each March 1.  
07/2003 ■ Notice of Injection (of commencement or termination of injection) U-5  
07/2003 ■ Application to Amend Injection Order U-8  
07/2003 ■ Notice to Modify Injection Order U-9
- Wireline Service**
- 08/2003 ■ Monthly Wireline Service Company Report MWSC-1