

STATE CORPORATION COMMISSION OF KANSAS
OIL & GAS CONSERVATION DIVISION
WELL COMPLETION OR RECOMPLETION FORM
ACO-1 WELL HISTORY
DESCRIPTION OF WELL AND LEASE

S

API NO. 15-.....163-22-928-0000.....
County.....Rooks.....4
NW/4 SW/4 SE/4 Sec. 1... Twp. 10S. Rge. 20W. X East
.....990..... Ft North from Southeast Corner of Section
.....2289..... Ft West from Southeast Corner of Section
(Note: Locate well in section plat below)

Operator: License #6417.....
NameUnion Pacific Resources Company.....
Address1000 Louisiana Suite 3000.....
City/State/ZipHouston, TX 77002-5016.....

Lease Name.....Sutor.....Well #.....A-23.....

Purchaser.....Mobil Oil.....
.....Wichita, KS.....

Field Name.....Marcotte.....

Operator Contact PersonMarilyn Day.....
Phone(713) 654-2758.....

Producing Formation.....Upper Arbuckle.....

Contractor: License #5302.....
NameRed Tiger Drilling Company.....

Elevation: Ground.....2226'.....KB.....

Wellsite Geologist.....N/A.....
Phone.....

Section Plat

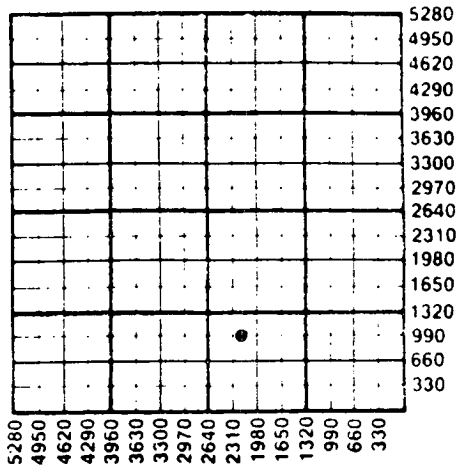

Designate Type of Completion
X New Well ___ Re-Entry ___ Workover
X Oil ___ SWD ___ Temp Abd
___ Gas ___ Inj ___ Delayed Comp.
___ Dry ___ Other (Core, Water Supply etc.)

If ONWO: old well info as follows:
Operator
Well Name
Comp. DateOld Total Depth.....

WATER SUPPLY INFORMATION

Disposition of Produced Water: X Disposal
Docket #D-20 271..... ___ Repressuring

WELL HISTORY

Drilling Method:
X Mud Rotary ___ Air Rotary ___ Cable
.....6/26/87..... 7/2/87..... 8/19/87.....
Spud Date Date Reached TD Completion Date
.....3,850'..... 3,770'.....
Total Depth PBTD

Questions on this portion of the ACO-1 call:
Water Resources Board (913) 296-3717
Source of Water:
Division of Water Resources Permit #.....
___ Groundwater.....Ft North from Southeast Corner
(Well) Ft West from Southeast Corner of
Sec Twp Rge ___ East ___ West
X Surface Water.....1200.....Ft North from Southeast Corner
(Stream, pond etc).....3100.....Ft West from Southeast Corner
Sec 30 Twp 9S Rge 19 ___ East X West
___ Other (explain).....Charles Stahl, Zurich, KS 67676
(purchased from city, R.W.D. #)

Amount of Surface Pipe Set and Cemented at.....245.42.....feet
Multiple Stage Cementing Collar Used? X Yes ___ No
If yes, show depth set.....1710.....feet
If alternate 2 completion, cement circulated
from.....3799.....feet depth to.....0.....w/.....750.....SX cmt
Cement Company Name
Invoice #

INSTRUCTIONS: This form shall be completed in triplicate and filed with the Kansas Corporation Commission, 200 Colorado Derby Building, Wichita, Kansas 67202, within 120 days of the spud date of any well. Rule 82-3-130, 82-3-107 and 82-3-106 apply. Information on side two of this form will be held confidential for a period of 12 months if requested in writing and submitted with the form. See rule 82-3-107 for confidentiality in excess of 12 months. One copy of all wireline logs and drillers time log shall be attached with this form. Submit CP-4 form with all plugged wells. Submit CP-111 form with all temporarily abandoned wells.

All requirements of the statutes, rules and regulations promulgated to regulate the oil and gas industry have been fully complied with and the statements herein are complete and correct to the best of my knowledge.

SignatureMarilyn Day.....
Title.....Regulatory Analyst..... Date3/3/88.....

Subscribed and sworn to before me this3rd..... day ofMarch.....
Notary PublicAdella Zavala.....
Date Commission Expires.....5-6-91.....

K.C.C. OFFICE USE ONLY
F Letter of Confidentiality Attached
C X Wireline Log Received
C X Drillers' Timelog Received
STATE CORPORATION Distribution
X KCC SWD/Rep NGPA
X KGS 7 1988 Plug Other...
3-7-88
Wichita, Kansas

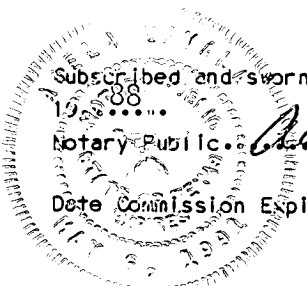

Sec. 1 Twp. 10S Rge. 20W

SIDE TWO

Operator Name Union Pacific Resources Company Lease Name Sutor Well # A-23

Sec. 1 Twp. 10S Rge. 20 East West County Rooks

WELL LOG

INSTRUCTIONS: Show important tops and base of formations penetrated. Detail all cores. Report all drill stem tests giving interval tested, time tool open and closed, flowing and shut-in pressures, whether shut-in pressure reached static level, hydrostatic pressures, bottom hole temperature, fluid recovery, and flow rates if gas to surface during test. Attach extra sheet if more space is needed. Attach copy of log.

.....

Drill Stem Tests Taken Yes No
 Samples Sent to Geological Survey Yes No
 Cores Taken Yes No

Formation Description
 Log Sample

Name	Top	Bottom
Lecompton	3324	
Oread	3364	
Heebner	3421	
Toronto	3440	
Lansing	3458	
Kansas City	3524	
Marmaton	3695	
Arbuckle	3756	

CASING RECORD New Used
 Report all strings set-conductor, surface, intermediate, production, etc.

Purpose of String	Size Hole Drilled	Size Casing Set (in O.D.)	Weight Lbs/Ft.	Setting Depth	Type of Cement	#Sacks Used	Type and Percent Additives
Surface	12-1/4"	8-5/8"	24#	254-42'	Class A	200	2% Gel 3% CC
Production	7-7/8"	5-1/2"	14#	3,843'	Class A	200	2% A-2, 1/4# SX
cello-flake, 200 sx Surefull Thixotropic, 6% A-10, 1/4# sx cello-flake; 350 sx Class A Fly							
Ash Gel 50/50, 6# 1% CC							

PERFORATION RECORD		Acid, Fracture, Shot, Cement Squeeze Record	
Shots Per Foot	Specify Footage of Each Interval Perforated	(Amount and Kind of Material Used)	Depth
4	3805-12' M. Arbuckle	Sqz w/25 sx Class A	3805-12'
4	3793-95'; 3782-86'; 3772-77'	Sqz w/50 sx Class A	3772-95'
4	M. Arbuckle		
4	3767-69'; 3761-64'; 3756-59'	Sqz w/75 sx Class A	3756-69'
4	U. Arbuckle	Spot 250 gal, 15% FE	3761-64'
4	3761-64' U. Arbuckle		

TUBING RECORD Size 2-7/8" Set At 3754' Packer at _____ Liner Run Yes No

Date of First Production 8-10-87 Producing Method Flowing Pumping Gas Lift Other (explain).....

Current Production	Oil	Gas	Water	Gas-Oil Ratio	Gravity
Estimated Production Per 24 Hours	10 Bbls	-MCF	676 Bbls	- CFPB	28.2 ⁰

METHOD OF COMPLETION Production Interval

Disposition of gas: Vented Open Hole Perforation Sold Other (Specify) U. Arbuckle
 Used on Lease Dually Completed 3761'-3764'
 Commingled

15-163-22928-0000

PLAT AND CERTIFICATION OF ACREAGE ATTRIBUTABLE TO A GAS WELL

CG-8

State Corporation Commission, Conservation Division
200 Colorado Derby Bldg. Wichita, Kansas 67202

OPERATOR Union Pacific Resources Company

LOCATION OF WELL

LEASE Sutor "A"

990 feet from the south line
2289 feet from the east line
Of the SE/4 of Sec. 1 T. 10S R. 20W

WELL NUMBER 23

FIELD Marcotte

COUNTY Rooks

ORDER GRANTING ALLOWABLE ENTERED IN DOCKET NO. _____

NUMBER OF ACRES
ATTRIBUTABLE TO WELL 10

DESCRIPTION OF ACREAGE:

PLAT

(Show location of Well and outline attributable acreage)

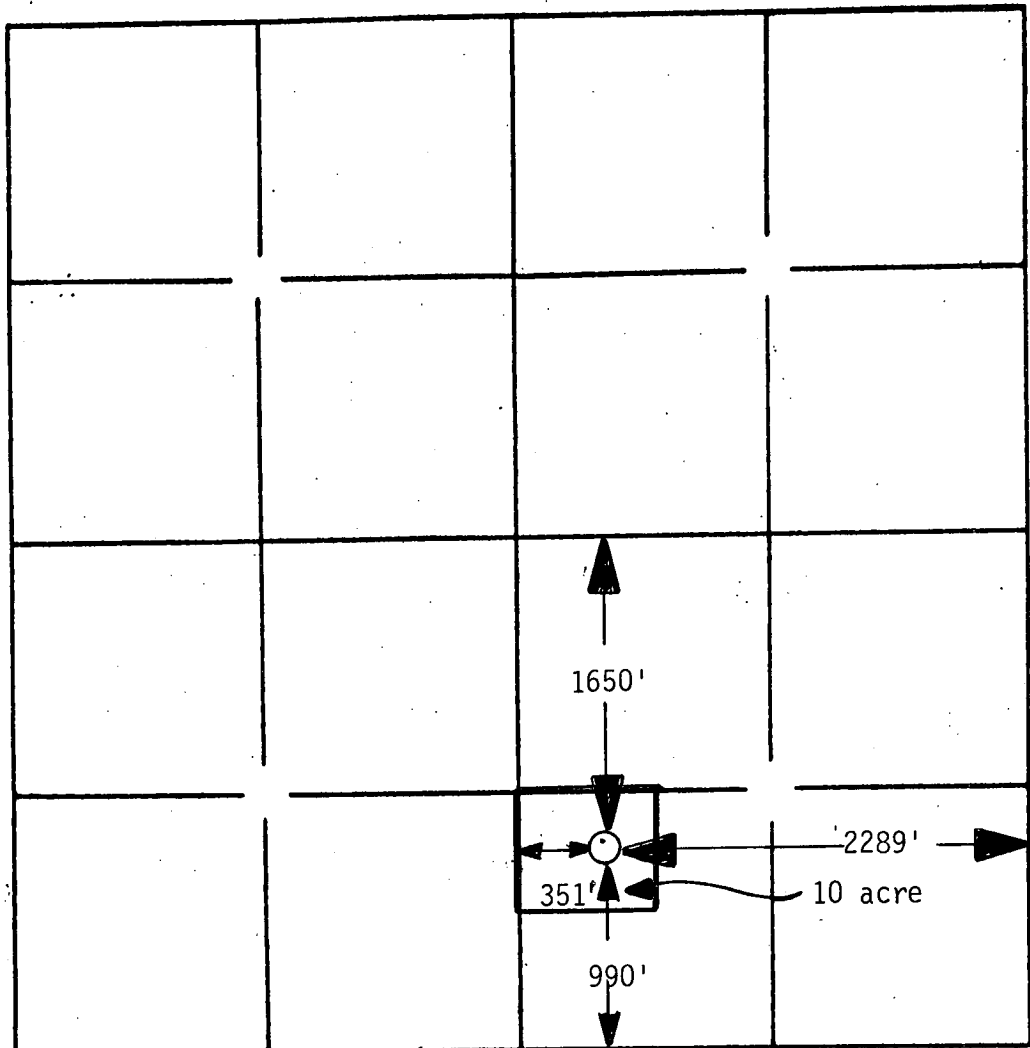

The undersigned hereby certifies that he is Regulatory Analyst
for Union Pacific Resources Company, a duly authorized agent, that all information shown hereon is true and correct to the best of his knowledge and belief, and that all acreage claimed as attributable to the well named herein is held by production from that well.

Paulyn Roy

Subscribed and sworn to before me on this 3rd day of March, 19 88.

Adela Zavala
Notary Public

My Commission Expires 5-6-91



STATE CORPORATION COMMISSION

MAR - 7 1988

Wichita, Kansas