

15-163-23313-00-00

FOR KCC USE:

FORM C-1 7/91

FORM MUST BE TYPED

FORM MUST BE SIGNED

ALL BLANKS MUST BE FILLED

EFFECTIVE DATE: 12-26-2000

State of Kansas

DISTRICT # 4

NOTICE OF INTENTION TO DRILL

Must be approved by the K.C.C. five (5) days prior to commencing well.

Expected Spud Date 12 month 29 day 2000 year

Spot SE SE NW Sec 9 Twp 10 S, Rg 20 East West

OPERATOR: License # 5616 Name: Calvin Noah Address: 329 N. Birch Valley Center, Ks. 67147 Contact Person: Joan Noah Phone: (316) 755-1032

2310 feet from South / North line of Section 2310 feet from East / West line of Section IS SECTION X REGULAR IRREGULAR?

(NOTE: Locate well on the Section Plat on Reverse Side) County: Rooks Lease Name: Therean Towns Well #: 1 Field Name: Marcotte

CONTRACTOR: License #: 30606 Name: Murfin Drilling Co., Inc.

Is this a Prorated/Spaced Field? yes X no Target Formation(s): LKC Arbuckle Nearest lease or unit boundary: 330'

Ground Surface Elevation: 2165 feet MSL Water well within one-quarter mile: X yes no Public water supply well within one mile: X yes no

Well Drilled For: Well Class: Type Equipment: X Oil Enh Rec X Infield X Mud Rotary Gas Storage Pool Ext. Air Rotary OWO Disposal Wildcat Cable Seismic; # of Holes Other

Depth to bottom of fresh water: 180' Depth to bottom of usable water: 200' SURFACE PIPE BY ALTERNATE: 1 X 2' 250'

Length of Surface Pipe Planned to be set: None Length of Conductor pipe required: 3850' Projected Total Depth: 3850' Formation at Total Depth: Arbuckle

If OWO: old well information as follows: Operator: Well Name: Comp. Date: Old Total Depth

Water Source for Drilling Operations: well farm pond X other

Directional, Deviated or Horizontal wellbore? yes X no If yes, true vertical depth: Bottom Hole Location:

Will Cores Be Taken? yes X no If yes, proposed zone:

AFFIDAVIT

The undersigned hereby affirms that the drilling, completion and eventual plugging of this well will comply with K.S.A. 55-101, et. seq. It is agreed that the following minimum requirements will be met:

- 1. Notify the appropriate district office prior to spudding of well;
2. A copy of the approved notice of intent to drill shall be posted on each drilling rig;
3. The minimum amount of surface pipe as specified below shall be set by circulating cement to the top;
4. If the well is dry hole, an agreement between the operator and the district office on plug length and placement is necessary prior to plugging;
5. The appropriate district office will be notified before well is either plugged or production casing is cemented in;
6. IF AN ALTERNATE II COMPLETION, PRODUCTION PIPE SHALL BE CEMENTED FROM BELOW ANY USABLE WATER TO SURFACE WITHIN 120 DAYS OF SPUD DATE. IN ALL CASES, NOTIFY DISTRICT OFFICE PRIOR TO ANY CEMENTING.

I hereby certify that the statements made herein are true and to the best of my knowledge and belief.

Date: 12-18-2000 Signature of Operator or Agent: Calvin B. Noah Title: operator

RECEIVED KANSAS CORPORATION COMMISSION

DEC 19 2000

CONSERVATION DIVISION WICHITA, KS

FOR KCC USE: API # 15- 163-23313-0000 Conductor pipe required NONS feet Minimum surface pipe required 200 feet per Alt. X(2) Approved by: JK 12-21-2000 This authorization expires: 6-21-2001 (This authorization void if drilling not started within 6 months of effective date.) Spud date: Agent:

REMEMBER TO:

- File Drill Pit Application (form CDP-1) with Intent to Drill;
- File Completion Form ACO-1 within 120 days of spud date;
- File acreage attribution plat according to field proration orders;
- Notify appropriate district office 48 hours prior to workover or re-entry;
- Submit plugging report (CP-4) after plugging is completed;
- Obtain written approval before disposing or injecting salt water.

Mail to: KCC - Conservation Division, 130 S. Market - Room 2078, Wichita, Kansas 67202.

9 10 20W

IN ALL CASES PLOT THE INTENDED WELL ON THE PLAT BELOW

PLAT OF ACREAGE ATTRIBUTABLE TO A WELL IN A PRORATED OR SPACED FIELD

If the intended well is in a prorated or spaced field, please fully complete this side of the form. If the intended well is in a prorated or spaced field complete the plat below showing that the well will be properly located in relationship to other wells producing from the common source of supply. Please show all the wells within 1 mile of the boundaries of the proposed acreage attribution unit for gas wells and within 1/2 mile of the boundaries of the proposed acreage attribution unit for oil wells.

API NO. 15- _____
 OPERATOR Calvin Noah
 LEASE Therean Towns
 WELL NUMBER #1
 FIELD Marcotte

LOCATION OF WELL: COUNTY Rooks
2310 feet from south/north line of section
2310 feet from east/west line of section
 SECTION 9 TWP 10S RG 20W

NUMBER OF ACRES ATTRIBUTABLE TO WELL 10
 QTR/QTR/QTR OF ACREAGE SE - SE - NW

IS SECTION X REGULAR or _____ IRREGULAR
IF SECTION IS IRREGULAR, LOCATE WELL FROM NEAREST CORNER BOUNDARY.

Section corner used: _____ NE _____ NW _____ SE _____ SW
PLAT

(Show location of the well and shade attributable acreage for prorated or spaced wells.)
 (Show footage to the nearest lease or unit boundary line.)

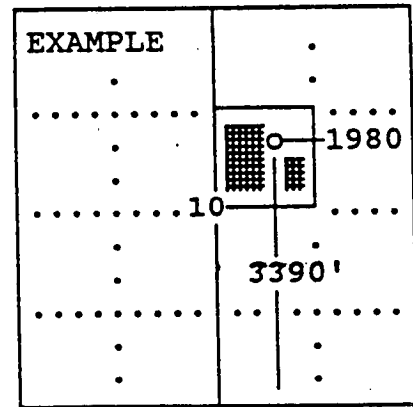
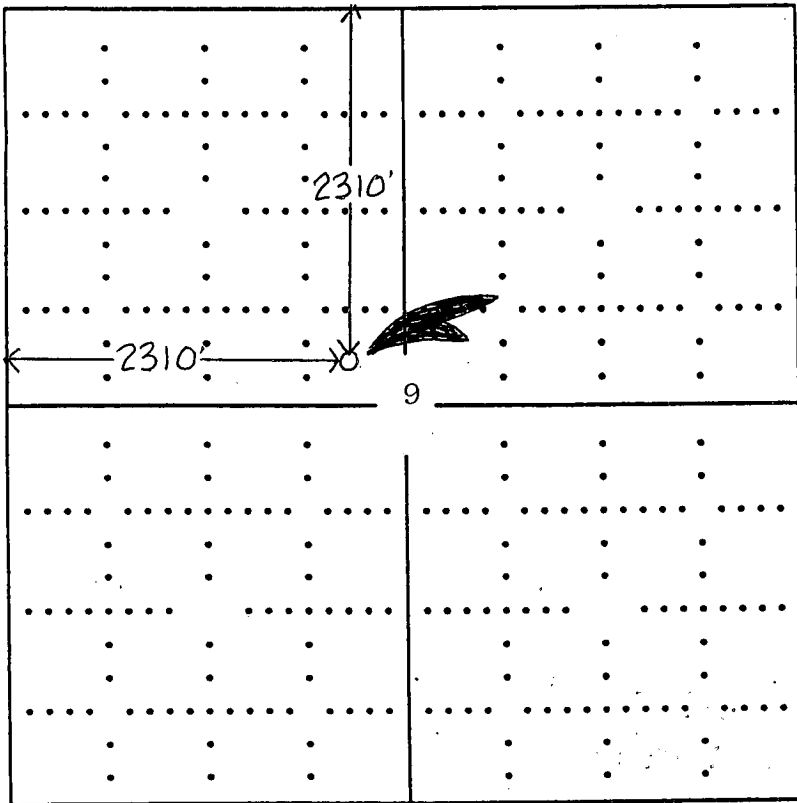

SEWARD CO.

In plotting the proposed location of the well, you must show:

- 1) The manner in which you are using the depicted plat by identifying section lines, i.e. 1 section, 1 section with 8 surrounding sections, 4 sections, etc.;
- 2) the distance of the proposed drilling location from the section's south/north and east/west; and
- 3) the distance to the nearest lease or unit boundary line.