

FOR KCC USE:

15-051-24794-00-00

FORM C-1 7/91

FORM MUST BE TYPED

FORM MUST BE SIGNED

ALL BLANKS MUST BE FILLED

EFFECTIVE DATE: 4-12-92

State of Kansas

DISTRICT # 4

NOTICE OF INTENTION TO DRILL

SGAT... Yes... No

Must be approved by the K.C.C. five (5) days prior to commencing well

Expected Spud Date April 6, 1992 month day year

Spot NW NE SE Sec 18 Twp 12 S, Rg 191 West

OPERATOR: License # 03655 STAAB ENERGY & LEASING Name: 2514 Haney Drive Address: Hays, Kansas 67601 City/State/Zip: Norman G. Staab Contact Person: 913-628-1326 Phone:

2310 feet from South / North line of Section 990 feet from East / West line of Section IS SECTION X REGULAR IRREGULAR?

CONTRACTOR: License # 05655 Shields Drilling Co., Inc. Name:

(NOTE: Locate well on the Section Plat on Reverse Side) County: Ellis Lease Name: Oscar Hagen Well #: 1 Field Name: Unknown

Well Drilled For: Well Class: Type Equipment: Oil Enh Rec Infield Mud Rotary Gas Storage Pool Ext Air Rotary OWWO Disposal Wildcat Cable Seismic # of Holes Other If OWWO: old well information as follows: Operator: Well Name: Comp. Date: Old Total Depth

Is this a Prorated/Spaced Field? yes X no Target Formation(s): Arbuckle Nearest lease or unit boundary: 990' Ground Surface Elevation: Later feet MSL Water well within one-quarter mile: X yes no Public water supply well within one mile: yes X no Depth to bottom of fresh water: 24' Depth to bottom of usable water: 450' 710 Surface Pipe by Alternate: 1 X 2 Length of Surface Pipe Planned to be set: 200' Length of Conductor pipe required: N/A Projected Total Depth: 3800' Formation at Total Depth: Arbuckle Water Source for Drilling Operations: Spring Water feed draw - 2' deep well farm pond X other DWR Permit #: Will Cores Be Taken?: yes X no If yes, proposed zone:

Directional, Deviated or Horizontal wellbore? yes X no

If yes, true vertical depth:

Bottom Hole Location:

AFFIDAVIT

The undersigned hereby affirms that the drilling, completion and eventual plugging of this well will comply with K.S.A. 55-101, et. seq.

It is agreed that the following minimum requirements will be met:

- 1. Notify the appropriate district office prior to spudding of well;
2. A copy of the approved notice of intent to drill shall be posted on each drilling rig;
3. The minimum amount of surface pipe as specified below shall be set by circulating cement to the top; in all cases surface pipe shall be set through all unconsolidated materials plus a minimum of 20 feet into the underlying formation;
4. If the well is dry hole, an agreement between the operator and the district office on plug length and placement is necessary prior to plugging;
5. The appropriate district office will be notified before well is either plugged or production casing is cemented in;
6. IF AN ALTERNATE II COMPLETION, PRODUCTION PIPE SHALL BE CEMENTED FROM BELOW ANY USABLE WATER TO SURFACE WITHIN 120 DAYS OF SPUD DATE. IN ALL CASES, NOTIFY DISTRICT OFFICE PRIOR TO ANY CEMENTING.

I hereby certify that the statements made herein are true and to the best of my knowledge and belief.

Date: April 6, 1992 Signature of Operator or Agent: Title: Owner

FOR KCC USE: API # 15-051-24794-00-00 Conductor pipe required None feet Minimum surface pipe required 200 feet per Alt. X (2) Approved by: 09 4-7-92 This authorization expires: 10-7-92 (This authorization void if drilling not started within 6 months of effective date.) Spud date: Agent:

STATE CORPORATION COMMISSION RECEIVED APR 07 1992 CONSERVATION DIVISION Wichita, Kansas

REMEMBER TO:

- File Drill Pit Application (form CDP-1) with Intent to Drill;
- File Completion Form ACO-1 within 120 days of spud date;
- File acreage attribution plat according to field proration orders;
- Notify appropriate district office 48 hours prior to workover or re-entry;
- Submit plugging report (CP-4) after plugging is completed;
- Obtain written approval before disposing or injecting salt water.

Mail to: Conservation Division, 200 Colorado Derby Building, 202 W. First St., Wichita, Kansas 67202-1286.

IN ALL CASES PLOT THE INTENDED WELL ON THE PLAT BELOW

PLAT OF ACREAGE ATTRIBUTABLE TO A WELL IN A PRORATED OR SPACED FIELD

If the intended well is in a prorated or spaced field, please fully complete this side of the form. If the intended well is in a prorated or spaced field complete the plat below showing that the well will be properly located in relationship to other wells producing from the common source of supply. Please show all the wells within 1 mile of the boundaries of the proposed acreage attribution unit for gas wells and within 1/2 mile of the boundaries of the proposed acreage attribution unit for oil wells.

API NO. 15- _____
 OPERATOR STAAB ENERGY & LEASING
 LEASE OSCAR HAGEN
 WELL NUMBER 1
 FIELD Unknown

LOCATION OF WELL: COUNTY Ellis
2310 feet from south/~~north~~ line of section
990 feet from east/~~west~~ line of section
 SECTION 18 TWP 12s RG 19w

NUMBER OF ACRES ATTRIBUTABLE TO WELL 160
 QTR/QTR/QTR OF ACREAGE NW - NE - SE

IS SECTION X REGULAR or IRREGULAR
IF SECTION IS IRREGULAR, LOCATE WELL FROM NEAREST CORNER BOUNDARY.

Section corner used: NE NW X SE SW

PLAT

(Show location of the well and shade attributable acreage for prorated or spaced wells.)
 (Show footage to the nearest lease or unit boundary line.)

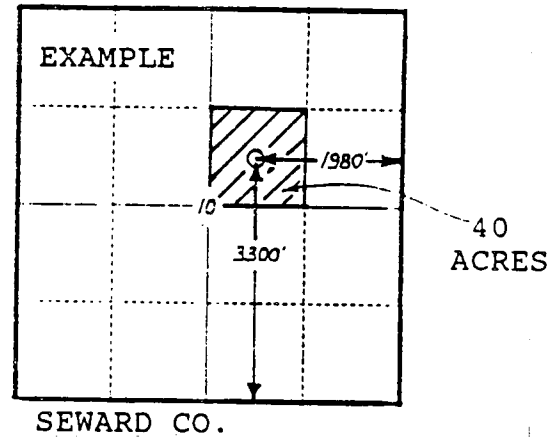
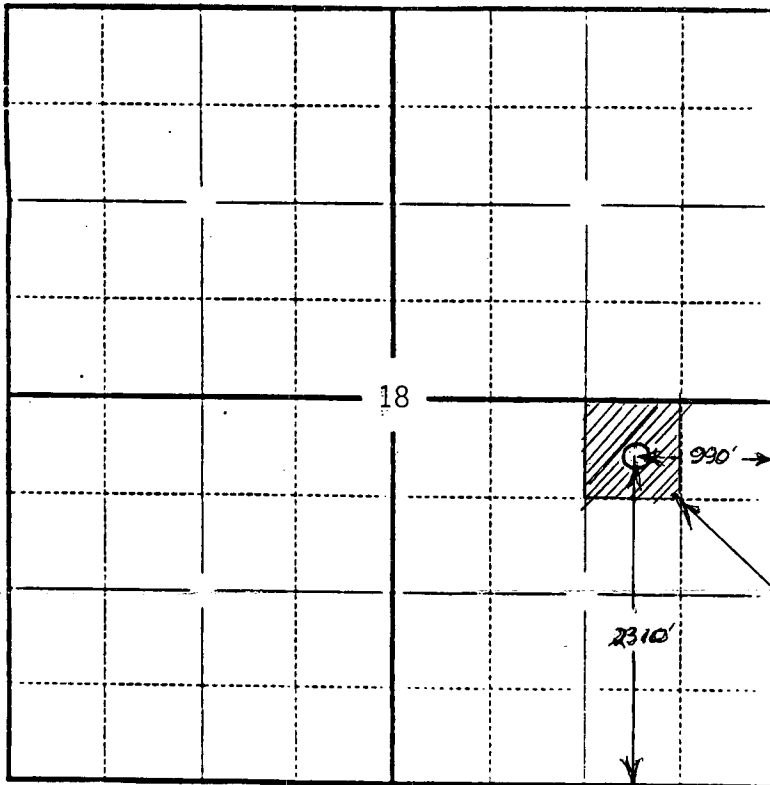

ELLIS COUNTY

In plotting the proposed location of the well, you must show:

- 1) The manner in which you are using the depicted plat by identifying section lines, i.e. 1 section, 1 section with 8 surrounding sections, 4 sections, etc.;
- 2) the distance of the proposed drilling location from the section's south/north and east/west lines; and
- 3) the distance to the nearest lease or unit boundary line.

FOR KCC USE:

FORM C-1 7/91

EFFECTIVE DATE: 4-12-92

FORM MUST BE TYPED

DISTRICT # 4

State of Kansas
NOTICE OF INTENTION TO DRILL

FORM MUST BE SIGNED

SSAT Yes No

ALL BLANKS MUST BE FILLED

Must be approved by the K.C.C. five (5) days prior to commencing well

Expected Spud Date April 6, 1992
month day year

Spot NW NE SE Sec 18 Twp 12 S, Rg 19 West

OPERATOR: License # 03655
Name: STAAB ENERGY & LEASING
Address: 2514 Haney Drive
City/State/Zip: Hays, Kansas 67601
Contact Person: Norman G. Staab
Phone: 913-628-1326

2310 feet from South / XXXX line of Section
990 feet from East / XXX line of Section
IS SECTION X REGULAR IRREGULAR?

CONTRACTOR: License # 05655
Name: Shields Drilling Co., Inc.

(NOTE: Locate well on the Section Plat on Reverse Side)
County: Ellis
Lease Name: Oscar Hagen Well #: 1
Field Name: Unknown

Well Drilled For: Well Class: Type Equipment:
X Oil ... Enh Rec ... Infield X Mud Rotary
Gas ... Storage ... Pool Ext. ... Air Rotary
OWVO ... Disposal X Wildcat ... Cable
Seismic; ... # of Holes ... Other

Is this a Prorated/Spaced Field? yes X no
Target Formation(s): Arbuckle
Nearest lease or unit boundary: 990'

If OWVO: old well information as follows:
Operator:
Well Name:
Comp. Date: Old Total Depth

Ground Surface Elevation: Later feet MSL
Water well within one-quarter mile: X yes no
Public water supply well within one mile: yes X no
Depth to bottom of fresh water: 24'

Directional, Deviated or Horizontal wellbore? yes X no
If yes, true vertical depth:
Bottom Hole Location:

Depth to bottom of usable water: 450' 7/0
Surface Pipe by Alternate: 1 X 2
Length of Surface Pipe Planned to be set: 200'
Length of Conductor pipe required: N/A
Projected Total Depth: 3800'

AFFIDAVIT

The undersigned hereby affirms that the drilling, completion and eventual plugging of this well will comply with K.S.A. 55-101, et. seq.

It is agreed that the following minimum requirements will be met:

- 1. Notify the appropriate district office prior to spudding of well;
- 2. A copy of the approved notice of intent to drill shall be posted on each drilling rig;
- 3. The minimum amount of surface pipe as specified below shall be set by circulating cement to the top; in all cases surface pipe shall be set through all unconsolidated materials plus a minimum of 20 feet into the underlying formation;
- 4. If the well is dry hole, an agreement between the operator and the district office on plug length and placement is necessary prior to plugging;
- 5. The appropriate district office will be notified before well is either plugged or production casing is cemented in;
- 6. IF AN ALTERNATE II COMPLETION, PRODUCTION PIPE SHALL BE CEMENTED FROM BELOW ANY USABLE WATER TO SURFACE WITHIN 120 DAYS OF SPUD DATE. IN ALL CASES, NOTIFY DISTRICT OFFICE PRIOR TO ANY CEMENTING.

I hereby certify that the statements made herein are true and to the best of my knowledge and belief.

Date: April 6, 1992 Signature of Operator or Agent: Norman G. Staab Title: Owner

FOR KCC USE:
API # 15-051-24794-00-00
Conductor pipe required None feet
Minimum surface pipe required 200 feet per Alt. X (2)
Approved by: 29 4-7-92
This authorization expires: 10-7-92
(This authorization void if drilling not started within 6 months of effective date.)
Spud date: Agent:

RECEIVED
STATE COMMISSION
APR 07 1992
CONSERVATION DIVISION
Wichita, Kansas

REMEMBER TO:

- File Drill Pit Application (form CDP-1) with Intent to Drill;
- File Completion Form ACO-1 within 120 days of spud date;
- File acreage attribution plat according to field proration orders;
- Notify appropriate district office 48 hours prior to workover or re-entry;
- Submit plugging report (CP-4) after plugging is completed;
- Obtain written approval before disposing or injecting salt water.

Mail to: Conservation Division, 200 Colorado Derby Building, 202 W. First St., Wichita, Kansas 67202-1286.

18
12
19

IN ALL CASES PLOT THE INTENDED WELL ON THE PLAT BELOW

PLAT OF ACREAGE ATTRIBUTABLE TO A WELL IN A PRORATED OR SPACED FIELD

If the intended well is in a prorated or spaced field, please fully complete this side of the form. If the intended well is in a prorated or spaced field complete the plat below showing that the well will be properly located in relationship to other wells producing from the common source of supply. Please show all the wells within 1 mile of the boundaries of the proposed acreage attribution unit for gas wells and within 1/2 mile of the boundaries of the proposed acreage attribution unit for oil wells.

API NO. 15- _____
 OPERATOR STAAB ENERGY & LEASING LOCATION OF WELL: COUNTY Ellis
 LEASE OSCAR HAGEN 2310 feet from south/north line of section
 WELL NUMBER 1 990 feet from east/west line of section
 FIELD Unknown SECTION 18 TWP 12s RG 19w

NUMBER OF ACRES ATTRIBUTABLE TO WELL 160 IS SECTION X REGULAR or IRREGULAR
 QTR/QTR/QTR OF ACREAGE NW - NE - SE IF SECTION IS IRREGULAR, LOCATE WELL FROM NEAREST CORNER BOUNDARY.

Section corner used: NE NW X SE SW
PLAT

(Show location of the well and shade attributable acreage for prorated or spaced wells.)
 (Show footage to the nearest lease or unit boundary line.)

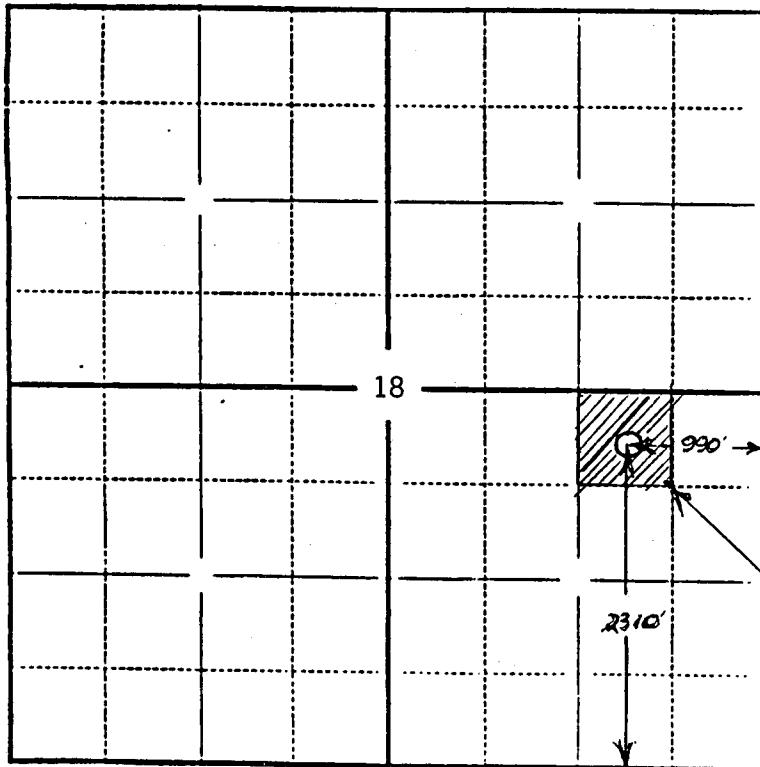

ELLIS COUNTY

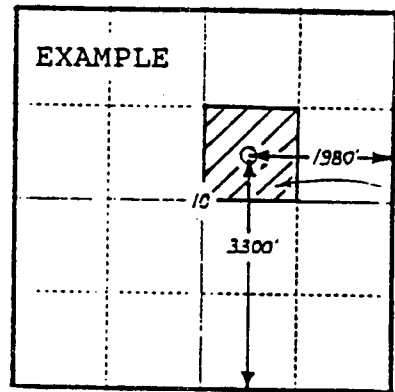

SEWARD CO.

10 ACRES

In plotting the proposed location of the well, you must show:

- 1) The manner in which you are using the depicted plat by identifying section lines, i.e. 1 section, 1 section with 8 surrounding sections, 4 sections, etc.;
- 2) the distance of the proposed drilling location from the section's south/north and east/west lines; and
- 3) the distance to the nearest lease or unit boundary line.