

Give All Information Completely  
Make Required Affidavit  
Mail or Deliver Report to:  
Conservation Division  
State Corporation Commission  
212 North Market, Insurance Bldg.  
Wichita, Kansas

WELL PLUGGING RECORD

Ellis County. Sec. 13 Twp. 12S Rge. (E) 20 (W)

Location as "NE/CNW%SW%" or footage from lines NW NE  
Lease Owner John O. Farmer, Inc.  
Lease Name Hagen Well No. 1  
Office Address 370 W. Wichita, Russell, Kansas  
Character of Well (completed as Oil, Gas or Dry Hole) Dry  
Date well completed 19  
Application for plugging filed 3/22/1962  
Application for plugging approved 3/22/1962  
Plugging commenced 3/22/1962  
Plugging completed 3/22/1962  
Reason for abandonment of well or producing formation Dry

NORTH

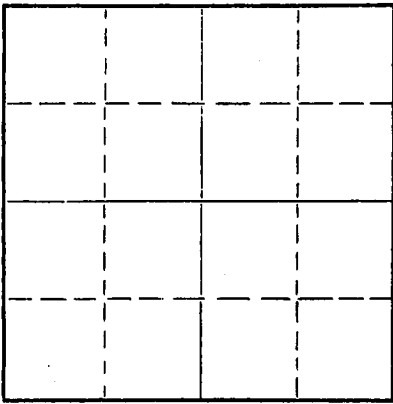

Locate well correctly on above Section Plat

If a producing well is abandoned, date of last production 19  
Was permission obtained from the Conservation Division or its agents before plugging was commenced? Yes

Name of Conservation Agent who supervised plugging of this well Elen Petty, Hays, Kansas  
Producing formation \_\_\_\_\_ Depth to top \_\_\_\_\_ Bottom \_\_\_\_\_ Total Depth of Well 3815 Feet  
Show depth and thickness of all water, oil and gas formations.

OIL, GAS OR WATER RECORDS

CASING RECORD

FORMATION	CONTENT	FROM	TO	SIZE	PUT IN	PULLED OUT

Describe in detail the manner in which the well was plugged, indicating where the mud fluid was placed and the method or methods used in introducing it into the hole. If cement or other plugs were used, state the character of same and depth placed, from \_\_\_\_\_ feet to \_\_\_\_\_ feet for each plug set.

First Plug at 550' with 20 sacks cement  
Second at 160' with 20 sacks cement  
Third at 40' with 10 sacks cement

RECEIVED  
STATE CORPORATION COMMISSION

MAR 29 1962  
03-29-1962  
CONSERVATION DIVISION  
Wichita, Kansas

(If additional description is necessary, use BACK of this sheet)

Name of Plugging Contractor John O. Farmer, Inc.  
Address P. O. Box 352, Russell, Kansas

STATE OF Kansas, COUNTY OF Russell, ss.  
John O. Farmer (employee of owner) or (owner or operator) of the above-described well, being first duly sworn on oath, says: That I have knowledge of the facts, statements, and matters herein contained and the log of the above-described well as filed and that the same are true and correct. So help me God.

(Signature) John O. Farmer  
President  
P. O. Box 352, Russell, Kansas  
(Address)

SUBSCRIBED AND SWORN TO before me this 28th day of March 1962

My commission expires 5/18/64  
Dorothy Ratts Notary Public.

OPERATOR John O. Farmer, Inc.

15051-01167-00-00

FORMATION RECORD

Give detailed description and thickness of all formation drilled through, contents of sand, whether dry, water, oil or gas.

ADDRESS 370 W. Wichita, Russell, Kansas

WELL NO. 1 COUNTY ELLIS SEC. 13 TWP. 12S RGE. 20W

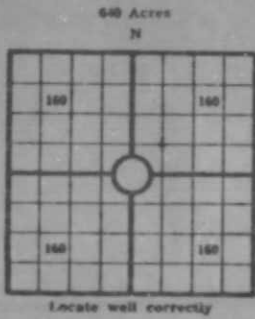

COUNTY Ellis, SEC. 13, TWP. 12S, RGE. 20W  
 COMPANY OPERATING John O. Farmer, Inc.  
 OFFICE ADDRESS 370 W. Wichita, Russell, Kns.  
 DRILLING STARTED 3/14 1962. DRILLING FINISHED 3/22 1962  
 DATE OF FIRST PRODUCTION \_\_\_\_\_ COMPLETED \_\_\_\_\_  
 WELL LOCATED 1/4 NW 1/4 NE 1/4 660 of South  
 Line and 660 ft. East of West Line of Quarter Section  
 Elevation (Relative to sea level) DERRICK FLOOR 2176 GROUND 2173  
 CHARACTER OF WELL (Oil, gas or dryhole) Dry

OIL OR GAS SANDS OR ZONES

Name	From	To	Name	From	To
1			4		
2			5		
3			6		

Perforating Record if Any

Shot Record

Formation	From	To	No. of Shots	Formation	From	To	Size of Shot

CASING RECORD

Amount Set						Amount Pulled		Packer Record			
Size	Wt.	Thds.	Make	Ft.	In.	Ft.	In.	Size	Length	Depth Set	Make

Liner Record: Amount \_\_\_\_\_ Kind \_\_\_\_\_ Top \_\_\_\_\_ Bottom \_\_\_\_\_

CEMENTING AND MUDDING

Size	Amount Set		Socks Cement	Chemical		Method of Cementing	Amount	Mudding Method	Results (See Note)
	Ft.	In.		Gal.	Make				
8 5/8	160	100							

Note: What method was used to protect sands if outer strings were pulled? \_\_\_\_\_

NOTE: Were bottom hole plugs used? \_\_\_\_\_ If so, state kind, depth set and results obtained \_\_\_\_\_

TOOLS USED

Rotary Tools were used from 0 feet to T. D. Cable tools were used from \_\_\_\_\_ feet to \_\_\_\_\_ feet, and from \_\_\_\_\_ feet to \_\_\_\_\_ feet, and from \_\_\_\_\_ feet to \_\_\_\_\_ feet

Type Rig Rotary

INITIAL PRODUCTION TEST

Describe initial test: whether by flow through tubing or casing or by pumping \_\_\_\_\_

Amount of Oil Production \_\_\_\_\_ bbls. Size of choke, if any \_\_\_\_\_ Length of test \_\_\_\_\_ Water

Production \_\_\_\_\_ bbls. Gravity of oil \_\_\_\_\_ Type of Pump if pump is used, describe \_\_\_\_\_

Formation	Top	Bottom	Formation	Top	Bottom
Surface	0	160			
Shale	160	300			
Shale & Sand	300	1375			
Shale	1375	1555			
Anhydrite	1555	1587			
Shale & Shells	1587	2200			
Shale & Lime	2200	2600			
Lime & Shale	2600	2715			
Shale & Lime	2715	3075			
Lime & Shale	3075	3815			
T. D.	3815				
			<u>Tops: Formation</u>		
			Heebner	3400	
			Toronto	3467	
			Lansing	3484	
			B/KC	3724	
			Marmathon Chert	3766	
			Conglomerate	3792	
			T. D.	3815	

RECEIVED  
 STATE CORPORATION COMMISSION  
 MAY 29 1962  
 CONSERVATION DIVISION  
 Wichita, Kansas

I, the undersigned, being first duly sworn upon oath, state that this well record is true, correct and complete according to the records of this office and to the best of my knowledge and belief.

Name and title of \_\_\_\_\_ of company  
President

Subscribed and sworn to before me this 28th day of March, 1962

My Commission expires 5/18/64

Dorothy Ratts  
 Notary Public.