

STATE OF KANSAS
STATE CORPORATION COMMISSION

WELL PLUGGING RECORD

Give All Information Completely
Make Required Affidavit
Mail or Deliver Report to
Conservation Division
State Corporation Comm.
245 North Water
Wichita, KS 67202

ROOKS County. Sec. 11 Twp. 10S Rge. 20 XE/W
Location as "NE/CNW¹/SW¹" or footage from lines
C NE/4 SW/4

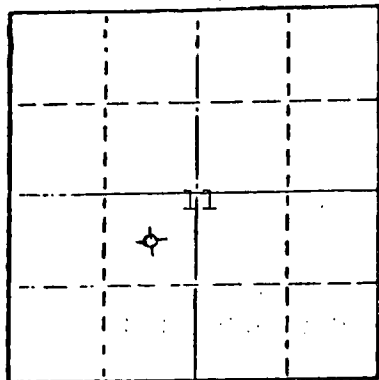

Locate well correctly on above
Section Plat

Lease Owner I O MILLER INC
Lease Name CROFFOOT C-G Well No. 11
Office Address P OBOX 124, ELLIS, KS 67637
Character of Well (Completed as Oil, Gas or Dry Hole)
DRY HOLE

Date Well completed 9/5/77 19
Application for plugging filed 9/5/77 19
Application for plugging approved 9/5/77 19
Plugging commenced 9/5/77 19
Plugging completed 9/5/77 19

Reason for abandonment of well or producing formation
TOO LOW STRUCTURALLY

If a producing well is abandoned, date of last production
19

Was permission obtained from the Conservation Division or
its agents before plugging was commenced? YES

Name of Conservation Agent who supervised plugging of this well LEO F MASSEY, HAYS, KS
Producing formation Depth to top Bottom Total Depth of Well 3829
Show depth and thickness of all water, oil and gas formations.

OIL, GAS OR WATER RECORDS

CASING RECORD

FORMATION	CONTENT	FROM	TO	SIZE	PUT IN	PULLED OUT
				8 5/8"	212.95'	NONE

Describe in detail the manner in which the well was plugged, indicating where the mud fluid
was placed and the method or methods used in introducing it into the hold. If cement or other
plugs were used, state the character of same and depth placed, from _____ feet to
_____ feet for each plug set.

FILLED WITH HEAVY MUD TO 720'. SET
PLUG. PUT IN 70 SACKS CEMENT. FILLED
WITH HEAVY MUD TO 180'. SET PLUG.
PUT IN 20 SACKS CEMENT. FILLED WITH
HEAVY MUD TO 40'. SET PLUG. FILLED TO
TOP WITH 15 SACKS HULLS & 10 SACKS
CEMENT, 50-50- POZ 6% GEL.

09-116-77

(If additional description is necessary, use BACK of this sheet)

Name of Plugging Contractor C-G DRILLING CO
1107 DOUGLAS BLDG, WICHITA, KS 67202

STATE OF KANSAS COUNTY OF SEDGWICK ss:
G F GALLOWAY

(employee of owner) or (owner or operator) of the above-described
well, being first duly sworn on oath, says: That I have knowledge of the facts, statements, and matters herein contained and the log of the
above-described well as filed and that the same are true and correct. So help me God.

(Signature) *G F Galloway*
G F GALLOWAY
1107 DOUGLAS BLDG, WICHITA, KS 67202

SUBSCRIBED AND SWORN TO before me this 10TH day of SEPTEMBER 1977

My commission expires MARCH 3, 1980

Debra L Heersche
DEBRA L HEERSCHKE Notary Public.

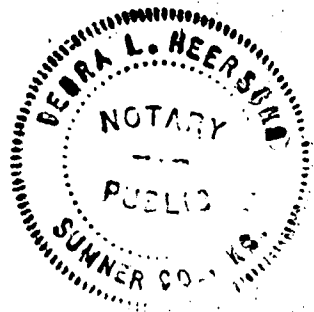

15-163-20727-0000

KANSAS DRILLERS LOG

S. 11 T. 10S R. 20 ^E/_W
 Loc. APPROX C NE/4 SW/4
 County ROOKS

API No. 15 — County Number

Operator
I O MILLER INC

Address
P O BOX 124, ELLIS, KS 67637

Well No. 11 Lease Name CROFFOOT C-G

Footage Location
1980 feet from (N) (S) line 1980 feet from (E) (W) line

Principal Contractor C-G DRILLING CO Geologist JERRY JESPERSEN

Spud Date 8/27/77 Total Depth 3829 P.B.T.D.

Date Completed 9/5/77 Oil Purchaser

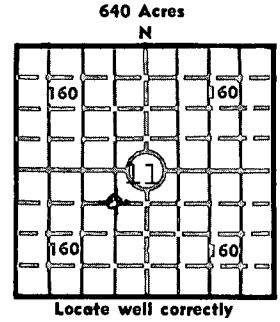

Elev.: Gr.

DF KB 2240

CASING RECORD

Report of all strings set — surface, intermediate, production, etc.

Purpose of string	Size hole drilled	Size casing set (in O.D.)	Weight lbs/ft.	Setting depth	Type cement	Sacks	Type and percent additives
SURFACE	12 1/4"	8 5/8"	28#	212.95	Common	120	2% Gel 3% CC

LINER RECORD

PERFORATION RECORD

Top, ft.	Bottom, ft.	Sacks cement	Shots per ft.	Size & type	Depth interval

TUBING RECORD

Size	Setting depth	Packer set at

ACID, FRACTURE, SHOT, CEMENT SQUEEZE RECORD

Amount and kind of material used	Depth interval treated

INITIAL PRODUCTION

Date of first production <u> </u>		Producing method (flowing, pumping, gas lift, etc.) <u> </u>			
RATE OF PRODUCTION PER 24 HOURS	Oil <u> </u> bbls.	Gas <u> </u> MCF	Water <u> </u> bbls.	Gas-oil ratio <u> </u>	CFPB <u> </u>
Disposition of gas (vented, used on lease or sold) <u> </u>			Producing interval(s) <u> </u>		

INSTRUCTIONS: As provided in KCC Rule 82-2-125, within 90 days after completion of a well, one completed copy of this Drillers Log shall be transmitted to the State Geological Survey of Kansas, 4150 Monroe Street, Wichita, Kansas 67209. Copies of this form are available from the Conservation Division, State Corporation Commission, 3830 So. Meridian (P.O. Box 17027), Wichita, Kansas 66217. Phone AC 316-522-2206. If confidential custody is desired, please note Rule 82-2-125. Drillers Logs will be on open file in the Oil and Gas Division, State Geological Survey of Kansas, Lawrence, Kansas 66044.

Operator

I O MILLER INC

DESIGNATE TYPE OF COMP.: OIL, GAS, DRY HOLE, SWDW, ETC.:

DRY HOLE

Well No.

11

Lease Name

CROFFOOT C-G

S 11 T 10 R 20 W

WELL LOG

Show all important zones of porosity and contents thereof; cored intervals, and all drill-stem tests, including depth interval tested, cushion used, time tool open, flowing and shut-in pressures, and recoveries.

SHOW GEOLOGICAL MARKERS, LOGS RUN, OR OTHER DESCRIPTIVE INFORMATION.

FORMATION DESCRIPTION, CONTENTS, ETC.	TOP	BOTTOM	NAME	DEPTH
SHALE	0	850		
SAND	850	1060		
SHALE & SAND	1060	1505		
RED BED	1505	1674		
ANHYDRITE	1674	1718		
SHALE & SHELLS	1718	1970		
SHALE & LIME	1970	2285		
LIME & SHALE	2285	3250		
LIME	3250	3325		
LIME & SHALE	3325	3505		
LIME	3505	3809		
ARBUCKLE & RTD	3809	3829		
DST #1: 3262-3280' 30-30-60-30. REC 30' OCM, 60' SOCWM, 180' MW, IBHP 1056# FBHP 1022#, IFP 45#, FFP 149#.				
DST #2: 3490-3555' 30-30-60-30. REC 190' MUD. IBHP 880#, FBHP 846#, IFP 44#, FFP 111#				
DST #3: 3557-3577' 30-30-30-30. STRONG BLOW. REC 90' SO & GCM, IBHP 33#, FBHP 66#, IFP 22#, FFP 44#.				
DST #4: 3763-3778' 30-30-30-30. REC 120' O & GCMW, 420' O & GCW, 180' WTR. IBHP 344#, FBHP 344#, IFP 344#, FFP 344#				
DST #5: 3789-3809' 30-30-30-30. REC 1922' SW IBHP 842#, FBHP 842#, IFP 42# FFP 842#.				
USE ADDITIONAL SHEETS, IF NECESSARY, TO COMPLETE WELL RECORD.				

DST #6: 3821-3829' 30-30-30-30. REC 190' SW IBHP 876#, FBHP 864# IFP 114#, FFP 864#.

Date Received

C-G DRILLING CO

Debra Heersche

Signature

Debra Heersche, Office Mgr

Title

9/15/77

Date