

STATE OF KANSAS
STATE CORPORATION COMMISSION

Give All Information Completely
Make Required Affidavit
Mail or Deliver Report to:
Conservation Division
State Corporation Commission
211 No. Broadway
Wichita, Kansas

15-051-00830-00-00
WELL PLUGGING RECORD

NORTH

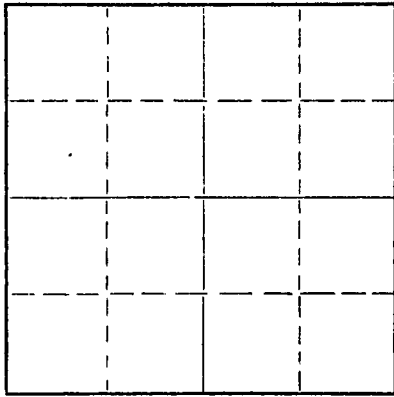

Locate well correctly on above
Section Plat

Ellis County. Sec. 22 Twp. 12 Rge. (E) 17 (W)
Location as "NE/CNW/WSW" or footage from lines NE NE SW
Lease Owner Jones, Shelburne & Farmer, Inc.
Lease Name SCHMEIDLER C Well No. 1
Office Address Russell, Kansas
Character of Well (completed as Oil, Gas or Dry Hole) Dry
Date well completed 12-17 19 56
Application for plugging filed 12-17 19 56
Application for plugging approved 12-17 19 56
Plugging commenced 12-17 19 56
Plugging completed 12-17 19 56
Reason for abandonment of well or producing formation Dry

If a producing well is abandoned, date of last production _____ 19 ____
Was permission obtained from the Conservation Division or its agents before plugging was commenced? Yes

Name of Conservation Agent who supervised plugging of this well Eldon Petty
Producing formation _____ Depth to top _____ Bottom _____ Total Depth of Well 3714 Feet
Show depth and thickness of all water, oil and gas formations.

OIL, GAS OR WATER RECORDS

CASING RECORD

FORMATION	CONTENT	FROM	TO	SIZE	PUT IN	PULLED OUT
				8-5/8	160	None

Describe in detail the manner in which the well was plugged, indicating where the mud fluid was placed and the method or methods used in introducing it into the hole. If cement or other plugs were used, state the character of same and depth placed, from _____ feet to _____ feet for each plug set.

1. Filled hole with heavy mud
2. Pushed plug to 160
3. Dumped 1/2 sack hulls on top of plug
4. Mixed 15 sacks cement and dumped on top of hulls
5. Filled hole to top
6. Pushed plug to 40
7. Dumped in 1/2 sack hulls
8. Mixed 9-1/2 sacks cement and filled hole to top with same.

1-2-1957

(If additional description is necessary, use BACK of this sheet)

Name of Plugging Contractor Jones, Shelburne & Farmer, Inc.
Address Russell, Kansas

STATE OF Kansas, COUNTY OF Russell, ss.
JOHN O. FARMER (owner or operator) of the above-described well, being first duly sworn on oath, says: That I have knowledge of the facts, statements, and matters herein contained and the log of the above-described well as filed and that the same are true and correct. So help me God.

(Signature) John O. Farmer
Russell, Kansas
(Address)

SUBSCRIBED AND SWORN to before me this 27th day of December, 19 56

My commission expires 10-11-58

Lucille Kennedy
Lucille Kennedy
Notary Public.

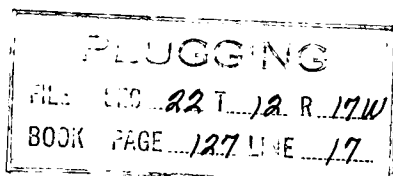

OPERATOR Jones, Shelburne & Farmer, Inc.ADDRESS Russell, Kansas

15-051-00830-00-00

FORMATION RECORD

Give detailed description and thickness of all formations drilled through, contents of sand, whether dry, water, oil or gas.

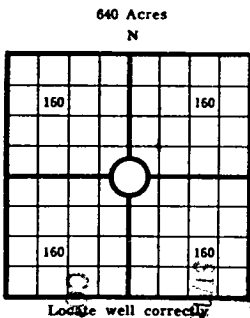

COUNTY Ellis SEC. 22 TWP. 12S RGE. 17W
 COMPANY OPERATING Jones, Shelburne & Farmer, Inc.
 OFFICE ADDRESS Russell, Kansas
 FARM NAME SCHMEIDLER C WELL NO. 1
 DRILLING STARTED 12-7, 1956 DRILLING FINISHED 12-17, 1956
 DATE OF FIRST PRODUCTION _____ COMPLETED _____
 WELL LOCATED NE 1/4 NE 1/4 SW 1/4 North of South
 Line and _____ ft. East of West Line of Quarter Section
 Elevation (Relative to sea level) DERRICK FLOOR 2115 GROUND 2110
 CHARACTER OF WELL (Oil, gas or dryhole) Dry

OIL OR GAS SANDS OR ZONES

Name	From	To	Name	From	To
1			4		
2			5		
3			6		

Fracturing Record If Any

Shot Record

Formation	From	To	No. of Shots	Formation	From	To	Size of Shot

CASING RECORD

Amount Set						Amount Pulled				Packer Record	
Size	Wt.	Thds.	Make	Ft.	In.	Ft.	In.	Size	Length	Depth Set	Make
8-5/8				160							

Liner Record: Amount _____ Kind _____ Top _____ Bottom _____

CEMENTING AND MUDDING

Size	Amount Set		Sacks Cement	Chemical		Method of Cementing	Amount	Mudding Method	Results (See Note)
	Ft.	In.		Gal.	Make				
8-5/8	160		100						

Note: What method was used to protect sands if outer strings were pulled? _____

NOTE: Were bottom hole plugs used? _____ If so, state kind, depth set and results obtained _____

TOOLS USED

Rotary Tools were used from _____ feet to _____ feet to _____ feet, and from _____ feet to _____ feet, and from _____ feet to _____ feet.

Type Rig _____

INITIAL PRODUCTION TEST

Describe initial test: whether by flow through tubing or casing or by pumping _____

Amount of Oil Production _____ bbls. Size of choke, if any _____ Length of test _____ Water

Production _____ bbls. Gravity of oil _____ Type of Pump if pump is used, describe _____

I, the undersigned, being first duly sworn upon oath, state that this well record is true, correct and complete according to the records of this office and to the best of my knowledge and belief.

Name and title of representative of company - Pres

Subscribed and sworn to before me this 27th day of December, 19 56My Commission expires 10-11-58

Notary Public

Formation	Top	Bottom	Formation	Top	Bottom
Shale	0	500			
Shale & snad	500	580			
Sand & iron pyrite	580	965			
Shale (redbed)	965	1316			
Anhydrite	1316	1359			
Shale & shells	1359	1870			
Shale & shells & salt	1870	1920			
Lime & shalle	1920	3415			
Lime	3415	3545			
Lime & shale	3545	3634			
Conglomerate	3634	3665			
Lime & shale	3665	3710	Elevation		2117 RB
Arbuckle	3710	3714			
T.D.	3714		SAMPLE TOPS:		
			Anhydrite		1316
			Heebner		3327
			Toronto		3351
			Lansing		3373
			B/KC		3583
			Cherty Congl.		3635
			Arbuckle		3701
			T.D.		3714
			D & A		

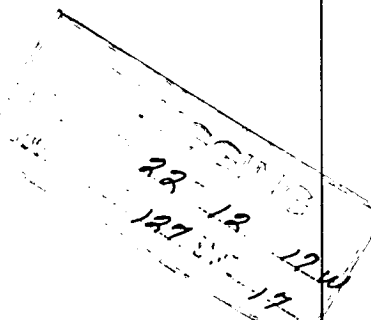
FARM NAME SCHMEIDLER C WELL NO. 1 COUNTY ELLIS SEC. 22 TWP. 12S RGE. 17W