

For KCC Use: 1-3-2010  
 Effective Date: 3  
 District # 3  
 SGA?  Yes  No

KANSAS CORPORATION COMMISSION  
 OIL & GAS CONSERVATION DIVISION

Form C-1  
 October 2007  
 Form must be Typed  
 Form must be Signed  
 All blanks must be Filled

NOTICE OF INTENT TO DRILL

Must be approved by KCC five (5) days prior to commencing well

Expected Spud Date: 1 20 2010  
month day year

OPERATOR: License# 32709  
 Name: TimSplechter  
 Address 1: 1586 Hwy 54  
 Address 2: \_\_\_\_\_  
 City: Yates Center State: Ks Zip: 66783  
 Contact Person: Tim Splechter  
 Phone: 620 496 6100

CONTRACTOR: License# 32079  
 Name: Leis Oil Services

Well Drilled For:  Oil  Gas  Seismic; # of Holes \_\_\_\_\_  
 Enh Rec  Storage  Disposal  Other: \_\_\_\_\_  
 Well Class:  Infield  Pool Ext.  Wildcat  Other \_\_\_\_\_  
 Type Equipment:  Mud Rotary  Air Rotary  Cable

If OWWO: old well information as follows:  
 Operator: \_\_\_\_\_  
 Well Name: \_\_\_\_\_  
 Original Completion Date: \_\_\_\_\_ Original Total Depth: \_\_\_\_\_

Directional, Deviated or Horizontal wellbore?  Yes  No  
 If Yes, true vertical depth: \_\_\_\_\_  
 Bottom Hole Location: \_\_\_\_\_  
 KCC DKT #: \_\_\_\_\_

Spot Description: \_\_\_\_\_  
 nw - sw - nw - sw Sec. 8 Twp. 25 S. R. 16  E  W  
 (or/or/a) 1,870 feet from  N /  S Line of Section  
165 feet from  E /  W Line of Section

Is SECTION:  Regular  Irregular?

(Note: Locate well on the Section Plat on reverse side)  
 County: Woodson

Lease Name: Grisier Well #: 8-10  
 Field Name: Owl Creek

Is this a Prorated / Spaced Field?  Yes  No

Target Formation(s): Squirrel  
 Nearest Lease or unit boundary line (in footage): 165

Ground Surface Elevation: NA feet MSL

Water well within one-quarter mile:  Yes  No

Public water supply well within one mile:  Yes  No

Depth to bottom of fresh water: 120

Depth to bottom of usable water: 230

Surface Pipe by Alternate:  I  II

Length of Surface Pipe Planned to be set: 40

Length of Conductor Pipe (if any): \_\_\_\_\_

Projected Total Depth: 1000

Formation at Total Depth: squirrel

Water Source for Drilling Operations:  
 Well  Farm Pond  Other: \_\_\_\_\_

DWR Permit #: \_\_\_\_\_

(Note: Apply for Permit with DWR )

Will Cores be taken?  Yes  No

If Yes, proposed zone: \_\_\_\_\_

AFFIDAVIT

The undersigned hereby affirms that the drilling, completion and eventual plugging of this well will comply with K.S.A. 55 et. seq.  
 It is agreed that the following minimum requirements will be met:

1. Notify the appropriate district office **prior** to spudding of well;
2. A copy of the approved notice of intent to drill **shall be** posted on each drilling rig;
3. The minimum amount of surface pipe as specified below **shall be set** by circulating cement to the top; in all cases surface pipe **shall be set** through all unconsolidated materials plus a minimum of 20 feet into the underlying formation.
4. If the well is dry hole, an agreement between the operator and the district office on plug length and placement is necessary **prior to plugging**;
5. The appropriate district office will be notified before well is either plugged or production casing is cemented in;
6. If an ALTERNATE II COMPLETION, production pipe shall be cemented from below any usable water to surface within **120 DAYS** of spud date. Or pursuant to Appendix "B" - Eastern Kansas surface casing order #133,891-C, which applies to the KCC District 3 area, alternate II cementing must be completed within 30 days of the spud date or the well shall be plugged. **In all cases, NOTIFY district office** prior to any cementing.

I hereby certify that the statements made herein are true and correct to the best of my knowledge and belief.

Date: 12/23/09 Signature of Operator or Agent: [Signature] Title: owner

For KCC Use ONLY  
 API # 15 - 207-27562-00-00  
 Conductor pipe required None feet  
 Minimum surface pipe required 40 feet per ALT.  I  II  
 Approved by: [Signature] 12-29-2009  
 This authorization expires: 12-29-2010  
 (This authorization void if drilling not started within 12 months of approval date.)  
 Spud date: \_\_\_\_\_ Agent: \_\_\_\_\_

Remember to:

- File Drill Pit Application (form CDP-1) with Intent to Drill;
- File Completion Form ACO-1 within 120 days of spud date;
- File acreage attribution plat according to field proration orders;
- Notify appropriate district office 48 hours prior to workover or re-entry;
- Submit plugging report (CP-4) after plugging is completed (within 60 days);
- Obtain written approval before disposing or injecting salt water.
- If this permit has expired (See: authorized expiration date) please check the box below and return to the address below.

Well Not Drilled - Permit Expired Date: \_\_\_\_\_  
 Signature of Operator or Agent: \_\_\_\_\_

RECEIVED

DEC 28 2009

KCC WICHITA

8  
25  
16  
 E  W

**IN ALL CASES PLOT THE INTENDED WELL ON THE PLAT BELOW**

*Plat of acreage attributable to a well in a prorated or spaced field*

**If the intended well is in a prorated or spaced field, please fully complete this side of the form.** If the intended well is in a prorated or spaced field complete the plat below showing that the well will be properly located in relationship to other wells producing from the common source of supply. Please show all the wells and within 1 mile of the boundaries of the proposed acreage attribution unit for gas wells and within 1/2 mile of the boundaries of the proposed acreage attribution unit for oil wells.

API No. 15 - 207-27562-00-00  
 Operator: Tim Splechter  
 Lease: Grisler  
 Well Number: 8-10  
 Field: Owl Creek

Location of Well: County: Woodson  
1,870 feet from  N /  S Line of Section  
165 feet from  E /  W Line of Section  
 Sec. 8 Twp. 25 S. R. 16  E  W

Number of Acres attributable to well: \_\_\_\_\_  
 QTR/QTR/QTR/QTR of acreage:  NW -  SW -  NW -  SW

Is Section:  Regular or  Irregular

**If Section is Irregular, locate well from nearest corner boundary.**

Section corner used:  NE  NW  SE  SW

**PLAT**

*(Show location of the well and shade attributable acreage for prorated or spaced wells.)*

*(Show footage to the nearest lease or unit boundary line.)*

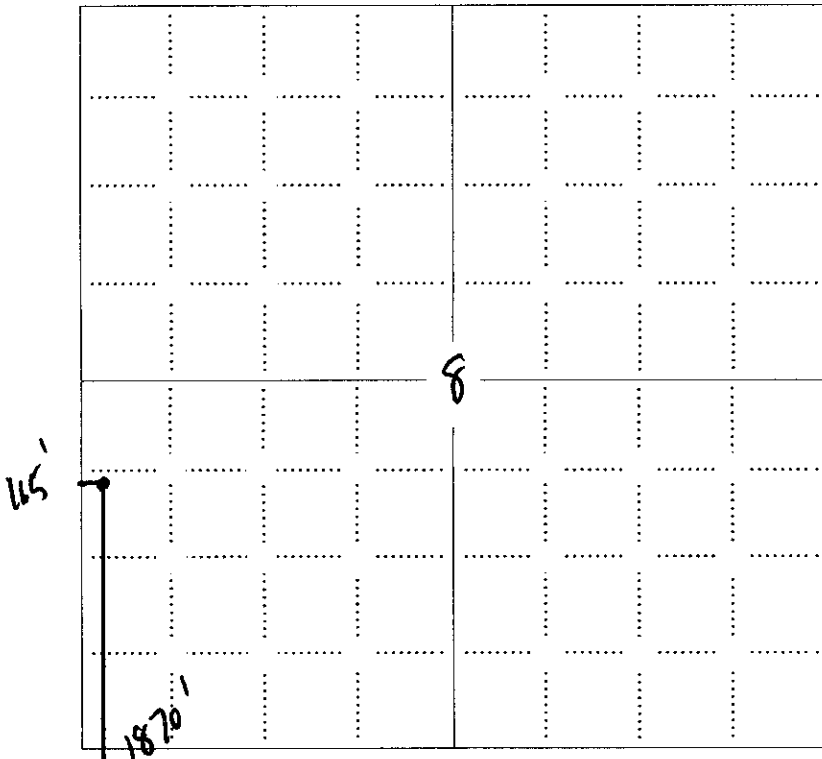

RECEIVED  
 DEC 2 8 2009  
 KCC WICHITA

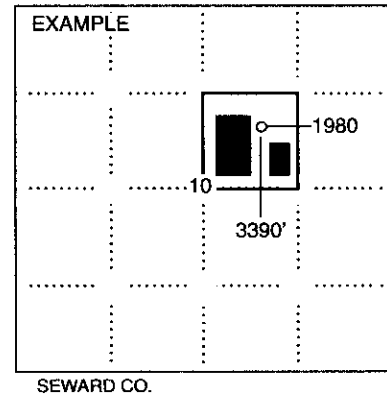

**NOTE: In all cases locate the spot of the proposed drilling location.**

**In plotting the proposed location of the well, you must show:**

1. The manner in which you are using the depicted plat by identifying section lines, i.e. 1 section, 1 section with 8 surrounding sections, 4 sections, etc.
2. The distance of the proposed drilling location from the south / north and east / west outside section lines.
3. The distance to the nearest lease or unit boundary line (in footage).
4. If proposed location is located within a prorated or spaced field a certificate of acreage attribution plat must be attached: (CO-7 for oil wells; CG-8 for gas wells).

**KANSAS CORPORATION COMMISSION  
OIL & GAS CONSERVATION DIVISION  
APPLICATION FOR SURFACE PIT**

Form GDP-1  
April 2004  
Form must be Typed

*Submit in Duplicate*

Operator Name: <b>Tim Splechter</b>		License Number: <b>32709</b>																				
Operator Address: <b>1586 Hwy 54</b>		<b>Yates Center Ks 66783</b>																				
Contact Person: <b>Tim Splechter</b>		Phone Number: <b>620 496 6100</b>																				
Lease Name & Well No.: <b>Grisier 8-10</b>		Pit Location (QQQQ): <table style="width:100%; border:none;"> <tr> <td align="center">NW</td> <td align="center">SW</td> <td align="center">NW</td> <td align="center">SW</td> </tr> <tr> <td>Sec. <u>8</u></td> <td>Twp. <u>25</u></td> <td>R. <u>16</u></td> <td><input checked="" type="checkbox"/> East <input type="checkbox"/> West</td> </tr> <tr> <td colspan="3">1,870 Feet from <input type="checkbox"/> North / <input checked="" type="checkbox"/> South Line of Section</td> <td></td> </tr> <tr> <td colspan="3">165 Feet from <input type="checkbox"/> East / <input checked="" type="checkbox"/> West Line of Section</td> <td></td> </tr> <tr> <td colspan="4"><b>Woodson</b> County</td> </tr> </table>	NW	SW	NW	SW	Sec. <u>8</u>	Twp. <u>25</u>	R. <u>16</u>	<input checked="" type="checkbox"/> East <input type="checkbox"/> West	1,870 Feet from <input type="checkbox"/> North / <input checked="" type="checkbox"/> South Line of Section				165 Feet from <input type="checkbox"/> East / <input checked="" type="checkbox"/> West Line of Section				<b>Woodson</b> County			
NW	SW	NW	SW																			
Sec. <u>8</u>	Twp. <u>25</u>	R. <u>16</u>	<input checked="" type="checkbox"/> East <input type="checkbox"/> West																			
1,870 Feet from <input type="checkbox"/> North / <input checked="" type="checkbox"/> South Line of Section																						
165 Feet from <input type="checkbox"/> East / <input checked="" type="checkbox"/> West Line of Section																						
<b>Woodson</b> County																						
Type of Pit: <input type="checkbox"/> Emergency Pit <input type="checkbox"/> Burn Pit <input type="checkbox"/> Settling Pit <input checked="" type="checkbox"/> Drilling Pit <input type="checkbox"/> Workover Pit <input type="checkbox"/> Haul-Off Pit <small>(If WP Supply API No. or Year Drilled)</small>		Pit is: <input checked="" type="checkbox"/> Proposed <input type="checkbox"/> Existing If Existing, date constructed: _____ Pit capacity: <b>100</b> (bbbls)																				
Is the pit located in a Sensitive Ground Water Area? <input type="checkbox"/> Yes <input checked="" type="checkbox"/> No		Chloride concentration: _____ mg/l <small>(For Emergency Pits and Settling Pits only)</small>																				
Is the bottom below ground level? <input checked="" type="checkbox"/> Yes <input type="checkbox"/> No	Artificial Liner? <input type="checkbox"/> Yes <input checked="" type="checkbox"/> No	How is the pit lined if a plastic liner is not used? <b>native clay</b>																				
Pit dimensions (all but working pits): <u>40</u> Length (feet) <u>10</u> Width (feet)		<input type="checkbox"/> N/A: Steel Pits																				
Depth from ground level to deepest point: <u>4</u> (feet)		<input type="checkbox"/> No Pit																				
If the pit is lined give a brief description of the liner material, thickness and installation procedure.		Describe procedures for periodic maintenance and determining liner integrity, including any special monitoring.																				
Distance to nearest water well within one-mile of pit <u>NA</u> feet    Depth of water well _____ feet		Depth to shallowest fresh water _____ feet. Source of information: <input type="checkbox"/> measured <input type="checkbox"/> well owner <input type="checkbox"/> electric log <input type="checkbox"/> KDWR																				
<b>Emergency, Settling and Burn Pits ONLY:</b> Producing Formation: _____ Number of producing wells on lease: _____ Barrels of fluid produced daily: _____ Does the slope from the tank battery allow all spilled fluids to flow into the pit? <input type="checkbox"/> Yes <input type="checkbox"/> No		<b>Drilling, Workover and Haul-Off Pits ONLY:</b> Type of material utilized in drilling/workover: <u>fresh water, shale, sandstone, limestone</u> Number of working pits to be utilized: <u>1</u> Abandonment procedure: <u>dry and backfill</u> Drill pits must be closed within 365 days of spud date.																				
I hereby certify that the above statements are true and correct to the best of my knowledge and belief.		RECEIVED DEC 28 2009 KCC WICHITA																				
<u>12/23/09</u> Date	 Signature of Applicant or Agent																					

15-207-2756200-00

<b>KCC OFFICE USE ONLY</b>		Steel Pit <input type="checkbox"/>	RFAC <input checked="" type="checkbox"/>	RFAS <input type="checkbox"/>
Date Received: <u>12-28-09</u>	Permit Number: _____	Permit Date: <u>12-28-09</u>	Lease Inspection: <input checked="" type="checkbox"/> Yes <input type="checkbox"/> No	

Mail to: KCC - Conservation Division, 130 S. Market - Room 2078, Wichita, Kansas 67202

December 29, 2009

TimSplechter  
1586 Hwy 54  
Yates Center, KS 66783

RE: Drilling Pit Application  
Grisier Lease Well No. 8-10  
SW/4 Sec. 08-25S-16E  
Woodson County, Kansas

Dear Sir or Madam:

District staff has inspected the above referenced location and has determined that the reserve pit shall be constructed **without slots**, the bottom shall be flat and reasonably level, and the free fluids must be removed. The fluids are to be removed from the reserve pit as soon as practical after drilling operations have ceased.

**If production casing is set all completion fluids shall be removed from the working pits daily. NO completion fluids or non-exempt wastes shall be placed in the reserve pit.**

The fluids should be taken to an authorized disposal well. Please call the District Office at (620) 432-2300 when the fluids have been removed. Please file form CDP-5 (August 2004), Exploration and Production Waste Transfer, within 30 days of fluid removal. Conservation division forms are available through our office and on the KCC web site:  
[www.kcc.state.ks.us/conservation/forms](http://www.kcc.state.ks.us/conservation/forms).

**A copy of this letter should be posted in the doghouse along with the approved Intent to Drill.**

If you have any questions or concerns please feel free to contact the undersigned at the above address.

Sincerely,

  
Kathy Haynes

Environmental Protection and Remediation Department

cc: File