

FOR KCC USE:

15-051-24886-00-00

FORM C-1 7/91

FORM MUST BE TYPED

EFFECTIVE DATE: 11-8-94

State of Kansas

FORM MUST BE SIGNED

DISTRICT # 4

NOTICE OF INTENTION TO DRILL

ALL BLANKS MUST BE FILLED

SGA? Yes No

Must be approved by the K.C.C. five (5) days prior to commencing well.

Expected Spud Date 11-4-94 month day year

Spot N/2 NE SE Sec 1 Twp 12 S, Rg 20 X West

OPERATOR: License # 30606 Name: Murfin Drilling Company, Inc. Address: 250 N. Water, Suite 300 City/State/Zip: Wichita, KS. 67022 Contact Person: Scott Robinson Phone: 316-267-3241

2310' feet from South North line of Section 660' feet from East West line of Section IS SECTION X REGULAR IRREGULAR?

CONTRACTOR: License # 30606 Name: Murfin Drilling Co, Inc.

(NOTE: Locate well on the Section Plat on Reverse Side) County: Ellis

Well Drilled For: Well Class: Type Equipment:

- X Oil Enh Rec Infield Mud Rotary Gas Storage Pool Ext. Air Rotary OWWO Disposal X Wildcat Cable Seismic; # of Holes Other

Lease Name: HOWARD STAR Well #: 1-1 Field Name: Wildcat

If OWWO: old well information as follows:

Operator: Well Name: Comp. Date: Old Total Depth

Is this a Prorated/Spaced Field? yes X no Target Formation(s): IKC-Arbuckle

Directional, Deviated or Horizontal wellbore? yes X no

If yes, true vertical depth:

Bottom Hole Location:

Nearest lease or unit boundary: 330 Ground Surface Elevation: 2127 feet MSL

Water well within one-quarter mile: yes X no Public water supply well within one mile: yes X no

Depth to bottom of fresh water: 150 Depth to bottom of usable water: 800/640

Surface Pipe by Alternate: 1 X 2 250' Length of Surface Pipe Planned to be set: N/A

Length of Conductor pipe required: 3700' Formation at Total Depth: Arbuckle

Water Source for Drilling Operations: well farm pond X other

Will Cores Be Taken? yes X no If yes, proposed zone:

AFFIDAVIT

The undersigned hereby affirms that the drilling, completion and eventual plugging of this well will comply with K.S.A. 55-101, et. seq.

It is agreed that the following minimum requirements will be met:

- 1. Notify the appropriate district office prior to spudding of well; 2. A copy of the approved notice of intent to drill shall be posted on each drilling rig; 3. The minimum amount of surface pipe as specified below shall be set by circulating cement to the top; in all cases surface pipe shall be set through all unconsolidated materials plus a minimum of 20 feet into the underlying formation; 4. If the well is dry hole, an agreement between the operator and the district office on plug length and placement is necessary prior to plugging; 5. The appropriate district office will be notified before well is either plugged or production casing is cemented in; 6. IF AN ALTERNATE IS COMPLETION, PRODUCTION PIPE SHALL BE CEMENTED FROM BELOW ANY USABLE WATER TO SURFACE WITHIN 120 DAYS OF SPUD DATE. IN ALL CASES, NOTIFY DISTRICT OFFICE PRIOR TO ANY CEMENTING.

I hereby certify that the statements made herein are true and to the best of my knowledge and belief.

Date: 11-3-94 Signature of Operator or Agent: Scott Robinson Title: Agent for Operator

FOR KCC USE: API # 15- 051-24886 Conductor pipe required NONE feet Minimum surface pipe required 200' feet per Alt. X (2) Approved by: CB 11-3-94 This authorization expires: 5-3-95 (This authorization void if drilling not started within 6 months of effective date.) Spud date: Agent:

REMEMBER TO:

- File Drill Pit Application (form CDP-1) with Intent to Drill; - File Completion Form ACO-1 within 120 days of spud date; - File acreage attribution plat according to field proration orders; - Notify appropriate district office 48 hours prior to workover or re-entry; - Submit plugging report (CP-4) after plugging is completed; - Obtain written approval before disposing or injecting salt water.

Mail to: KCC - Conservation Division, 130 S. Market - Room 2078, Wichita, Kansas 67202.

1 - 12 - 20

IN ALL CASES PLOT THE INTENDED WELL ON THE PLAT BELOW

PLAT OF ACREAGE ATTRIBUTABLE TO A WELL IN A PRORATED OR SPACED FIELD

If the intended well is in a prorated or spaced field, please fully complete this side of the form. If the intended well is in a prorated or spaced field complete the plat below showing that the well will be properly located in relationship to other wells producing from the common source of supply. Please show all the wells within 1 mile of the boundaries of the proposed acreage attribution unit for gas wells and within 1/2 mile of the boundaries of the proposed acreage attribution unit for oil wells.

API NO. 15- _____
 OPERATOR Murfin Drilling Co., Inc.
 LEASE Howard Star
 WELL NUMBER 1-1
 FIELD Wildcat

LOCATION OF WELL: COUNTY Ellis
2310 feet from south/north line of section
660 feet from east/west line of section
 SECTION 1 TWP 12 S. RG 20 W

NUMBER OF ACRES ATTRIBUTABLE TO WELL _____
 QTR/QTR/QTR OF ACREAGE _____

IS SECTION X REGULAR or _____ IRREGULAR
IF SECTION IS IRREGULAR, LOCATE WELL FROM NEAREST CORNER BOUNDARY.

Section corner used: _____ NE _____ NW _____ SE _____ SW

PLAT

(Show location of the well and shade attributable acreage for prorated or spaced wells.)
 (Show footage to the nearest lease or unit boundary line.)

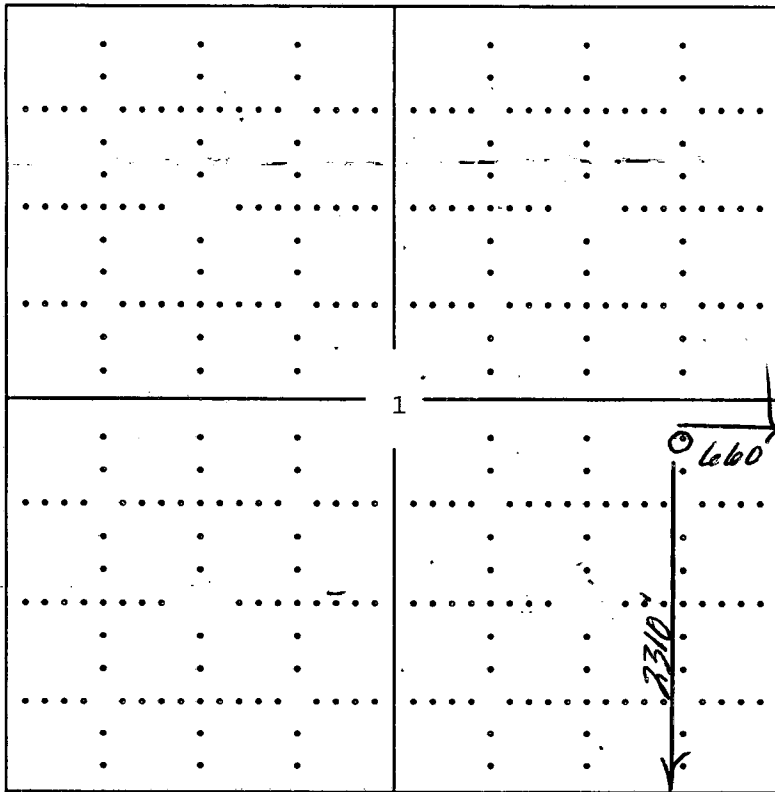

RECEIVED
 KANSAS CORPORATION COMMISSION

11-3-1994
 NOV 03 1994

CONSERVATION DIVISION
 WICHITA, KS

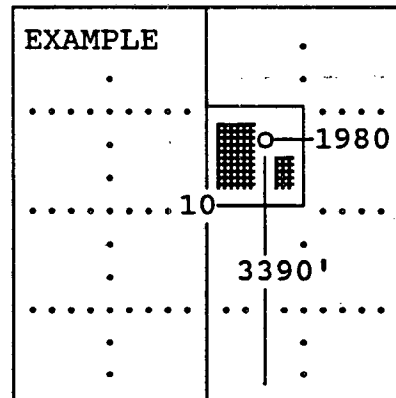

SEWARD CO.

In plotting the proposed location of the well, you must show:

- 1) The manner in which you are using the depicted plat by identifying section lines, i.e. 1 section, 1 section with 8 surrounding sections, 4 sections, etc.;
- 2) the distance of the proposed drilling location from the section's south/north and east/west; and
- 3) the distance to the nearest lease or unit boundary line.