

For KCC Use: Effective Date: 12-14-02 District # 3 SGA? Yes No

KANSAS CORPORATION COMMISSION OIL & GAS CONSERVATION DIVISION

RECEIVED

15-065-22865-00-00

Form C-1 September 1999

Form must be Typed Form must be Signed All blanks must be Filled

NOTICE OF INTENT TO DRILL

DEC 09 2002

KCC WICHITA

Must be approved by KCC five (5) days prior to commencing well

Expected Spud Date December 11 2002 month day year

OPERATOR: License# 32754 Name: ELYSIUM ENERGY, LLC Address: 1625 Broadway, Suite 2000 City/State/Zip: Denver, CO 80202 Contact Person: Jim Annable Phone: (303) 389-3610

CONTRACTOR: License# 31548 Name: Discovery Drilling Co., Inc. RSP/KCC

Well Drilled For: Oil Gas OWWO Seismic; # of Holes Other Well Class: Infield Pool Ext. Wildcat Other Type Equipment: Mud Rotary Air Rotary Cable

If OWWO: old well information as follows: Operator: Well Name: Original Completion Date: Original Total Depth:

Directional, Deviated or Horizontal wellbore? Yes No

If Yes, true vertical depth:

Bottom Hole Location:

KCC DKT #:

Spot SE SE NE Sec. 3 Twp. 10 S. R. 21W East West 2310 feet from (N) Line of Section 330 feet from (E) Line of Section Is SECTION Regular Irregular?

(Note: Locate well on the Section Plat on reverse side)

County: Graham Lease Name: Trible Well #: 8 Field Name: Cooper

Is this a Prorated / Spaced Field? Yes No

Target Information(s): LKC & Arbuckle

Nearest Lease or unit boundary: 330'

Ground Surface Elevation: 2284 feet MSL

Water well within one-quarter mile: Yes No

Public water supply well within one mile: Yes No

Depth to bottom of fresh water: 150'

Depth to bottom of usable water: 1000'

Surface Pipe by Alternate: 1 2

Length of Surface Pipe Planned to be set: 200'

Length of Conductor Pipe required: None

Projected Total Depth: 3900'

Producing Formation Target: Arbuckle

Water Source for Drilling Operations: Well Farm Pond Other

DWR Permit #:

(Note: Apply for Permit with DWR)

Will Cores be taken? Yes No

If Yes, proposed zone:

AFFIDAVIT

The undersigned hereby affirms that the drilling, completion and eventual plugging of this well will comply with K.S.A. 55-101, et. seq.

It is agreed that the following minimum requirements will be met:

- 1. Notify the appropriate district office prior to spudding of well;
2. A copy of the approved notice of intent to drill shall be posted on each drilling rig;
3. The minimum amount of surface pipe as specified below shall be set by circulating cement to the top; in all cases surface pipe shall be set through all unconsolidated materials plus a minimum of 20 feet into the underlying formation.
4. If the well is dry hole, an agreement between the operator and the district office on plug-length and placement is necessary prior to plugging;
5. The appropriate district office will be notified before well is either plugged or production casing is cemented in;
6. If an ALTERNATE II COMPLETION, production pipe shall be cemented from below any usable water to surface within 120 days of spud date. In all cases, NOTIFY district office prior to any cementing.

I hereby certify that the statements made herein are true and to the best of my knowledge and belief.

Date: 6 Dec. 2002 Signature of Operator or Agent: [Signature] Title: Agent

For KCC Use ONLY

API # 15 - 065-22865-00-00

Conductor pipe required NONE feet

Minimum surface pipe required 200 feet per Alt. 2

Approved by: RSP 12-9-02

This authorization expires: 6-9-03

(This authorization void if drilling not started within 6 months of effective date.)

Spud date: Agent:

Remember to:

- File Drill Pit Application (form CDP-1) with Intent to Drill;
- File Completion Form ACO-1 within 120 days of spud date;
- File acreage attribution plat according to field proration orders;
- Notify appropriate district office 48 hours prior to workover or re-entry;
- Submit plugging report (CP-4) after plugging is completed;
- Obtain written approval before disposing or injecting salt water.

Handwritten notes: W, 10, 2/14

IN ALL CASES PLOT THE INTENDED WELL ON THE PLAT BELOW

Plat of acreage attributable to a well in a prorated or spaced field

If the intended well is in a prorated or spaced field, please fully complete this side of the form. If the intended well is in a prorated or spaced field complete the plat below showing that the well will be properly located in relationship to other wells producing from the common source of supply. Please show all the wells and within 1 mile of the boundaries of the proposed acreage attribution unit for gas wells and within 1/2 mile of the boundaries of the proposed acreage attribution unit for oil wells.

API No. 15 _____
 Operator: ELYSIUM ENERGY, LLC
 Lease: Tribble
 Well Number: 8
 Field: Cooper
 Number of Acres attributable to well: _____
 QTR / QTR / QTR of acreage: _____

Location of Well: County: Graham

2310 feet from N S (circle one) Line of Section

330 feet from E W (circle one) Line of Section
 Sec. 3 Twp. 10 S. R. 21W East West

Is Section Regular or _____ Irregular

If Section is Irregular, locate well from nearest corner boundary.

Section corner used: ___NE ___NW ___SE ___SW

PLAT

(Show location of the well and shade attributable acreage for prorated or spaced wells.)
(Show footage to the nearest lease or unit boundary line.)

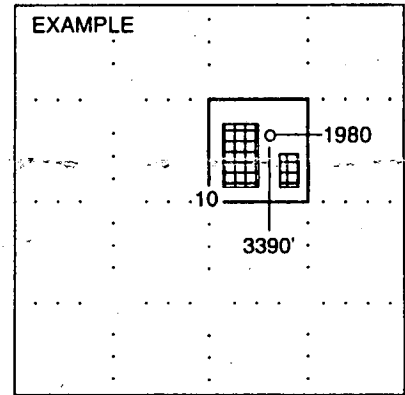
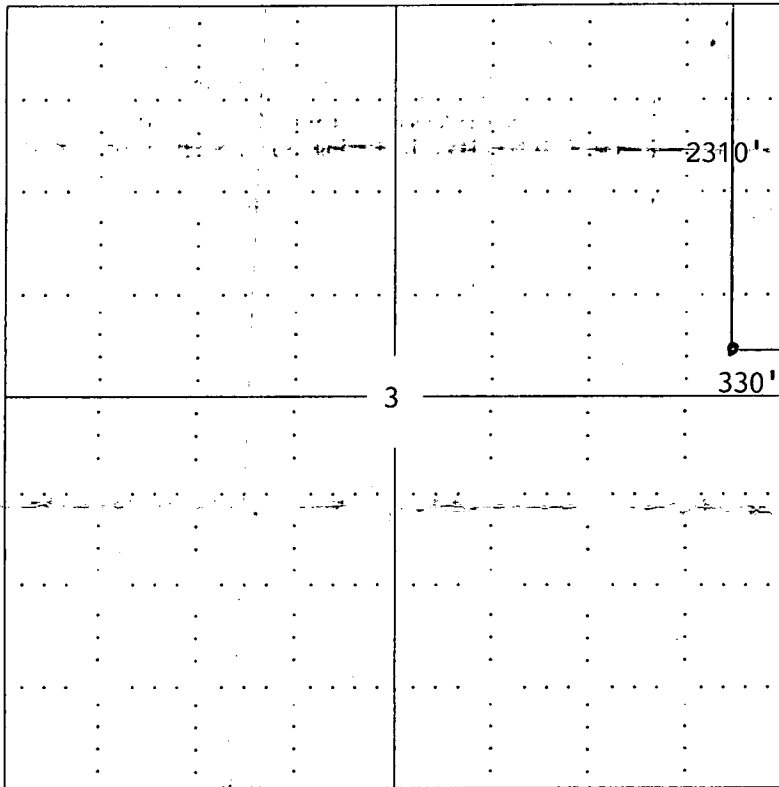

NOTE: In all cases locate the spot of the proposed drilling location.

Graham County, KS

In plotting the proposed location of the well, you must show:

1. The manner in which you are using the depicted plat by identifying section lines, i.e. 1 section, 1 section with 8 surrounding sections, 4 sections, etc.
2. The distance of the proposed drilling location from the section's south / north and east / west.
3. The distance to the nearest lease or unit boundary line.
4. If proposed location is located within a prorated or spaced field a certificate of acreage attribution plat must be attached: (CO-7 for oil wells; CG-8 for gas wells).